

深圳市维尔晶科技有限公司
SHENZHEN WEIKING TECHNOLOGY CO.,LTD.

产品规格书

PRODUCT SPECIFICATION

蓝牙音箱

Bluetooth speaker

Model : Rad Sound

深圳市维尔晶科技有限公司

SHENZHEN WEIKING TECHNOLOGY CO.,LTD.

1 基本规格参数 Basic specification

蓝牙芯片 Bluetooth Chipset		ATS2833		
蓝牙版本 Bluetooth version		BT5.0		
配对名称 Bluetooth pairing name		Rad Sound		
支持蓝牙协议 Support profiles		HFP V1.5;A2DP V1.2;AVRCP V1.4, GAVDP V1.2;AVDTP V1.2;SPP V1.2;AVCTP V1.2		
音频解码 Audio decoding		SBC		
RF 载波频率 RF carrier frequency		2402MHz-2480MHz		
蓝牙接收距离 Bluetooth working distance		10 meters		
输出功率 Output power		10W (the output power 10W is loudspeaker POWER)		
整机灵敏度 SPL Whole machine sensitivity SPL		82±3dB (BT in 200mv/1m) 1K-10KHz		
声道 Channel		Mono		
信噪比 S/N		≥74dB		
频率范围 Frequency range		100Hz—20KHz -10dB		
失真度 THD		≤1%at 1KHz 1M/1W		
蓝牙不连接自动关机时间 Automatically turn off time (Bluetooth unconnected)		15 Minutes		
喇叭 Speaker driver				
	尺寸 Size	48mm		
	数量 Quantity	1PC		
	阻抗 Impedance	4 Ω ±15%		
	额定功率 Rated power	10W		
	最大功率 Max power	15W		
	频率响应 Frequency response	100Hz-20KHz		
电池 Battery		电池型号 Model	Lithium battery 18650 cell	
		标称电压 Nominal voltage	3.6V	
		容量 Capability	3200mAh	
工作时间 Working time		100% volume: About 3hours 70% volume: About 8 hours (5 steps less than max volume) 50% volume: About 15 hours (8 steps more than minimum volume)		

深圳市维尔晶科技有限公司

SHENZHEN WEIKING TECHNOLOGY CO.,LTD.

	30% volume: About 25hours (5 steps more than minimum volume) Standby time: About 60 hours	
电力参数 Electric power parameter	输入电压/电流 Input voltage/current	TPYE-C USB 5V/2A
	充电时间 Charging time	Around 4hours (current 1A)
	待机电流 Standby current	<50mA
	关机电流 Shutdown current	<50uA
防水等级 Waterproof grade	IPX7	
箱体材质 Materials	ABS+PC+Fabric cover	
产品尺寸 Product size	143.53*118.2*44.6mm±0.5mm	
产品裸机净重量 Product weight	310g±20g	
工作温度 Working temperature	0~45℃	
存储温度 Storage temperature	-20~50℃	

2 操作使用说明 Operation instruction

序号 No.	项目 Actions	操作方法 Operation	LED 状态 LED status	提示音 prompt
1	Power on	When the speaker on power off status, press and hold the power button for 1S	Blue LED on	Y
2	Power off	When the speaker on power on status, press and hold the power button for 1S	LED turn off	Y
3	Pairing	Automatically enter pairing mode when turn on the speaker	Blue LED flash	N
4	Connected	Select the Bluetooth pairing name on mobile phone	3 LED indicators vary with power	Y
5	Disconnected manually	Long press V+ and V- button together	3 Blue LED flashes	Y
6	Reconnected	Speaker will reconnect with last device when power on.	LED indicators vary with its Power	Y
7	Incoming call	When incoming call	LED indicators vary with its Power	Y
8	On call	When incoming call mode, short press Play/Pause button	LED indicators vary with its Power	N
9	Reject call	When incoming call mode, long press Play/Pause button	LED indicators vary with its Power	N
10	Hang up call	When on call mode, short press Play/Pause button	LED indicators vary with its Power	N
11	Volume up	Short press V+, volume up monotonic increasing	3 LED indicators vary with its Power	Max volume have prompt voice
12	Volume down	Short press V-, volume down monotonic decreasing	3 LED indicators vary with its Power	Min volume have prompt voice
13	Volume up	Long press V+, volume up rapidly	3 LED indicators vary with its	Max volume

深圳市维尔晶科技有限公司

SHENZHEN WEIKING TECHNOLOGY CO.,LTD.

		increasing	Power	have prompt voice
14	Volume down	Long press V-, volume up rapidly decreasing	3 LED indicators vary with its Power	Min volume have prompt voice
15	Play/pause	Short press play/pause	3 LED indicators vary with its Power	N
16	TWS Pairing (Master and slave)	For any 2 pcs speakers, Without BT connection status, click one of the Speaker—the one which be double clicked will be speaker, then another speaker will be slave speaker.)	LED Indicators flashes in blue	Y
17	TWS connect to phone	After TWS connect under master and slave speaker, TWS mode connect, turn on your phone to search the device	1) Master speaker—LED indicators flash in blue 2) Slave speaker --- LED indicators vary with its Power	Y
18	Master/Slave speaker TWS disconnection	Double click power button→TWS disconnected : 1. Master speaker connected phone to play music; Double click the power button, master speaker still can play music, but slave speaker will turn to pairing mode. 2. If Master speaker do not connect to phone yet, then once TWS disconnected, then both master and slave speaker are BT Pairing mode.	1) Under mobile phone connected mode: Both master and slave speakers' LED indicators in blue and vary with its Power 2) Under pairing mode: LED indicators flashes in blue	Y
19	BLE Connect	1) connect the device to bluetooth 2) Turn on BLE App and search its BLE name (eg: XXXX LE) to connect it	/	N
20	BLE connect successfully	Turn on BLE test App: 1) short press BLE button: FA 02 00 01 EF 2) long press BLE button: FA 02 00 02 EF 3) Double click BLE button: FA 02 00 03 EF	/	N
21	Clear pairing list	Power on the speaker (do not connect BT), Long press play/pause button (Every device need operation one time if want to clear its pairing list every time)	/	Y
22	电量灯 Power LED indicator	3pcs LED Indicators	70%-100% power: 3pcs LED keep in solid blue 30%-70% power: 2pcs LED light on 10%-30%: 1pc LED light on	无 N
23	Low power prompt	Power left lower than 10%	1pc LED flashes in blue	Y
24	Automatically Turn off at low battery	Power left 0%	Low power alarm once before automatic shutdown	Y
25	Charging	Insert the 5V/2A charging cable	LED indicators keep in solid Red	N
26	Charging finish	Automatically	Red LED off	N
27	Reset	Using a slim pen to press the reset button	/	N

深圳市维尔晶科技有限公司

SHENZHEN WEIKING TECHNOLOGY CO.,LTD.

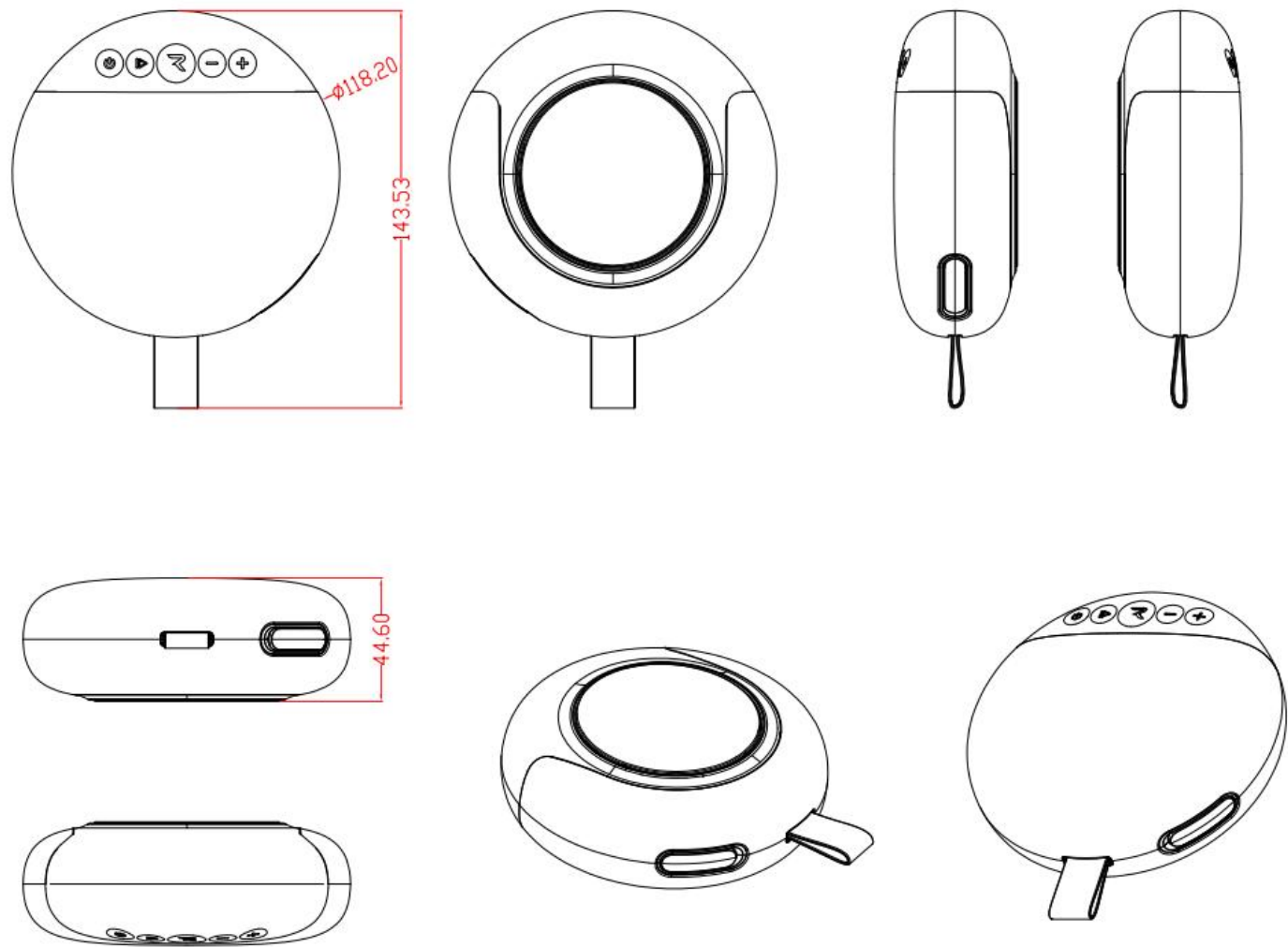

6 标准配件 Standard accessories

序号 No.	配件名 Accessory name	规格描述 Specification Description	用量 Dosage	备注 Remark
1	USB 线 USB cable	USB 对 TYPE-C 600MM 红色 色号: Pantone 185C	1pcs	

深圳市维尔晶科技有限公司

SHENZHEN WEIKING TECHNOLOGY CO.,LTD.

Federal Communications Commission (FCC) Statement. This device complies with part 15 of the FCC Rules. Operation is subject to the following two conditions:

- (1) This device may not cause harmful interference, and
- (2) this device must accept any interference received,

including interference that may cause undesired operation. Note: This equipment has been tested and found to comply with the limits for a Class B digital device, pursuant to part 15 of the FCC Rules. These limits are designed to provide Reasonable protection against harmful interference in a residential installation. This equipment generates, uses and can radiate radio frequency energy and, if not installed and used in accordance with the instructions, may cause harmful interference to radio communications. However, there is no guarantee that interference will not occur in a particular installation. If this equipment does cause harmful interference to radio or television reception, which can be determined by turning the equipment off and on, the user is encouraged to try to correct the interference by one or more of the following measures:

- Reorient or relocate the receiving antenna.
- Increase the separation between the equipment and receiver.
- Connect the equipment into an outlet on a circuit different from that to which the receiver is connected.
- Consult the dealer or an experienced radio/TV technician for help.

Warning: Changes or modifications made to this device not expressly approved by **Rad Golf, Inc.** may void the FCC authorization to operate this device. Note: The manufacturer is not responsible for any radio or TV interference caused by unauthorized modifications to this equipment. Such modifications could void the user's authority to operate the equipment.

RF exposure statement:

This device complies with FCC RF radiation exposure limits set forth for an uncontrolled environment. The device is installed and operated without restriction.

深圳市维尔晶科技有限公司

SHENZHEN WEIKING TECHNOLOGY CO.,LTD.

ISED Statement

- English: This device complies with Industry Canada license - exempt RSS standard(s).

Operation is subject to the following two conditions: (1) This device may not cause interference, and (2) This device must accept any interference, including interference that may cause undesired operation of the device.

The digital apparatus complies with Canadian CAN ICES - 3 (B)/NMB - 3(B).

- French: Le présent appareil est conforme aux CNR d'Industrie Canada applicables aux appareils radio exempts de licence. L'exploitation est autorisée aux deux conditions suivantes: (1) l'appareil ne doit pas produire de brouillage, et (2) l'utilisateur de l'appareil doit accepter tout brouillage radioélectrique subi, même si le brouillage est susceptible d'en compromettre le fonctionnement.

l'appareil numérique du ciem conforme canadien peut - 3 (b) / nmb - 3 (b).

For Transmitter:

This device meets the exemption from the routine evaluation limits in section 2.5 of RSS 102 and compliance with RSS 102 RF exposure, users can obtain Canadian information on RF exposure and compliance.

cet appareil est conforme à l'exemption des limites d'évaluation courante dans la section 2.5 du cnr - 102 et conformité avec rss 102 de l'exposition aux rf, les utilisateurs peuvent obtenir des données canadiennes sur l'exposition aux champs rf et la conformité.

This equipment complies with Canada radiation exposure limits set forth for an uncontrolled environment. The device is installed and operated without restriction.

Cet équipement est conforme Canada limites d'exposition aux radiations dans un environnement non contrôlé. Die Installation und der Betrieb der Ausrüstung sind uneingeschränkt.