

Shenzhen Tomoloo Technology Industrial Co.,Ltd

Address: 5th Floor, Building 28, Yongfa Science Park, Shajing Street, Baoan District, Shenzhen.

Web: www.tomoloo.com

Email: service@tomoloo.com

Shenzhen Tomoloo Technology Industrial Co., Ltd Supports After-Sell Service

TOMOLOO
Go any where

Electric Scooter L1 Pro

Operation and installation manual



1. Electric scooter are suitable for age 16-50. If you are tired or lack energy, please do not ride it. Inexperienced users should ride carefully. Children should not use this electric scooter or play with its parts and do not clean or maintain it. When riding, the vibration of the scooter will cause the driver's body to vibrate.

2. Please read the instructions carefully before use, and use this scooter properly comply with the instructions strictly.

3. Notice: To charge the battery, please use the charging adapter compatible with the scooter.
(Model: FY-0634201500)

4. When the product is scrapped

- (1) The battery must be removed from the device before scrapping.
- (2) When removing the battery, the device must be disconnected from the power supply.
- (3) The battery should be disposed properly.

5. This device contains a non-replaceable battery pack.

About Manual

This manual is suitable for two-wheel electric scooter, please read this manual carefully to ensure:

- × Quickly know the basic operation and riding methods of two-wheel electric scooter.
 - × Familiar with safe riding rules and get a safe and pleasant riding experience.
 - × Understand the structure and operation mode of two-wheel electric scooter, and regular maintenance methods.
- If you have any questions or want to know more about us, please contact an authorized dealer or customer service.

Please pay special attention to the following signs and related content



Danger!
May cause serious property damage or personal injury



Notice!
Improper operation can cause the product to work abnormally or malfunction



Message notification

Catalogue

About manual	01
Catalogue	02
Chapter 1: Product and accessories	04
Chapter 2: Function and icon description	05
Chapter 3: Installation guide	07
Chapter 4: Charging instructions	10
Chapter 5: How to ride	11
Chapter 6: Folding and transportation	13
Chapter 7: Security & Protection	14

Chapter 8: Daily Maintenance	19-20
Chapter 9: Specification parameter table	21-22
Chapter 10: Warranty	23-24
Chapter 11: APP download guide and function introduction	25-26

Chapter 1 Product and accessories

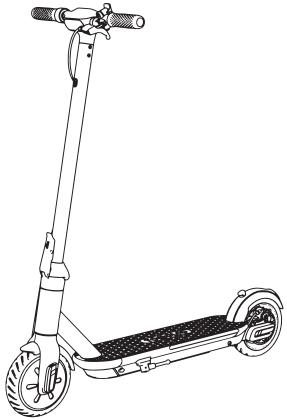

*Please check carefully that the parts in the package are intact.

Parts List

User manual x 1
Pole screw M5 x 6



Allen key M5 x 1, M3 x 1



Charging adapter x 1

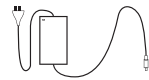

Chapter 2 Function and icon description

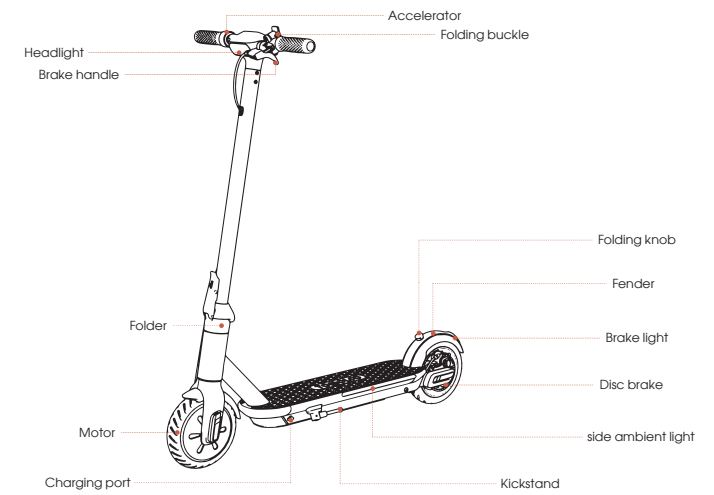

Control pannel



Control instructions

Use the control pannel to control scooter, the specific features are as follows.

1. Speedometer display the current driving speed of the electric scooter. When the electric scooter out functioned, the speedometer will display the fault error code.
2. Bluetooth display: the long bright Bluetooth icon indicates that the electric scooter has been successfully connected to the mobile device.
3. Lock display: operate through HUAWEI AILIFE app. See app for detailed operation.
4. Power display: the remaining power of the battery is displayed by 5 gear display lights, and each gear display light represents about 20% of the full power of the battery.
5. Power switch: ① Turn on / off electric scooter: press the switch button for about 2 seconds in the turn off state.
② Turn on / turn off the headlight: press the switch button once after power on.
③ Gear Adjustment : press the switch button twice in quick succession after power on.
④ Total mileage display: press the switch button three times in quick succession after power on, and then press the switch button three times in quick succession to return to the speed display. When pushing or riding, it can automatically turn to the speed display.
6. Cruise control: Cruise mode is off by default and can be opened through mobile app. When you ride at the same speed for more than 8 seconds, it will start the cruise mode. After braking or changing the speed, it will automatically exit the constant speed cruise mode.

- 06 -

Chapter 3 installation guide

1. Take out the inner bracket of the electric scooter fixed in the packing box.

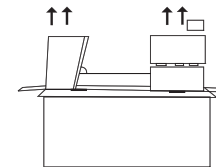

2. Take out the electric scooter in the packing box.

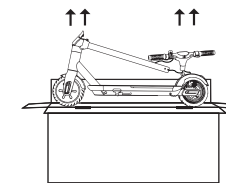

3. Hold the scooter upright, After the pole is completely upright, push the folding buckle handle (the blue part of the image) inward until the safety latch (the red part of the image) is stuck in the upright pole.

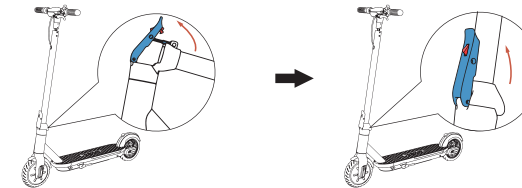

- 07 -

4. Before inserting the head into the pole, align the communication line with the arrow to the card slot for installation.

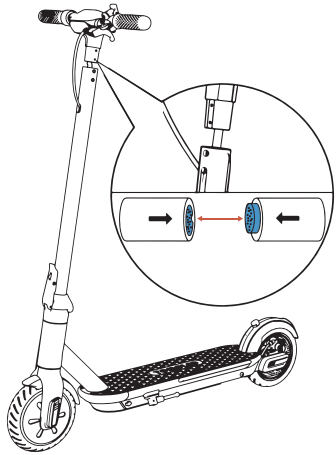

5. Insert and install the head into the pole.

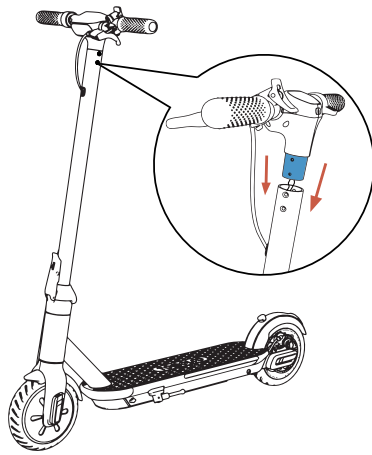

- 08 -

6. Use the M3 Allen key, twist the screws slightly in order of the below picture. Tighten the screws thoroughly after fixed the scooter head.

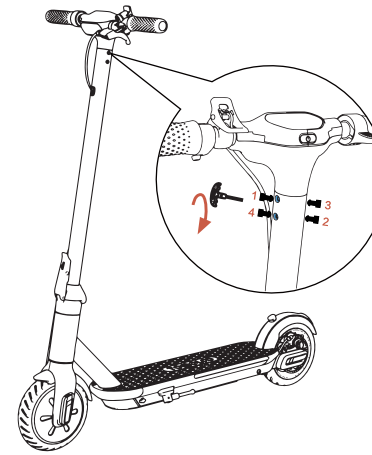

7. Use the M5 Allen key of the tool bag to install the brake handle to a comfortable angle (as shown in the picture).

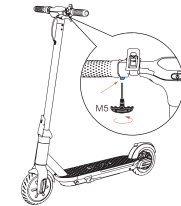

8. Do the power on/off testing after installation finished.

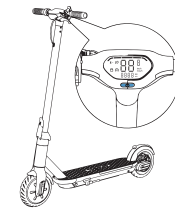

- 09 -

Chapter 4 Charging instructions

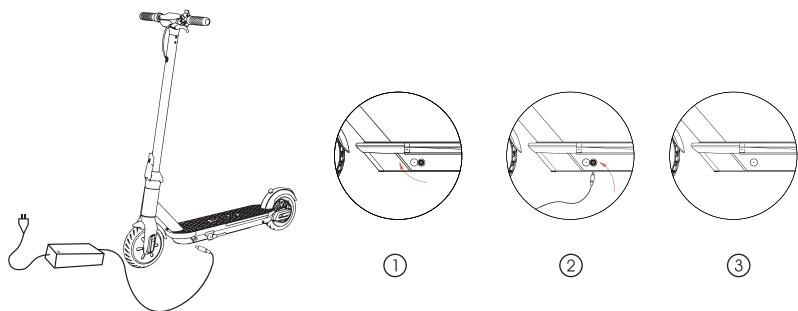

1. Open the rubber cap.
2. Insert in the charging plug. After the power is turned on, the red light of the charger is on, which means that the scooter is charging, and the green light of the charger is on, which means that the scooter is fully charged.
3. Turn off the power, pull out the charging plug and fasten the rubber cap.

Chapter 5 How to ride

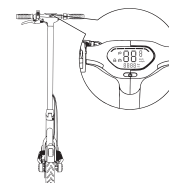
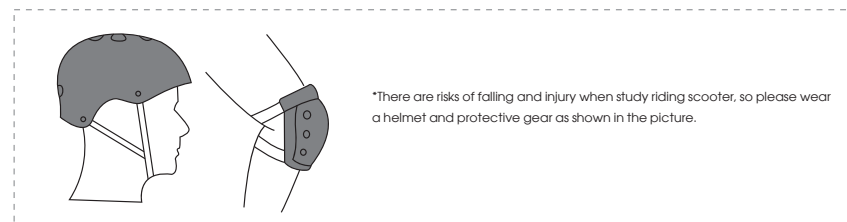

1. Turn on the power and check the power indicator.



2. One foot stands on the pedal, the other foot kicks backward.

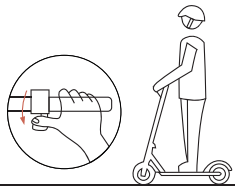

3. When the electric scooter is sliding, the other foot steps on the pedal. After the feet step on the pedal, slightly press the throttle (speed above 3km/h will start the throttle) Cruise mode is off by default and can be opened through mobile app.

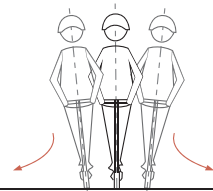

4. When turning, you need to lean the body slightly toward the direction of turning and turn the handle slowly.

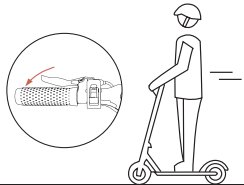

5. When deceleration is required, release the throttle slowly. When braking, the brake light will flash after holding the brake handle tightly.

Note: the above riding instructions are applicable to the non-zero start mode. If it is set to the zero start mode, it can be started by gently pressing the throttle without assistance. In this mode, do not press the throttle when pushing to prevent accidents. You can switch the mode in app.

Chapter 6 Folding and transportation

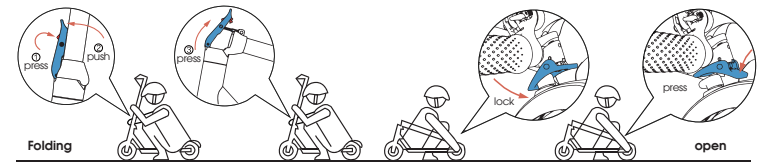

1. Folding: please hold the upright pole first, press the safety lock (the red part in the picture) with a little force, push the folding handle outward (the blue part in the picture), put down the upright pole, and hang the folding clasp hook on the mudguard folding knob.
2. Open: gently press the folding clasp to erect the upright pole. When the upright pole is completely upright, push the folding clasp handle inward until the safety lock catches in the upright pole.
3. Transportation: after folded successfully, use one hand or two to hold the folding rod to transit.



Chapter 7 Security & Protection



⚠ Please avoid riding in the rain.

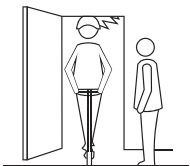

⚠ Pay attention to the impact when entering the door, elevator and other high obstacles.



⚠ Do not pass at high speed when encounter speed bump/ elevator threshold/pothole and offbeat pavement. Please keep medium-low speed on bumpy road(5/10Km/h). Slightly bend your knees let you better adapt to the above complex road.



⚠ Don't speed up while going downward.

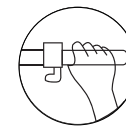

⚠ Don't press throttle when walking with the electric scooter.

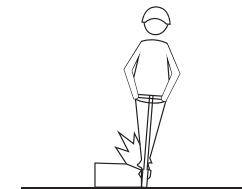

⚠ Please avoid obstacles.



⚠ Don't hang on the handlebar.



⚠ Don't riding with single foot on the pedal.

Warm prompt:

Don't try to do dangerous action

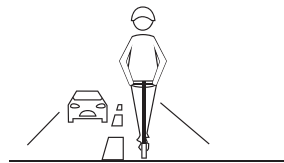

⊗ No riding into the residential complex with mixed flow of people and vehicles and lane of motor vehicle.

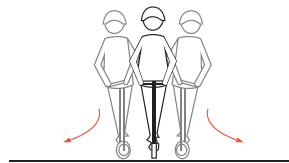

⊗ Don't turn handlebar substantially on the high speed.



⊗ Don't step on the Rear mudguard.

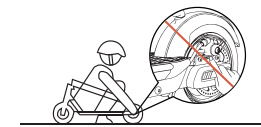

⊗ Don't touch disc brake while riding.



⊗ Don't leave the handlebar with both hands when riding



⊗ No riding under the ponding water area that deeper than 2cm.

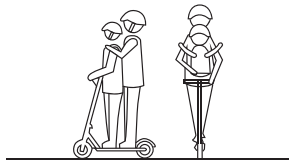

⊗ No riding when more than one person on an electric scooter or with children.

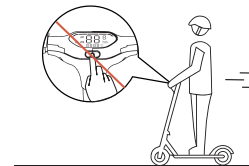

⊗ Do not adjust gears to avoid unnecessary injury when riding.

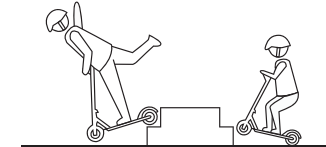

⊗ No jump up and down stairs or obstacles.

Safety instructions

- An electric scooter is a sporting entertainment tool that is not a vehicle, but once you riding it into a public area, there are also potential safety risks. Please strictly follow the instructions in this manual to ride for the maximum to protect you and the others' safety. And ensure your riding is compliance with national and provincial regulations and traffic regulations.
- At the same time, you need to understand, once you have an electric scooter on a public road or other public place, you may be exposed to the risk of unauthorized driving / improper operation of others or vehicles, even if you are in full compliance with this safe riding guide. It is important to be vigilant and maintain the proper speed during driving, and it is important to maintain a reasonable safety distance with others and other transports. Please be vigilant and ride at low speed before entering unfamiliar terrain.
- Please respect the right of pedestrian when riding scooter. Avoid frightening pedestrians, especially the children. When pedestrians passing through, remind pedestrians and slowing down when passing. As far as possible from the pedestrian.
- You must strictly follow the safety requirements of this manual for riders in countries and regions, where there are no national standards and regulations for electric scooters, we shall not be liable for any liability, personal injury, accident, legal dispute, and all other unfavorable events resulting from the use of violating the instructions indicated in this manual.
- Please check the electric scooter for each time before riding. If you find that the parts are loose, the battery life is obviously reduced, the tire is slow to leak or excessive wear, turn to abnormal sound or malfunction, please stop using it immediately and please seek professional guidance or service.
- When use or park the scooter outdoors, please keep it properly and park it in the line of sight. When parking, it is recommended to turn on the app lock function, and use the mechanical lock to lock the scooter frame or tires to avoid stealing.
- Do not change gears or use APP in riding to avoid unnecessary injury.

Chapter 8 Daily Maintenance

Electric scooter cleaning and storage

If there are stains in the body of the electric scooter, wipe it with a small amount of water with a soft cloth. If it is difficult to clean, you can use a toothbrush with toothpaste to scrub it repeatedly and then use a damp cloth to clean it.

Note:

1. Do not use alcohol, gasoline, kerosene or other corrosive, volatile solvents to clean scooter, otherwise it will seriously damage the body and internal structure of scooter. It is forbidden to use pressure gun spray and flush scooter, make sure in shutdown state that the charging cable is unplugged and the rubber cap has been tightened when cleaning, otherwise it may cause electric shock or accident due to water intake.
2. When not in use, try to store the electric scooter indoors in a dry and cool place, and try to avoid outdoor storage for a long time. The outdoor environment of sun exposure, overheating and supercooling will accelerate the appearance and tire aging of the electric scooter, and reduce the service life of the electric scooter and its battery pack.
3. Even the electric scooter is fully charged and not use, you should still charging it every three months to avoid battery over discharge protection.

Electric scooter battery maintenance

1. Do not use other models or brands of batteries, otherwise there may be security risks.
2. Do not touch the battery contacts and do not open the battery compartment to avoid the metal objects to touch the battery contacts, which may cause a short circuit or may damage the battery, or cause personal injury.
3. Only use the original charger for charging, otherwise it may cause damage or fire.
4. Inappropriate disposal of used batteries may result in serious environmental pollution, disposal of waste battery packs must be in accordance with local regulations. Don't litter the battery pack to protect the natural environment.
5. Do not place the battery in a high temperature environment higher than 50°C or lower than -20°C (for example, do not expose the electric scooter or its battery pack in the open air), otherwise it may cause malfunction, fire, or even fire risk.

6. Under the normal working temperature of the scooter, the battery can exert higher mileage and performance. If used in an environment below 0°C, the battery life and performance will decrease. Below -10°C, the mileage may be only half or less.

Note:

It is forbidden for non-professionals to remove the battery pack. Failure to do so may result in serious appliances faults or safety incident.

Disc brakes debug

If you feel the brake is tight when you are riding, you can adjust the disc brake by loosening the screw on the rotary knob with a M5 Allen key (As shown in below picture), turn the rotary knob to the right by a little and tighten the screw with a M5 Allen key. If you feel the brake is loose, you can turn the Rotary knob to the left by a little after loosening the screw on the Rotary Knob with M5 hex wrench, and then tighten the screw.

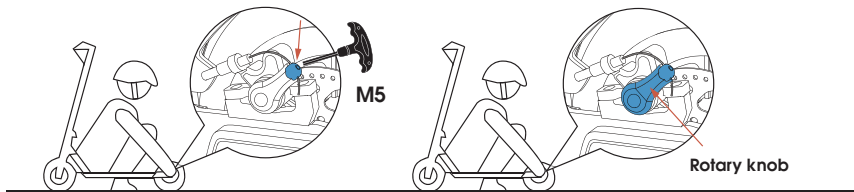

Chapter 9

Specification Parameter Table

Parameters	Description	Specifications
Product Dimensions	LxWxH (MM)	1120X520X1185
	Folding Size LxWxH(MM)	1120X520X530
Weight	Total Scooter (KG)	15
Ride Limits	Rider Weight Maximum (KG)	100
	Rider Age	16-50
	Rider Height (CM)	120-200
Main Parameter	Max Speed (Km/h)	25
	Max Mileage (KM)	≤ 35
	Max Slope (%)	10-15
	Road	Cement, asphalt, flat roads, etc., shall not exceed 1cm steps, and shall not exceed 3cm.
	Working Temperature(°)	-10-40
	Stock Temperature(°)	-20-45
	Charging Temperature	0-40
waterproof level	IPX4	

Parameters	Description	Specifications
Battery Pack	Battery manufacturer	Shenzhen World Electronic Co.,Ltd
	Battery model name	BSJ-30-A
	Rated voltage (VDC)	36
	Maximum Charge Voltage (VDC)	42
	Rated Capacity (Ah)	8
	Protection	Temperature short circuit undervoltage overcurrent overchargeover-discharge
Motor	Rated Power(W)	250
	Max. Power(W)	540
Charger	Charge manufacturer	Shenzhen Fuyuan dian Power Co.,Ltd
	Charge model name	FY0634201500
	Rated Power(W)	63
	Rated Voltage input (VAC)	100-240
	Rated Voltage output(VDC)	42
	Rated Current Output(A)	1.5
	Charging time(H)	6-6.5

Endurance: Electric scooters are fully charged, load is 75kg, ambient temperature is 25 degrees without wind, 18 km/h in safe mode Kilometers. However, the actual cruising range varies with driving habits, roads, ambient temperature, wind speed or other factors.

Note:Data and parameters vary by mode. Subject to change without notice.

Cruise control:is not recommended to enable this function when the speed is over than 18km/h, crooked road, crowded and vehicles, rain and snow weather.

Chapter 10 Warranty

Limited Warranty To Qualify for warranty service:

- 1.This product cannot be used for rental or commercial use.
- 2.This product cannot be used for competition.

LIMITATIONS OF LIABILITY

- This Limited 1 Year Warranty is non-transferable after the product's initial sale.
- No unapproved modifications can be made to the product, its performance, or otherwise, in order for this Limited 1 Year Warranty to remain in effect.
- No reimbursement is provided for towing, loss of time, loss of use, inconvenience, incidental or consequential damages.
- Warranty is void if weather-related water damage is determined. The owner is responsible for storage and protection from the weather.
- TOMOLOO makes no warranty with respect to products or trade accessories not made by Tomoloo, including, but not limited to, motors, tires, wheels and batteries, such products or trade accessories, such items being subject to the original manufacturer's warranty, if any.
- This Limited 1 Year Warranty does not cover minor surface blemishes, rips, tears, or other cosmetic damages due to normal use, or other intentional or unintentional damage to the product.
- This Limited 1 Year Warranty will not cover any damage which results from the application of improper cleaners, solvents, or chemicals to the product, water damage, smoke or soot, or from exposure to the saltwater, sea breeze, or salt.
- This Limited 1 Year Warranty will not cover any damage which results from aging, such as fading of paint, deterioration of plated surfaces, deterioration of rubber or plastics, or rusting.
- This Limited 1 Year Warranty does not cover improper repair or misdiagnoses of problems.
- This Limited 1 Year Warranty only covers parts due to manufacturer defect.
- Damage due to misuse or neglect, use other than as specified in the Owner's Manual, or use under abnormal conditions are not covered by this Limited 1 Year Warranty.

OWNER'S WARRANTY RESPONSIBILITIES

As the device's owner, you are responsible for the performance of the required maintenance. You may be denied a warranty claim solely because of your failure to ensure the performance of all scheduled maintenance. As the owner, you should be aware that you may be denied your warranty coverage if your device or a part has failed due to abuse, neglect, improper maintenance, or unapproved modifications. For any issue regarding your TOMOLOO product, contact email: Service@tomoloo.com

If you have any product questions, or you have any product issues, please contact our e-mail: Service@tomoloo.com

WARRANTY INFORMATION:

The 1-year limited warranty covers only parts due to manufacturer defect for one year from the date of purchase. The warranty is non-transferable from the original purchaser. The warranty does not cover minor surface blemishes, rips, tears, or other cosmetic damages due to normal use, or other intentional or unintentional damage to the device. The warranty does not cover any damage which results from the application of improper cleaners, solvents or chemicals to the Product, water damage, smoke or soot, or from exposure to saltwater, sea breeze or salt. The warranty does not cover improper repair or misdiagnoses of the problem. If you believe your product needs any repair or you have questions, please contact our e-mail: service@tomoloo.com

Our engineers will check whether the returned product complies with our repair policy and please note if it exceeds 3 months from the purchase date, all the repair human fees and replaces parts cost and all shipping fees need to be taken by customers. But those core parts excluded. The controller, motor, and battery can be replaced for free within 6 months from the purchase date but the human fees and shipping fees still need to be taken by customers. Order exceeds more than 6 months, the buyer needs to afford all the replacement parts cost, repair fee, and shipping cost. If you need the item to be repaired, we will check the item after we receive it and confirm the details of the repair fee, replacement parts cost, and shipping fees. Please note that appearance parts, rubber parts, and tires are vulnerable parts and are not covered by the warranty.

***Please refer to the Product manual for full warranty coverage and specifications.**

Name _____ Address _____ Order number _____
Email _____ Product Model _____ Phone _____

Your signature below acknowledges that you have read, fully understand, and accept this limited warranty agreement.

Signature _____ Date _____

Scan and email this warranty card to service@tomoloo.com

Chapter 11 APP Download Guide

Install TOMOLOO APP

Scan the QR code with your mobile phone, or search for TOMOLOO in the App Store, download and install the APP.

If you have downloaded TOMOLOO APP on your mobile phone, please make sure that the APP version is the latest one.



TOMOLOO APP

Add Device

1. Connect your phone to a WiFi or Cellular Data network.
2. Open the TOMOLOO APP, and please register/log in your account according to the APP guidance when using it for the first time.
3. Enter the homepage of APP, then enter the "select vehicle" page according to the guide. Select "NEW L1 PRO" in the Electric Skateboard series.
4. Turn on the scooter and your mobile phone Bluetooth, then scan and connect your scooter.
5. After completion, the device is added successfully. Click the device on the home page of APP and enter the device control interface to control the device.

and Function Introduction

This product has been connected to TOMOLOO and can be controlled with the TOMOLOO APP.

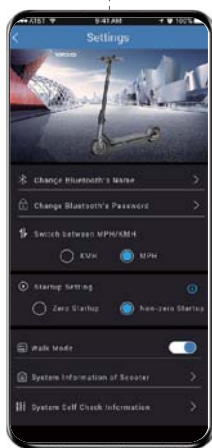

TOMOLOO
Go any where

This device complies with part 15 of the FCC Rules. Operation is subject to the following two conditions: (1) this device may not cause harmful interference, and (2) this device must accept any interference received, including interference that may cause undesired operation.

Any changes or modifications not expressly approved by the party responsible for compliance could void the user's authority to operate the equipment.

NOTE: This equipment has been tested and found to comply with the limits for a Class B digital device, pursuant to Part 15 of the FCC Rules. These limits are designed to provide reasonable protection against harmful interference in a residential installation. This equipment generates, uses and can radiate radio frequency energy and, if not installed and used in accordance with the instructions, may cause harmful interference to radio communications. However, there is no guarantee that interference will not occur in a particular installation.

If this equipment does cause harmful interference to radio or television reception, which can be determined by turning the equipment off and on, the user is encouraged to try to correct the interference by one or more of the following measures:

- Reorient or relocate the receiving antenna.
- Increase the separation between the equipment and receiver.
- Connect the equipment into an outlet on a circuit different from that to which the receiver is connected.
- Consult the dealer or an experienced radio/TV technician for help.

The device has been evaluated to meet general RF exposure requirement. The device can be used in portable exposure condition without restriction