

# Getting to know your SOUND TABLE SPEAKER

User's Guide for Model AT600



## Important Safety Instructions

- Read these Instructions.
- Keep these Instructions.
- Heed all Warnings.
- Follow all instructions.
- Do not use this apparatus near water.
- Clean only with a dry cloth.
- Do not block any ventilation openings. Install in accordance with the manufacturer's instructions.
- Do not install near any heat sources such as radiators, heat registers, stoves, or other apparatus (including amplifiers) that produce heat.
- Do not defeat the safety purpose of the polarized or grounding - type plug. A polarized plug has two blades with one wider than the other. A grounding type plug has two blades and a third grounding prong. The wide blade or the third prong are provided for your safety. When the provided plug does not fit into your outlet, consult an electrician for replacement of the obsolete outlet.
- Protect the power cord from being walked on or pinched particularly at plugs, convenience receptacles, and the point where they exit from the apparatus.
- Only use attachments/accessories specified by the manufacturer.
- Unplug this apparatus during lightning storms or when unused for long periods of time.
- Refer all servicing to qualified service personnel. Servicing is required when the apparatus has been damaged in any way, such as power-supply cord or plug is damaged, liquid has been spilled or objects have fallen into the apparatus, the apparatus has been exposed to rain or moisture, does not operate normally, or has been dropped.
- Use only with a cart, stand, tripod, bracket, or table specified by the manufacturer, or sold with the apparatus. When a cart is used, use caution when moving the cart/apparatus combination to avoid injury from tip-over.



## FCC Warnings

Warning: Changes or modifications to this unit not expressly approved by the party responsible for compliance could void the user's authority to operate the equipment.

NOTE: This equipment has been tested and found to comply with the limits for a Class B digital device, pursuant to Part 15 of the FCC Rules. These limits are designed to provide reasonable protection against harmful interference in a residential installation. This equipment generates, uses, and can radiate radio frequency energy and, if not installed and used in accordance with the instructions, may cause harmful interference to radio communications. However, there is

no guarantee that interference will not occur in a particular installation. If this equipment does cause harmful interference to radio or television reception, which can be determined by turning the equipment off and on, the user is encouraged to try to correct the interference by one or more of the following measures:

- Reorient or relocate the receiving antenna.
- Increase the separation between the equipment and receiver.
- Connect the equipment into an outlet on a circuit different from that to which the receiver is connected.
- Consult the dealer or an experienced radio/TV technician for help.

## Additional Warnings and Precautions

- **CAUTION:** TO PREVENT ELECTRIC SHOCK, MATCH WIDE BLADE OF PLUG TO WIDE SLOT, FULLY INSERT.
- Mains plug is used as disconnect device and it should remain readily operable during intended use. In order to disconnect the apparatus from the mains completely, the mains plug should be disconnected from the mains socket outlet completely.
- **WARNING:** Shock hazard - Do Not Open.
- **CAUTION:** Use of controls or adjustments or performance of procedures other than those specified may result in hazardous radiation exposure.
- **WARNING:** Changes or modifications to this unit not expressly approved by the party responsible for compliance could void the user's authority to operate the equipment.
- **WARNING:** Do not place this unit directly onto furniture surfaces with any type of soft, porous, or sensitive finish. As with any rubber compound made with oils, the feet could cause marks or staining where the feet reside. We recommend using a protective barrier such as a cloth or a piece of glass between the unit and the surface to reduce the risk of damage and/or staining.
- **WARNING:** Do not ingest battery, chemical burn hazard.
- Battery shall not be exposed to excessive heat such as sunshine, fire or the like.
- Lithium batteries, like all rechargeable batteries, are recyclable and should be recycled or disposed of according to state and local guidelines. They should never be disposed of in normal household waste and they should never be incinerated, as they might explode. Contact your local government for disposal or recycling practices in your area.

This device complies with part 15 of the fcc rules.

Operation is subject to the following two conditions:

- 1) This device may not cause harmful interference, and
- 2) This device must accept any interference received, including Interference that may cause undesired operation.



**WARNING:** To reduce the risk of electric shock, do not remove cover (or back). No user-serviceable parts inside. Refer servicing to qualified service personnel.



The exclamation point within an equilateral triangle is intended to alert the user to the presence of important operating and maintenance (servicing) instructions in the literature accompanying the appliance.



The lightning flash with arrowhead symbol, within an equilateral triangle, is intended to alert the user to the presence of un-insulated "dangerous voltage" within the product's enclosure that may be of sufficient magnitude to constitute a risk of electric shock to persons.



This symbol indicates that this product incorporates double insulation between hazardous mains voltage and user accessible parts.



**WARNING :** This product can expose you to chemicals including lead, which is known to the State of California to cause cancer. For more information go to: [www.P65Warnings.ca.gov](http://www.P65Warnings.ca.gov) This product meets and complies with required Federal product guidelines.

## RF Exposure

The equipment complies with FCC radiation exposure limits set forth for an uncontrolled environment. This device should be installed and operated with minimum distance 20cm between the radiator & your body.

## Assemble Steps:

1. Open the gift box, put the speaker on the table and the fixing hole upwards.
2. Take on from wooden tripod and match it with one fixing hole.
3. Rotate it clockwise until tightly fixed.
4. To fix the left two with the same procedure.
5. The wooden tripod is well fixed.
6. Put the speaker on the ground.

## Warning:

1. The maxium bear weight of this product is 5KG, the consumers couldn't put any item more than 5KG on this product, otherwise, the consumers will bear the damage to this product by themselves.
2. This product couldn't be used as seat, no matter adult, or children, otherwise, the consumers will have to bear by themselves the damage to this product, and the damage to your health.

## 1 Align table leg with screw hole, Tighten clockwise.

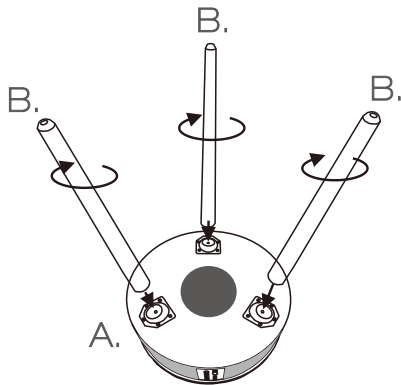

## Accessories

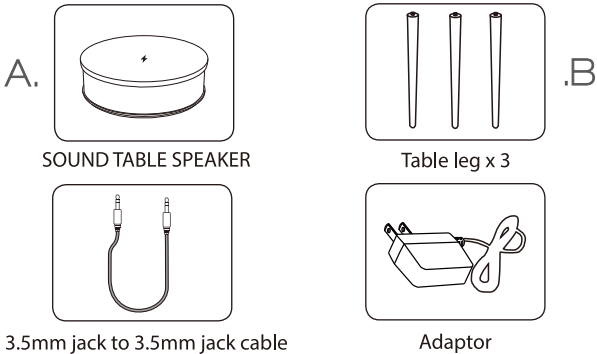

## 2 Enjoy Music~

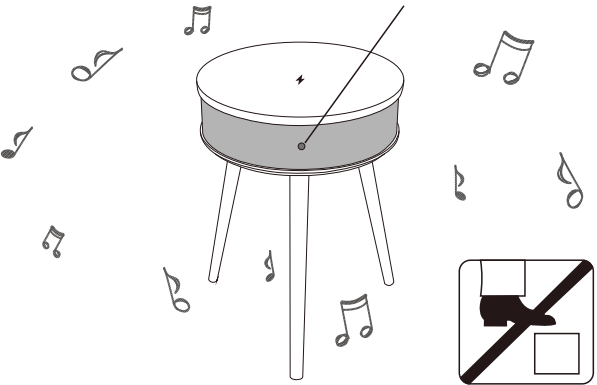

## Powering The Speaker

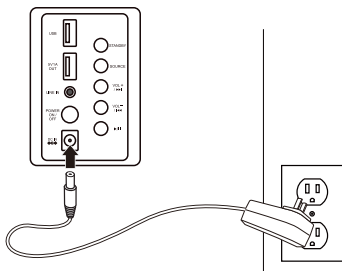

To power the unit, connect the DC power input on the table to a standard power outlet using the included AC/DC power adapter.

## Function Description

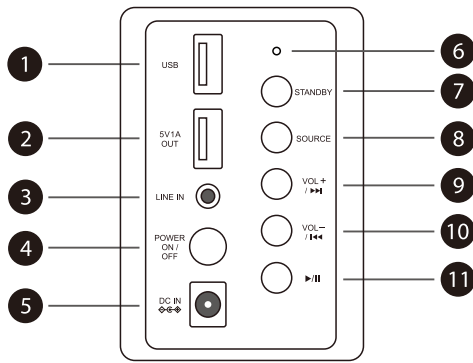

- 1. USB input (Mp3 playback)**
- 2. DC 5V USB charging port**
- 3. 3.5mm Line input**
- 4. Power:** Press to switch the unit on or off
- 5. DC jack in**
- 6. Charging LED**
- 7. STANDBY**
- 8. Source:** Press to select an input: Wireless, USB, LINE in
- 9. Volume+ :** Press 3 seconds to adjust the volume up  
▶▶: In Wireless/USB mode, Press 1 second to skip forward one track
- 10. Volume- :** Press 3 seconds to adjust the volume down  
◀◀: In Wireless/USB mode, press 1 second to skip back one track
- 11. ▶/II Play/Pause:** In Wireless mode, press to play or pause a track  
Press and hold seconds to disconnect the Wireless.

Table Speaker Indicators

STATUS	INDCATOR
Power ON	Red Light
USB Mode	White Light
Line In Mode	Green Light
Wireless Pairing	Flashing Blue Light
Wireless Connected	Blue Light
Low Battery	Flashing Red Light

## Wireless Audio

### Pairing & Playing Audio

- When first powered on, the speaker defaults to Wireless Mode and is ready to pair automatically. When pairing, remain within 3 feet of the unit.
- Using the controls on your Wireless device, select **AT600** in the Wireless settings to pair. When successfully paired, a voice will announce the connection.
- Use the controls on the connected Wireless device to select and play audio. Use the speaker controls or the connected Wireless device to play pause, and adjust the volume level.
- After initial pairing, the speaker will automatically connect to the last Wireless device used whenever it is in Wireless Mode. Note: If your device should become unpaired or you find it is unable to connect, press and hold the **Play** button to enter Pairing Mode. A voice will announce, "Wireless is connecting," and you can connect to the speaker manually.

## LINE IN

Requires a 3.5mm audio cable(included).

- Connect a 3.5mm audio cable to the **LINE IN** on the unit and the **audio output/headphone jack on an audio device**.
- Press **Power/Source** to switch to **LINE IN** mode.
- Use the controls on the connected device to select and play audio,

**Note:** Newer phone models may require an adapter (lightning to 3.5mm headphone adapter for iPhone) or (USB-C to 3.5mm audio adapter) for android.

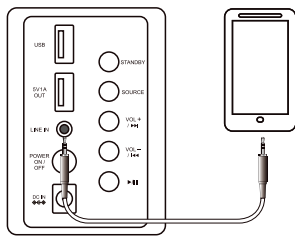

## Party Plus Mode

If you have another AT600 table speaker, you can pair and play the two speaker together for a surround sound effect.

- To enter Party Plus Mode, please make sure the unit is in Wireless mode. Press and hold the **SOURCE** button for 5 seconds on one of the tables, When a beep indicate the Party plus is under pairing. Then do the same on the other table. Whichever table you activate Party Plus Mode on first is now the primary unit.
- When successfully connected to party plus two beeps will issue from speaker.
- To disconnect the speakers, press and hole the **SOURCE** button for 5 seconds on one of the two units. When three beeps heard, Party Plus was disconnected.

**Note:** To use Party Plus Mode, please make sure that you connect the speakers before pairing to your Wireless device. You will not be able to connect the speakers if you are already paired to a Wireless device.

## USB Playback

- Load a USB drive in to the USB Media port. The speaker will automatically switch to USB mode, solid cyan light when in USB mode, and begin playing media on the drive.
- Use the controls on the speaker to select and play audio from the connected drive.

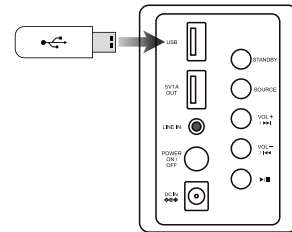

## USB Charging Port

Plug your USB charging cable (not included) into the USB Charging Port on the table and the other end into your device and the device will begin charging.

**Note:** The USB charging port is for charging mobile devices.

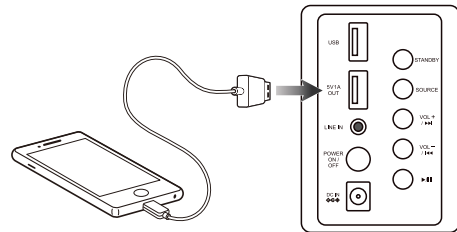

## Wireless Charging

Place your phone onto the **Power Pad** to begin charging.

**Note:** you may need to remove your phone case in order to begin charging.

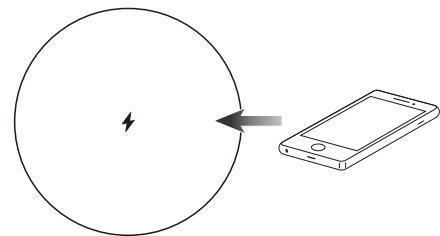

## Technical Specification

Power source	INPUT : DC 15V --- 1.5A
Wireless charging	OUTPUT : 10W MAX
USB charging	OUTPUT : DC 5V 1A
Dimiensions	400x400x568mm