

USER’S MANUAL

Headphone

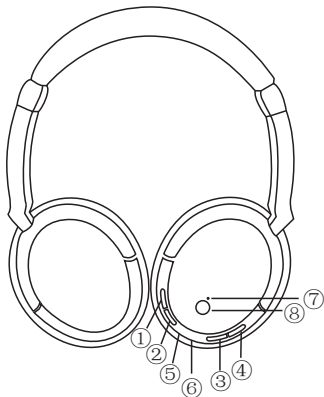

- 1. FM (SCAN)
- 2. WL (Wireless headphone)
- 3. Volume-
- 4. Volume +
- 5. Charging socket
- 6. Audio-in
- 7. Indicator
- 8. ON/OFF

Transmitter



- 9. Audio-in (3.5mm)
- 10. USB plug (5 Volt Power)

Package include

Headphone	1
Transmitter	1
User’s manual	1
3.5mm Aux cable	1
USB charging cable	1
RCA Audio cable	1(Optional)

Operation

Wireless Headphone

- 1. The transmitter's USB plug inserted into the power supply device. (The device should have 5V USB socket, or use the high quality adaptor.)
- 2. Using the aux cable or audio cable connect the transmitter and audio source device. (The device should have 3.5mm audio-out socket or RCA audio-out socket, such as TV, PC, MP3 player, etc.)

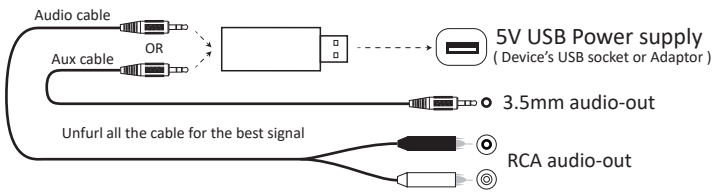

- 3. After install transmitter, pressing the headphone power button(8). It will receive the sound from transmitter. (If you are listening the FM radio, press the wireless headphone button(2) to turn to the transmitter signal.)

FM Radio

Press the power button(8) to “ON”. then press the button(1)“SCAN” in turn to search a higher range and lock one radio channel.

Wired Headphone

Using aux cable plug into headphone’s audio-in socket. It can be use as wired headphone. (If you use the headphone as wired headphone, the buttons are useless.)

Charge Headphone

Using charge cable plug into headphone’s charging socket. If the indicator is red color, it is charging. When charge complete, the indicator will off.

Use diagram

Wireless Headphone

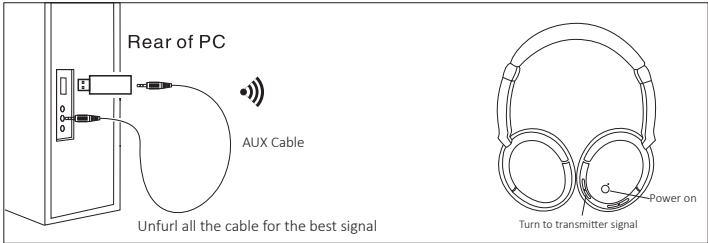
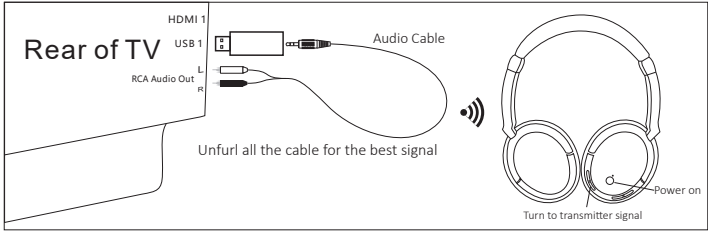

- 1. If you hear the current voice, you can change other power supply. Such as other USB socket of device, 5V adaptor, powerbank,etc.
- 2. If you hear the FM noise loudly, you can turn up the source device volume and press the headphone button(3) to turn down headphone volume.

Wired Headphone

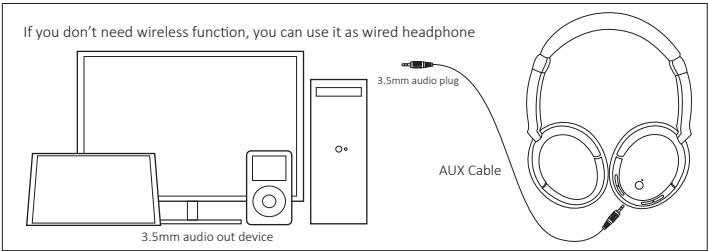

Specification

Headphone

Reception Mode	: Stereo FM
Reception Frequency	: 88-108Mhz
Speaker Size	: 40mm
Speaker Impedance	: 32Ω
Distortion	: ≤ 1%
Power Supply	: Li-polymer battery
Battery Capacity	: 180mAh
Play Time	: ≥ 8h
Charging Socket	: Micro USB socket
Charging Time	: 1.5h
Charging Voltage	: 5V
Audio-in Socket	: 3.5mm audio socket

Transmitter

Transmit Mode	: Stereo FM
Transmit Frequency	: 88.1Mhz
Transmit Range	: ≤ 30m
Power Supply	: 5V USB Plug
Audio-in Socket	: 3.5mm audio socket

Note

- 1.The transmitter is easy to interference. If you hear the current voice, please change transmitter’s position or power supply.
- 2.Recharge the headphone if it reception is poor.
- 3. If you hear the FM noise loudly, you can turn up the source device Volume and press the headphone button(3) to turn down headphone Volume.
- 4.If you hear the headphone distortion, please turn down the source device volume.
- 5.Please unplug the headphone, when it charging complete.
- 6.Unfurl all the cable for the best signal

正

反

FCC Caution:

This device complies with part 15 of the FCC Rules. Operation is subject to the following two conditions: (1) This device may not cause harmful interference, and (2) this device must accept any interference received, including interference that may cause undesired operation.

Any Changes or modifications not expressly approved by the party responsible for compliance could void the user's authority to operate the equipment.

Note: This equipment has been tested and found to comply with the limits for a Class B digital device, pursuant to part 15 of the FCC Rules. These limits are designed to provide reasonable protection against harmful interference in a residential installation. This equipment generates uses and can radiate radio frequency energy and, if not installed and used in accordance with the instructions, may cause harmful interference to radio communications. However, there is no guarantee that interference will not occur in a particular installation. If this equipment does cause harmful interference to radio or television reception, which can be determined by turning the equipment off and on, the user is encouraged to try to correct the interference by one or more of the following measures:

- Reorient or relocate the receiving antenna.
- Increase the separation between the equipment and receiver.
- Connect the equipment into an outlet on a circuit different from that to which the receiver is connected.
- Consult the dealer or an experienced radio/TV technician for help.

The device has been evaluated to meet general RF exposure requirement. The device can be used in portable exposure condition without restriction.