

## LIGHT ASSEMBLY DIAGRAM

48 Watts

Thank you for purchasing your Christmas tree. The instructions below will help you quickly and easily set up your new tree.

1. Find a level surface near an electrical outlet and assemble the tree stand as shown in **Fig. A**.

**Fig. A - Tree Stand Assembly**

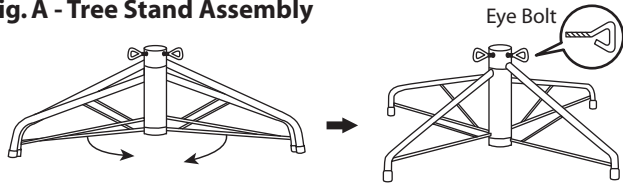

1. Pull apart the legs of the stand so that they are x-shaped.
2. When inserting the bottom section of the tree into the assembled stand, thread the eyebolt into the stand and tighten until the pole is firmly secured.

**Fig. B - Tree and Lights Assembly**

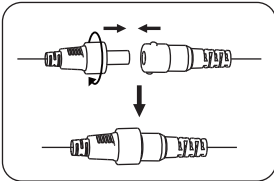

**\*Electrical Rating For The Tree  
(For Indoor Use Only)**

Input: AC 120V, 60Hz, 0.83A  
Output: DC 24V, 2A  
Controller: 2A

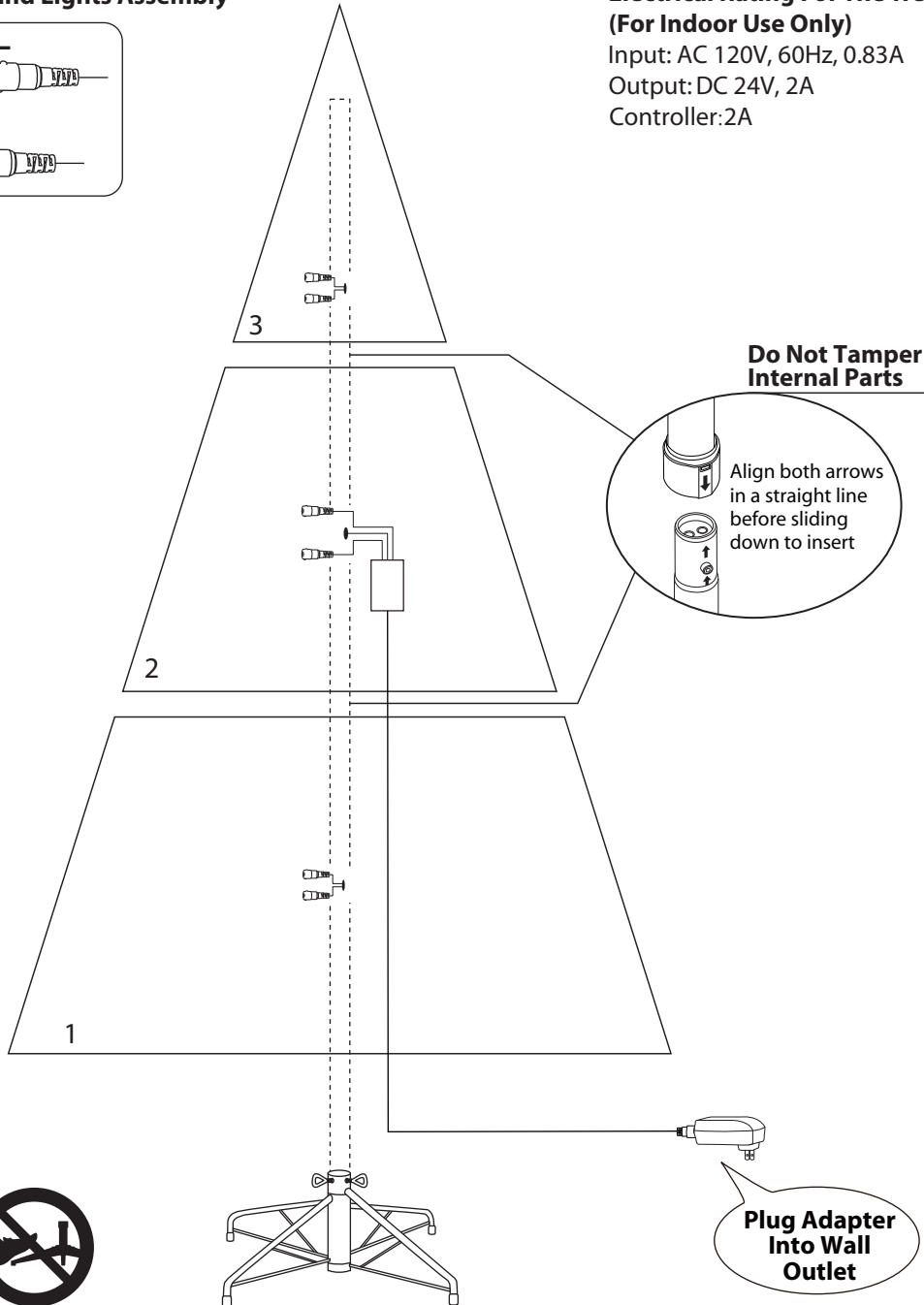

2. Identify all tree sections (**See Fig. B**) by the tags on them, and start assembling from bottom to top.
3. Insert the pole into the stand. Allow all branches fall down into place. Check to make sure that all wires are free from branch hinges.
4. Shape the tree section one branch at a time. Start with the tips closest to the pole and move outwards. Fan all the tips out in alternating directions, and slightly upsweep them for a natural look (**See Fig. C**).

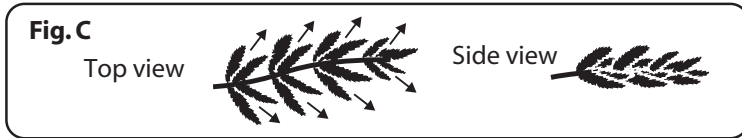

5. Repeat **Step 4 and 5** for the upper tree section(s) until tree top is installed and shaped.
6. Connect plug with adapter, and plug it in to the wall outlet as indicated in **Fig. B**.
7. Step back and view your tree. Shift branches to fill any gaps. Your Christmas tree is now ready to be decorated.

## STORAGE INSTRUCTIONS

1. Unplug adapter from the wall outlet first and then remove all ornaments and decorations.
2. Disassemble the tree from the top to the bottom. Start with the tree top and gently lift straight up to remove from section below and fold all branches toward the pole.
3. Continue by gently lifting each section straight up from the section below. Fold all branches toward the pole until the bottom section is removed from the tree stand.
4. Carefully place all tree sections into the storage bags within the shipping box(es) and tape the box(es) shut.
5. When not in use, please store your tree in a cool, dry place away from sunlight. Exposing your tree to excessive heat or humidity may damage your tree.

## TROUBLESHOOTING TIPS

### If Tree Does Not Illuminate / Some Bulbs Do Not Light or Flicker

1. Please check to make sure that all plugs are properly connected and adapter is plugged into the wall outlet.
2. Turn the poles gently to make sure pole to pole sections are connected properly
3. Check for loose connection between light string plugs and extension cords.

### Loose Hinge Pin

1. Extra hinge pins are included for repairing the hinges of the branches. Place the branch into the slot of the bracket.
2. Insert a new hinge pin through the hole and secure using the retainer washer. (**See Fig. D**)

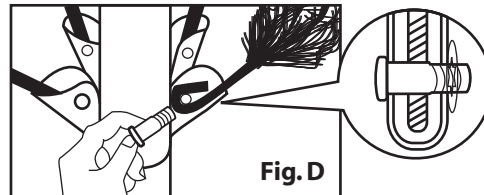

## SPARE PARTS

This tree includes spare hinge pins and washers.

## CAUTION

1. To reduce the risk of fire and electric shock:
  - a) Use only the power supply that was provided with this product. Using a different adapter will damage the lights and may cause fire, or electrical shock hazards.
  - b) Do not install on trees having needles, leaves or branch coverings of metal or materials which look like metal.
  - c) Do not mount or support strings in a manner that can cut or damage wire insulation.
2. The controller and remote controller (if included) can only be used with this product.

## REMOTE CONTROL INSTRUCTIONS

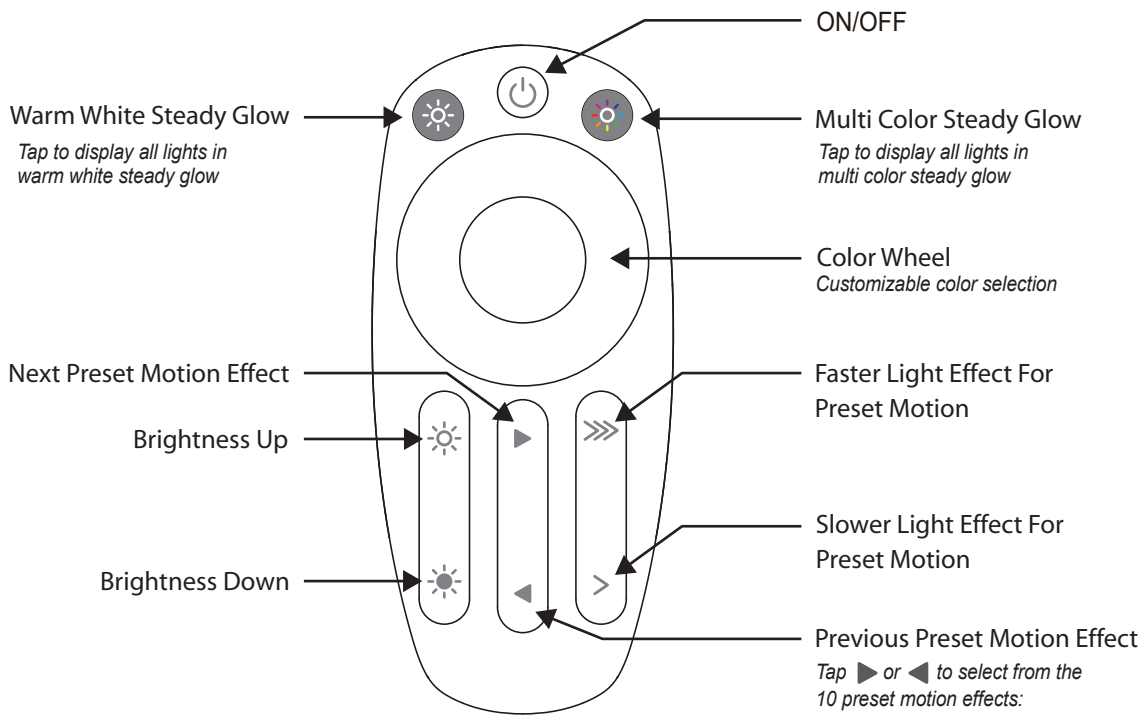

### NOTE:

In case the light motion effects keep switching to the next one every 30 seconds and continues to cycle, this means the Demo mode is on.

To cancel the Demo mode, simply press and hold the ☀ (Brightness Down) button and the > (Slower Speed) button together for 10 seconds.

### Battery Replacement

1. Slide open the battery cover.
2. Replace with a new CR2032 button cell battery with correct polarities (+/-) as indicated.
3. Slide the battery cover closed.

### ⚠ WARNING

1. Small parts, keep away from children.
2. Do not expose the product to moisture.
3. Remove batteries when not used for an extended period of time, or when depleted.
4. Dispose of used batteries properly, and local laws and regulations regarding the disposal of hazardous waste.
5. Use only CR2032 batteries for the remote controller.
6. Clean the battery contact surfaces gently prior to battery installation.
7. Do not dispose of batteries in fire. Batteries may explode or leak.
8. This product is powered by a lithium battery. Due to their small size, lithium batteries can easily be swallowed by children. Ingestion of such batteries has been known to cause death.
9. This is a lithium battery which if swallowed has been known to cause death.

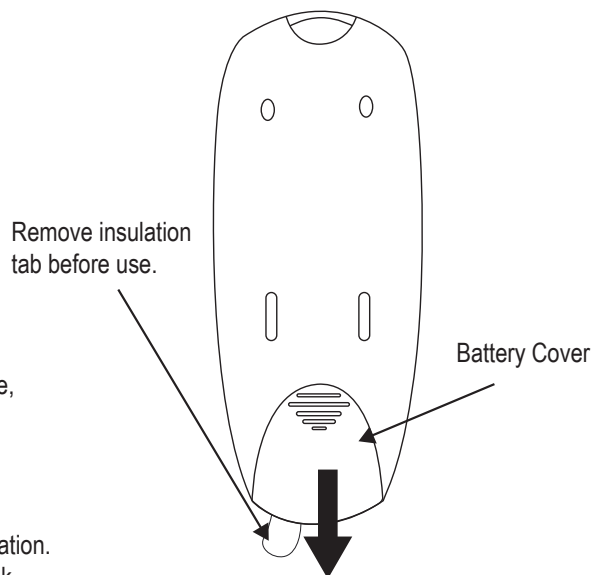

**WARNING:** This product may potentially trigger seizures for people with photosensitive epilepsy when using the motion effect light modes.

### **FCC Caution:**

Any Changes or modifications not expressly approved by the party responsible for compliance could void the user's authority to operate the equipment.

This device complies with part 15 of the FCC Rules. Operation is subject to the following two conditions: (1) This device may not cause harmful interference, and (2) this device must accept any interference received, including interference that may cause undesired operation.

### **IMPORTANT NOTE:**

Note: This equipment has been tested and found to comply with the limits for a Class B digital device, pursuant to part 15 of the FCC Rules. These limits are designed to provide reasonable protection against harmful interference in a residential installation. This equipment generates, uses and can radiate radio frequency energy and, if not installed and used in accordance with the instructions, may cause harmful interference to radio communications. However, there is no guarantee that interference will not occur in a particular installation. If this equipment does cause harmful interference to radio or television reception, which can be determined by turning the equipment off and on, the user is encouraged to try to correct the interference by one or more of the following measures:

—Reorient or relocate the receiving antenna.

—Increase the separation between the equipment and receiver.

—Connect the equipment into an outlet on a circuit different from that to which the receiver is connected.

—Consult the dealer or an experienced radio/TV technician for help.

### **ISED Warning**

This device complies with Innovation, Science, and Economic Development Canada licence-exempt RSS standard(s). Operation is subject to the following two conditions:

(1) this device may not cause interference, and

(2) this device must accept any interference, including interference that may cause undesired operation of the device.

Le présent appareil est conforme aux CNR d'Innovation, Sciences et Développement économique Canada applicables aux appareils radio exempts de licence. L'exploitation est autorisée aux deux conditions suivantes :

(1) l'appareil n' doit pas produire de brouillage, et

(2) l'utilisateur de l'appareil doit accepter tout brouillage radioélectrique subi, même si le brouillage est susceptible d'en compromettre le fonctionnement.

The device is compliance with RF exposure guidelines, users can obtain Canadian information on RF exposure and compliance.

Le présent appareil est conforme Après examen de ce matériel aux conformité ou aux limites d'intensité de champ RF, les utilisateurs peuvent sur l'exposition aux radiofréquences et la conformité and compliance d'acquérir les informations correspondantes.