

## Wireless Charger instruction manual

Thanks you for choosing to purchase our company's wireless charging products. The equipment should support Qi standard).Please read this manual carefully before using the product.

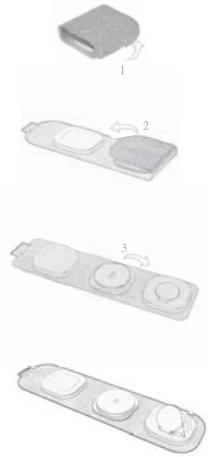

## Specifications

Input	DC 5V/2A 9V/2A 12V/2A
Phone Output	5W /7.5W / 10W/15W (Max)
Watch Output	2.5W
Earphone Output	3W
Product Standard	Qi
Charging Efficiency	≥70%
Charging Distance	≤8mm
Connector	Type-C
Frequency	111-205KHz

## Tip:

- 1: It is recommended to use PD or QC 3.0 adapter.
- 2: When using the power adapter, please make sure that the cable is fully inserted into the power adapter before plugging the adapter into the power outlet.
- 3: Please do not use this product in a high temperature, humid environment, please stay away fire and water.
- 4: When using this product, please do not please the metal foreign objects (Such as keys, coin, batteries, chip card or jewelry etc.) on the charging pad when charging, o avoid damage
- 5:Dot not dissembles this product at will.

FC CE RoHS

## 无线充使用说明书

感谢您选购我公司的无线充电产品。  
(设备支持Qi标准)。使用本产品前请仔细阅读本说明书。  
祝您生活愉快!

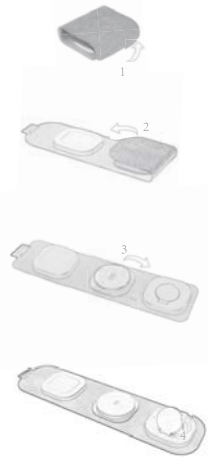

## 产品规格:

输入	DC 5V/2A 9V/2A 12V/2A
手机输出	5W /7.5W / 10W/15W (Max)
手表充输出	2.5W
耳机输出	3W
无线充标准	Qi
充电效率	>70%
传输距离	≤8mm
产品接口	Type-C
工作频率	111-205KHz

## 提示:

- 1: 建议使用PD或QC 3.0适配器。
- 2: 使用电源适配器时，在将适配器插入电源插座之前，请确保链接线已完全插入电源适配器。
- 3: 请勿在高温、潮湿环境下使用本产品，请远离火源、和水。
- 4: 使用本产品时，请勿在其上放置金属异物(如钥匙、硬币、电池、芯片卡或首饰等)，以免造成充电异常或者发烫的情况;也会导致无线充电器损坏。
- 5:请勿随意拆卸本产品。

FC CE RoHS

This device complies with part 15 of the FCC Rules. Operation is subject to the following two conditions: (1) this device may not cause harmful interference, and (2) this device must accept any interference received, including interference that may cause undesired operation.

Any changes or modifications not expressly approved by the party responsible for compliance could void the user's authority to operate the equipment.

NOTE: This equipment has been tested and found to comply with the limits for a Class B digital device, pursuant to Part 15 of the FCC Rules. These limits are designed to provide reasonable protection against harmful interference in a residential installation. This equipment generates, uses and can radiate radio frequency energy and, if not installed and used in accordance with the instructions, may cause harmful interference to radio communications. However, there is no guarantee that interference will not occur in a particular installation. If this equipment does cause harmful interference to radio or television reception, which can be determined by turning the equipment off and on, the user is encouraged to try to correct the interference by one or more of the following measures:

- Reorient or relocate the receiving antenna.
- Increase the separation between the equipment and receiver.
- Connect the equipment into an outlet on a circuit different from that to which the receiver is connected.
- Consult the dealer or an experienced radio/TV technician for help.

#### Radiation Exposure Statement

This device complies with FCC RF radiation exposure limits set forth for an uncontrolled environment. This transmitter must not be co-located or operating in conjunction with any other antenna or transmitter. During the operation of device a distance of 15 cm surrounding the device and 20 cm above the top surface of the device must be respected.