

110.04 mm

-5-

80.01 mm

蓝牙

Warning: Changes or modifications to this unit not expressly approved by the party responsible for compliance could void the user's authority to operate the equipment.

NOTE: This device complies with part 15 of the FCC Rules. Operation is subject to the following two conditions: (1) This device may not cause harmful interference, and (2) this device must accept any interference received, including interference that may cause undesired operation.

FCC Statement: This equipment has been tested and found to comply with the limits for a Class B digital device, pursuant to part 15 of the FCC Rules. These limits are designed to provide reasonable protection against harmful interference in a residential installation. This equipment generates, uses and can radiate radio frequency energy and, if not installed and used in accordance with the instructions, may cause harmful interference to radio communications. However, there is no guarantee that interference will not occur in a particular installation. If this equipment does cause harmful interference to radio or television reception, which can be determined by turning the equipment off and on, the user is encouraged to try to correct the interference by one or more of the following measures:

- Reorient or relocate the receiving antenna.
- Increase the separation between the equipment and receiver.
- Connect the equipment into an outlet on a circuit different from that to which the receiver is connected.
- Consult the dealer or an experienced radio/TV technician for help.

[Product warranty certificate]

Thank you very much for choosing our products, your choice will be our continuous and support! All along, under the principle of customer first, we continue to improve every detail of the product, strive to improve performance technology and establish a humanized after-sales service system, always will User needs are the starting point for everything.

warranty terms

From the date of sale, the mouse can enjoy a 12-month free warranty in case of hardware failure under normal use. If it belongs to the following factors, the warranty will not be granted, and the company will have the right to charge maintenance fees if maintenance services are required.

1. Accidents, earthquakes, fires, floods, lightning or other natural disasters, unauthorized product repairs
2. Damage caused by remodeling.
3. Repaired or attempted to be repaired by unauthorized persons.
4. Physical damage, including damage caused by the user moving or installing the product.
5. Caused by the use of substitutes or components that do not meet technical specifications
6. Normal wear and tear.
7. Other reasons unrelated to product quality

USER MANUAL

Please read the manual first, thank you



QUICK START GUIDE

-1-

80.01 mm

—、How to use bluetooth

step 1: (power on)
When the switch is turned on, the blue indicator light in the middle of the bottom of the mouse will flash once. If it does not flash, please charge the mouse for 2-4 hours before proceeding to the next step.

step 2: (Start pairing state - two methods below)
Method 1: Press and hold (the mouse wheel key + the right mouse button) at the same time for 3-5 seconds until the indicator light flashes continuously at the bottom of the mouse, then the mouse enters the pairing state
Method 2: Long press the pairing key at the bottom of the mouse for 2-3 seconds, until the indicator light flashes continuously at the bottom of the mouse, and the mouse enters the pairing state. Method 1: This is a general pairing method.
Method 2: Only for models with a pair of keys at the bottom

step 3: (Pairing connection - Bluetooth on method - see page 2)
Turns on the Bluetooth function of the device to search, find Bluetooth mouse and click connect, you can use it. Generally, no password is required. If prompted to enter a password, please try 0000

Precautions:
1.1. When using such wireless devices, please try to stay away from strong sources of interference, such as wireless WIFI home microwave ovens, etc.
2.2. If the mouse is found to be dirty after using it for a long time, it can be wiped with a small amount of non-alcoholic alcohol, and it must not be placed in liquid for cleaning.

Specifications

Rated working current : <10mA
Sensitivity can be adjusted : 1200/1400/1600 Wireless frequency : 2402-2480MHz
operating system : Windows Android MAC OS

pay attention: This product is a silent and silent charging mouse, using a non-light engine, there is no light when using it; it is not recommended to use a mobile phone charger for charging, use the data cable provided to you to directly plug it into a computer or a mobile power supply to charge. That's it.
If the bottom switch is toggled to ON, the indicator does not light up, please let the indicator charge to solve the problem.

【About charging】 : It takes about 2-4 hours to fully charge, the indicator light is on when charging, and the indicator light is off when fully charged
We send you a data cable, one end is connected to the USB port of the computer, and the other end is connected to the mouse. It can be used for about a month when fully charged, depending on the intensity of personal use.

【About DPI】 : Below the scroll wheel is the DPI button, you can fine-tune the movement speed, and you can adjust the speed in three gears.

(Please see the following connection steps for detailed installation tutorials of various devices)

WIN 8/10System connection steps

There are two ways to connect the mouse and computer
The first method: Find the icon in the lower right corner of the computer desktop, if there is no icon below, use the second method:

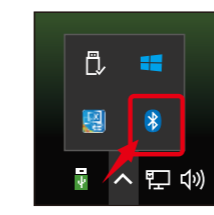

-2-

1. Find the icon shown in the figure above, right-click, the figure below will appear, click Add Bluetooth Device;

2. After clicking, wait for ten seconds, the icon as shown in the figure below will appear, select a Bluetooth Mouse device, click pairing, wait for a while, the progress bar is finished and you can use the mouse normally!

The second method: click the win key on the keyboard, click the setting button in turn, enter the windows settings and click the device, see bluetooth and other devices, turn on bluetooth, add bluetooth or other devices to search

-3-

80.01 mm

WIN 7 System connection steps

Note: Due to the system version, most win7 systems do not support the bluetooth function, so an outsourced bluetooth adapter is required!

1. Open My Computer or Computer, the following screen will appear, select: Open Control Panel
2. The following screen will appear, click in sequence, under Hardware and Sound Devices and Printers: Add Device
3. After clicking Add Device, wait for ten seconds, the icons shown in the following figure will appear in turn, select a Bluetooth Mouse device, click Next, wait for a while, the progress bar is finished and you can use it!



-4-

80.01 mm