

DXOPHIEX



Scan the QR code
to download and install the APP

or search "Resun Aquarium" from APP Store,
or search "Resun Aquarium" from Google Play.

Automatic Fish Feeder

INSTRUCTION MANUAL

AF2020Wi-Fi



Shenzhen Chongchao Technology Co., Ltd.

Add: No.366, Ainan road, Nanlian block, Longgang, Shenzhen, China.

PREFACE

Thanks for buying our product, a new generation of Automatic Fish Feeder with App, easy to customize feeding plans and keep feeding records, especially suitable for remote feeding when you are not at home. To ensure you use the product safely and correctly, please read thoroughly this instruction before use.

Please note that we are not responsible for any failure caused by misuse or improper maintenance. Please save this instruction for future use.

FEATURES

- Remote control with APP to customize feeding plans and keep feeding records
- Easy to set up automatic feeding, also comes with the manual feeding
- Workable with fish foods of any shape
- 2 sizes of food containers
- Feeding amount adjustable
- Fits any kind of aquariums with 2 ways to mount the feeder
- Power supplied by both USB and battery (2*AA)

Note: The feeder must be powered by USB when using the APP.

PRODUCT STRUCTURE

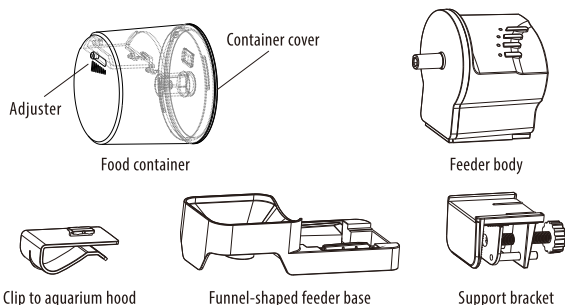

PREPARATION

1. Open the battery cover at the bottom of the feeder, put in Alkaline batteries (2*AA).

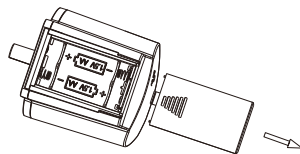

2. POSITIONING OF THE FEEDER

There are 2 ways to position the feeder to the aquarium. These 2 ways are for aquariums with hoods and without hoods respectively.

2.1 Aquariums without hoods – support bracket

- a. Align the bottom of the feeder with the support bracket and slide in. Make sure the screw nut is towards the outside of the aquarium (See Fig.1).
- b. Seat the feeder on the rim of the aquarium, then tighten with the screw (See Fig.2).

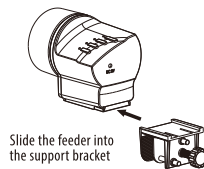

Fig.1

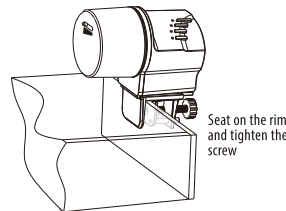

Fig.2

2.2 Aquariums with hoods – funnel-shaped base

- a. Fix the clip to the right side of the feeding hole on the aquarium hood (See Fig.3).

b. Align the extruded tab on the clip with the small rectangular hole at the bottom of the funnel-shaped base, then slide the base to the right until you hear the “click” sound (See Fig.4).

c. Align the bottom of the feeder with the rail at the right side of the base, slide the feeder till the end (See Fig.5).

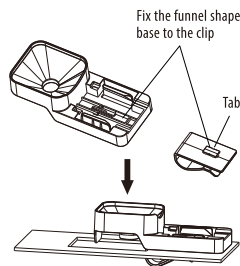

Fig.4

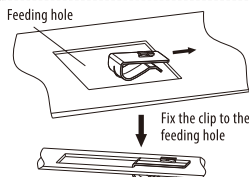

Fig.3

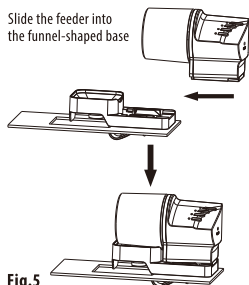
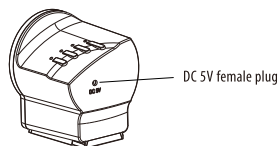

Fig.5

3. Plug in the DC plug, then connect the other end of the power cable to an adapter of DC5V/1A, plug the adapter (sold separately) into the mains socket.



USB to DC power cable

Note: USB is the default power supply and will automatically switch to battery in case of home outage, and the feeder continues to run as previously set.

FOOD FILLING

1. To remove the food container from the feeder, firstly move the adjustor to the minimum position, then grab the feeder body with one hand and the food container with another hand, and use force to detach (See Fig.6). Take off the container lid by using force on the tab on the lid (See Fig.7).

Do not overfill. Make sure the food is below the two notches on the inner surface of the container (See Fig.8).

When the food filling is done, align the hole on the tab to the locating tab on the food container and press to fit (See Fig.9). Then fit the food container to the feeder body (See Fig.10).

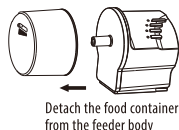

Fig.6

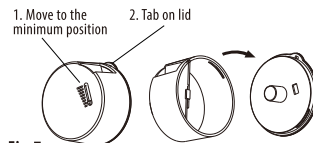

Fig.7

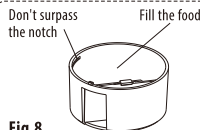

Fig.8

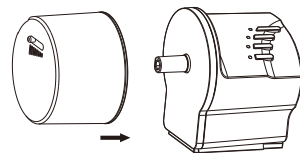

Fig.10 Press the food container to fit to the feeder body

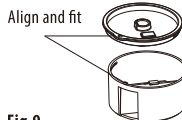



Fig.9

2. Change of the food containers

The feeder comes with one big and one small food containers. To exchange, simply follow the above instruction to take off the food container and install the desired one.

1. Control Panel

1.1 Manual feeding

Press button , the light in the left will flash and the food container will rotate for one turn. Each pressing will trigger the rotation for one turn.

1.2 Press button to set feeding once a day, the light in the left will flash and the food container will rotate for one turn.

After this turn, the light will flash in a lower frequency to remind the user of the setting is valid. After 24 hours it will feed the fish automatically.

1.3 Press button to set feeding twice a day, the food container will rotate for one turn, then rotate for another turn after 12 hours.

1.4 Press and hold for 5 sec, the LED indicator will flash red, get ready for Wi-Fi Network configuration.

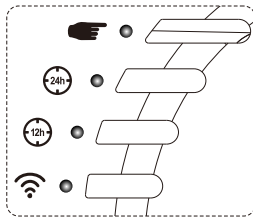

Note: When any one of the indicators (except the Wi-Fi indicator) at the control panel is fast flashing once per second, it indicates the power of the batteries is low. Batteries should be changed immediately, or else the feeder will not be able to function due to dead battery.

2. Installing the APP

Scan the QR code on the right to download and install the APP, or search "Resun Aquarium" from APP Store for iPhone, or search "Resun Aquarium" from Google Play for Android phone.

If you have already installed the APP on your mobile phone, please check if it is the latest version.



3. User Registration

3.1 Read and Agree User Agreement and Privacy Policy

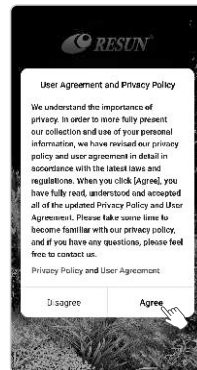

3.2 Tap "Sign up"



3.3 Choose your country, type in your E-mail account, check and tap "Get Verification Code"

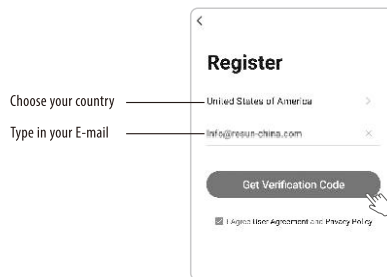

3.4 Find the verification code in your E-mail and enter the verification code



3.5 Set Password

After setting password, then tap "Done"



3.6 Check and tap "Go to App"



4. Add Device

4.1 Connect your phone to your home Wi-Fi

4.2 Open the APP

4.3 Tap "Add Device" on the home page or the "+" sign in the upper right corner

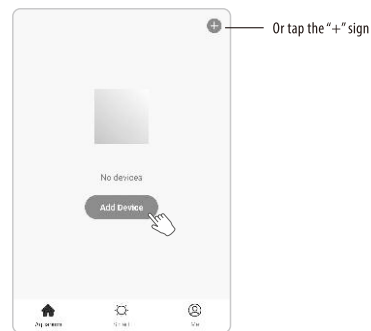

4.4 Select Add Manually, then "Feeder".

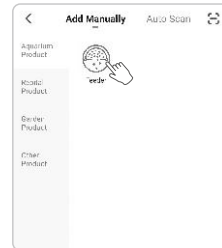

4.5 Enter password for you home Wi-Fi, then tap "Next"

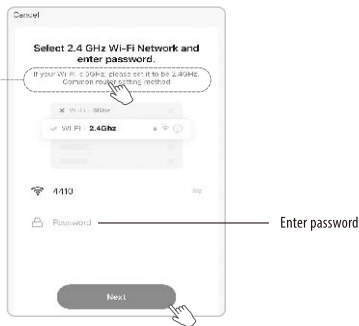

*Special attention:

If your router supports both the 2.4GHz and 5GHz bands, but only one Wi-Fi name is displayed on the Wi-Fi search page of your mobile phone, please tap "Common router setting method"

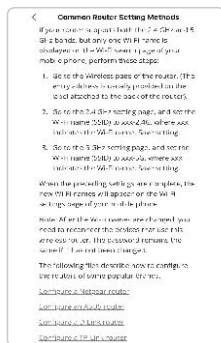

4.6 The default network configuration mode is by Wi-Fi, press and hold the Wi-Fi button for 5 seconds until the indicator flashes red quickly (2 times per second). If the indicator does not flash red quickly, please press and hold the Wi-Fi button for another 5 seconds again.



4.7 Check and tap "Next"



The APP will search for the device automatically, then add the device successfully soon.

5. Set up meal schedules

5.1 Go to the setup homepage

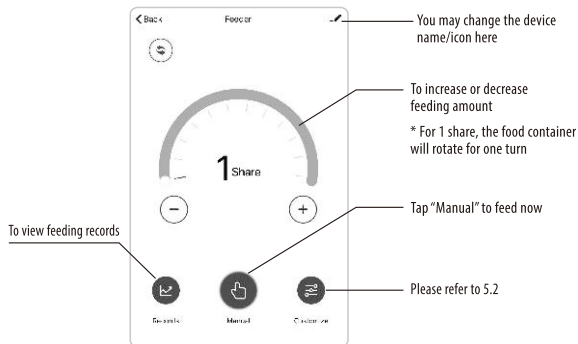

5.2 To customize setting

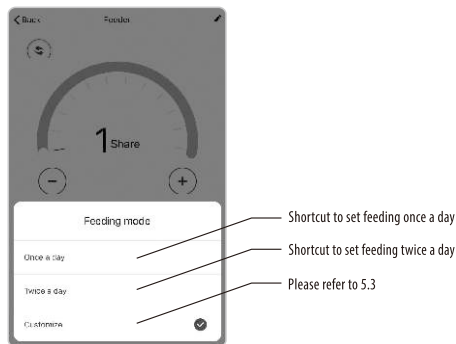

5.3 To view existing meal schedules or add schedules

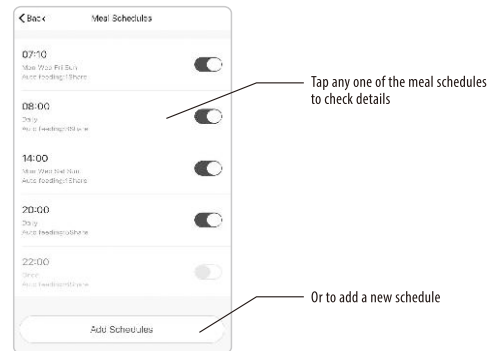

5.4 To set details (Don't forget to save after setting)

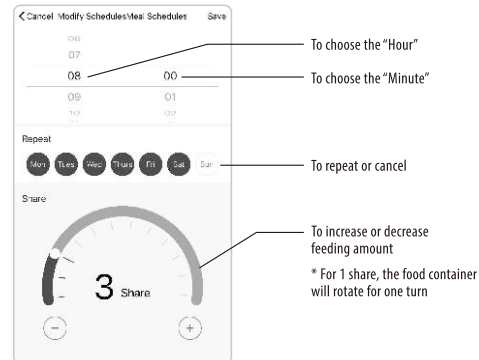

5.5 To view feeding records



To view feeding records in list form

To view weekly/monthly/yearly feeding records in line chart

NOTES:

- The feeder continues to run as previously set when the USB power is cut off or the internet is out of service.
- The offline feeding records during power cut or internet failure will not be collected even after the restoration of power and internet.

More features, wait for you to discover!

ATTENTION:

1. You can only use the APP when the feeder is powered by USB.
2. For the first time to add a device, it is recommended to keep the feeder within 3 meters of your home wireless router.
3. If it fails to add a device by your home Wi-Fi, give it another try to add the device by using the mobile phone hot spot network.

IMPORTANT SAFETY CAUTIONS

DANGER: To avoid possible electric shock, special care should be taken since water is employed in the use of aquarium equipment.

- 1) NEVER PLACE THE FISH FEEDER IN WATER.
- 2) DO NOT DROP THE FEEDER IN THE TANK! WATER DAMAGE VOIDS THE WARRANTY AND CAUSES THE ELECTRONIC COMPONENTS TO MALFUNCTION.
- 3) DO NOT USE ANY SOAP OR DETERGENT FOR CLEANING. REMOVE THE FOOD CONTAINER AND THOROUGHLY CLEAN AND RINSE WITH WARM WATER. MAKE SURE THE FOOD CONTAINER IS COMPLETELY DRY BEFORE ADDING FOOD.

Warranty Card

WARRANTY

1-year free warranty

CONTACT INFORMATION:

Email: dxophiex@gmail.com

Shenzhen Chongchao Teconology Co.,Ltd.

Adds: No.366 Ainan Road, Nanlian Community, Longgang District, Shenzhen, Guangdong. 518000

Thank you for choosing DXOPHIEX, If you have any questions or suggestions for our products, please contact us by email before leaving feedback or opening a case, it will be the fastest way to solve your problem.

If you are pleased with this purchase, sharing your positive feedback will do great help for more customers. Thanks again!

FCC STATEMENT:

This device complies with Part 15 of the FCC Rules. Operation is subject to the following two conditions:

- (1) This device may not cause harmful interference, and
- (2) This device must accept any interference received, including interference that may cause undesired operation.

Warning: Changes or modifications not expressly approved by the party responsible for compliance could void the user's authority to operate the equipment.

NOTE: This equipment has been tested and found to comply with the limits for a Class B digital device, pursuant to Part 15 of the FCC Rules. These limits are designed to provide reasonable protection against harmful interference in a residential installation. This equipment generates uses and can radiate radio frequency energy and, if not installed and used in accordance with the instructions, may cause harmful interference to radio communications. However, there is no guarantee that interference will not occur in a particular installation. If this equipment does cause harmful interference to radio or television reception, which can be determined by turning the equipment off and on, the user is encouraged to try to correct the interference by one or more of the following measures:

- Reorient or relocate the receiving antenna.

- Increase the separation between the equipment and receiver.

- Connect the equipment into an outlet on a circuit different from that to which the receiver is connected.

- Consult the dealer or an experienced radio/TV technician for help.

FCC Radiation Exposure Statement:

This equipment complies with FCC radiation exposure limits set forth for an uncontrolled environment. This equipment should be installed and operated with minimum distance 20cm between the radiator & your body.