

Manual Instruction

2.4GHz RF 4-Zone Remote Control

Model Number: RC01RF/RC01RFB/RC02RF/RC02RFB/RC03RF/RC03RFB

1. Features

This product adopt world-wide used 2.4GHz frequency, GFSK control method, with the features of low power consumption, long distance transmitting, strong anti-interference and fast communication rate. It can control our 2.4GHz RF smart lights and controllers with color changing, color Temperature adjust, saturation and brightness changing.

2. Product Size

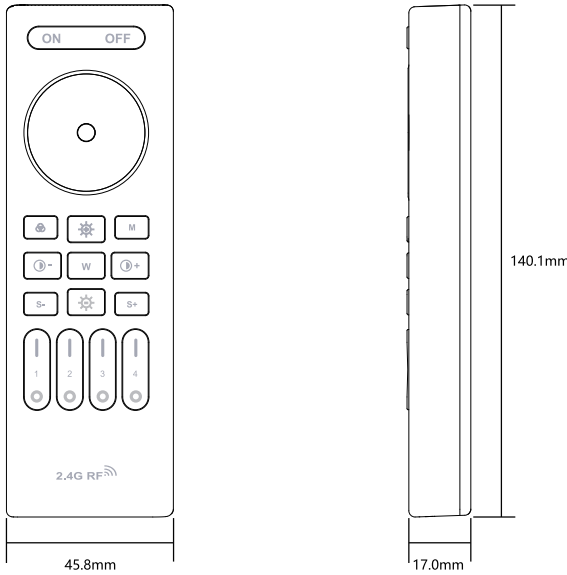

3. Button Instruction

(1). RC01RF/RC01RFB: 4-Zone Dimming Remote Control

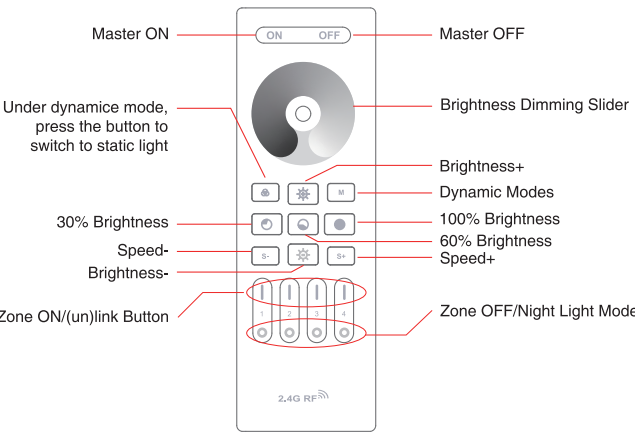

- ON** Press the button to turn ON all linked devices.
- OFF** Press the button to turn OFF all linked devices.
- Slider** Touch the slider to dim the brightness from 1%-100%.
- Static Light** Under dynamice mode, press the button to switch to static light.
- Dynamic Modes** Press the button to switch the dynamic modes repeatedly.
- Brightness Up** Press the button to dim the brightness up.
- Brightness Down** Press the button to dim the brightness down.
- 30% Brightness** Press the button to get the 30% brightness.
- 60% Brightness** Press the button to get the 60% brightness.
- 100% Brightness** Press the button to get the 100% brightness.
- Speed-** Lower the dynamic mode speed.
- Speed+** Accelerate the dynamic mode speed.

(2). RC02RF/RC02RFB: 4-Zone DIM&CCT Remote Control

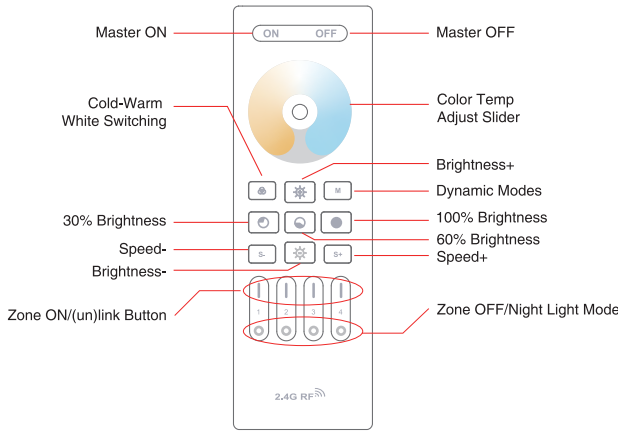

- ON** Press the button to turn ON all linked devices.
- OFF** Press the button to turn OFF all linked devices.
- Slider** Touch the slider to dim the brightness from 1%-100%.
- White Switching** Press the button to switch the cool white, nature white and warm white repeatedly.
- Dynamic Modes** Press the button to switch the dynamic modes repeatedly.
- Brightness Up** Press the button to dim the brightness up.
- Brightness Down** Press the button to dim the brightness down.
- 30% Brightness** Press the button to get the 30% brightness.
- 60% Brightness** Press the button to get the 60% brightness.
- 100% Brightness** Press the button to get the 100% brightness.
- Speed-** Lower the dynamic mode speed.
- Speed+** Accelerate the dynamic mode speed.

(3). RC03RF/RC03RFB: 4-Zone RGB&RGBW&RGBCCT Remote Control

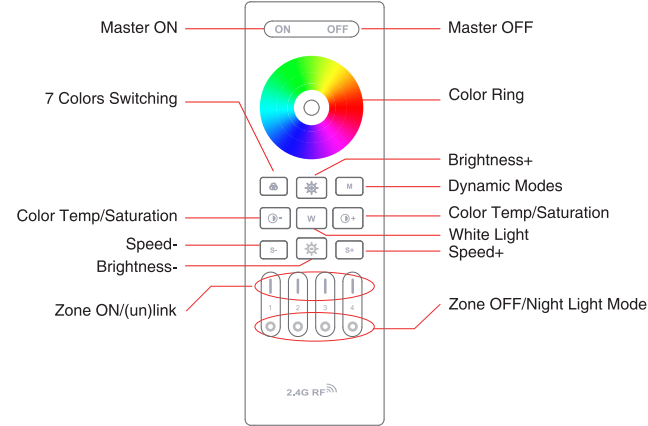

- ON** Press the button to turn ON all linked devices.
- OFF** Press the button to turn OFF all linked devices.
- Color Ring** Touch the color ring to change the colors.
- Color Switching** Short press the button to switch the pure colors from orange, yellow, green, cyan, blue, purple and red repeatedly. Long press the button to switch the pure colors from orange, yellow, green, cyan, blue, purple and red gradually. Press the button to get the white light.
- White Switching** Under white light mode, press the button to change the white light to cold white. Under color light mode, press the button to reduce the saturation.
- Dynamic Modes** Under white light mode, press the button to change the white light to warm white. Under color light mode, press the button to add the saturation.
- Dynamic Modes** Press the button to switch the dynamic modes repeatedly.
- Brightness Up** Press the button to dim the brightness up.
- Brightness Down** Press the button to dim the brightness down.
- Speed-** Lower the dynamic mode speed.
- Speed+** Accelerate the dynamic mode speed.

4. Linking and Unlinking Instruction

Remark: The light can be working after linking with the remote.

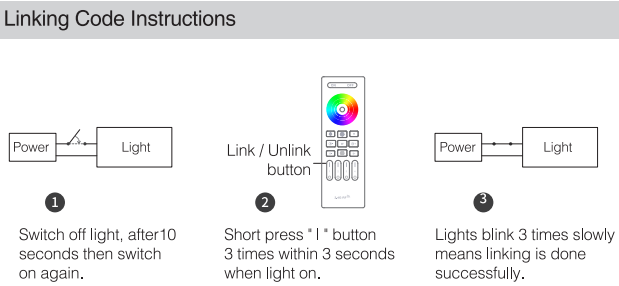

Linking failed if light is not blinking slowly, Please follow above steps again. (Note: Light that have linked can't link again)

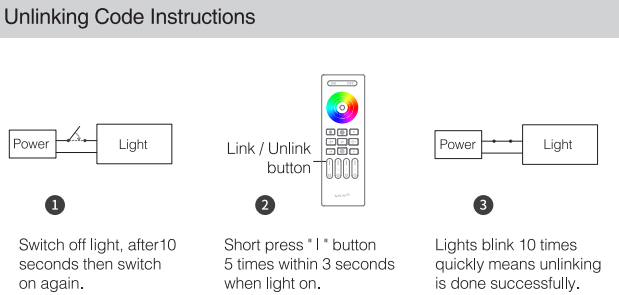

Unlinking failed if light is not blinking quickly, Please follow above steps again. (Note: Light haven't linked that don't need to unlink)

5. Group Control

You can add an endless numbers of lights to a zone on the 4 channel remote by linking the lights to different zones. This way you are completely flexible in creating different group combinations. Below you can see some grouping examples.

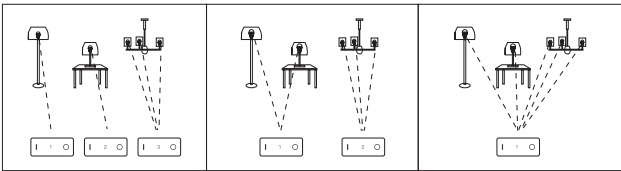

- Remark:**
- The user can re-programme freely as needed. One remote can control countless lamps or controllers, but one lamp or controller can only be controlled by five remotes (Max).
  - Please check the battery installation and controller (totally discharge the power), when you programme after switching off and switching on.

6. Attention

- This remote only control our 2.4GHz RF products; cannot control other products not made by us.
- In the using of the remote, if the indicated lamp blinking quickly, Please change the battery in time. Please don't use poor quality battery to avoid the leaking of battery liquid to damage the remote.
- This 2.4GHz remote is precise electronic product; don't use it in humid, high temperature, dust and high voltage environment; Saving it at indoor, dry and no static electricity environment.
- Please don't use the remote on the wide-range metal or strong electromagnetic wave area, otherwise, it will badly affect the controlling distance.

This device complies with Part 15 of the FCC Rules. Operation is subject to the following two conditions: (1) this device may not cause harmful interference, and (2) this device must accept any interference received, including interference that may cause undesired operation

NOTE: This equipment has been tested and found to comply with the limits for a Class B digital device, pursuant to Part 15 of the FCC Rules. These limits are designed to provide reasonable protection against harmful interference in a residential installation. This equipment generates, uses and can radiate radio frequency energy and, if not installed and used in accordance with the instructions, may cause harmful interference to radio communications. However, there is no guarantee that interference will not occur in a particular installation.

If this equipment does cause harmful interference to radio or television reception, which can be determined by turning the equipment off and on, the user is encouraged to try to correct the interference by one or more of the following measures:

- Reorient or relocate the receiving antenna.
- Increase the separation between the equipment and receiver.
- Connect the equipment into an outlet on a circuit different from that to which the receiver is connected.
- Consult the dealer or an experienced radio/TV technician for help.

Warning: changes or modifications not expressly approved by the party responsible for compliance could void the user's authority to operate the equipment

The devices has been evaluated to meet general RF exposure requirement , the device can be used in portable exposure condition without restriction