

LED display smart electric rotating disc with APP

Manual

1. Product Information

Product name: LED display smart electric rotating disc with APP

Product size: 200*40mm Input

Current/voltage: 5V/1A

Speed of rotation : 135s/circle to be slow , 33s/circle to be fast

Power supply mode: type-c data cable, 18650 rechargeable battery, AA battery.

Charging time: 4H

Use time: 8H

2. Technical features

- APP controls the LED turntable, you can adjust the speed of rotation and angle of the turntable, and edit the content of the display screen.
 - The display screen can input to 40 Chinese, 80 English or numbers.
 - Use energy-saving, high-power, long-life LED lamp beads.
- 3. Working principle: The LED lamp bead is powered by a battery and can be reused after charging. The LED turntable is used with APP.**

4. Operation

- Press ON/OFF the first time to turn on the power, and the turntable starts to rotate at the same time,

press the second time to turn on the display, press the third time to turn on the turntable rotation, and press the fourth time to turn on the display.

- Turn on the power switch and the turntable starts to rotate. Press the Speed button to switch the speed to rotation .
- Turn on the power switch, the turntable starts to rotate, touch the L/R key to switch the direction of rotation.
- This product needs to be used with APP.

In the first step, touch ON/OFF the first time to turn on the power, and touch the second time to turn on the display;

The second step is to open the APP page and click to connect to the device;

In the third step, the device can be used together after it shows that the connection is successful;

5. Attention

- After fully charged, please cut off the power in time to protect the battery life.
- It is forbidden to use over-charged chargers (such as 9V/2A, 12V/2A, 5V/3A, etc.).
- Keep safe charging operation.
- Do not use this product when charging and avoid to burn the LED lamp beads or the internal electronic components of the power supply.

| Category | Features | Content |
|---------------|-------------------|--|
| Set mode | Language version | Support Chinese, Traditional Chinese, English, German, Spanish, Portuguese, Japanese, Korean, Russian, French, Italian and other languages |
| | Pattern animation | Comes with animations and patterns |
| | Text editor | Support multi-language input |
| Display mode | Display mode | Fixed, move left, move right, move up, move down, blink, scroll, Snow, laser, brightness adjustment, speed adjustment |
| | Single mode | Rotate clockwise, rotate counterclockwise |
| | Double mode | 90°、180°、360° |
| Rotation mode | Speed mode | Slow, fast |

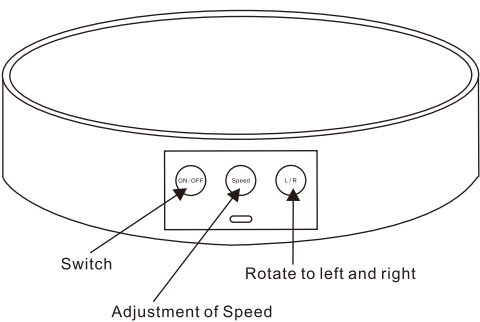

APP operation instructions



Scan the QR code and install 360 displayAPP
(IOS system can also be searched and downloaded directly in the app store)

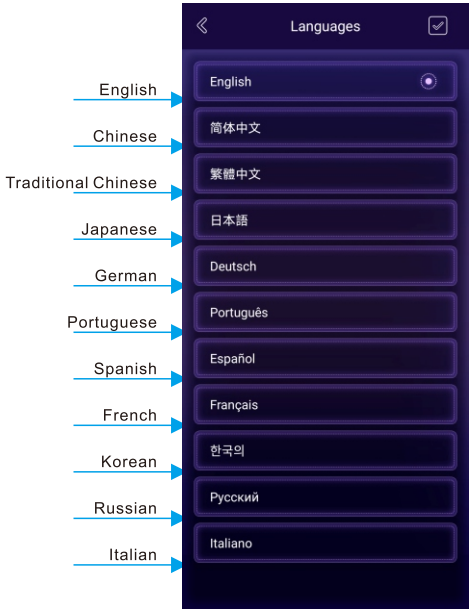
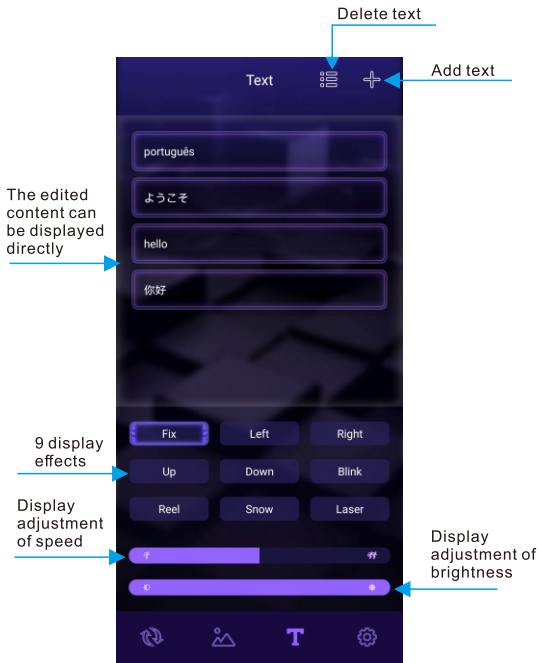
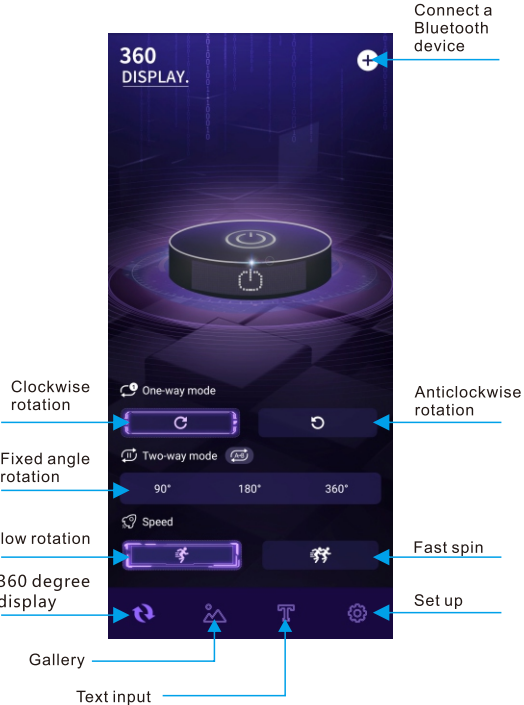

This device complies with Part 15 of the FCC Rules. Operation is subject to the following two conditions: (1) this device may not cause harmful interference, and (2) this device must accept any interference received, including interference that may cause undesired operation

NOTE: This equipment has been tested and found to comply with the limits for a Class B digital device, pursuant to Part 15 of the FCC Rules. These limits are designed to provide reasonable protection against harmful interference in a residential installation. This equipment generates, uses and can radiate radio frequency energy and, if not installed and used in accordance with the instructions, may cause harmful interference to radio communications. However, there is no guarantee that interference will not occur in a particular installation.

If this equipment does cause harmful interference to radio or television reception, which can be determined by turning the equipment off and on, the user is encouraged to try to correct the interference by one or more of the following measures:

- Reorient or relocate the receiving antenna.
- Increase the separation between the equipment and receiver.
- Connect the equipment into an outlet on a circuit different from that to which the receiver is connected.
- Consult the dealer or an experienced radio/TV technician for help.

Warning: changes or modifications not expressly approved by the party responsible for compliance could void the user's authority to operate the equipment