

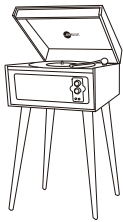

CONSOLE TURNTABLE Instruction Manual



READ INSTRUCTIONS CAREFULLY BEFORE USE AND STORE
IN A SAFE PLACE FOR FUTURE REFERENCE

www.ARKROCKET.com

DESCRIPTION

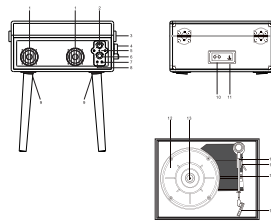

| | | | |
|---|-----------------------------|----|---------------------------|
| 1 | Built-in speaker | 10 | RCA L/R out |
| 2 | Power on/off Volume control | 11 | DC in jack |
| 3 | Lock catch | 12 | Turntable Platter |
| 4 | Wandle | 13 | Turntable Shaft |
| 5 | Power indicator | 14 | Tone Arm |
| 6 | Tone control | 15 | Lift Lever |
| 7 | Earphone jack | 16 | Speed Control |
| 8 | Aux in jack | 17 | Stylus (Needle) Cartridge |
| 9 | Removable foot | | |

Main features:

- 33,3,45,45rpm Turntable LP player
- Built-in Speaker
- Aux in jack
- RCA Line Out
- With headphones jack
- With DC 5V 1A power adaptor
- Automatic return play arm

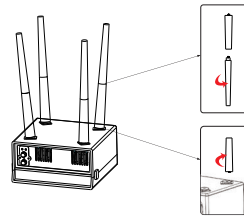

- With 45RPM adaptor
- Bluetooth receiver function

INITIAL SET-UP

- 1.Plug the supplied AC100-240V, 50/60HZ to DC 5 V power adaptor into the DC 5 V input located on the rear of the turntable.
- 2.Insert the wall plug of the power adaptor into an electrical wall outlet.

AMPLIFIER CONNECTION (if required)

Whilst you can listen to your new turntable using the built in speakers you may wish to connect it to your existing Hi Fi system. Connect the audio plugs to the jack input on your mixer or amplifier using an RCA cable (not supplied)

- Red plug into R/H channel input.
- White plug into L/H channel input.

HEADSET OR EXTERNAL SPEAKERS CONNECTION (if required)

Connect the audio plugs to the jack input on your Headset or Speakers.

Playing a record

- Place the record of your choice on the turntable.
- Choose the desired playing speed using the speed selection switch between 33.3, 45 and 78rpm.
- Turn on the Rotary Power Switch; note that this also controls volume.
- Release the tone arm lock.
- Raise the arm with your hand lightly.
- Place the stylus vertically over the first track of the record, the turntable will start turning automatically.
- Pat down the stylus slowly on to the record to play.
- When the record is finished, the platter will stop spinning. You will need to move the needle arm back to its resting place by hand.
- Replace the protective cap on the stylus and close the tone arm lock.
- Turn off power at mains.

The Auxiliary input

- The Auxiliary input at the back of the equipment, can connect the external audio device (such as CD player). The audio signal from the external audio device will be played through the system.
- If an external audio device is connected to the AUX IN socket, playing of the auxiliary device takes priority over other features.

Connect to Bluetooth devices.

Play from Bluetooth device:

- When the Tone arm is in arm holder, then you can activate the Bluetooth function in your Bluetooth device (such as Mobile Phone or Personal Computer); put your device into Bluetooth search mode.
- Your Bluetooth device should show "Arkrocket ARCT" in the list, and then select it for pairing. Waiting for some seconds and you will see connected message as shown on your Bluetooth device.
- Now, you can start to music play on your Bluetooth device when the device is in paired and shows connected.

MAINTENANCE

REPLACING THE STYLUS

-Refer to the figures 1-8

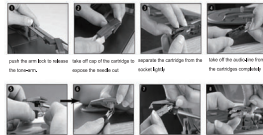

NOTE: Please mention extreme care whilst performing this operation so as to avoid the tone arm and auxiliary wires from any damage.

INSTALLING A NEW STYLUS CARTRIDGE

-Refer to the figures 5 & 6



NOTES

We advise you to clean your records with an anti-static cloth to gain maximum enjoyment from them and to make them last. We would also point out that for the same reason your stylus should be replaced periodically (approximately every 250 hours)

Dust the stylus from time to time using a very soft brush dipped in alcohol (brushing from back to front of the cartridge)

WHEN TRANSPORTING YOUR RECORD PLAYER DO NOT FORGET TO:

- Replace the protective cap on the stylus.
- Put the rest clip into the pick-up arm

FCC Statement

This device complies with part 15 of the FCC rules. Operation is subject to the following two conditions: (1) this device may not cause harmful interference, and (2) this device must accept any interference received, including interference that may cause undesired operation.

Changes or modifications not expressly approved by the party responsible for compliance could void the user's authority to operate the equipment.

NOTE: This equipment has been tested and found to comply with the limits for a Class B digital device, pursuant to part 15 of the FCC Rules. These limits are designed to provide reasonable protection against harmful interference in a residential installation. This equipment generates uses and can radiate radio frequency energy and, if not installed and used in accordance with the instructions, may cause harmful interference to radio communications. However, there is no guarantee that interference will not occur in a particular installation. If this equipment does cause harmful interference to radio or television reception, which can be determined by turning the equipment off and on, the user is encouraged to try to correct the interference by one or more of the following measures:

- Reorient or relocate the receiving antenna.
- Increase the separation between the equipment and receiver.
- Connect the equipment into an outlet on a circuit different from that to which the receiver is connected.
- Consult the dealer or an experienced radio/TV technician for help.

Radiation Exposure Statement

To comply with FCC RF exposure compliance requirements, this grant is applicable to only mobile configurations. The antenna used for this transmitter must be installed to provide a separation distance of at least 20cm from all persons and must not be co-located or operating in conjunction with any other antenna or transmitter.



www.ARKROCKET.com

A5
80G 书纸单黑印刷

403-T040222-00