

Thanks for choosing us!

This is a smart phone wireless charger that allows you enjoy the fun of digital products easily.

Please kindly read the user manual before using and keep it for future reference.

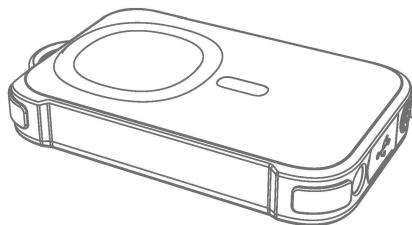

Parameter specification

Model: ME (WATERPROOF POWER BANK)
Battery Capacity: 10000mAh
Lithium battery capacity: 10000mAh 3.85V/37Wh,
Rated capacity: 6000mAh
USB-C Input: 5V=3A, 9V=2A
USB-C Output: 5V=3A, 9V=2.2A, 12V=1.5A, 20W
Wireless charging output: 15W
5V输入电压电流: 稳压直流电源或适配器供电 电压5.0V-5.25V 电流2400-3200mA
快充输入电压电流: Type-C支持PD协议18W以上充电器供电 电压5V:8.8V-9.4V 电流1700-2200mA
额定输入: Type-C: 5V 3A, 9V 2A, 18W 协议: PD3.0, QC2.0, AFC, FCP
额定输出: Type-C: 5V 3A, 9V 2.2A, 12V 1.5A, 20W 协议: PD3.0, QC2.0, AFC, FCP 无线充: 5W, 7.5W, 10W, 15W 协议: Qi, 苹果, 三星
转换效率: 80% (5V 3A)
尺寸:
重量:

FC CE PS RoHS
Made in China

Checking the Battery Level

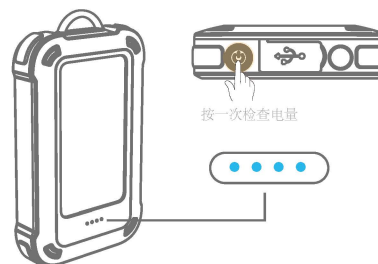

充电指示灯:		
●●●●	小于 25%	第一个灯闪
●●●●	25-50%	第二个灯闪
●●●●	50-75%	第三个灯闪
●●●●	75-100%	第四个灯闪
●●●●	充满电	四颗灯亮
电量及放电显示:		
●●●●	0%, 或整机保护后	四颗灯灭
●●●●	0-5%	第一个灯闪
●●●●	5-25%	第一灯长亮
●●●●	25-50%	第二灯长亮
●●●●	50-75%	第三灯长亮
●●●●	75-100%	第四灯长亮

Illumination



ME

POWER BANK
Magnetic Wireless Charger

User Manual

Product Overview

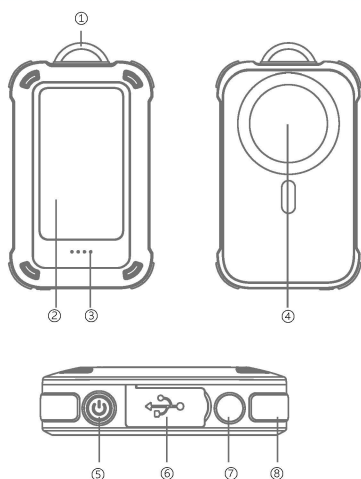

1. 挂孔
2. 大灯
3. LED电量显示
4. 磁吸无线充
1. 多功能按键
2. 输出/输入 Type-C口
3. 聚光灯
4. 护角防摔硅胶设计

给手机充电



磁吸无线充输出: 为苹果12、13、14系列手机

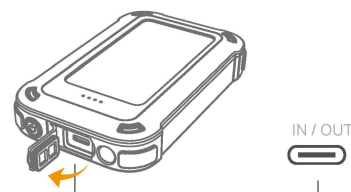

Type-C端口输出: 为手机、耳机、平板充电;
注意, 不配送安卓线和苹果充电线;

Connect to Power Adapter

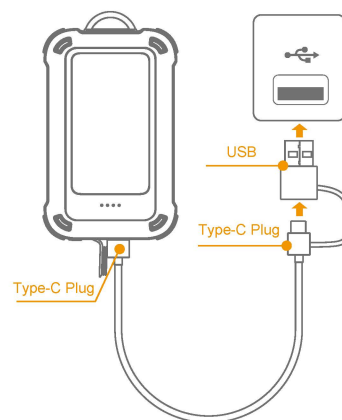

Type-C端口输入: 通过USB或Type-C为ME
Waterproof Power bank充电

Notes

1. Do not squeeze or collisions.
2. Do not disassemble or throw into fire or water, to avoid causing a short circuit leakage.
3. Do not use wireless charger in severely hot, humid or corrosive environments, to avoid circuit damage and occurs leakage phenomnon.
4. Do not place too close with magnetic stripe or chip card (ID card, bank cards, etc.) to avoid magnetic failure.
5. Please keep the distance at least 20cm between implantable medical devices (pacemakers, implantable cochlear, etc.) and the wireless charger, to avoid potential interference with the medical device.
6. To take care of the children, to ensure that they won't play the wireless charger as a toy, to avoid unnecessary accidents.



Note: Only supports charging for iPhone 12/13/14 series.
Charging speed will be very slow and will cause heat if charge for other models of mobile phones.

The involved images are sketch maps, the final product as per the material subjects.



IPX7 WATERPROOF



10000mAh



3-level Illumination



Magnetic



Wireless charging



Type-C Charger

FCC Caution:

This device complies with part 15 of the FCC Rules. Operation is subject to the following two conditions: (1) This device may not cause harmful interference, and (2) this device must accept any interference received, including interference that may cause undesired operation.

Any Changes or modifications not expressly approved by the party responsible for compliance could void the user's authority to operate the equipment.

Note: This equipment has been tested and found to comply with the limits for a Class B digital device, pursuant to part 15 of the FCC Rules. These limits are designed to provide reasonable protection against harmful interference in a residential installation. This equipment generates uses and can radiate radio frequency energy and, if not installed and used in accordance with the instructions, may cause harmful interference to radio communications. However, there is no guarantee that interference will not occur in a particular installation. If this equipment does cause harmful interference to radio or television reception, which can be determined by turning the equipment off and on, the user is encouraged to try to correct the interference by one or more of the following measures:

- Reorient or relocate the receiving antenna.
- Increase the separation between the equipment and receiver.
- Connect the equipment into an outlet on a circuit different from that to which the receiver is connected.
- Consult the dealer or an experienced radio/TV technician for help.

The device has been evaluated to meet general RF exposure requirement. The device can be used in portable exposure condition without restriction.