

size: 380x208mm



LED FLOOR LAMP

INSTRUCTION

Email: feifu.wang@temtop.com

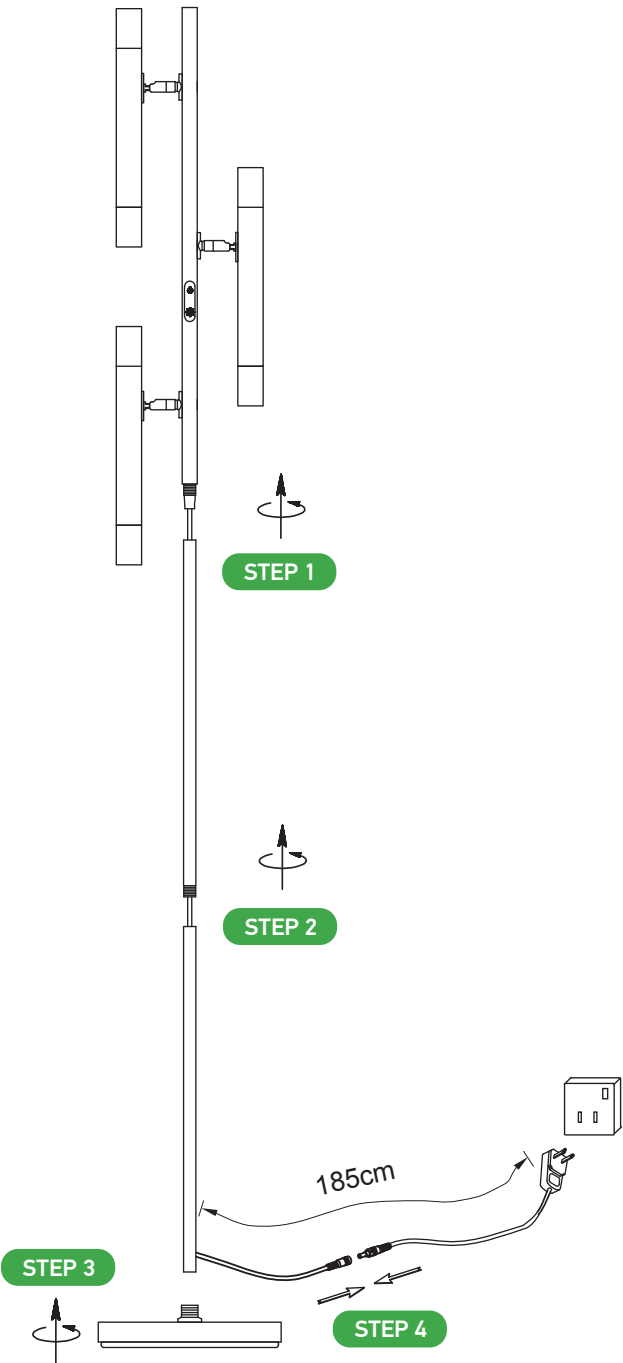
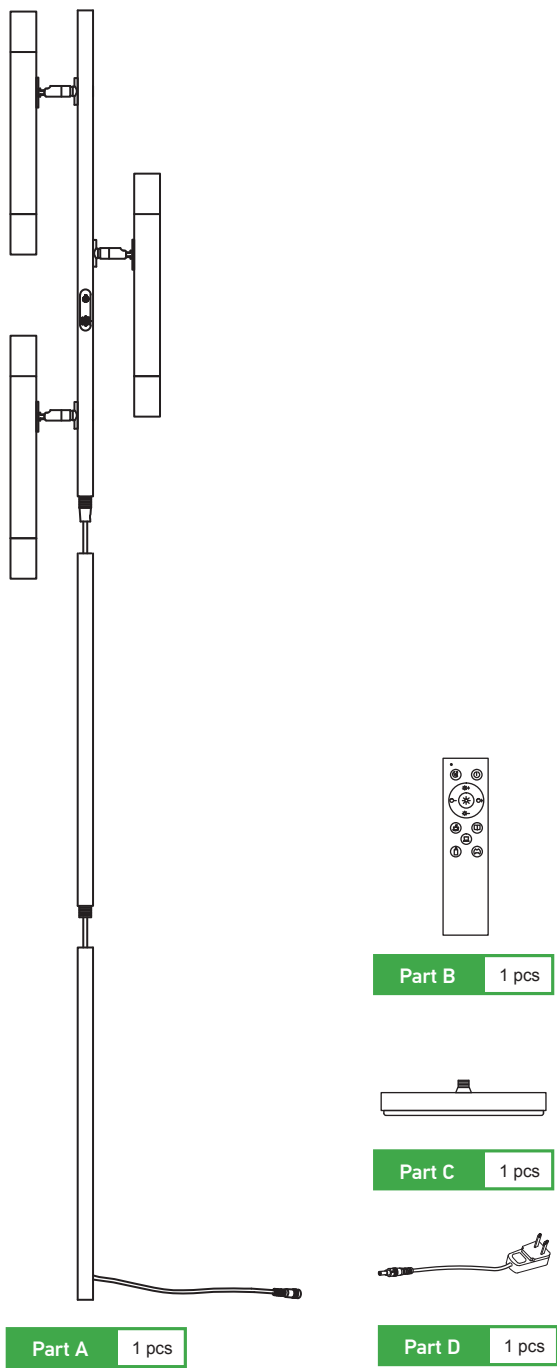

UNIT:CM

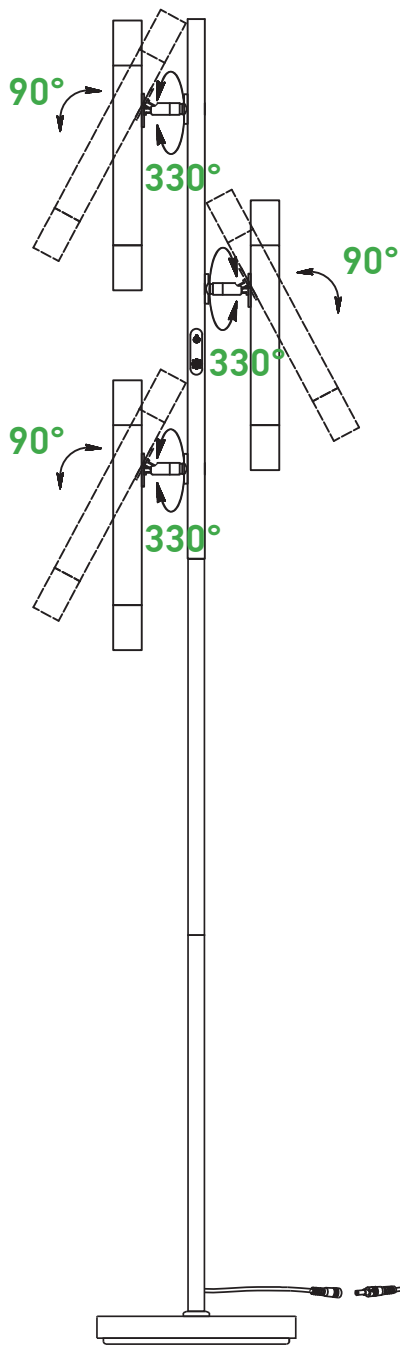
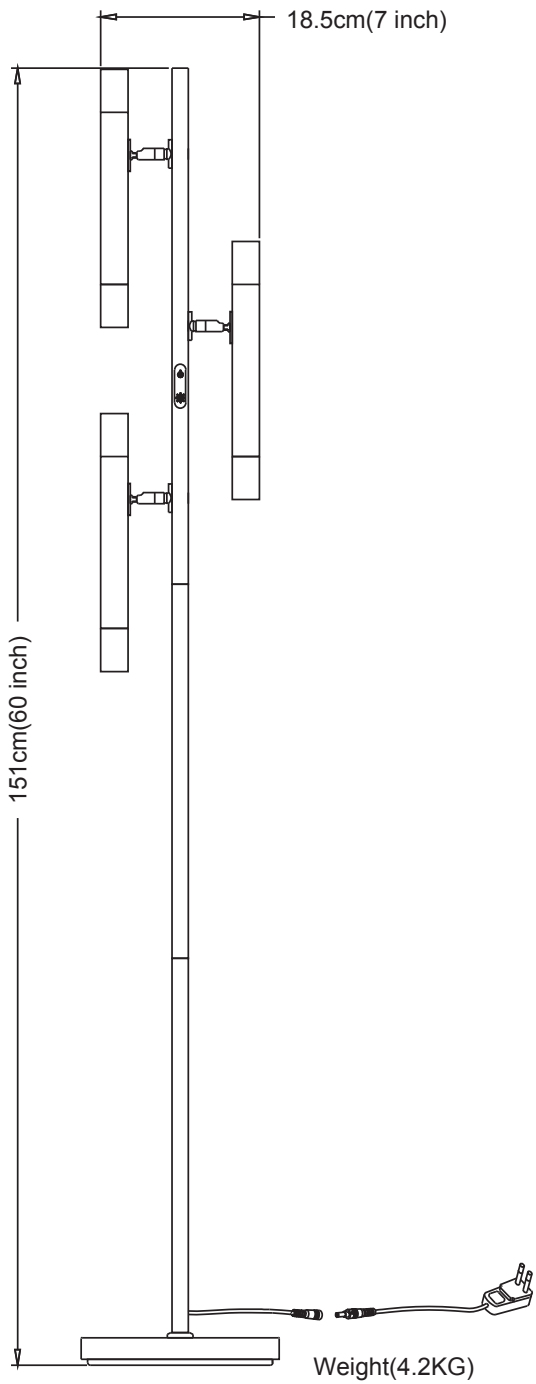

1	○	Indicator light
2	Ⓢ	Night light Timed 1 hour function
3	☀ +	6000K
4	○ -	Brightness Waning
5	☀ -	3000K
6	📖	Leisure Mode
7	👶	Breastfeeding Mode
8	🔌	Turn on / off
9	☀	4000K
10	○ +	Brightness Enhancement
11	📖	Reading Mode
12	💻	Office Mode
13	🎮	Entertainment Mode

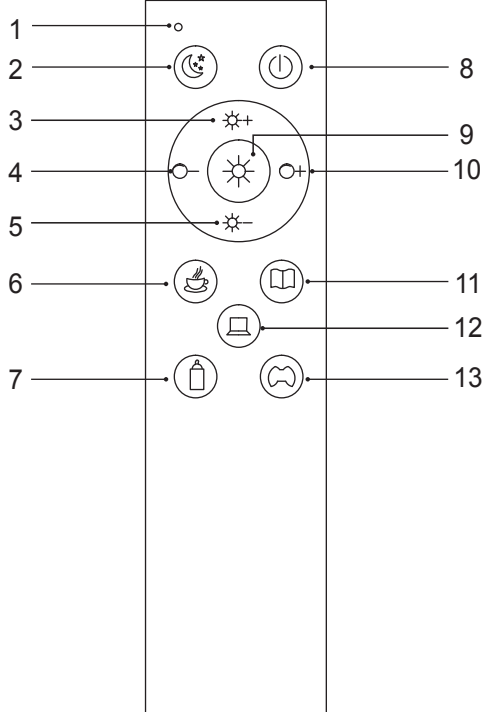

NOTICE: This remote cotroller does not pack batter ies,please put 2x1.5v batteries into it before use.

EN

OPERATING INSTRUCTIONS

Thank you for your purchase! Before installing the product, please read this instruction carefully and keep it for further reference.

SPECIFICATION

Name	LED floor lamp
Material	Metal + Acrylic
Color	Matt Black
Wattage	15 W
Luminous Flux	800 LM
Dimmable	Yes (5%-100% dimming)
Color Temperature	3000 Kelvin - 6000 Kelvin
Lifespan	30,000 Hrs
Adapter Voltage	DC24V 0.75A
Input Voltage	AC100-240V 50/60Hz
Protection class	IP20

HOW TO USE

Press on, then press off

Color temperature: the first stage is 3000K, the second stage is 4500K, the third stage is 6000K, Long press is an electroless dimmer

NOTICES

- Read the instructions before using the lamp.
- Avoid damp, high temperature or corrosive environments to ensure long life.
- Check whether there is any shipping damage after receiving the packaged lamp. Report any issues to us directly at feifu.wang@temtop.com.
- Do not disassemble or repair the lamp if you are not qualified to do so by your local regulations.
- Do not use frayed appliances or damaged cables.
- Do not touch electrical appliances with wet hands and keep it away from fluids.
- Only use the included power adapter.
- Please turn off the power when the device is not used.
- Only clean with dry cloth, no solvents or cleaning solutions.
- Do not use if exceed the voltage.
- Dispose of all packaging correctly and responsibly in accordance with local regulations. Do not keep packaging parts that may be a source of danger within the reach of children.
- Please ensure that all the accessories are assembled according to the assembly instructions. After connecting the driver to the wires, the whole lamp can be used normally.

WARRANTY

Warranty is provided by the seller of this device please contact your reseller for more information regarding the local warranty regulations.

FCC Statement

This device complies with Part 15 of the FCC Rules. Operation is subject to the following two conditions:

- This device may not cause harmful interference.
- This device must accept any interference received, including interference that may cause undesired operation.

2. Changes or modifications not expressly approved by the party responsible for compliance could void the user's authority to operate the equipment.

Note: This equipment has been tested and found to comply with the limits for a class B digital device,pursuant to Part 15 of the FCC Rules. These limits are designed to provide reasonable protection against harmful interference in a residential installation.

This equipment generates uses and can radiate radio frequency energy and,if not installed and used in accordance with the instructions,may cause harmful interference to radio communications.However,there is no guarantee that interference will not occur in a particular installation.If this equipment does cause harmful interference to radio or television reception,which can be determined by turning the equipment off and on,the user is encouraged to try to correct the interference by one or more of the following measures:

- Reorient or relocate the receiving antenna.
- Increase the separation between the equipment and receiver.
- Connect the equipment into an outlet on a circuit different from that to which the receiver is connected.
- Consult the dealer or an experienced radio/TV technician for help