

Automotive key

Electronic smart key - Carry the electronic smart key and press the left and right front door micro switches to unlock/lock all doors; you can also use the buttons on the smart key to unlock/lock the doors, open the back door and start remotely.

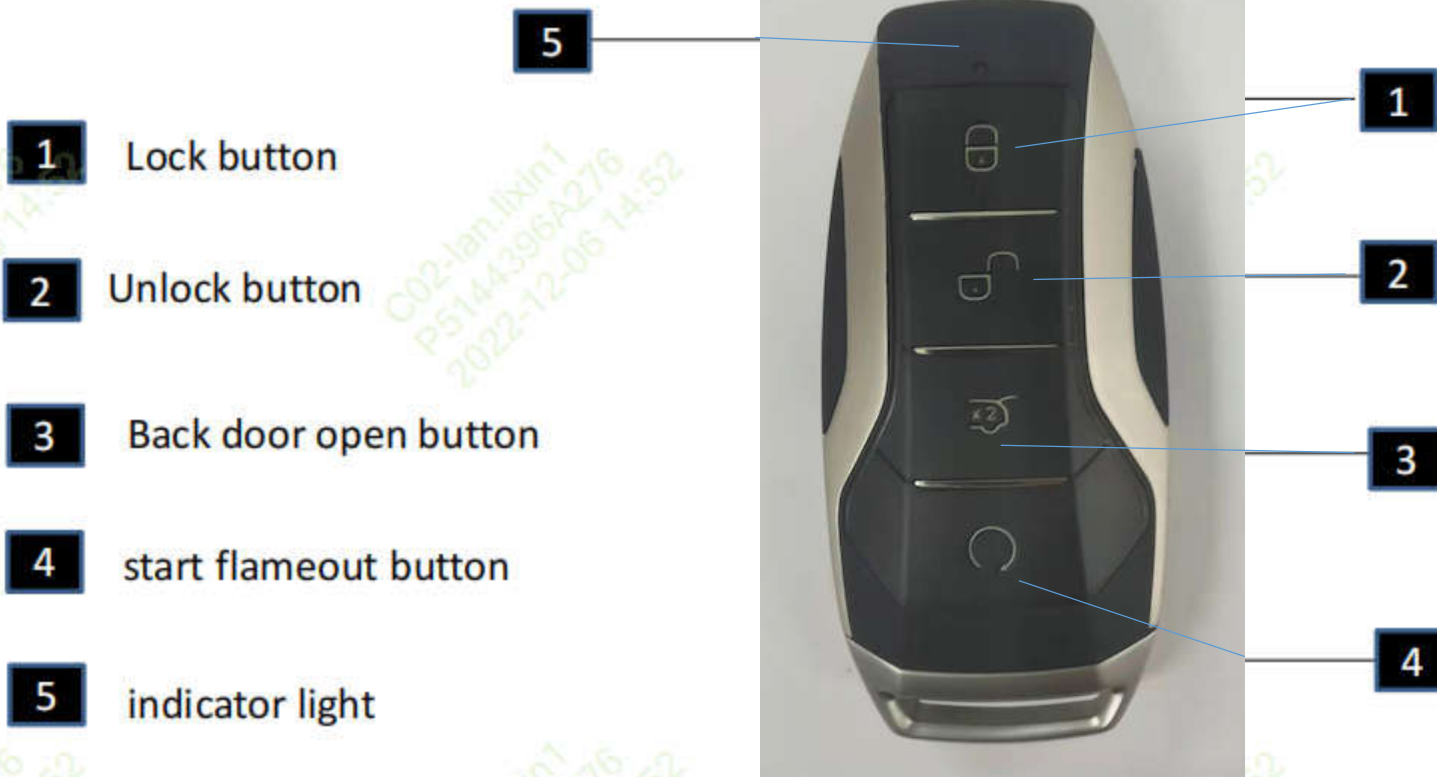

Notice

■ The smart key is an electronic component and the following instructions should be followed to prevent damage to the smart key.

- Do not leave the key in a high temperature place, such as on a dashboard.

- Do not disassemble it at will.

- Do not hit other objects hard with the key or drop it to the ground.

- Do not immerse the key in water or wash it in an ultrasonic washer.

- Do not put the smart key together with devices that emit electromagnetic waves, such as mobile phones.

- Do not attach anything (such as metal seals) to the smart key that will cut off the battery waves.

- A spare key can be registered for the same vehicle.

FCC Requirement

Any Changes or modifications not expressly approved by the party responsible for compliance could void the user's authority to operate the equipment.

This device complies with part 15 of the FCC Rules. Operation is subject to the following two conditions:

- (1) This device may not cause harmful interference, and
- (2) this device must accept any interference received, including interference that may cause undesired operation.

Note: This equipment has been tested and found to comply with the limits for a Class B digital device, pursuant to part 15 of the FCC Rules. These limits are designed to provide reasonable protection against harmful interference in a residential installation. This equipment generates uses and can radiate radio frequency energy and, if not installed and used in accordance with the instructions, may cause harmful interference to radio communications. However, there is no guarantee that interference will not occur in a particular installation. If this equipment does cause harmful interference to radio or television reception, which can be determined by turning the equipment off and on, the user is encouraged to try to correct

FCC Requirement

the interference by one or more of the following measures:

- Reorient or relocate the receiving antenna.
- Increase the separation between the equipment and receiver.
- Connect the equipment into an outlet on a circuit different from that to which the receiver is connected.
- Consult the dealer or an experienced radio/TV technician for help.

This transmitter must not be co-located or operating in conjunction with any other antenna or transmitter.

The device has been evaluated to meet general RF exposure requirement. The device can be used in portable exposure condition without restriction.

Model Name: S0-315, FCC ID: 2A5DHS0-315.