

AGE 14+

2.4G REMOTE CONTROL DRONE INSTRUCTION MANUAL

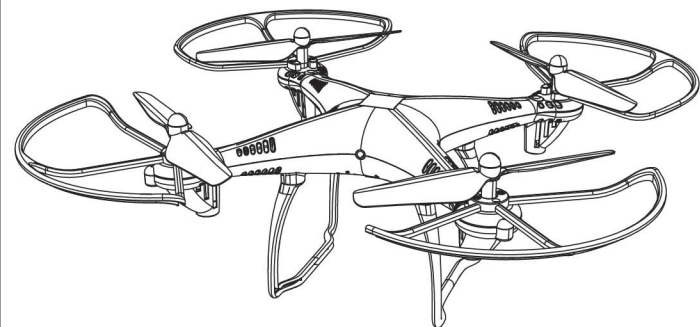

KNOW YOUR REMOTE CONTROL

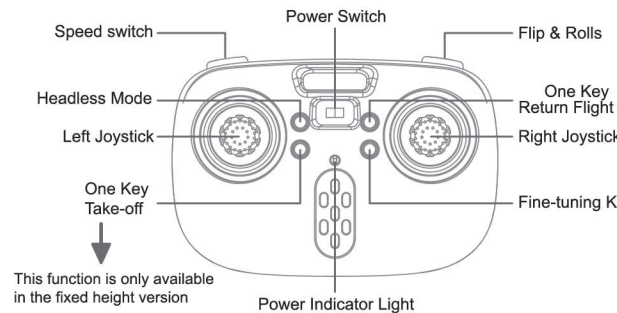

This function is only available in the fixed height version

BATTERY INSTALLATION FOR REMOTE CONTROLLER

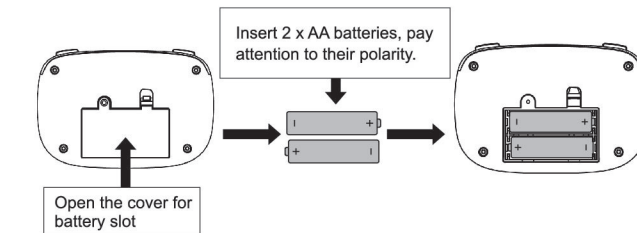

Open the cover for battery slot, insert 2 x AA batteries, pay attention to their polarity. (AA batteries are not included, needs to be bought separately)

NOTES:

1. Pay attention to batteries' polarity when installing, never reverse them;
2. Never mix new batteries with used batteries;
3. Never mix with batteries in different types.

SET UP LANDING GEARS/PROPELLER GUARDS

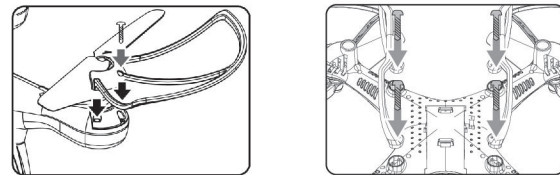

Plug 4 propeller guards to sockets on the drone arms, make sure that they're joint perfectly. Screw them down clockwise.

Install 2 landing gears' plugs to sockets at the bottom of the drone, make sure that they're joint perfectly, Screw them down clockwise.

REPLACE PROPELLERS

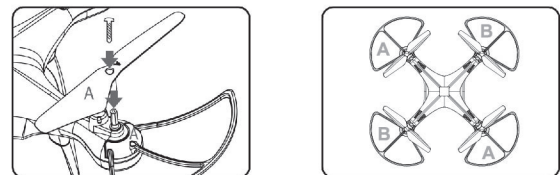

Install propellers with character "A" or "B" to corresponding position. Screw them down clockwise. Propellers with character "A" or "B" are in different shapes, please make sure that they're installed at corresponding position, or the drone will not able to take off, and even turns up side down when trying to take off.

DRONE BATTERY CHARGING

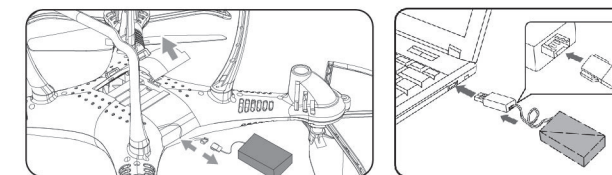

Pull the cover and open, then take out the battery, connect it with charging cable and charger. LED light on the charging cable lights off when the battery is charging, and glows red when charging completed. (Fully charging takes about 60 minutes)

SYNC THE DRONE WITH REMOTE CONTROLLER

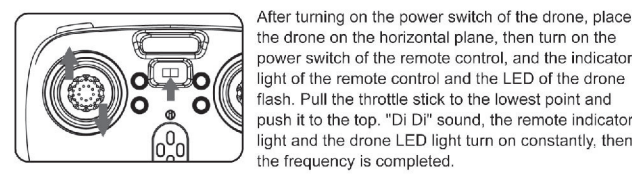

After turning on the power switch of the drone, place the drone on the horizontal plane, then turn on the power switch of the remote control, and the indicator light of the remote control and the LED of the drone flash. Pull the throttle stick to the lowest point and push it to the top. "Di Di" sound, the remote indicator light and the drone LED light turn on constantly, then the frequency is completed.

BASIC FLIGHTS

Left Joystick

The left joystick serves to control the altitude and left and right rotation.

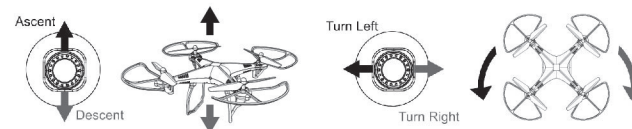

Right Joystick

The right joystick serves to control the forward, backward and sideward flights.

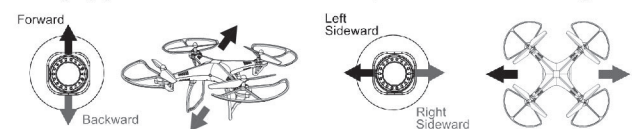

FLIPS AND ROLLS

Flip & Rolls function can be operated when the drone is flying over 3 meters. Press the Flip & Rolls button and pull right throttle to a direction, the drone will flip to the same direction.

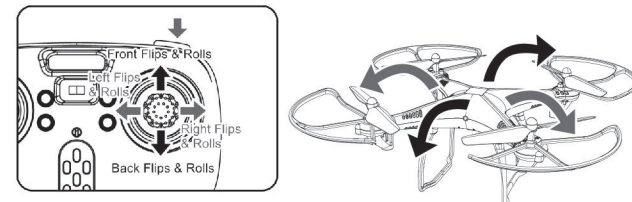

HEADLESS MODE

Put the drone in front of the remote controller, ensure that it's facing forward and then calibrate them horizontally. After taking off, Press the Headless Mode button on controller and it will beeps, which indicates that the Headless Mode is enabled. Indicator lights on the drone will also blinks slowly. To quit Headless Mode, Press the Headless Mode button and it will beeps again, which indicates Headless Mode is disabled.

Please make sure that the player is always facing the same direction when the drone has taken off.

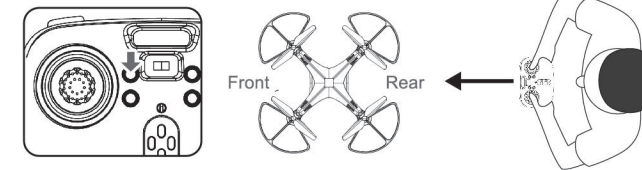

ONE KEY RETURN FLIGHT

Press the one key return flight button, the left lever controls the flying height (the right lever does not need to be operated, otherwise it will exit the return mode), and the aircraft will automatically return backward according to the direction coordinates of the frequency. When the aircraft returns to the safe visual range, turn the right lever in any direction to exit the return mode.

when the drone is flying at altitude 30cm (about 1 feet) or lower height, its flying will be influenced by the vortex generated from propellers and appears to be unstable, which is a normal situation named Wing-In-Ground effect. The lower the drone flies, the bigger influence will be made.

FINE-TUNING

When the Drone is spinning in the air or tends to be in different directions, press and hold the "fine-tuning" button to hear the "di" sound and turn the right operation lever in the opposite direction to adjust and calibrate until the Drone does not fly. For example, when the aircraft takes off and flies forward, press the "fine-tuning" button and then pull the right lever down to balance the aircraft.

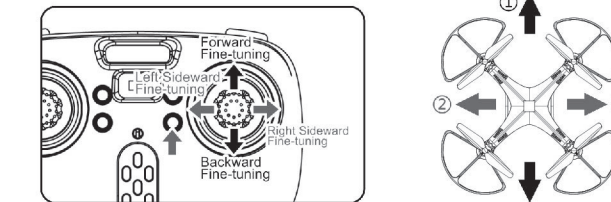

HIGH AND LOW SPEED ADJUSTMENT

The aircraft is equipped with three flight speed files. Press the "Speed switch" button in the upper right corner of the remote control to adjust the flight speed. (The aircraft is set to low speed by default)

KEEP CALM AND SOLVE THE PROBLEMS

PROBLEMS	CAUSES	SOLUTIONS
Control failure.	Not connected with the drone battery.	Connect the battery with the two poles aligned correctly.
	Strong wind force.	Do not fly in heavily windy conditions.
Fail to ascend.	The rotation is slow.	Toggle the throttle joystick upward.
	The drone's battery is not fully charged.	Fully charge the battery.
Landing too soon.	The throttle joystick is pulled down too fast.	Pull down the throttle joystick slowly to perform a smooth landing.
Out of control.	Beyond the effective control range.	Ensure the flying distance is within 50 meters.

NOTE: This equipment has been tested and found to comply with the limits for a Class B digital device, pursuant to part 15 of the FCC Rules. These limits are designed to provide reasonable protection against harmful interference in a residential installation. This equipment generates uses and can radiate radio frequency energy and, if not installed and used in accordance with the instructions, may cause harmful interference to radio communications. However, there is no guarantee that interference will not occur in a particular installation. If this equipment does cause harmful interference to radio or television reception, which can be determined by turning the equipment off and on, the user is encouraged to try to correct the interference by one or more of the following measures:

- Reorient or relocate the receiving antenna.
- Increase the separation between the equipment and receiver.
- Connect the equipment into an outlet on a circuit different from that to which the receiver is connected.
- Consult the dealer or an experienced radio/TV technician for help

Changes or modifications not expressly approved by the party responsible for compliance could void the user's authority to operate the equipment.

*Please read this manual carefully before operation and keep it properly for future reference.