

Automatic Pet Feeder

Video Type Operation Guide



Please Read the Manual Carefully
Before Using the Product

Safety Instruction

- 1.Children must be accompanied by adults to use it.
- 2.Do not use the feeder for pets which cannot reach the food tray or have physical disabilities.
- 3.Do not immerse the base part in water, which will damage electronic components such as control panel.
- 4.Do not put any foreign objects into the pet feeder.
5. Do not put canned or wet food into the feeder.
- 6.Do not disassemble the equipment by yourself.
- 7.Do not modify the pet feeder.
- 8.If the equipment can not work or have damaged accessories, do not try to repair the pet feeder by yourself. Contact the seller immediately and solve it.
- 9.Please make sure the the feeder is unplug and power off when not using or cleaning it.
- 10.If the plug is damp, please turn off the socket rather than trying to unplug the power.

Notice

- 1.Please purchase hard plastic protector from hardware store to protect plugs and power cord then prevent your pet from damaging the accessories.
- 2.Do not put the pet feeder in an high temperature place.The temperature should be within the range of - 10 °C~40 °C.
- 3.Please use alkaline Size D battery for power supply. Do not use rechargeable batteries.
- 4.Check the battery regularly. Please replace the battery before having a trip.
- 5.Do not lift the pet feeder directly with the cover, food bucket and food tray. Hold the base with both hands to lift and carry, while keeping the device in an upright position.
- 6.Only applicable to dry food with a diameter of 2-12mm. Larger food may get stuck or block the food outlet.
- 7.Please read all the notices on the packing and manuals carefully.

Product Image

Front View

- 1.Button To Open Cover
- 2.Food Tank Lid
- 3.Food Tank
- 4.Control Panel
- 5.Camera
- 6.Food Outlet
- 7.Body
- 8.Food Bowl

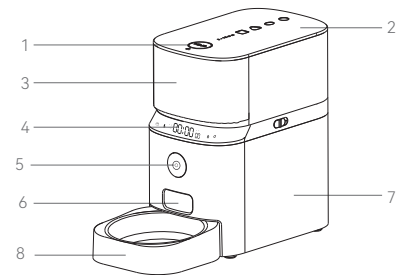

Bottom View

- 9.Battery Compartment
- 10.Speaker
- 11.Type-C Interface
- 12.Rocker Switch

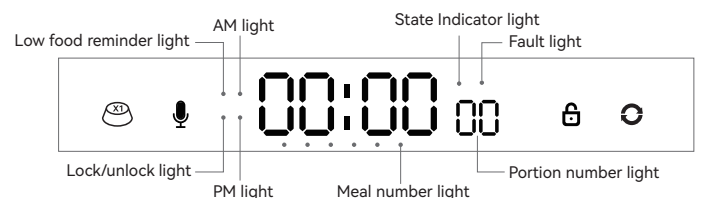
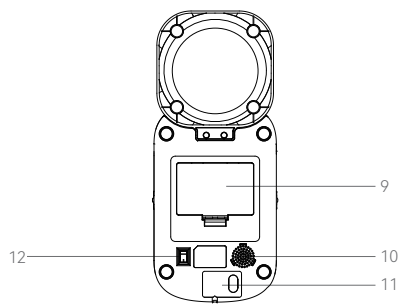

Button Description

☺ Manual Feeding Button:short press this button to serve 1 portion, When there is a recording,the recording will be played twice at the same time.

🔊 Recording Button:1.Long press this button until you hear "di" and start recording.The recording time does not exceed 10 seconds, After you release your hand, you will hear "didi" to indicate that it has been saved.
2.Play recording: short press it and the recording will be played once.

🔒 Lock/Unlock Button: The machine will automatically lock without operating for 30 seconds,the screen panel is off,but status light is always on.In the locked state ,press and hold for 3 seconds to unlock it.In the unlocked state,press and hold for 3 seconds to lock it.

🔄 Reset Button:When the machine is locked or unlocked state, press and hold for 6 seconds until you hear "ding dong" mean that it restores all factory settings, and the feeder reset automatically restarts.

State Indicator light(White light)

- 1.Slow flashing: flash once every 2 seconds, QR code distribution network and AP hotspot distribution network mode
- 2.Steady on:the network connection is successful
- 3.Power on: if the network is not configured, it enter the distribution network mode,and the indicator flashes in white; if the network is already configured, it try to connect to the router, and the indicator is steady on after the connection is successful.

Fault light(Red light)

Indicates the machine failure,the red light is always on.

Low food reminder light(White light)

Steady on: low food reminder.

Lock/unlock light(White light)

Light always on:Lock light always off:unlock

AM light (white light)

When the setting local time during 0-12 o'clock AM, the AM light will light up.

PM light (white light)

When the setting local time during 12-24o'clock PM, the PM light will light up.

Time light (white light)

Indicates local real time(The time correspond to the local time zone after network distribution)

Divider light(White light)

Divider lights for time display,beats for seconds.

Portion number light(White light)

Indicates the feeding food portions.

Meal number light (white light)

The meal number indicator lights up when app sets the feeding plan;The corresponding indicator lights off after feeding plan is executed, up to 6 meals/day ,all the indicator lights are on when the time reach 0 o'clock in the morning.

Note:Low food reminder light only support the product with Low food reminder founction.

Cleaning and Maintenance

Please clean the feeder regularly to keep your pet's health.

When it starts to get dirty and a lot of loose food in the food trough, you can remove the food cover to clean it.

Clean the feeder base containing the control panel with a soft, damp cloth. Do not wet this part. Remember not to rinse it directly with running water.

Do not put the product in the dishwasher, otherwise it will be permanently damaged!

Packing List

After opening the product package, please confirm whether the machine is in good condition.

Please check the list to confirm whether the accessories are complete.

The Feeder ×1

The power adapter ×1

Power Cord ×1

User's guidance ×1

Specification

Food Tank Capacity:5L

Power supply: DC 5V/1A power adapter; 3pcs alkaline D Size batteries

Power adapter: AC110-240V input, DC5V output

N.G:1.95KG

Size: 28×17.2×32cm

FCC WARNING

This device complies with part 15 of the FCC Rules. Operation is subject to the follow ing two conditions : (1) this device may not cause harmful interference, and (2) this device must accept any interference received,inc luding interference that may cause undesired operation.

Any changes or modifications not expressly approved by the party responsible for compliance could void the user's authority to operate the equipment.

NOTE:This equipment has been tested and found to comply with the limits for a Class B digital device, pursuant to Part 15 of the FCC Rules. These limits are designed to provide reasonable protection against harmful interference in a residential installation. This equipment generates, uses and can radiate radio frequency energy and, if not installed and used in accordance with the instructions, may cause harmful interference to radio communications.

However, there is no guarantee that interference will not occur in a particular installation. If this equipment does cause harmful interference to radio or televis ion reception, which can be determined by turning the equipment off and on, the user is encouraged to try to correct the interference by one or more of the following measures:

-- Reorient or relocate the receiving antenna.

-- Increase the separation between the equipment and receiver.

-- Connect the equipment into an outlet on a circuit different from that to which the receiver is connected.

-- Consult the dealer or an experienced radio/TV technic ian for help.

To maintain compliance with FCC's RF Exposure guidelines, This equipment should be installed and operated with minimum distance between 20cm the radiator your body: Use only the supplied antenna.

Instructions

01 | Installation

- Remove the feeder from the box.
- Place the feeder in the suitable location.
- Combine the food tray with the base of the feeder.

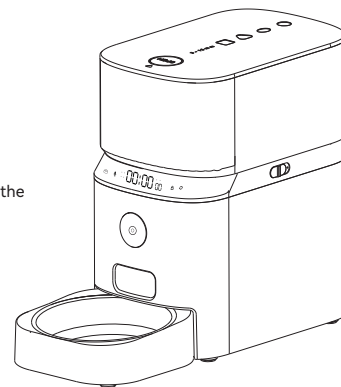

02 | Connect the power supply

- Plug the 5V/1A power adapter into the wall socket and connect the device.
- The bottom of the equipment is a rocker switch, which can cut off or open the power supply.
- Open the battery compartment at the bottom of the feeder and install 3 pcs D size batteries (not necessary) to prevent power failure
- The LED light is turn on to indicate that the feeder is powered on.

Note:

- Does not including battery .
- Before turning on the power, make sure that all parts are clean and completely dry.

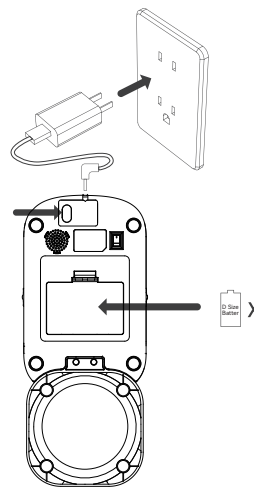

03 | Put pet food into food tank

- Fill the food tank with dry pet food. To close the lid, press and hold the open button, align the side clips, and release the lid lid button to secure the food bucket and lid together.

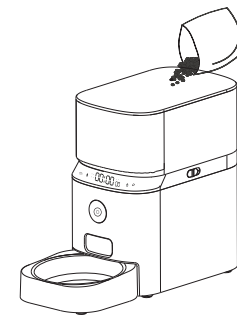

Note:

- Do not place canned or wet pet food.
- The recommended pet food size range is 3-13 mm.

04 | Recording

- Press and hold this button until you hear "di" and start recording. The recording time does not exceed 10 seconds. After you release your hand, you will hear "didi" to indicate that it has been saved. If you are not satisfied, you can repeat this step to replace the previous recording. Delete recording: Press and hold this button until you hear "di", then release your hand, and end the recording when you hear "didi" twice. (In fact, a short period of blank recording is to replace old recording)

Note:

- Recording will be played by pressing when there is a recording.
- Recording will be played once when feeding



05 | Lock/unlock button

- In the unlocked state, press and hold this button for 3 seconds, the white indicator light is always on and the machine is locked; in the locked state, press and hold it again for 3 seconds, the white indicator is off and the machine is unlocked.

note:

- Pressing the feeding button in the locked state does not work, it must be unlocked for normal use.
- The APP operation is not affected in the locked state.



06 | Feeding

- Manual feeding: short press this button to serve 1 portion, recording will be played twice when there is a recording.

note:

- The feeding plan will not be affected



07 | Reset

- Switching distribution network mode: When the machine is locked or unlocked state, long press this button for 6 seconds until you hear "di dong" and it restore all factory settings. The feeder reset automatically restarts.



Smart Life APP specific operations



1. Scan the QR code to download the exclusive APP, register an account and log in

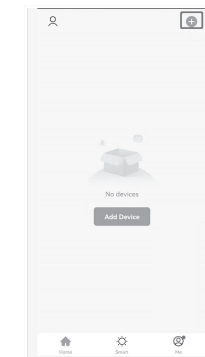

2. Enter the main interface then click on the upper right corner icon or Add Device

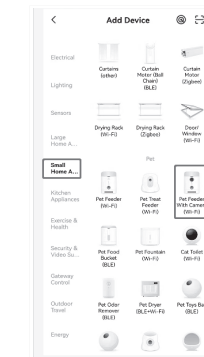

3. Manually Add - Small Home Appliances - Pet Feeder With Camera (Wi-Fi)

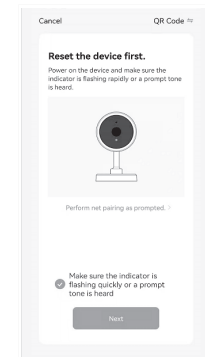

4. Confirm the device indicator is flashing, then next step

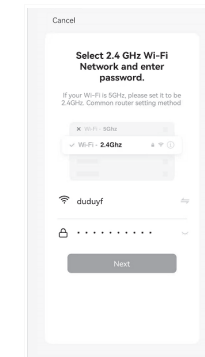

5. Enter the WiFi password. Note that the name and password do not contain Chinese characters and special symbols, and 5G WiFi is not supported.

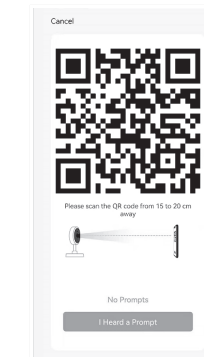

6. Keep the QR code facing the feeder camera at a distance of 15-20cm

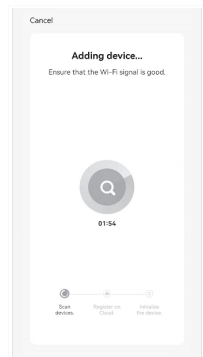

7. Wait for the device connect to the network

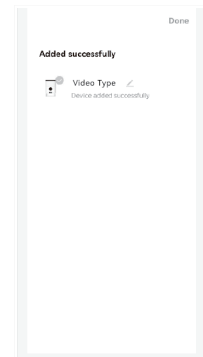

8. Added successfully, you can give a name to the feeder

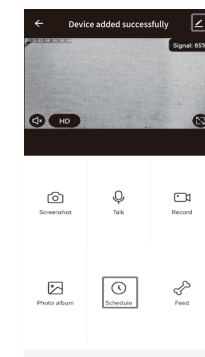

9. Click Schedule to set up a feeding plan

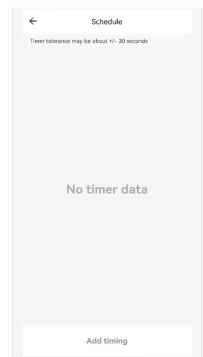

10. Click Add timing to set feeding time and number of meals

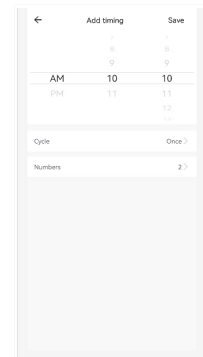

11. Select the time and setting everyday then setting the food portions for each meal

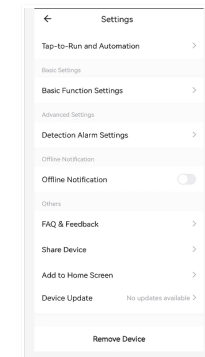

12. Click the icon in the upper right corner of step 9 interface to enter the device settings

Simple Troubleshooting

Q: Cannot be configured

A: 1) WiFi name and password do not use Chinese, not more than 12 digits, please use a combination of numbers and letters, do not support 5G WiFi signal, please use 2.4G WiFi signal.

2) Some software conflicts in the mobile phone will also cause the network connection fail. Please restart the mobile phone, close the non-system software which will automatically work when you turn on the phone, then turn on the mobile phone's bluetooth and position, and then try to reconnect.

Q: The feeder is feeding inaccurately or can not work

A: Please check whether there is too much food on the food tray or the food outlet is blocked; Please clean the food outlet and food channel usually; when using battery power, please check the battery whether is dead or leaking power.

Q: The feeder displays offline

A: Please check whether the distance between the feeder and the router more than 10 meters (effective distance is 10 meters); Please keep the feeder and router without any obstructions. According to the WiFi characteristics, the WiFi signal will drop sharply if there have the obstructions then the connection will unstable which will cause the offline.

Q: No response when turn on the feeder

A: Please check that the feeder is plugged in and the switch is on first. If both of them are ready, please check whether the power adapter and power cord are damaged, and contact customer service for handling.

Hotspot distribution network (optional)

The specific steps are as follows:

Open the Smart Life APP, select Add Device - Small Appliances - Pet Feeder with Camera (Wi-Fi) - Click QR Code on the upper right corner - Change to Wi-Fi Mode - Click AP mode - Enter the WiFi Password - then go to connect SmartLife -XXXX WiFi signal - Back to APP waiting to connect.