

Automatic Pet Feeder Smart Type Operation Guide



Please Read the Manual Carefully
Before Using the Product

Safety Instruction

- 1.Children must be accompanied by adults to use it.
- 2.Do not use the feeder for pets which cannot reach the food tray or have physical disabilities.
- 3.Do not immerse the base part in water, which will damage electronic components such as control panel.
- 4.Do not put any foreign objects into the pet feeder.
5. Do not put canned or wet food into the feeder.
- 6.Do not disassemble the equipment by yourself.
- 7.Do not modify the pet feeder.
- 8.If there is a malfunction or damaged accessory on this device, please do not attempt to repair the pet feeder yourself. Please contact the dealer immediately and resolve the issue
- 9.Please make sure the the feeder is unplug and power off when not using or cleaning it.
- 10.If the plug is damp, please turn off the socket rather than trying to unplug the power.

Notice

- 1.Please purchase hard plastic protector from hardware store to protect plugs and power cord then prevent your pet from damaging the accessories.
- 2.The ambient temperature for normal operation of this feeder is between 0 ° C and 40 ° C. Do not place the feeder in a place that is exposed to sunlight or does not match the ambient temperature.
- 3.Please use alkaline Size D battery for power supply. Do not use rechargeable batteries.
- 4.Check the battery regularly. Please replace the battery before having a trip.
- 5.Do not lift the pet feeder directly with the cover, food bucket and food tray. Hold the base with both hands to lift and carry, while keeping the device in an upright position.
- 6.Only applicable to dry food with a diameter of 3-10mm. Larger food may get stuck or block the food outlet.
- 7.Please read all the notices on the packing and manuals carefully.

Product Image

Front view

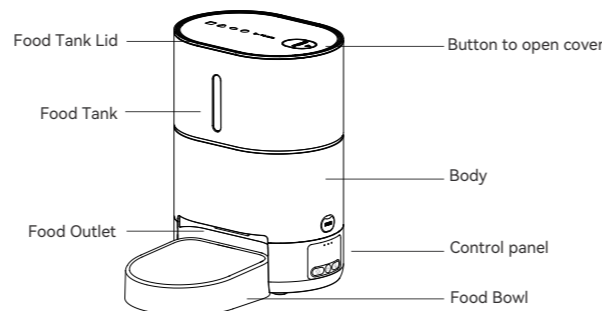

Bottom View

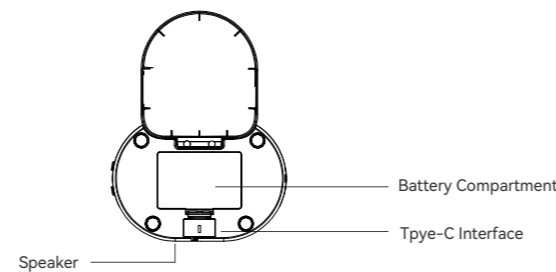

Button Description

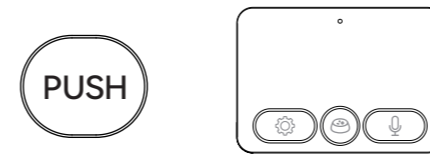

PUSH Press and hold the detachable grain bucket on both sides simultaneously.

- Feeding button: Press once to manually feed once, and when there is a recording, it will play once. Long press for 6 seconds, the red indicator light flashes twice to lock the machine, and long press again for 6 seconds, the red indicator light flashes twice to unlock. In the locked state, you can press and hold the setting button to restore the factory settings. In the locked state, you cannot press the recording and feeding buttons.
- Recording: Press and hold for 3 second to make a "di" sound to start recording, and release to make two "di" sounds to end recording. The recording duration can be up to 10 seconds.
- Reset: Press and hold for 6 seconds to make a three beep sound. After restoring the factory settings, the device will automatically restart (the white light flashes quickly for 7-10 seconds and then restarts. If the white light remains on, it needs to be re wired).

Indicator light color	Indicator light signal	Device status
White	flash	Twice flashing in 1s, WIFI fast connection distribution mode
	Slow flashing	3S flashing once, AP hotspot distribution mode
	light's on	Network connection successful
Red	twinkle	Abnormal detection (motor not rotating)
	flash	Unlock/Lock Status

Low Power Description

1. When the feeder is not connected to a power source, it will change to battery power supply. If you need to use it without plugging it in, please ensure that the battery is installed as required.
2. When the feeder battery is powered, in order to ensure normal feeding and long-term battery life, remote control of the app is not supported, only feeding records and battery level are reported.
3. If you need to use the app function, please connect the power cord and use it after successful network distribution.

Packing list

After opening the product package, please confirm whether the machine is in good condition. Please check the list to confirm whether the accessories are complete.

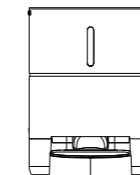

The Feeder×1



The power adapter×1



Power Cord×1

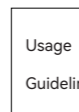

Product Manual×1

Cleaning and Maintenance

For the health of your pet, it is recommended to regularly clean the feeder. When it starts to get dirty and there is a lot of loose food in the food bin, you can remove the food cover for cleaning. Use a soft cloth to clean the feeder base including the control panel. Do not wet the equipment. Clean with running water. Do not put the product in the dishwasher, as it may be permanently damaged!

Specification

Food Tank Capacity:4L
Screen: LCD screen
Power supply: DC 5V/1A power adapter; 3pcs alkaline D Size batteries
Power adapter: AC110-240V input, DC5V output
N.G: 1.52KG
Size: 23*16.4*30.7cm
BC-041-D

Instructions

01 | Installation

- Remove the feeder from the box.
- Place the feeder in the suitable location.
- Combine the food tray with the base of the feeder.

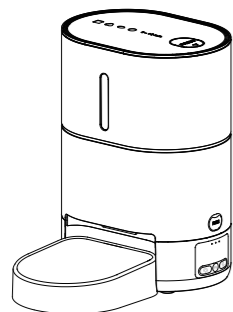

02 | Connect the power supply

- Plug the 5V/1A power adapter into the wall socket and connect the device.
- Open the battery compartment at the bottom of the feeder and install 3 pcs D size batteries (not necessary) to prevent power failure
- The LED light is turn on to indicate that the feeder is powered on.

Note:

Does not including battery .

Before turning on the power, make sure that all parts are clean and completely dry.

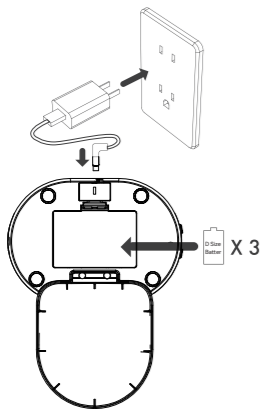

03 | Put pet food into food tank

Fill the food tank with dry pet food then close the lid.

Note:

Do not place canned, wet or moist pet food.

The recommended pet food size range is 3-10 mm.

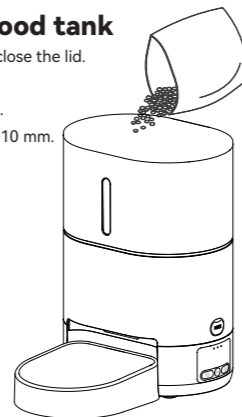

04 | Recording

Long press for 3s until you hear "di" and start recording. The recording time does not exceed 10s, After you release your hand, you will hear "didi" to indicate that it has been saved. If you are not satisfied, you can repeat this step to replace the previous recording.

note:

- Recording will be played by pressing the recording button
- Recording will be played when feeding



05 | Feeding

Manual feeding: short press to serve 1 portion.

Note:

The feeding plan will not be affected



06 | Lock/unlock button

Under unlock state, Long press for 6 seconds and the red indicator light flashes twice to lock the machine, then long press again for 6 seconds and the red indicator light flashes 2 times to unlock.

In the locked state, you can press and hold the SET button to restore the factory settings

Note:

Pressing the feeding button in the locked state does not work, it must be unlocked for normal use.

The APP operation is not affected in the locked state.

Feeder will be locked after 15 seconds not operated.



07 | Reset

Reset(Switching the network configuration mode): When the power is turned on and the network is not configured, the white indicator flashes quickly by default (WiFi quick connection configuration mode), press and hold this button for 7 seconds until you hear "di-didi" beeps, The red/white indicator is always on for 6 seconds and then switches to slow flashing (hot spot network configuration mode). Repeat the operation to switch between the two network modes.



08 | Fault alarm

Food blockage detection: When a food blockage is detected before feeding, manual/planned feeding will not be performed, and a notification of the blockage will be made on the APP side simultaneously;

When a food blockage is detected when feeding in the app (one detection per serving), the APP will record the number of feeding and send a notification of the food blockage.

In normal mode, the device detects whether there is a food block every 2 seconds.

Smart Life APP specific operations



1. Download the App, register a dedicated account and log in

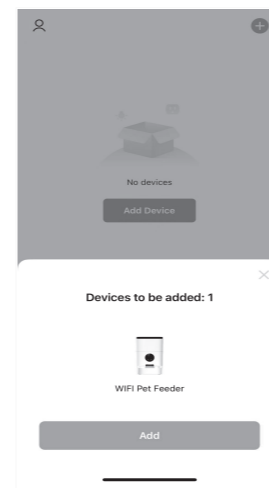

3. First open your phone Bluetooth and allow permissions. After entering the interface, wait for the device to be discovered

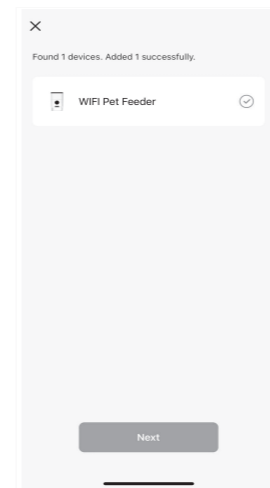

4. Enter a WiFi password (the name cannot be used in Chinese, the password cannot be used for special symbols)

Simple Troubleshooting

Q: Cannot be connected

A: 1) WiFi name and password do not use Chinese, not more than 12 digits, please use a combination of numbers and letters, do not support 5G WiFi signal, please use 2.4G WiFi signal.

2) Some software conflicts in the mobile phone will also cause the network connection fail. Please restart the mobile phone, close the non-system software which will automatically work when you turn on the phone, then turn on the mobile phone's bluetooth and position, and then try to reconnect.

Q: The feeder is feeding inaccurately or can not work

A: Please check whether there is too much food on the food tray or the food outlet is blocked; Please clean the food outlet and food channel usually; when using battery power, please check the battery whether is dead or leaking power.

Q: The feeder displays offline

A: Please check whether the distance between the feeder and the router more than 10 meters (effective distance is 10 meters); Please keep the feeder and router without any obstructions. According to the WiFi characteristics, the WiFi signal will drop sharply if there have the obstructions then the connection will unstable which will cause the offline.

Q: No response when turn on the feeder

A: Please check that the feeder is plugged in and the switch is on first. If both of them are ready, please check whether the power adapter and power cord are damaged, and contact customer service for handling.

Hotspot distribution network (optional)

Please follow the button instructions to switch the network distribution mode to hot distribution network, the LED light flashes slowly, the specific operation steps are as follows:

- Open the Smart Life APP, select Add Device - Manually Add - Small home appliance - Pet Feeder (Wi-Fi) - Enter the WiFi Password Next - Click "Next", select Slow Flash - Click "Connect" - then go to connect SmartLife -XXXX WiFi signal.
- After connecting, return to the previous interface, and then enter the network configuration interface to wait for the connection.

FCC WARNING

This device complies with part 15 of the FCC Rules. Operation is subject to the following two conditions: (1) this device may not cause harmful interference, (2) and this device must accept any interference received, including interference that may cause undesired operation.

Any changes or modifications not expressly approved by the party responsible for compliance could void the user's authority to operate the equipment.

NOTE: This equipment has been tested and found to comply with the limits for a Class B digital device, pursuant to Part 15 of the FCC Rules. These limits are designed to provide reasonable protection against harmful interference in a residential installation. This equipment generates, uses and can radiate radio frequency energy and, if not installed and used in accordance with the instructions, may cause harmful interference to radio communications.

However, there is no guarantee that interference will not occur in a particular installation. If this equipment does cause harmful interference to radio or television reception, which can be determined by turning the equipment off and on, the user is encouraged to try to correct the interference by one or more of the following measures:

-- Reorient or relocate the receiving antenna.

-- Increase the separation between the equipment and receiver.

-- Connect the equipment into an outlet on a circuit different from that to which the receiver is connected.

-- Consult the dealer or an experienced radio/TV technician for help.

To maintain compliance with FCC's RF Exposure guidelines, this equipment should be installed and operated with minimum distance between 20cm the radiator your body: Use only the supplied antenna.