

# Pet Water Fountain

## User Manual Basic Type

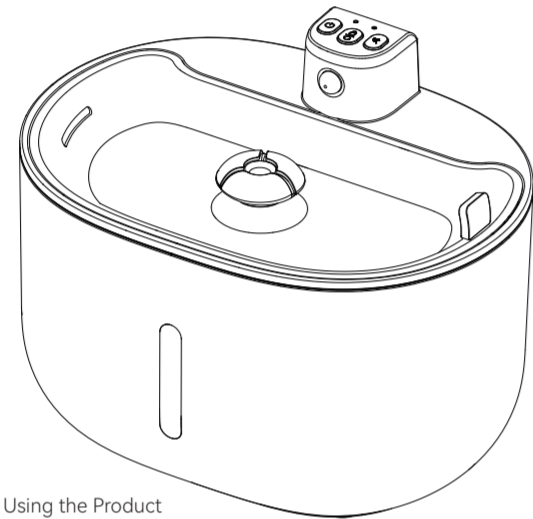

Please Read the Manual Carefully Before Using the Product

## Safety Instruction

- 1.Children must be accompanied by adults to use it.
- 2.When cleaning the water fountain, do not directly wash the bottom with water ,which will easily cause a short circuit at the bottom.
- 3.If the water fountain can not work or have damaged accessories, do not try to repair it by yourself, please contact the seller immediately and solve it.
- 4.Please make sure the the water fountain is unplug and power off when not using or before cleaning.
- 5.If the power plug gets wet, please turn off the socket power rather than trying to unplug the power plug.
- 6.Please use the water fountain on a level ground or place it to the corner of the wall to prevent pets from falling over.

## Packing List

After opening the product package, please confirm whether the machine is in good condition. Please check the list to confirm whether the accessories are complete.

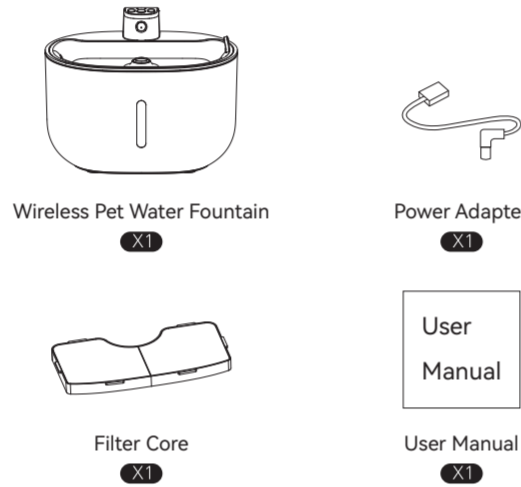

## Product Image

### Top view

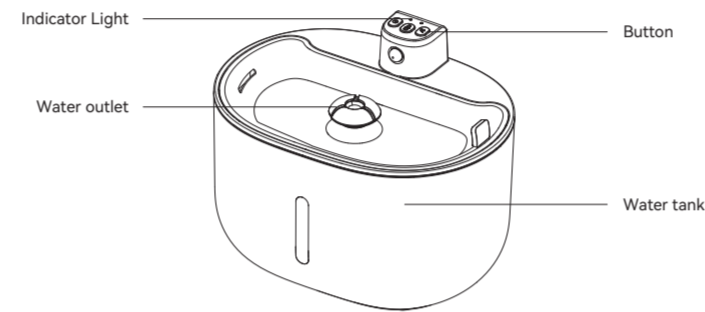

### Back view

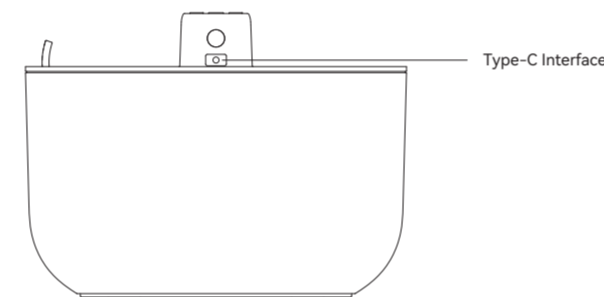

## Install and Use

### 01 | Water Tank Filling

Place the unit on a level surface, open the cap on top of the water tank and add appropriate mineral or tap water, with the water level not exceeding the visible window.

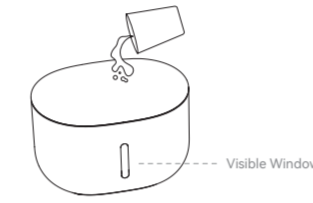

### 02 | Installation of the Tank Cover

After placing the cartridge, align the top cap spout tube with the water basin and install the shower.

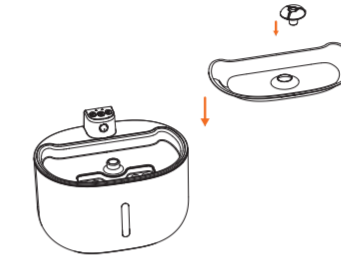

### 03 | Split Part Installation

Remove the fittings, then according to the picture labeling, install the cartridge, then cover the basin, and finally install the shower, the installation is complete.

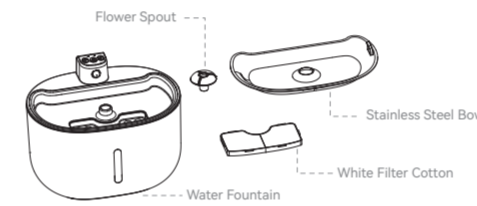

### 04 | Power Up the Device

Please use the DC5V power adapter to connect to the power supply for charging, when the power is sufficient, it can last for about 30 days when set to the inductive water discharge mode.

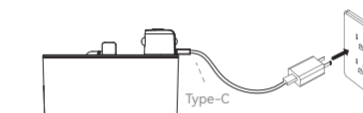

## Functional Description (key operation)

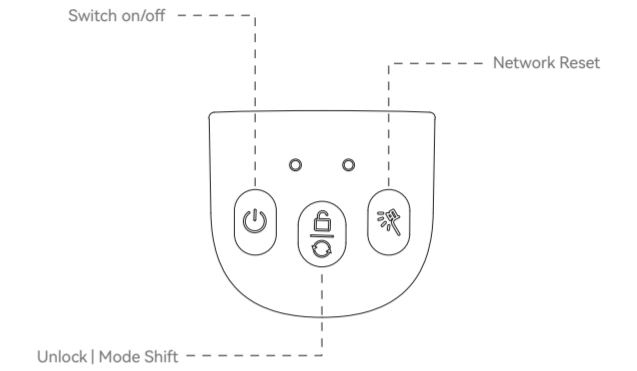

### Switch on/off

- 1) Press and hold the power button for 3 seconds, the device will switch on with a "di" sound.
  - 2) Long press the power button for 3 seconds in unlocked state, the device will be switched off with a "di" sound.
  - 3) After 15 seconds of no operation, the device automatically locks and enters the low-power mode. In this mode, long press the power button for 3 seconds to wake up the device.
- Note: Connecting Type-C power supply can also wake up the device.

### Cleaning reset button

When the button is unlocked, double-click the button and hear two beeps, the cleaning reset is successful and the dispenser will re-enter the cleaning reminder countdown.

## Specification

Food tank capacity: 3L  
Power supply: DC 5V/1A power adapter  
Power adapter: AC110~240V input, DC5V output  
G.W.: 1.15kg  
Size: 245x196x194mm  
BC-111-D

This appliance is not intended for use by persons (including children) with reduced physical, sensory or mental capabilities, or lack of experience and knowledge, unless they have been given supervision or instruction concerning use of the appliance by a person responsible for their safety.

Children should be supervised to ensure that they do not play with the appliance.

### FCC Caution:

Any Changes or modifications not expressly approved by the party responsible for compliance could void the user's authority to operate the equipment.

This device complies with part 15 of the FCC Rules. Operation is subject to the following two conditions: (1) This device may not cause harmful interference, and (2) this device must accept any interference received, including interference that may cause undesired operation.

### IMPORTANT NOTE:

Note: This equipment has been tested and found to comply with the limits for a Class B digital device, pursuant to part 15 of the FCC Rules. These limits are designed to provide reasonable protection against harmful interference in a residential installation. This equipment generates, uses and can radiate radio frequency energy and, if not installed and used in accordance with the instructions, may cause harmful interference to radio communications. However, there is no guarantee that interference will not occur in a particular installation. If this equipment does cause harmful interference to radio or television reception, which can be determined by turning the equipment off and on, the user is encouraged to try to correct the interference by one or more of the following measures:

### Warranty

We offer 1 year warranty for this device. If you have any questions, please contact the dealer or customer service. We will reply you as soon as possible.

## Water Flow Mode

### Child lock (long press for 3 seconds)

- 1) No operation for 15 seconds, the device is automatically locked.
- 2) When the device is locked, press and hold for 3 seconds, the device will be unlocked with "didi".

### Mode shift button (short press once)

Unlocked state, every short press, switch a mode: sensor water / intermittent water / combined mode / continuous water)

### Continuous water dispensing

Water flows continuously when plugged in. (Only available when plugged in, short press button to switch)

### Sensor water dispensing

Water comes out after every interval (short press of the button to switch)

### Intermittent water dispensing

Water flows once after a certain period of time (press the button briefly to switch)

### Combined Mode (Sensor + Intermittent)

Sensor mode and intermittent mode exist at the same time. Water can be triggered by sensing and at the same time water flows at intervals. (Only available when plugged in, short press button to switch)

## Indicator Light Description

### Left: Water flow indicator

1. Green stays on: continuous water dispensing mode
2. Yellow stays on: Sensor water dispensing mode
3. Blue stays on: intermittent water dispensing mode
4. White stays on: combined mode (sensor water + intermittent mode)
5. Red light flashing: water shortage

### Right: Status indicator

1. Low power state: the red light is always on
2. Cleaning due reminder: green light always on
3. Charging indication: white light flashing slowly

## Cleaning and Maintenance

1. Filter cartridges should be replaced regularly, not more than 30 days.
2. It is recommended to clean the water tank and water pump filter cotton within 7 days
3. There are electronic components at the bottom of the water tank, please do not soak.
4. The water dispenser is recommended to use tap water or bucket water.
5. When the red light blinks or the water out of the pump blisters, it means that the water level of the water tank is not enough, please add water immediately.

—Reorient or relocate the receiving antenna.

—Increase the separation between the equipment and receiver.

—Connect the equipment into an outlet on a circuit different from that to which the receiver is connected.

—Consult the dealer or an experienced radio/TV technician for help.

### FCC Radiation Exposure Statement:

This equipment complies with FCC radiation exposure limits set forth for an uncontrolled environment. This equipment should be installed and operated with minimum distance 20cm between the radiator& your body.

## Guide to Frequently Asked Questions

### Q: How long can I use the product without plugging it in?

A: According to the mode of water dispensing and the frequency and length of water dispensing, the power consumption of the product will be different. According to the actual test of Duodu Pet Lab, under the mode of sensing water dispensing, the product can last for about 30 days or more (according to the number of times the cat is close to the water and the length of time there will be differences).

### Q: How to determine the battery is almost out of power?

A: You can check the right side of the indicator, when the indicator light is always red, the battery power is low, you need to charge in time.

### Q: Why is it dirtier when dogs use it than when cats use it?

A: Because cats and dogs drink water in a very different way, dogs drink water, saliva and so on will flow into the water, increase the water material, will be more easily dirty than cats use. It is recommended that the frequency of cleaning the water dispenser is no less than 3 days/times for families where dogs use it. Or when adding water, at the same time for cleaning, to maintain clean water quality and water dispenser of healthy water.

### Q: Why does my water dispenser not dispense water after a period of time?

A: Although the filter element has the effect of filtering debris, but if you do not clean up for a long time, the surface of the filter element will be covered with more pet hair and impurities, blocking the filter cotton, can not be good filtration of the inflow of water, and then there will be impurities and pet hair flowing into the water tank, in the process of water, impurities or hair will block the pump. In such cases, please replace the filter element in time and clean the water dispenser, note that the water pump also needs to be cleaned to.

### Q: Why can't water come out instantly when my pet arrives near the water dispenser?

A: The sensor in the pet to reach the sensor distance, the need to transmit data for analysis, there will be a certain time (1-3) seconds of delay, is normal.

### Q: Why obviously there is water in the bucket, it can not come out of the water?

A: The water pump has a certain height, the amount of water is too small, it can not cover the surface of the water pump, please make sure that the water level can cover the entire pump when using.

### Q: Why does water come out of the dispenser even when I pass by or near it myself?

A: This induction system is effective for mobile living bodies, does not distinguish between living species.

### Q: Can I use my home computer charger or other Type-C to charge my water dispenser?

A: In order to protect the safety and effectiveness of electronic components, electrical appliances have a limited input current; our water dispenser limits the input specifications to 5V-1A, in the process of using the recommended use of the original adapter, such as the need for other adapters, you need to check the specifications are consistent.

### Q: When cleaning, can I flush the part with buttons?

A: The button part with precision components, can not be directly immersed in water for cleaning, such as water beads or slight sprinkles, etc., need to be wiped dry in time.