



6+

## CONTENTS AND BATTERY INSTALLATION

## Contents

Porsche Taycan Turbo S  
Remote Control  
USB-C Charging Station

## Battery Installation

The vehicle requires 1 3.7V 600mAh rechargeable lithium battery (included) and the remote requires 2 AAA 1.5V alkaline batteries (not included).

Use a Phillips head or Cross screwdriver to loosen the screw securing the battery cover on bottom of the remote. Insert the batteries, ensuring the correct polarity. Replace the battery cover and tighten the screw.

Charge your Porsche Taycan Turbo S by plugging the USB end of the charging cable into a AC wall adapter (not included). Insert the charging station cable into the left charging port of the Porsche Taycan Turbo S. The battery will take approximately 100 minutes to fully charge. The red indicator light will turn off when the Porsche Taycan Turbo S is fully charged.

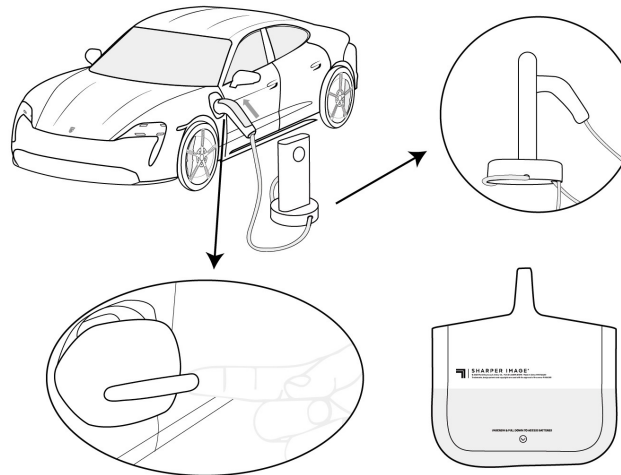

## START UP

1. Turn on the Porsche Taycan Turbo S by pressing the power button on the bottom of the vehicle.
2. Turn on the remote by turning the power knob clockwise.
3. Wait for the pulsing remote pair light to quit blinking and remain solidly lit, indicating the remote and vehicle have been successfully paired.
4. Place the vehicle on a hard, flat surface and control the vehicle using the control sticks. The left stick controls forward and reverse movement. The right stick controls left and right turns.

## CONTROLS

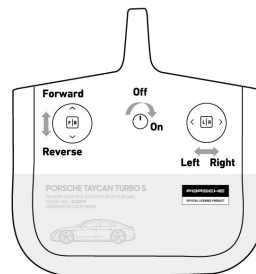

## BATTERY WARNING:

- Do not mix old and new batteries.
- Do not mix alkaline, standard (carbon-zinc), or rechargeable batteries.
- Alkaline batteries are recommended. Use only the specified voltage.
- Insert batteries using the correct polarity. Always use, replace, and recharge (if applicable) batteries under adult supervision.
- Do not short-circuit the battery supply terminals.
- Do not dispose of batteries in fire, batteries may explode or leak.
- Remove batteries before storing.
- Recycle or dispose of batteries according to federal, state, and local laws.
- Keep these instructions for future reference.

## Rechargeable Battery Warning:

- This product contains batteries that are non-replaceable.
- There is a risk of fire and personal injury if battery is punctured, damaged, or misused.
- Do not dismantle, crush, incinerate or short-circuit battery.
- Never expose battery to extreme temperatures or moisture.
- Keep away from flammable materials and direct sunlight.
- **Only charge using the provided charger, cable, and/or adapters.**
- **Rechargeable battery is only to be charged by an adult.**
- Adult supervision is required while charge the battery.
- Allow battery to cool to room temperature before charging.
- Charge on a non-flammable surface and keep away from flammable products.
- Discontinue charging if battery becomes hot, swells, smokes, or gives off a strong odor.
- Battery chargers used with the product are to be regularly examined for damage to the cord, plug, enclosure, and other parts. In the event of such damage, chargers must not be used until the damage has been repaired.
- Recycle or dispose of battery according to federal, state, and local laws.

## SAFETY WARNINGS

- Adult supervision required.
- Do not use people or animals as obstacles.
- Never operate your vehicle in inclement weather, rain, or standing water.
- Keep fingers, hair, and loose clothing away from wheels while vehicle is in motion.
- Do not expose to extreme temperatures.
- Do not leave vehicle or transmitter near sources of heat or under direct sunlight for long periods of time.
- Adult supervision is recommended when operating the vehicle.
- Thoroughly inspect products before every use. If the product appears worn, frayed/splintered, cracked, or broken in any manner, discontinue use and discard immediately.

NOTE: This equipment has been tested and found to comply with the limits for a Class B digital device, pursuant to Part 15 of the FCC Rules. These limits are designed to provide reasonable protection against harmful interference in a residential installation. This equipment generates, uses and can radiate radio frequency energy and, if not installed and used in accordance with the instructions, may cause harmful interference to radio communications.

However, there is no guarantee that interference will not occur in a particular installation. If this equipment does cause harmful interference to radio or television reception, which can be determined by turning the equipment off and on, the user is encouraged to try to correct the interference by one or more of the following measures:

- Reorient or relocate the receiving antenna.
- Increase the separation between the equipment and receiver.
- Connect the equipment into an outlet on a circuit different from that to which the receiver is connected.
- Consult the dealer or an experienced radio/TV technician for help.

**Warning:** Changes or modifications to this unit not expressly approved by the party responsible for compliance could void the user's authority to operate the equipment.

This device complies with Part 15 of the FCC Rules. Operation is subject to the following two conditions: (1) this device may not cause harmful interference, and (2) this device must accept any interference received, including interference that may cause undesired operation.



## WARNING:

CHOKING HAZARD - Small Parts. Not For Children Under 3 Years.

Sharper Image® name and logos (including the 77 logo) are trademarks or registered trademarks. Distributed by and © 2021 MerchSource, LLC, Irvine, CA 92618. All rights reserved.

Porsche, the Porsche shield and the distinctive design of Porsche cars are trademarks and trade dress of Porsche AG. Permission granted.

KEEP THIS INSTRUCTION MANUAL AS IT CONTAINS IMPORTANT INFORMATION FOR FUTURE REFERENCE. Due to continuous product improvements, the picture on the manual may differ slightly from the actual product.

FOR CUSTOMER SUPPORT, PLEASE CALL

1-800-374-2744