

正面

Detachable 4in1 Wireless Charger User Manual



Connect to Power Adapter



System Specifications

Product model	:W401
Input	:5V/3A 9V/2A 12V/1.5A
Output	:15W/10W/7.5W/5W/2.5(For iWatch)
Receiving distance	:2-8mm
Conversion	:> 73%
Frequency	:100-205 kHz

Mobile phone charging right way

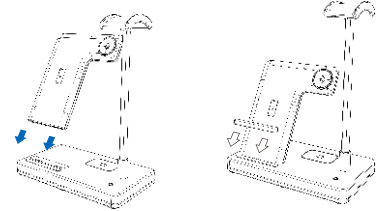

- ① The blue light of the electricity charging board turns off after three seconds, charging plate enters into standby status.
- ② When the LED indicator flickers in blue, the device is under the process of charging status. If the LED indicator keeps solid green, the device is fully charged and the charging plate goes into standby status.

Compatibility

10W Fast Charge Mode:
iPhone 13/12/12 Pro/12 Pro max/12 mini/Samsung Galaxy S21/S20/S10/S9+/S9/S8+/S7 edge/S7/S6 edge+ Samsung Note 10/Note 9/Note 8/Note 7
7.5W Fast Charge Mode:
iPhone SE / 11/ 11 Pro / 11 Pro Max / XS Max / XR / XS / X / 8 / 8 Plus
5W Standard Charge Mode:
AirPods 2/AirPods Pro/All Qi-enabled phones and devices
2W:Apple watch series 6/SE/5/4/3/2/1

反面

Notes:

Please pay attention to the following issues, otherwise it may cause abnormal charging, high charging temperature, intermittent charging, or even not charging.

1. Please put the device at the center of charge area to ensure stable charging. (as picture shows)
2. We recommend using a QC2.0/3.0 Quick Charger adapter (9V/2A) If you charge three devices simultaneously, 5V/3A charging speed will be slower than QC charging.
3. The charging distance is 2-8mm, please remove the phone case if the thickness is up to 3mm and above.
4. The Watch device has overheating protection. When the temperature reaches 40 degrees, the charging will be stopped automatically. When the temperature turns normal, charging keeps continue.
5. Do not put cases made of metal and attachments such as magnets, cards, and grips around the devices, which will interfere with charging.
6. The lower temperature, the faster charging speed. The charging speed is faster in winter than in summer.
7. Do not charge in high temperature and humidity to avoid damage the circuit.
8. Put it at the place that children can't reach to avoid to unnecessary accidents.

The involved images are sketch maps, the final product as per the material subjects
Includes: 1 X Wireless Charger, 1 X Type C Cable, 1 X User Manual, 1 X QC3.0 adapter, Increase the bar*1

FCC warning:

Any Changes or modifications not expressly approved by the party responsible for compliance could void the user's authority to operate the equipment.

Note: This equipment has been tested and found to comply with the limits for a Class B digital device, pursuant to part 15 of the FCC Rules. These limits are designed to provide reasonable protection against harmful interference in a residential installation. This equipment generates uses and can radiate radio frequency energy and, if not installed and used in accordance with the instructions, may cause harmful interference to radio communications. However, there is no guarantee that interference will not occur in a particular installation. If this equipment does cause harmful interference to radio or television reception, which can be determined by turning the equipment off and on, the user is encouraged to try to correct the interference by one or more of the following measures:
-Reorient or relocate the receiving antenna.
-Increase the separation between the equipment and receiver.
-Connect the equipment into an outlet on a circuit different from that to which the receiver is connected.
-Consult the dealer or an experienced radio/TV technician for help.

This equipment complies with FCC radiation exposure limits set forth for an uncontrolled environment. This equipment should be installed and operated with minimum distance 20cm between the radiator & your body.

This device complies with part 15 of the FCC rules. operation is subject to the following two conditions:(1)this device may not cause harmful interference, and

(2)this device must accept any interference received, including interference that may cause undesired operation