

W320折叠无线充说明书

3-In-1 Charging Station — User Manual —



18W

Model No: W320

Product Components

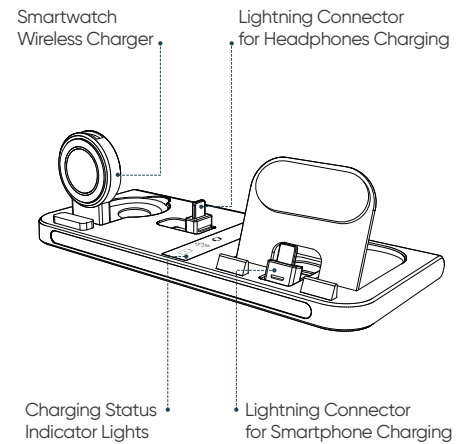

.....> 2

Product Specifications

Product Model: W320
Input : 5V/3A
Output : 10W for Smartphone
5W for Headphones
3W for Smartwatch
Frequency : 325KHz

Charging Indicator

1. The LED indicator lights turn green, finally turning off after 5 seconds, which indicates that it has entered the standby state.
2. The LED indicator light turns blue, indicating the corresponding device is charging, and the blue light turns off after 20 seconds.

Compatible Devices

1. Smartphone

iPhone6/iPhone6Plus/iPhone6s/iPhone6sPlus/
iPhone7/iPhone7Plus/iPhone8/iPhone8Plus/iPhoneX/
iPhoneXS/iPhoneXSMax/iPhoneXR/iPhone11/

.....> 3

iPhone6/iPhone6Plus/iPhone6s/iPhone6sPlus/
iPhone7/iPhone7Plus/iPhone8/iPhone8Plus/iPhoneX/
iPhoneXS/iPhoneXSMax/iPhoneXR/iPhone11/
iPhone11Pro/iPhone11ProMax/iPhoneSE2/iPhone12/
iPhone12mini/iPhone12Pro/iPhone12ProMax/iPhone13/
iPhone13mini/iPhone13Pro/iPhone13ProMax

2. Smartwatch

Apple Watch1/2/3/4/5/6/SE/7

3. Headphones

AirPods 1/2/3/Pro

Operation Instruction

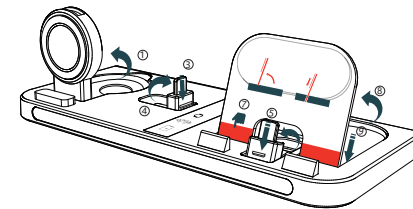

.....> 4

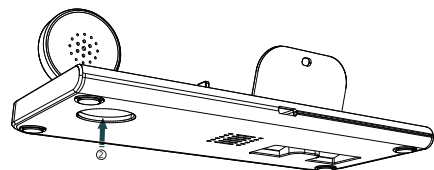

Two Ways to Start Smartwatch Charging:

- ① Lift the wireless charger upwards to stand up.
- ② Or push the bottom upwards with your finger.

Two Steps to Start Headphone Charging:

- ③ Lift the lightning connector up with your finger.
- ④ Adjust the position to keep the connector vertical.

Two Steps to Start Smartphone Charging:

- ⑤ Lift the lightning connector up with your finger.
- ⑥ Adjust the position to keep the connector in place.

Three Steps to Use the Phone Stand:

- ⑦ Press the red area to lift the phone stand a little.
- ⑧ Use the finger to lift it and find a supporting angle.
- ⑨ Finally, insert the stand into the slot for stabilization.

.....> 5

Tips:

1. Before charging, please get the stand in place first, then place your phone on the stand and readjust the lightning connector for charging.
2. Lift the stand and lay it down, back to the original position when not using it.

Notes

Please pay attention to the following issues. Otherwise, it may cause abnormal charge, high temperature, intermittent charging issue, or that it's even not charging at all.

1. Please put the device at the center of the charging area to ensure stable charging for your smartwatch.
2. The watch charger comes with overheat protection. When the temperature reaches 40 degrees Celsius, it will stop charging automatically and continue charging when it is back to normal.
3. Do not put the cases made of metal or attachments such as magnets, cards, and grips around the devices, which will interfere with charging.

.....> 6

FCC warning

Any Changes or modifications not expressly approved by the party responsible for compliance could void the user's authority to operate the equipment.

Note: This equipment has been tested and found to comply with the limits for a Class B digital device, pursuant to part 15 of the FCC Rules. Operation is subject to the following two conditions:
(1) This device may not cause harmful interference, and
(2) this device must accept any interference received, including interference that may cause undesired operation.
These limits are designed to provide reasonable protection against harmful interference in a residential installation.

.....> 7

This equipment generates uses and can radiate radio frequency energy and, if not installed and used in accordance with the instructions, may cause harmful interference to radio communications. However, there is no guarantee that interference will not occur in a particular installation. If this equipment does cause harmful interference to radio or television reception, which can be determined by turning the equipment off and on, the user is encouraged to try to correct the interference by one or more of the following measures:

- Reorient or relocate the receiving antenna.
- Increase the separation between the equipment and receiver.
- Connect the equipment into an outlet on a circuit different from that to which the receiver is connected.
- Consult the dealer or an experienced radio/TV technician for help.

This equipment complies with FCC radiation exposure limits set forth for an uncontrolled environment. This equipment should be installed and operated with minimum distance 20cm between the radiator & your body.

.....> 8

提示：
尺寸：65*85mm
印刷：折页

日期：2022-05-25

比例：1:1

版本：A0