

正面

Wireless Charging

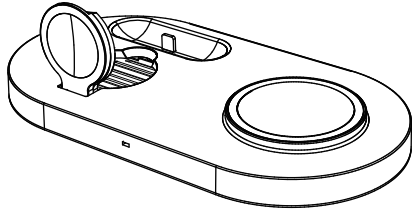

User Manual

Specification yield

Model: CW310
Input: 5V/2A 9V/2A
Output: 15W/10W/7.5W/5W for Cellphone, 3W for Watch, 5W for Earbuds

Compatible Models

1. For iPhone

For iPhone: iPhone 14, iPhone 14 Plus, iPhone 14 Pro, iPhone 14 Pro Max, iPhone 13, iPhone 13 Pro, iPhone 13 Pro Max, iPhone 13 mini, iPhone 12, iPhone 12 mini, iPhone 12 Pro, iPhone 12 Pro Max, iPhone 11, iPhone 11 Pro, iPhone 11 Pro Max, iPhone XS, iPhone XS Max, iPhone XR, iPhone XR Max, iPhone 8, iPhone 8 Plus,

2. For AirPods

AirPods 1, AirPods 2, AirPods 3, AirPods Pro, AirPods Pro 2

3. For iWatch

Apple watch 2/3/4/5/6/SE/7/SE 2/Ultra/Series 8

Product Description

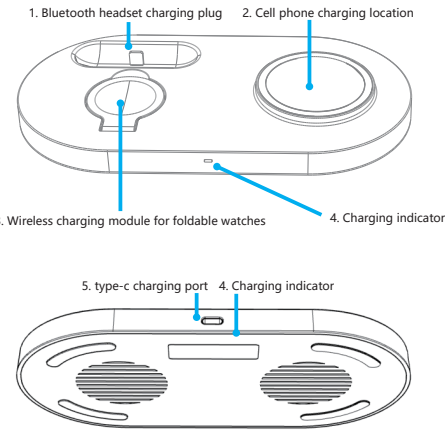

2. Bluetooth headset charging: plug the Bluetooth headset in the Bluetooth headset charging base charging (Note: Please remove the protective case on the Bluetooth headset, otherwise it may cause bad charging and can not be charged.)

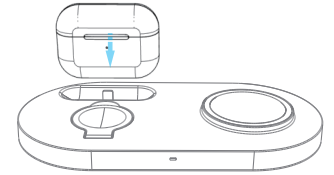

3. Watch charging: Please stand up the wireless charging module of the watch, then put the watch on it and align it with the module, when the watch shows the "charging" logo, it means the watch is charging normally.

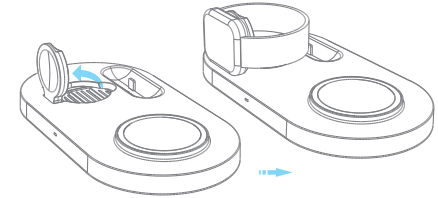

反面

4. Mobile phone charging: the blue light is always on when the phone is charging, the blue light is always off when the phone is not charging or full, and the light flashes when the phone is not charging properly.

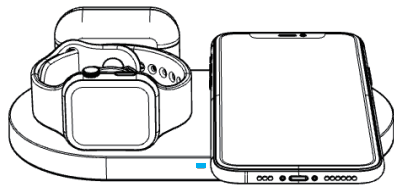

Warm Tips

Please pay attention to the following issues, otherwise it may cause irregular charging, high charging temperature, intermittent charging, or even no charging.

1. Please place your phone/watch/ in the correct charging area.
2. The charging distance is 2-8 mm, please do not wear a protective cover thicker than 3 mm.
3. No metal or magnetic objects in the center 6 cm of the back of the phone during charging.
4. The lower the temperature, the faster the charging speed.
5. Charging speed is faster in winter than in summer.
6. Please do not charge in a hot and humid environment to avoid damaging the circuit.
7. Please put it out of reach of children to avoid unnecessary accidents.
8. Make sure to use the original charging cable and adapter.

About the FCC

This equipment complies with FCC radiation exposure limits set forth for an uncontrolled environment. This equipment should be installed and operated with minimum distance 20cm between the radiator & your body.

This device complies with part 15 of the FCC rules operation is subject to the following two conditions:

- (1) this device may not cause harmful interference.
- (2) this device must accept any interference received including interference that may cause undesired operation.

FCC Warning:

Any Changes or modifications not expressly approved by the party responsible for compliance could void the user's authority to operate the equipment.

Note: This equipment has been tested and found to comply with the limits for a Class B digital device, pursuant to part 15 of the FCC Rules. These limits are designed to provide reasonable protection against

harmful interference in residential installation. This equipment generates uses and can radiate radio frequency energy and if not installed and used in accordance with the instructions may cause harmful interference to radio communications.

However there is no guarantee that interference will not occur in a particular installation. If this equipment does cause harmful interference to radio or television reception which can be determined by turning the equipment off and on. The user is encouraged to try to correct the interference by one or more of the following measures:

- Reorient or relocate the receiving antenna.
- Increase the separation between the equipment and receiver.
- Connect the equipment into an outlet on a circuit different from that to which the receiver is connected.
- Consult the dealer or an experienced radio/TV technician for help.