



TANK S1

User Manual

Content

1. Packing List	2
2. About the Smartwatch	3
3. About Smartwatch Keys	4
4. Charging Tips	5
5. Pair & Connect	6
6. Audio Settings	9
7. Customize Your Watch Face	16
8. Theme Setting	17
9. Settings on "Sports Modes with Smart Recognition"	17
10. Quality Guarantee	19
11. FAQs	19
12. To Download User Manuals in PDF	19
13. Key Safety Tips	20
14. Disclaimer	20
15. FCC Warning	20

1. Packing List

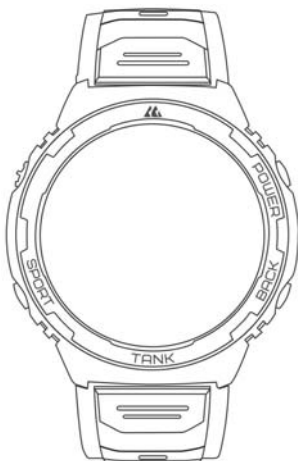

Smartwatch (Strap Included)



Magnetic Charging Cable

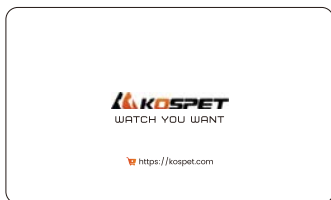

Warranty Card



User Manual

2. About the Smartwatch



3. About Smartwatch Keys

1) Power Key:



Press and hold for 2 seconds to turn on/off the smartwatch.

Short press to turn on/off the display.

2) Back key:



Short press to return to the previous menu.

Short press the Home screen to turn on/off the display.

3) Sport key:

a. Short press to enter Sports Modes.

After entering a sports mode, press and hold for 2 seconds to end it and save sports record.

b. Double-click to enter Voice Assistant.

Press and hold for 2 seconds to use Emergency SOS.



4. Charging Tips

- Please fully charge the smartwatch before using it.



- When charging the smartwatch, please keep the magnetic charging cable away from any metal conductor to prevent a fire.



5. Pair & Connect

1) To install the App (KOSPET FIT)

Two alternative ways to download the App

- a. Use your smartphone to scan the QR code below to download KOSPET FIT.



App QR code



KOSPET FIT

b. Enter "KOSPET FIT" in App Store or Google Play to find and download the App.



App Store

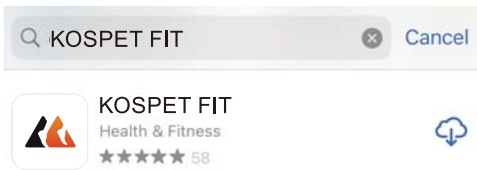

Google Play

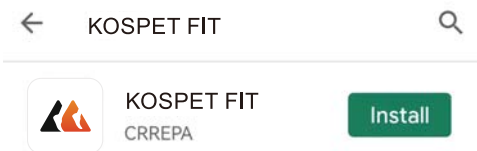

2) Pair and connect as follows

a. When first using KOSPET FIT, please allow it to access Bluetooth, location and grant other necessary permissions on your compatible smartphone.

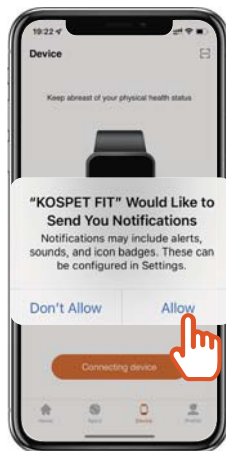

- b. Enter "Connecting device" in KOSPET FIT, find TANK S1 and tap "Pair".

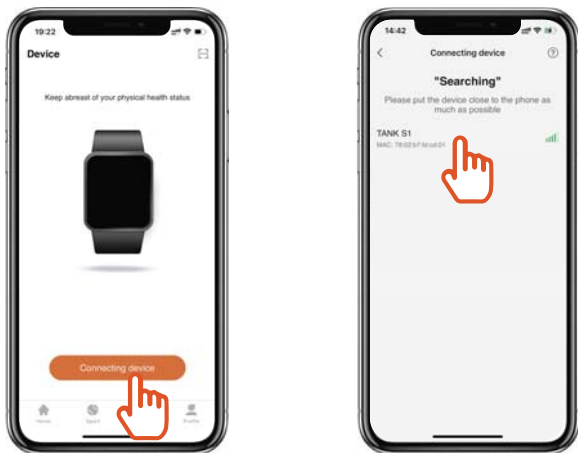

- c. Allow KOSPET FIT to access notifications of your compatible smartphone to connect the App with the smartwatch.

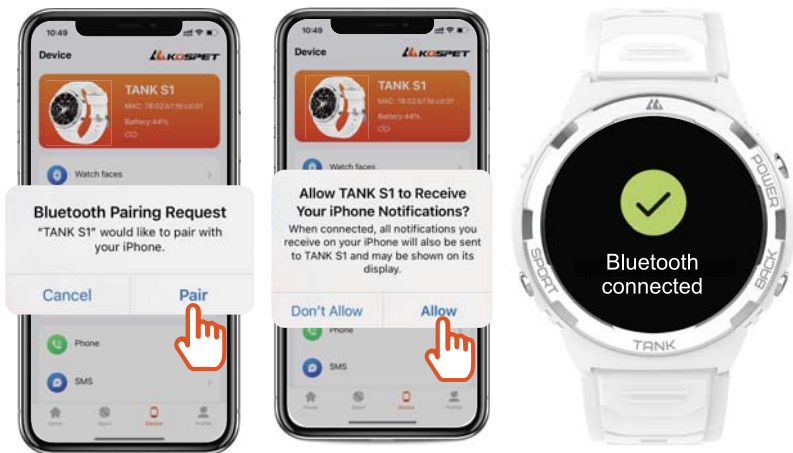

d. Necessary notifications can be set in KOSPET FIT for calls, text messages and applications.

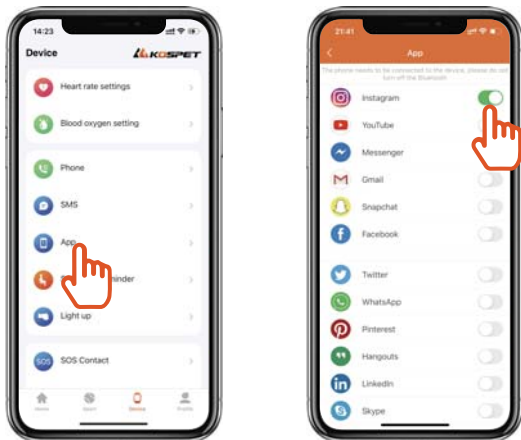

6. Audio Settings

1) Setting Bluetooth Calling:

a. A maximum of 70 contacts of your compatible smartphone can be transferred to the smartwatch via KOSPET FIT.

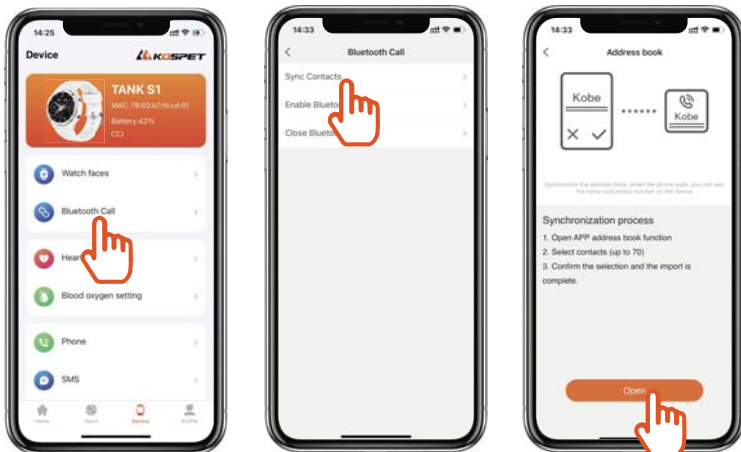

b. Set up Emergency Contacts in KOSPET FIT.

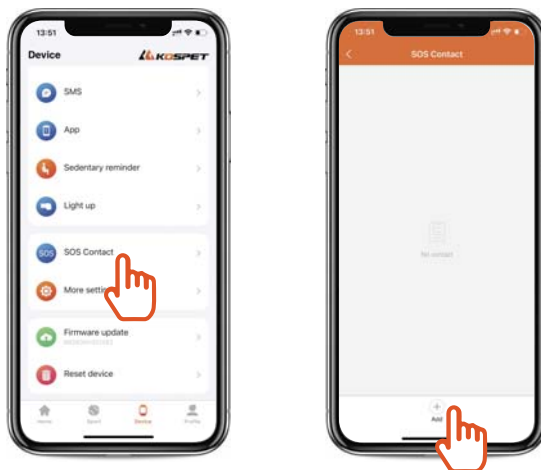

c. Tap  to turn on/off Bluetooth Calling.



d. Once Bluetooth calling is on, you can receive incoming phone calls on the smartwatch.



e. Once Bluetooth calling is on, you can also make phone calls directly on the smartwatch.



f. For users with an Android smartphone or an iPhone below iOS 15.0 to enable Bluetooth calling, please connect Bluetooth audio of the smartwatch as follows:

Steps to enable Bluetooth calling on iPhone:

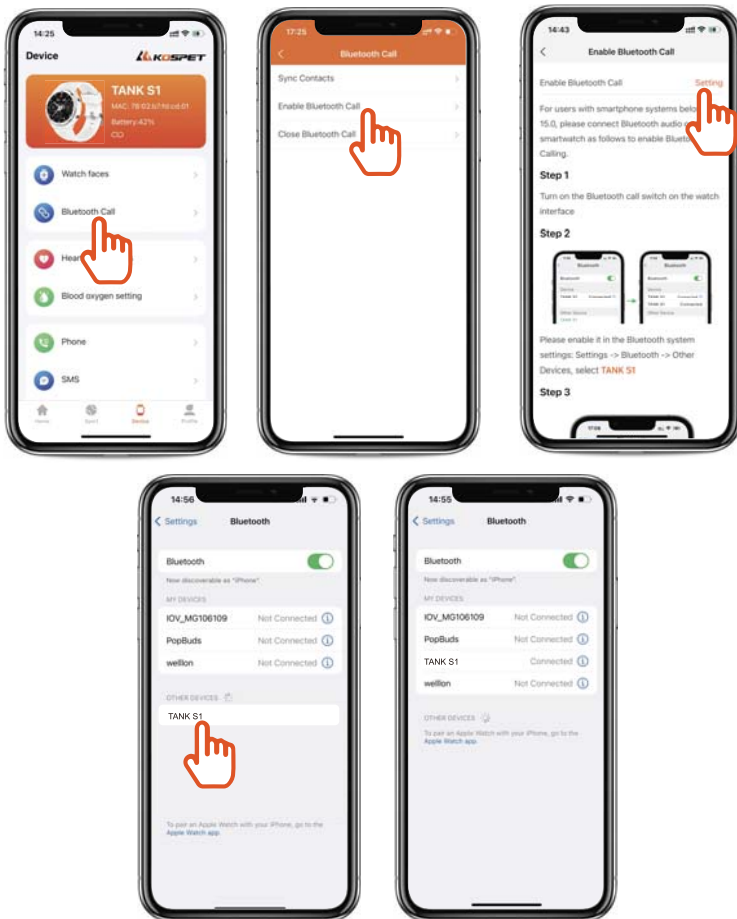

Steps to enable Bluetooth calling on Android smartphones:

Step I: Once you've connected your smartwatch with the App, please tap "Pair" in the Bluetooth pairing request to enable Bluetooth Calling.

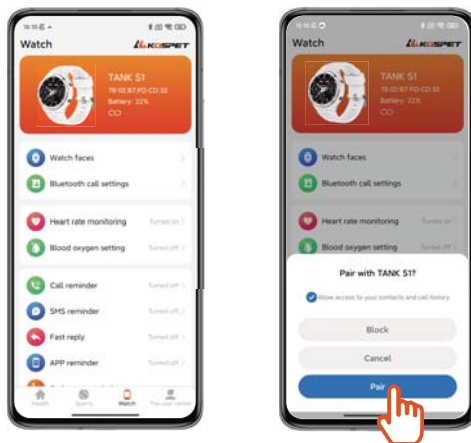

Step II: Once you've connected your smartwatch with the App, please operate as follows to enable Bluetooth calling if you don't find the Bluetooth pairing request or you've tapped "Cancel" by mistake.

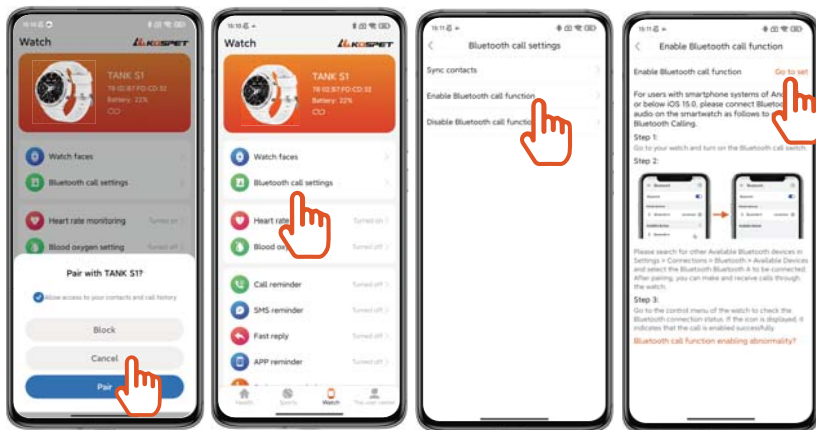

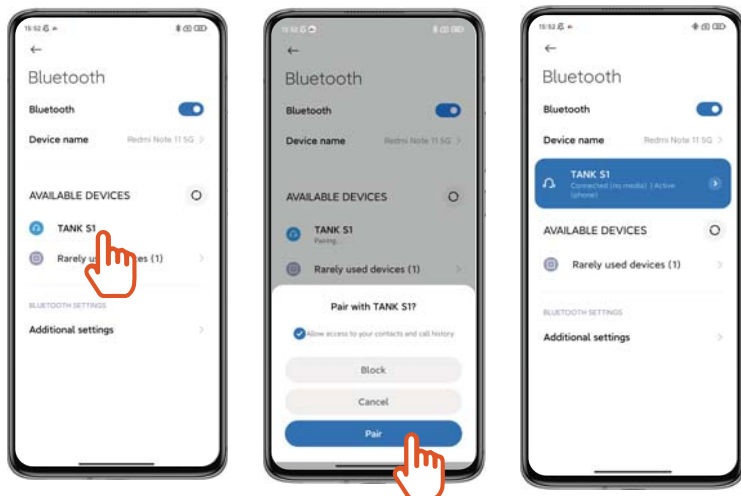

2) Setting Up Multimedia Audio:

a. Enter Settings → Sound settings. Turn on Media Audio and Ringtone to sync and play audio on the smartwatch from your compatible smartphone.





- b. Open "Music" on the smartwatch to play music from your compatible smartphone.



7. Customize Your Watch Face

1). Touch and hold the watch face for 2 seconds to quickly switch from one face to the next.



2). Setting Always-on Display

Enter Settings → Always-on Display and turn on Always-on Display.



8. Theme Setting

Tap  to quickly switch between themes.



9. Settings on "Sports Modes with Smart Recognition"

Enter Settings → Sport recognition and turn on Sport recognition to enable the smartwatch to sense five sports movements automatically – walking, running, cycling, elliptical and rower.



a. Walking can be activated by a continuous walk for 10 minutes.



b. Cycling can be activated by a continuous cycling for 10 minutes.



c. Running, Elliptical and Rower can be activated by continuous exercises for 3 minutes in running, on an elliptical trainer, and a rowing machine respectively.



10. Quality Guarantee

To learn about our latest warranty policy, please visit KOSPET official website at:

<https://kospet.com/pages/kospet-worry-free>

Or you can contact our after-sales service via email:
after-sales@kospet.com

11. FAQs

Enter KOSPET FIT and tap Help to view FAQs.

12. To Download User Manuals in PDF

Scan the QR code below to enter KOSPET Official Community and download the user manuals in PDF.



Official Community

13. Key Safety Tips

- 1) Do not expose the smartwatch to extremely high-temperature environments like scorching sun rays or around high-temperature devices, such as heaters, ovens, microwave ovens or water heaters. High-temperature environments may cause battery explosions or other safety accidents.
- 2) The product includes an irremovable lithium-polymer battery. Non-professionals are not allowed to disassemble it in case of a safety accident.
- 3) This product has passed multiple waterproof tests before launch. Its internal parts, however, may experience wear and tear due to different using habits, affecting its sealing effectiveness. Please wear and use the smartwatch carefully during swimming, diving, etc. But avoid wearing it in a sauna or for a hot shower.
- 4) This product is not designed as a medical device. The heart rate, blood pressure and other health data collected by it are only for reference rather than clinical basis.

14. Disclaimer

This user manual is published by KOSPET that owns the right of final interpretation. We may make adjustments to this manual anytime if necessary. All pictures for describing functions are for reference only.

How to view E-label

Enter Settings——about ——label



15. FCC Warning

This device complies with part 15 of the FCC Rules. Operation is subject to the following two conditions: (1) This device may not cause harmful interference, and (2) this device must accept any interference received, including interference that may cause undesired operation.

Any changes or modifications not expressly approved by the party responsible for compliance could void the user's authority to operate the equipment.

This equipment has been tested and found to comply with the limits for a Class B digital device, pursuant to part 15 of the FCC Rules. These limits are designed to provide reasonable protection against harmful interference in a residential installation. This equipment generates, uses and can radiate radio frequency energy and, if not installed and used in accordance with the instructions, may cause harmful interference to radio communications. However, there is no guarantee that interference will not occur in a particular installation. If this equipment does cause harmful interference to radio or television reception, which can be determined by turning the equipment off and on, the user is encouraged to try to correct the interference by one or more of the following measures:

- Reorient or relocate the receiving antenna.
- Increase the separation between the equipment and receiver.
- Connect the equipment into an outlet on a circuit different from that to which the receiver is connected.
- Consult the dealer or an experienced radio/TV technician for help.

FCC Radiation Exposure Statement

This equipment complies with FCC radiation exposure limits set forth for an uncontrolled environment .

This transmitter must not be co - located or operating in conjunction with any other antenna or transmitter.