

380 mm

125 mm

2.1CH SOUNDBAR

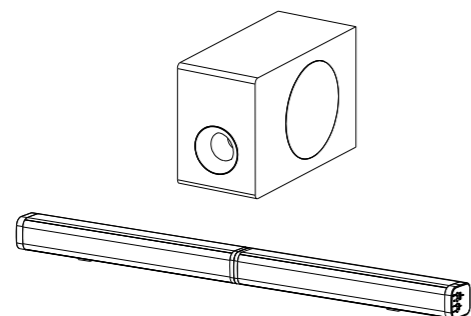

Family Audio
User Manual

TV Bottom

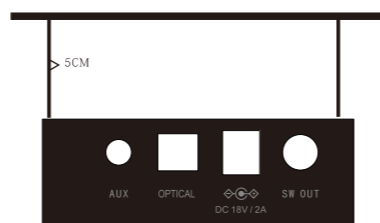

Button on Soundbar

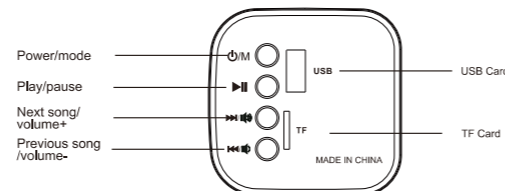

- ⏻: Long Press for power on and power off, short press for difference mode
- ⏸: Press for play of pause the music. at Bluetooth mode, long time to disconnect Bluetooth.
- ⏮: Long Press for volume+, short press for next song.
- ⏭: Long Press for volume-, short press for previous song.
- USB: USB slot, support up to 32GB, support MP3, WMA and WAV format music
- TF: TF card slot, up to 32GB, support MP3, WMA and WAV Format music.

1

Subwoofer Connect

Use the 3M Connect cable to connect the subwoofer first as bellows photo.

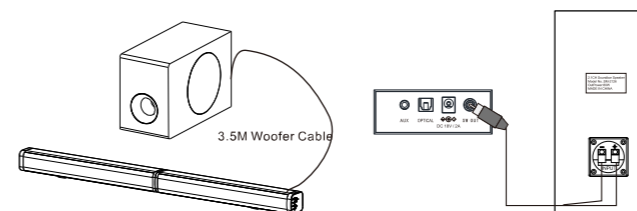

Installation

Connect the soundbar speaker to power as bellow:

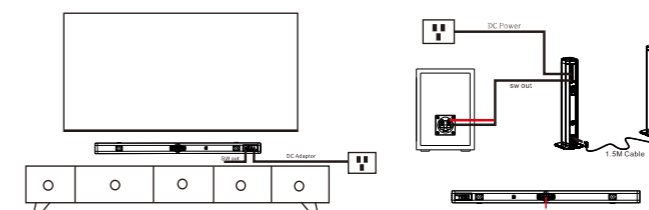

FLEXIBLE PLACEMENT WAY

This soundbar unit can be used either as a single soundbar or as 2-piece tube speakers.
Installation options include:

2

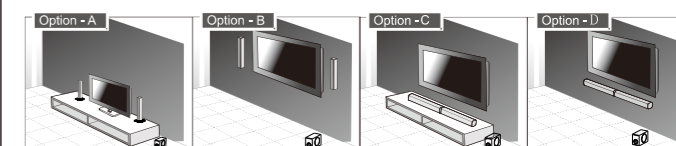

- Option A: Two tube speakers installed on stands
- Option B: Two Tubespeakers vertical wall-mounted
- Option C: Single soundbar mounted horizontally with rubber feet
- Option D: Single soundbar wall-mounted

Stand mounting (If using option A), Attach a stand each to the two separate pieces and twist so secure, as illustrated below, please noted use the long R&L Connect cable.

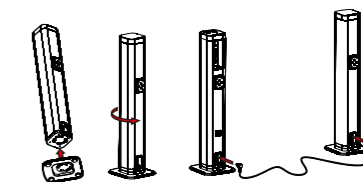

Vertical mounting (If using option B), use the long R&L Connect cable. And the wall mount screw wall-mounted

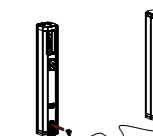

Installation (Cont.)

Horizontal mounting (If using option C and D) Align the two separate and twist to secure, as illustrated below please noted use the short R&L Connect cable

3

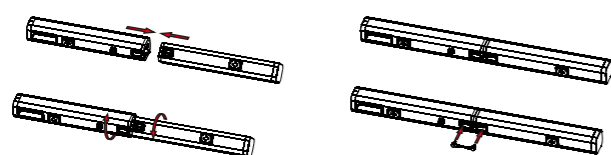

Rubber feet installation (if using option C)

You can extend the height of the unit, if required. To do so, attach the supplied rubber feet as follows.

- Ensure the surface of the soundbar is clean prior to attaching the rubber feet.
- Turn the unit upside down.
- Remove the backing paper from the rubber feet.
- Stick the rubber feet to the bottom of the unit, as illustrated below.

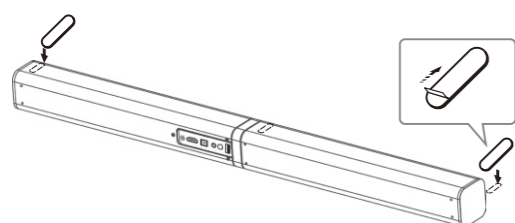

Installation(Cont.)

Wall mounting (f using option B And D)

if use option B, Mounting the bracket 5cm side of the TV as the illustration

if use option C, Mounting the bracket 5cm to the bottom of the TV.

4

Remote Control

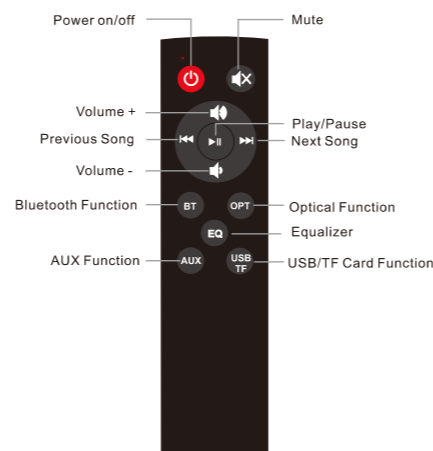

- ⏻: Press for power on/off.
- ⏸: Press for mute.
- ⏮: Press for play or pause music (at Bluetooth and USB/TF Mode).
- ⏭: Press for next song (at Bluetooth and USB/TF Mode).
- ⏮: Press for previous song (at Bluetooth and USB/TF Mode).
- EQ: Press for different EQ: FLAT, CLAS, ROC, POP, JAZZ and LIVE.
- BT: Press for Bluetooth Function.
- OPT: Press for Optical Input function.
- 3.5M: Press for 3.5mm Line in input function.
- USB/TF: Press for USB/TF Card Function. (support up 32GB, MP3, WMA, WAV Format music).

5

Instructions (Cont.)

AUX / Optical Operation

- Ensure that the unit is connected to a TV or audio device.
- While in ON mode, press the MODE button repeatedly on the unit or on the remote control to select AUX or Optical mode.
- Operate your audio device directly for playback features.
- Press the VOL +/- button to adjust the volume to your desired level.
- Tip: When in optical mode, if there is no sound is coming out of the unit, make sure the audio setting of your source player (e.g. DVD player, game player, TV) is set to PCM with optical output.

Playing Bluetooth * Enabled Devices

You can listen to tracks from a media device if connected to the unit via Bluetooth wireless technology.

Pairing Bluetooth * Enabled Devices

The first time you connect your Bluetooth device to this player, you need to pair your device to this player.

1. During ON mode, press the MODE button repeatedly on the unit or the remote control to select Bluetooth mode.
2. Activate your Bluetooth enabled device and select the search mode: "SAMTRONIC" will appear on your Bluetooth device list
3. Select "SAMTRONIC" from the pairing list and connect it. if need password, please enter "0000"

USB/TF Card

Insert your USB Disk or TF Card into the soundbar speaker, it will play the Mp3 Music automatically

6

Specification:

- Power :RMS80W=40W*40W
- SNR:>92dB
- Frequency response:100Hz-20kHz
- Voltage:100-240V-50/60Hz DC18V/2A
- Speaker Driver: 4pcs 50mm full frequency driver
- Input sensitivity:850mV
- Size: 946*60*60mm (Jointed together)
- 473*60*60mm (split to two parts)

Packing List

Soundbar speaker	1set
Adaptor	1pcs
Aux in cable	1pcs
Connect cable	2pcs
Remote control	1pcs
Manual	1pcs
Wall mount screw	2pcs
Foot pad:	2pcs
Subwoofer	1pcs
Subwoofer Cable	1pcs
Rubber feet:	2pcs

7

尺寸: 380x125mm

材质: 128g铜版纸, 单黑印刷, 风琴折

FCC Statement

This equipment has been tested and found to comply with the limits for a Class B digital device, pursuant to part 15 of the FCC Rules. These limits are designed to provide reasonable protection against harmful interference in a residential installation. This equipment generates, uses and can radiate radio frequency energy and, if not installed and used in accordance with the instructions, may cause harmful interference to radio communications. However, there is no guarantee that interference will not occur in a particular installation. If this equipment does cause harmful interference to radio or television reception, which can be determined by turning the equipment off and on, the user is encouraged to try to correct the interference by one or more of the following measures:

- Reorient or relocate the receiving antenna.
- Increase the separation between the equipment and receiver.
- Connect the equipment into an outlet on a circuit different from that to which the receiver is connected.
- Consult the dealer or an experienced radio/TV technician for help.

Caution: Any changes or modifications to this device not explicitly approved by manufacturer could void your authority to operate this equipment.

This device complies with part 15 of the FCC Rules. Operation is subject to the following two conditions: (1) This device may not cause harmful interference, and (2) this device must accept any interference received, including interference that may cause undesired operation.

RF Exposure Information

This equipment complies with FCC radiation exposure limits set forth for an uncontrolled environment. This equipment should be installed and operated with minimum distance 20cm between the radiator and your body.