

## Installation and operation manual of remote control anti-theft lock

### Operation Instruction



FCC ID: 2A4W3-HXQ908D

Our products have obtained many patents and application numbers

ZL201220521537.9	ZL201320195966.6
ZL201230097110.6	ZL201320647131.X
ZL201320243276.3	ZL201320815408.5
ZL201430156073.0	ZL201430156074.5
ZL201420194558.3	ZL201320306001.X

#### Version and statement

Description of the content of the final interpretation of the right to all the company,  
due to product upgrades may cause the contents of the manual deviation,  
please understand!



Thank you for choosing HuaXing Strong remote control lock. In order to ensure the safety of use, please read this instruction carefully before use and keep it for future reference. Type descriptors, such as HXQ908D, HXQ is the company abbreviation, 908 is the model number, and D is The version number.

### I. Product Standard Configuration

A lock body (excluding battery), lock body bottom buckle plate, Two remotes, instruction, latch holder (external door, internal door can be used), screw or rivet accessories.

#### Note:

1. In order to prevent damage to the receiving antenna during the transportation of the product, the antenna has been removed. Please install the antenna and the spare small battery (pay attention not to install the small battery reversely)
2. There is a mechanical emergency unlocking device on the back of the lock body. When installing, make a corresponding mark outside the door to prevent all remote controls from losing. You can open a 3-4mm hole outside the door for mechanical emergency unlocking.

### II. Product Function Features:

- Two systems, two ways, two methods of switch lock, a common circuit switch lock, a backup switch lock, a password switch lock, a password remote control unlock (optional), a mobile app unlock (optional).
- The unique design of external mounting base plate makes the installation easier and firmer;
- Good anti-theft performance, anti technology unlocking, anti violence unlocking;
- The remote controller is made of encrypted digital transformation, which can't be deciphered and copied, and the mutual opening rate is zero;
- Super power saving control mode, very low power consumption. Four No. 5 batteries can be normally standby for more than 16 months;
- The lock body has no power, and the lock can be opened and closed as normal when using the backup battery, so there is no need to worry about that the battery has no power and cannot be unlocked;
- The lock tongue and main parts are made of stainless steel;
- It can be equipped with a password keyboard remote control to unlock the lock with a password. The remote control can only be used when the password is known. It is safer and more secure as a backup;
- The system is paired with the remote control. Only the remote control with the correct code can be used. Each lock can be equipped with 16 additional remote controls (more can be customized)
- Low voltage alarm sound prompt function and undervoltage lock protection function: when the battery voltage is reduced and the battery power is almost used up, the remote control cannot lock the door (the remote control lock cannot be locked and alarm sounds for many times), but the remote control can still unlock normally, and the battery should be replaced; (when the battery power is too low, it will unlock automatically and will not lock people out)
- Automatic locking function (optional use of 909 / 910 Series)

### III. Technical Parameters:

- Remote control distance: 0-20 m (open space)
- Power supply mode: Four No.5 dry batteries for power supply
- Unlocking current: 120mA
- Operating environment: Temperature -10 ℃ ~ 60℃  
Humidity: 20% ~ 80%
- Movement stroke of locking tongue: 22mm
- Overall dimension: 130mm \* 75mm \* 33mm



#### IV. introduction to product pictures and parts names



- |                               |  |
|-------------------------------|--|
| 1. Manual knob                | 2. Battery box cover                   |
| 3. Cover screw of battery box | 4. Locking ear                         |
| 5. Receiving antenna          | 6. Lock body fixed base plate          |
| 7. Common switch lock button  | 8. Spare one set of switch lock button |

#### V. Instructions

**1. Scope of application: Office, home, hotel, security door, room door, corridor door, wooden door, garage door, etc.**

**2. Installation steps:**

① When the door is closed, attach the mounting plate and the locking tongue seat to the door frame, draw several positioning points with a pen, and then directly use the electric hand drill to screw and fix them. You can use the iron nail to punch a point first and then screw. (as shown in the reference Figure)

② After fixing the bottom plate of the lock body, screw 4 screws to fix the lock body. The corresponding lock tongue seat should not be too close. It is better to keep the door open and close without interference;

③ After the lock is installed, people shall use the remote control to control the lock in the door to see if the control is flexible and normal, and the lock tongue shall not be stuck.



The following are installation reference pictures:



1. Double sided tape is used to stick the lock base plate on the door
2. After the lock base plate is glued to the door, use the electric hand drill to directly screw
3. After installing the lock body, install latch base.
4. Reference for installation of latch base of external door
5. Reference for installation of latch base of inner door
6. Reference for direct drilling of external door opening frame

### 3. Battery replacement method:

Open the battery box board by unscrewing the battery cover screw, take out the battery, and then install the new four No. 5 batteries correctly  
(Aa, R 6 battery ), (reference figure on the right)

4. Use method of automatic locking function: turn the switch to the other side to start automatic locking, and then lock automatically after 20 seconds (subject to the actual purchase)

### 5. How to use the remote control:

#### 1) Common circuit switch lock:

Lock the door: press the  key of the remote control (0.5 seconds), hear the lock body ring once, and the lock is locked.

Open the door: press the  key of the remote control (0.5 seconds), hear the unlocking prompt tone, and the lock is unlocked

#### 2) Standby circuit switch lock:

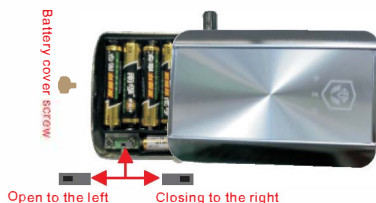



The standby circuit is usually disconnected and not working. When the standby circuit is used to unlock the lock, first tap and install the door lock (with a little more force), with a frequency of about 0.5 seconds, and then tap 3 to 5 times (if the door is very thick, you can knock and tap several times appropriately). When you hear the horn of the lock body, you can use it. At this time, the standby circuit is enabled, and you can control the switch lock by pressing a group of keys under the remote control immediately. If you listen the horn rings, if the following keys are not pressed in time, the door lock standby system will automatically close. If you want to use the standby circuit switch lock again, you must repeat the above steps

**During use, if you hear the horn multi alarm tone or you can unlock the lock but not close the lock remotely, it means that the battery voltage is low, and you need to replace the battery (spare 12V small battery is replaced together)**

#### 6. Remote control code matching (factory calibrated)

1) the lock adopts single-chip microcomputer intelligent code matching. After the battery in the lock is installed, press and hold the S2 code matching key of the lock body to hear the sound of the horn, then release the key. Immediately press and hold S2 again, the horn will ring again (keep pressing). At this moment, press any key on the remote control (about one second) to hear the horn ring three times in succession. At this time, the code matching is successful (release the code matching key). Test whether the lock can be opened and closed normally after the code is checked. If the lock cannot be opened and closed normally, please repeat the operation once.

2) other remote controls need to be set, please repeat the above steps

3) configuration method of standby system: press and hold the standby system code matching key S1, and then the configuration method is the same as above. The standby circuit can press any key of a group of keys under the remote control

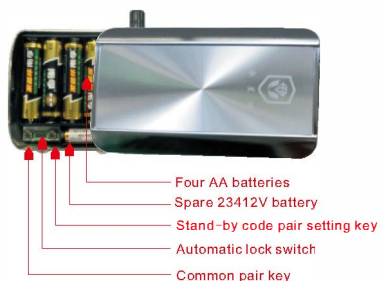





There cannot be 0 in the middle when setting the password, because 0 is to start input and finish input.

How to use the password remote control:

Press key 0 of password remote control - 1-2-3-4-5-6-0 (the key speed should not be too fast), and then press the switch lock key, the operation is as follows:

Press the 0 key (ring once), press the 1-2-3-4-5-6-0 key (4 beeps)  key to unlock and execute

Press the 0 key (ring once), press the 1-2-3-4-5-6-0 key (4 beeps)  key to lock and execute

Note: After setting the password remote control, the remote control all need to re-set the code.

7. To delete the remote control:

Delete the common circuit, press and hold the S2 key in the lock body for a long time, and the buzzer will ring once on time. After about 8 seconds, the buzzer will ring 1-2 times. All remote control passwords will be deleted. Delete the remote control password of the standby circuit: the method is the same as that of the common circuit, just press and hold the standby S1 key for a long time.

**Delete all is the remote control is all out of order, need to reset the code.**

## (V) Software installation

TT lock function



Scan to download TT lock

### (1) Software installation

The software (iOS version) can be downloaded from the app store, and the Android version can be downloaded from the application store of Google play, Yingyongbao, Baidu, Ali, 360, Huawei, and Xiaomi.

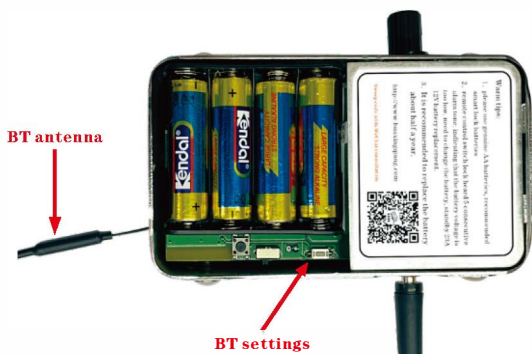

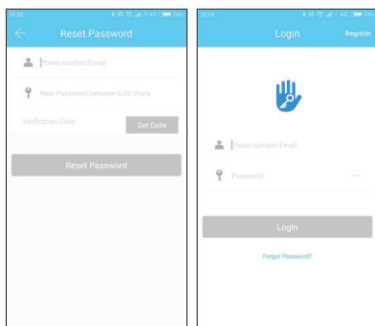

## (2) Registration and login

TT lock users can register the account by mobile phone and Email which currently support 200 countries and regions on the world. The verification code will be sent to user 's mobile phone or email, and the registration will be successful after the verification.

## Main functions-registration and login

TT lock function

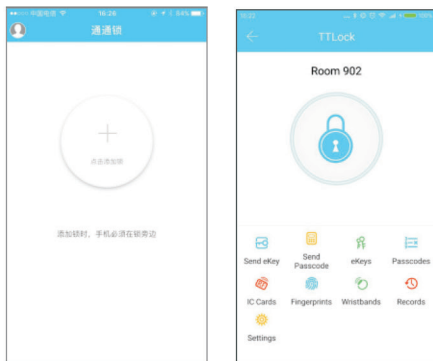

no lock adding

the account with lock

## (3) Login successful

The first time you use the lock app, if there is no lock or key data in the account, the home page will display the button to add the lock. If there is already a lock or key in the account, the lock information will be displayed.



## (4) Operation

Function	Operation
1.Return to factory settings	Long Press the BT reset button on the lock, the indicator light is always on, the lock resume factory settings, empty the administrator.
2.Add A cell phone administrator	Long Press the BT reset button on the lock, the light is always on, and then add a bluetooth administrator to the APP.
3. Delete the phone manager	In the APP selection you need to delete the phone administrator's lock, click settings, click delete.
4.Pick the lock	APP UNLOCK: Click the lock icon on the APP to unlock (operate next to the lock) .
5.Latching	App Lock: Long Press the lock icon on the APP to lock the APP (operate next to the lock) .
6.APP Key	Click "Send key"on the APP to send the electronic key to other users, you can authorize the electronic key, make it a secondary administrator.
7.Check the lock-picking records	Open the APP and Click on the operating record to view it
8.Low-voltage indication	APP can check the remaining power of the door lock.

## VII. Handling of common problems

No.	Problem phenomenon	Problem reason	Methods of resolution
1	Press the remote control. Lock has no response	1) remote control battery is dead 2) the lock battery is not powered 3) remote control distance is too far 4) the remote control is wrong 5) press the remote control for too short time	1) replace the remote control battery 2) replace the battery in the lock 3) close to lock body or orientation 4) re code 5) press the remote control longer
2	Remote control distance is close, no response	1) low battery voltage in lock body 2) low battery voltage of remote control	1) replace the battery in the lock 2) replace the remote control battery
3	Remote control lock cannot be controlled after the battery is installed	1) incorrect installation of battery polarity 2) battery stuck by battery box	1) install the battery according to the positive and negative signs of the battery box 2) push the battery from the negative to the positive by hand
4	The remote control doesn't match the code	Short time for remote control during preparation	Press the key of the remote control for longer time when preparing
5	Standby circuit has no response	Standby one is disconnected at normal time	After knocking the vibrating door, unlock it by remote control when hearing the lock ring
6	Can not lock automatically	Auto lock switch not on	Turn the auto lock switch on





### VIII. Maintenance

1. It is recommended to replace the battery regularly (normally about one year, and it can be replaced half a year in advance)
2. It is recommended to use genuine No. 5 alkaline batteries such as Nanfu or Chaoba
3. It is recommended to test the switch lock of the backup system once a month, (clap the door for 3 to 5 times, lock automatically enables the backup power supply and uses the backup system to unlock)
4. It is recommended to store the remote control or password remote control in a safe place (unit or relative's home) for standby.
5. It is recommended not to screw out the locking tongue in the unlocking state, so as to avoid damaging the lock body due to the impact of door closing.

### IX. After Sales Service

#### After sales Three Guarantees service card

This card is the basic certificate of after-sales Three Guarantees service. Please fill in it carefully and keep it properly.

Serial number: \_\_\_\_\_

User name		Contact number	
Product model		Date of purchase	
Bill number		Management Department	
User (signature)		Person in charge	

Handling date: Year Month Day

#### Note:

1. This card is only for the three guarantee service of the lock with the above model;
2. Please show this card when enjoying three guarantees service;
3. This card shall come into effect with the seal of the lock selling unit and the signature of the handler;
4. Huaxing Strong remote control lock body is guaranteed free of charge for one year, and the remote control is guaranteed for three months;
5. The starting date of warranty period shall be subject to the date of invoice;
6. Any of the following circumstances shall not be covered by the warranty:
  - A. damage caused by improper use, storage and maintenance of consumers;
  - B. artificial damage or unauthorized disassembly is not covered by the warranty;
  - C. damage caused by disassembly and repair by the maintenance department not designated by the company;
  - D. there is no valid bill;
  - E. damage due to force majeure
7. For products not covered by the warranty, the customer service center of our company is still enthusiastic to serve you.

**If you have any questions, you can contact your local dealer or our company.**

**This product has obtained many patents, and the counterfeiting must be investigated.**

**Website: <http://www.huaxingqiang.com>**

## Product presentation

---

**EN** The GUARDIAN high-security invisible lock has a main body (batteries not included), a base plate for its anchorage, four remote controls, base to accommodate bolts, anchor bolts and instruction manual.

**In order to prevent the receiving antenna from being damaged during transportation, it is removed. Please install the antenna before using the product.**

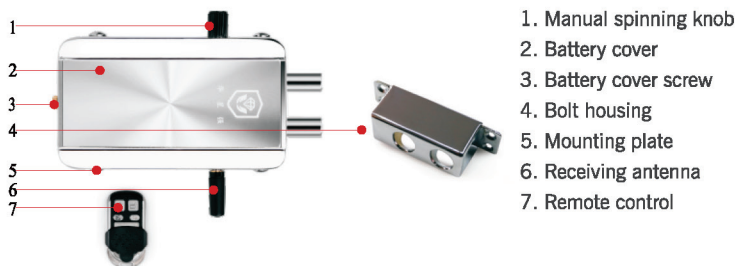

## Installation

---

1. Close the door, place the mounting plate (5) and the bolt housing (4) between the door frame and the door. Paint the holes to drill and fix the base with the screws provided.

2. Fix the bolt body to the anchor base and tighten the 4 screws firmly so that it is securely fastened.

Make sure that the bolts of the lock match correctly in the bolt housing part.

3. After installation, check with the remote control that it works properly.

## Operating instructions



---

### MAIN DRIVE BUTTONS:

Close the door: Press  on the remote control. A beep will sound.

Open the door: Press  on the remote control. Three beeps will sound.

### REINFORCEMENT DRIVE BUTTONS:

The reinforcement circuit is normally in the off position. It can be activated in the event of the main batteries being depleted. To activate it you will need to tap the door several times in the place where the lock is installed. A beep will sound, then tighten the reinforcement drive buttons ( & ); If you do not press them after a few seconds, you will return to the main drive.

## Pairing remote controls

All remote controls are factory paired.

### CANCEL ALL THE REMOTE CONTROLS:

This option will make all remote controls unusable.

**Main buttons:** Press and hold the ST-2 button. You will hear a beep. Keep pressing for about 8 seconds, until two more beeps sound. All the main buttons on the controls will be canceled.

**Reinforcement buttons:** Press and hold the ST-1 button. You will hear a beep. Continue to hold for about 15 seconds until two more beeps sound. All the reinforcement drive buttons of the controls will be canceled.

### ADD A REMOTE CONTROL:

**Main buttons:** Press the ST-2 button and release. You will hear a beep. Then press the ST-2 buttons and the button  together. You will then hear three beeps. The main buttons on the remote will be added.

**Reinforcement buttons:** Press the ST-1 button and release. You will hear a beep. Then press the ST-1 buttons and the reinforcement button together. You will then hear three beeps. Reinforcement buttons will be added.



## Emergency opening

If all the controls are lost or the lock can not be opened with the controls, there is an emergency opening mode.

When installing the lock, note the place where the emergency opening point is located.

In case of needing to use the emergency opening, a hole of 3 to 4 mm must be drilled in the door where the emergency opening is located. Once the drill is done, use a screwdriver to turn the screw and open the lock.

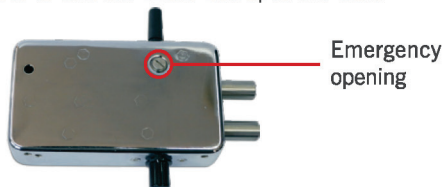

## FCC Statement

This device complies with part 15 of the FCC Rules. Operation is subject to the following two conditions: (1) This device may not cause harmful interference, and (2) this device must accept any interference received, including interference that may cause undesired operation.

Note: This equipment has been tested and found to comply with the limits for a Class B digital device, pursuant to part 15 of the FCC Rules. These limits are designed to provide reasonable protection against harmful interference in a residential installation. This equipment generates, uses and can radiate radio frequency energy and, if not installed and used in accordance with the instructions, may cause harmful interference to radio communications. However, there is no guarantee that interference will not occur in a particular installation. If this equipment does cause harmful interference to radio or television reception, which can be determined by turning the equipment off and on, the user is encouraged to try to correct the interference by one or more of the following measures:

- Reorient or relocate the receiving antenna.
- Increase the separation between the equipment and receiver.
- Connect the equipment into an outlet on a circuit different from that to which the receiver is connected.
- Consult the dealer or an experienced radio/TV technician for help.

Note: The Grantee is not responsible for any changes or modifications not expressly approved by the party responsible for compliance. such modifications could void the user's authority to operate the equipment.

The device shall be used with a minimum distance of 20cm from users.

Please Reserve 1-2 remote controls in a safe position in case the lock can not be unlocked without the remote control.