

## Portable Wireless Charger For apple Watch

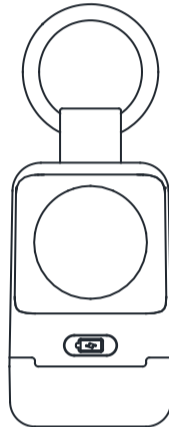

### Product Diagram

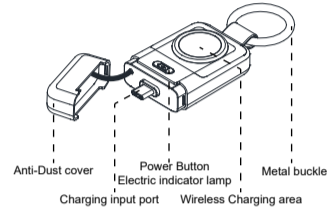

### Product Charging Instruction

Insert the charger into the computer or USB Devices, then it will start Charging.

Charging the case:  
Green light on: fully charged;  
Green light flashes: battery level 66%-99%;  
Blue light flashes: battery level 33%-65%;  
Red light flashes: battery level 0%-32%.

### Instruction for charging watch

Put the watch upon wireless charging area and press the power button to active charging apple watch,press the power button Twice to stop charging.While charging, the green indicator light always on.Green light on: battery level 66%-100%;  
Blue light on: battery level 33%-65%;  
Red light on: battery level 10%-32%;  
Red light flashes: battery level 0%-9%.When the battery power is 0%, the red light flash and stop charging.  
(The product built-in auto detect and recognize function) When press the power button to start charging, it will auto stop charging after 30 seconds if undetecting the watch,when the watch is full charged or take away without full charged,it will auto stop charging after 40 seconds.

### Charging Drawing

Place the apple watch above the wireless area of the Wireless Watch charger and press the power button to start charging.

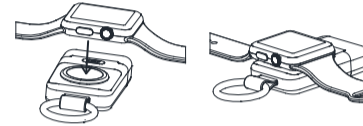

### Product specifications

Suitable: Apple Watch	Input: DC 5V/1A
Capacity: 1400mAh	Output: 2.5W

### Package Contents

Portable Wireless Charger For Apple Watch X1 Use Manual X1

### Warnings

- 1.Do not put metal foreign matters around the wireless charging area;
- 2.Please do not disassemble the battery;
- 3.Do not put the product in a moisture or water environment, and avoid severe fall;
- 4.Please do not recharge in a high temperature;
- 5.Do not put the product into fire or water;
- 6.If it is found that the battery is bulging, leaking of odour, please stop using it immediately;
- 7.If you do not use the product for a long time, charge the product at least once every five months.

**FCC Warning Statement:** Changes or modifications not expressly approved by the party responsible for compliance could void the user's authority to operate the equipment. This equipment has been tested and found to comply with the limits for a Class B digital device, pursuant to Part 15 of the FCC Rules. These limits are designed to provide reasonable protection against harmful interference in a residential installation. This equipment generates uses and can radiate radio frequency energy and, if not installed and used in accordance with the instructions, may cause harmful interference to radio communications. However, there is no guarantee that interference will not occur in a particular installation. If this equipment does cause harmful interference to radio or television reception, which can be determined by turning the equipment off and on, the user is encouraged to try to correct the interference by one or more of the following measures:  
Reorient or relocate the receiving antenna.  
Increase the separation between the equipment and receiver.  
Connect the equipment into an outlet on a circuit different from that to which the receiver is connected. Consult the dealer or an experienced radio/TV technician for help.  
Warning:In order to ensure the normal charging of the product, please place the watch directly above the wireless charger. During normal charging, please keep at least 20cm away from the human body.

Warning:Changes or modifications to this unit not expressly approved by the party responsible for compliance could void the user's authority to operate the equipment.

NOTE:This device complies with part 15 of the FCC Rules. Operation is subject to the following two conditions: (1) This device may not cause harmful interference, and (2) this device must accept any interference received, including interference that may cause undesired operation.

NOTE: This device complies with part 18 of the FCC Rules.

Information to the user.  
1.the device has potential interference,but the interference is very small and meets the requirements of the FCC rule  
2.Equipment system maintenance is simple, please refer to the manual  
3.The user can take simple measures to correct the interference. Such as staying away from interference sources, turning off interference sources, etc.