

1	Main interface operation
2	Game Buttons and Ports
3	Game Import
4	Common Settings
5	Game Settings
6	Indicator light and charging function
7	RA Emulator Shortcuts
8	Online Play

### 1.Main interface operation

#### ■ Main Interface Menu:



1	game rooms	After entering, you can choose "Internal Card" or "External Card". And select the game platform to play the game.
1	RA Emulator	After entering, you can choose "Internal Card" or "External Card". And select the game platform to play the game.
2	Favorites	Press the START button in the game center to collect the game, and the game will appear in this section.
3	history	The run game will appear in this section. History can be cleared in settings.
4	search	Quickly search games from memory cards. The X key deletes the keyword and the Y key confirms the search result.
5	settings	Contains all settings for theRG35XX Plus. Including language settings, backlight settings, background settings, etc.

### 2.Game Buttons and Ports

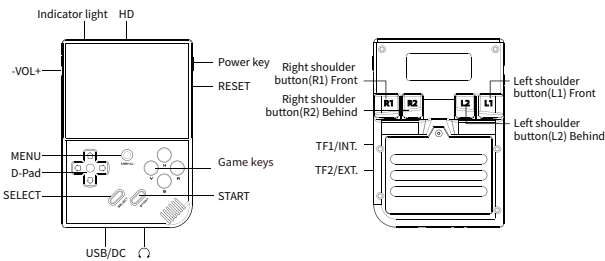

### 3.Game Import

- Insert a FAT32 formatted memory card into the external card slot of the game console, and a new folder for each platform will be created. Just put the game in the folder and select the game in the game rooms.
- Supported platform are: :PSP,N64,DC,PS1,ARCADE,FBA, NEOGEO,GBA,GBC,GB,SFC,FC,MAME,MD,GG,PCE, NGPC,SMS,WSC

### 4.Common Settings

- **Language Settings**  
Select Settings -> Language Settings in the main interface. Available languages are: Simplified Chinese, Traditional Chinese, English, Japanese, Korean, Spanish.
- **Backlight Brightness**  
Select Settings -> Backlight Brightness in the main interface. There are 5 levels of backlight brightness.
- **Backlight Time**  
Select Settings -> Backlight Time in the main interface. There are 1 minutes, 2 minutes, 5 minutes, 10 minutes, and always on. The screen backlight will be turned off after the set time has elapsed.
- **Key Customization**  
Button Custom: Select Settings -> Button Custom in the main interface. You can customize the button mapping of the body buttons or the gamepad.

### 5.Game Settings

- **Game quality**  
divided into high-definition, scan line, fast, dot matrix. Different options will present different screen filter display effects.
- **Game streaming**  
First, make sure that the game console and the computer are under the same WIFI. Select Settings -> moonlight in the main interface. Enter the IP address of the computer to start pairing. Enter the PIN code to pair successfully and select Connect. During streaming, press menu+START to exit streaming.
- **Bluetooth Settings**  
First, select Settings->Bluetooth Settings in the main interface, select Enable Bluetooth, and press the X key to scan for devices in the Search device. Finally, select the controller you want to connect according to the device name.

### 6.Indicator light and charging function

The packaging of the machine is matched with a 5V/2A four-lines charging data cable. Plug in the charging cable and the machine will start charging.

RG35XX Plus has two indicators, the left is the charging indicator, and the right is the working indicator.

The following light color and status table:

●Green light	Working
●Red light	Low power
●Yellow light	Charging

### 7.RA Emulator Shortcuts

Menu	Menu
Menu+R2	Fast Forward
Menu+L2	Slow Motion
Menu+R1	Save State
Menu+L1	Load State
Menu+Y	Display Frame Rate
Menu+B	Screenshot
Menu+X	Pause
Menu+START	Quit
Menu+ -VOL+	Adjust Brightness
Menu+Left/Right Direction	Select Save State Slot

### 8.Online Play



- First make sure the two consoles are on the same WIFI
- Note down the IP addresses of the two consoles by going to NETWORK SETTINGS ->IP ADDRESS
- In the RetroArch, enter the same game and call out the menu through the menu
- Set it up with the following steps:
  - Game console A (host)
  - Select Netplay->Host->Start Netplay Host
  - Game console B (slave)
  - Select Netplay->Connect to Netplay Host, enter the IP address and press the START button to connect successfully

FCC Warning:

This equipment has been tested and found to comply with the limits for a Class B digital device, pursuant to part 15 of the FCC Rules. These limits are designed to provide reasonable protection against harmful interference in a residential installation. This equipment generates, uses and can radiate radio frequency energy and, if not installed and used in accordance with the instructions, may cause harmful interference to radio communications. However, there is no guarantee that interference will not occur in a particular installation. If this equipment does cause harmful interference to radio or television reception, which can be determined by turning the equipment off and on, the user is encouraged to try to correct the interference by one or more of the following measures:

- Reorient or relocate the receiving antenna.
- Increase the separation between the equipment and receiver.
- Connect the equipment into an outlet on a circuit different from that to which the receiver is connected.
- Consult the dealer or an experienced radio/TV technician for help.

Caution: Any changes or modifications to this device not explicitly approved by manufacturer could void your authority to operate this equipment.

This device complies with part 15 of the FCC Rules. Operation is subject to the following two conditions:

(1) This device may not cause harmful interference, and (2) this device must accept any interference received, including interference that may cause undesired operation.

This equipment complies with FCC radiation exposure limits set forth for an uncontrolled environment. This equipment should be installed and operated with minimum distance 0cm between the radiator and your body.