

Upgraded W-series Small Wifi Camera User Manual



Please charge the camera for 2 hours before use



W8

W9



W10

Thank you for purchasing our 2021 upgraded small wireless camera W-series. Please carefully read and follow the manual to set up the camera.

You are welcomed to contact us on Amazon or via email if there are any issues and suggestion.

I. Product Description



ON/OFF: Press once to turn on the camera; press for another 3 seconds to turn it off;

Reset: Press for 6 seconds to reset the camera; Blue and Red indicator lights will be off and then on, which means the reset process has been done;

Card Port: Insert Micro SD card to save recording videos(Max 32G, FAT32, NOT included);

II. Warm Tips

1. Fully charge the camera for 2 hours before use; once connected with USB charging cable, it will be auto turned on with Blue and Red indicator lights by default. Please do not turn off the camera while charging. After fully charged, Orange indicator light will be off.
2. After fully charging the camera, please press Reset button for 6 seconds to reset it;
3. Must set **WIFI CONFIG** in the APP Decive Settings for remote viewing, or the camera will be offline and disconnect while you are away from because of distance limitation.
4. With Micro SD card in, it will automatically save videos; without card in, you should manually start recording in the APP live feed video page to save recordings. Support MAX 32G, FAT32 format. Before you remove and insert one card, please turn off the camera first or the recording videos would be damaged.
5. Low power will influence the signal of the camera. Recommend charging the camera while it is recording for 7/24 continuous recording. Li-battery with MSDS and UN38.3 certified, please purchase with confidence.

III. Before Setting up WIFI Network, what should you do?

1. Fully charge the camera when receiving the item;
>>>When it is charging, all indicator lights Blue, Red, Orange will all be on; and when it is fully charged, Orange will be off.

2. After fully charged, please reset the camera by press Reset button for about 6 seconds;
>>>Indicator lights Blue and Red are off and on again, which means the reset process has been done successfully.

3. After reset, please turn off the camera and turn it on again for stable signal.

4. Begin to start setting up connection for your phone, your camera and the router(Refer to [IV. Start Setting Up WIFI Network?](#)).
>>>Please follow the steps in part [IV](#). Without setting WIFI and connection, you won't be able to view the camera.

IV. Start Setting Up WIFI Network

1. Download the app “iWFCam”:

Scan the QR code below to download the APP compatible with your phone system.

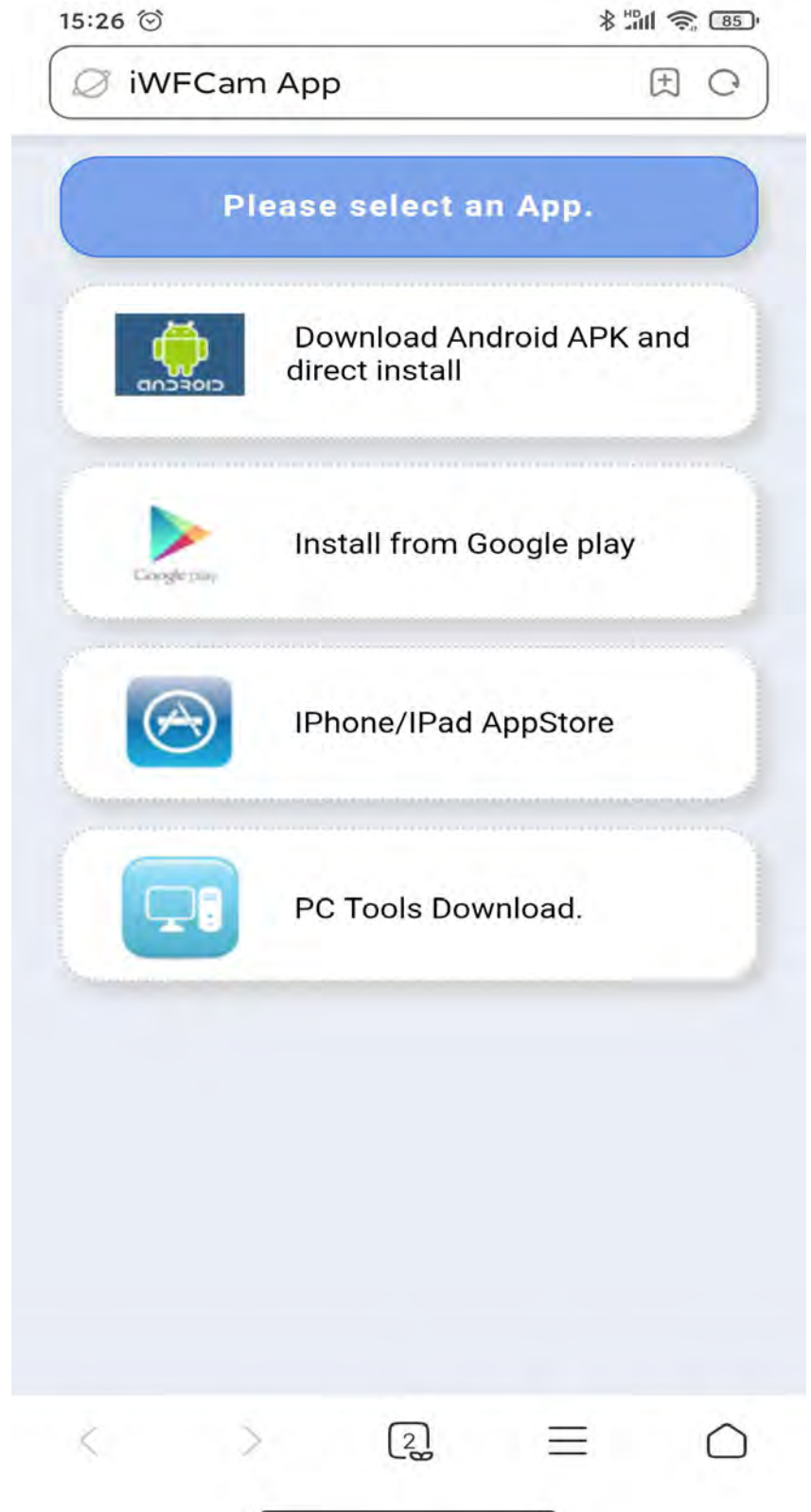

2. Connect Camera with Phone(AP Mode):

2.1 Turn on your phone Settings WLAN, refresh the list to find the camera hotspot signal BK*** and connect it;

Note: Android phones will receive one notification asking whether to change to another available network, please ignore and keep connecting with the camera signal; Your camera should be close to your phone within 3 meters for strong signal.

Please refer to the below pics.

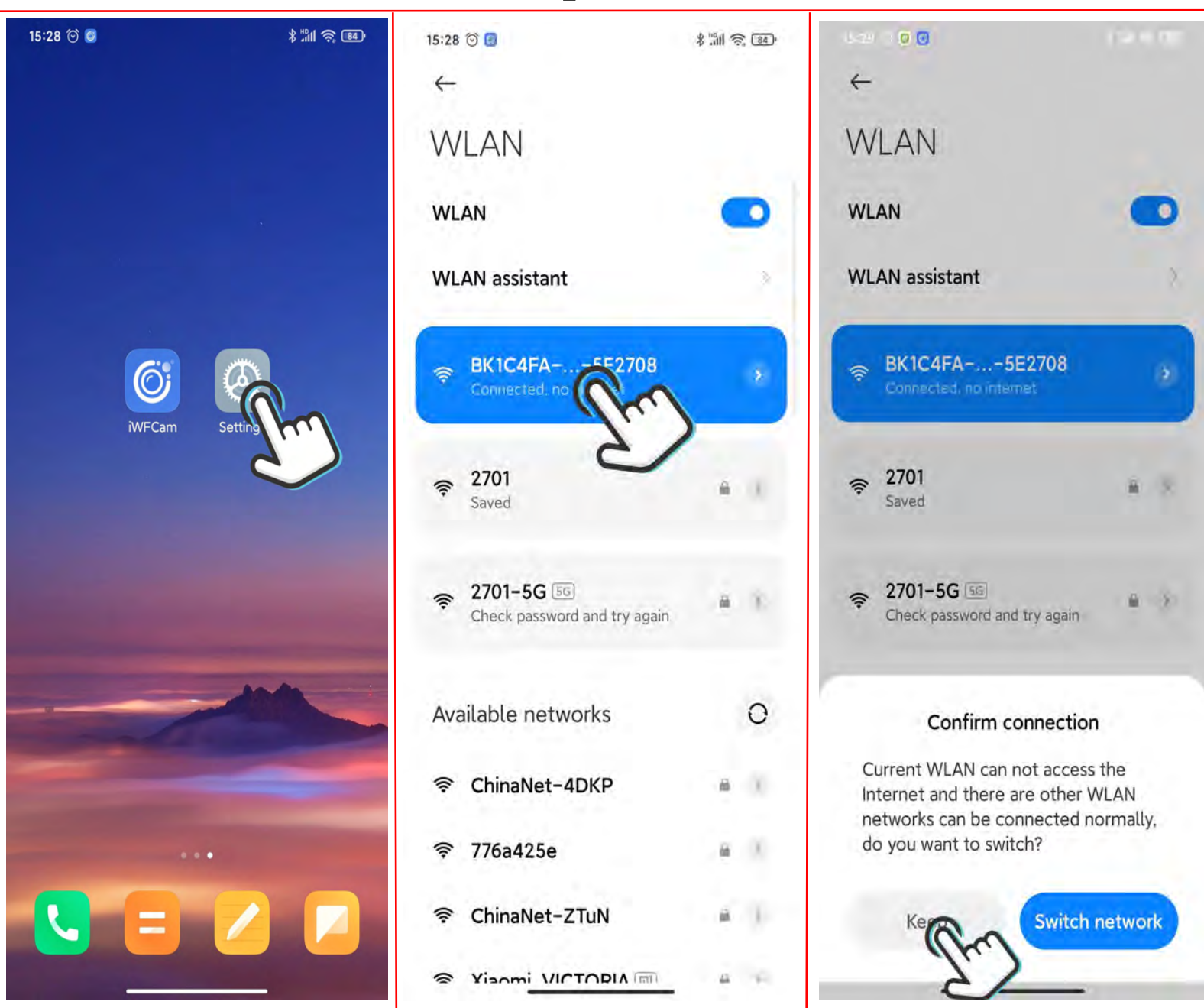

3.Set WiFi Config for Remote Viewing(IP Mode):

3.1 Start APP iWFCam, the camera will be auto added Online;

3.2 Click Setting---Device Settings---WiFi Config, set Wifi Config by choosing the router and enter router password;

Note: Your camera should be close to the router within 3 meters for strong signal.

3.3 Wait for update process for remote viewing till the camera shows Online;

Please refer to the below pics.

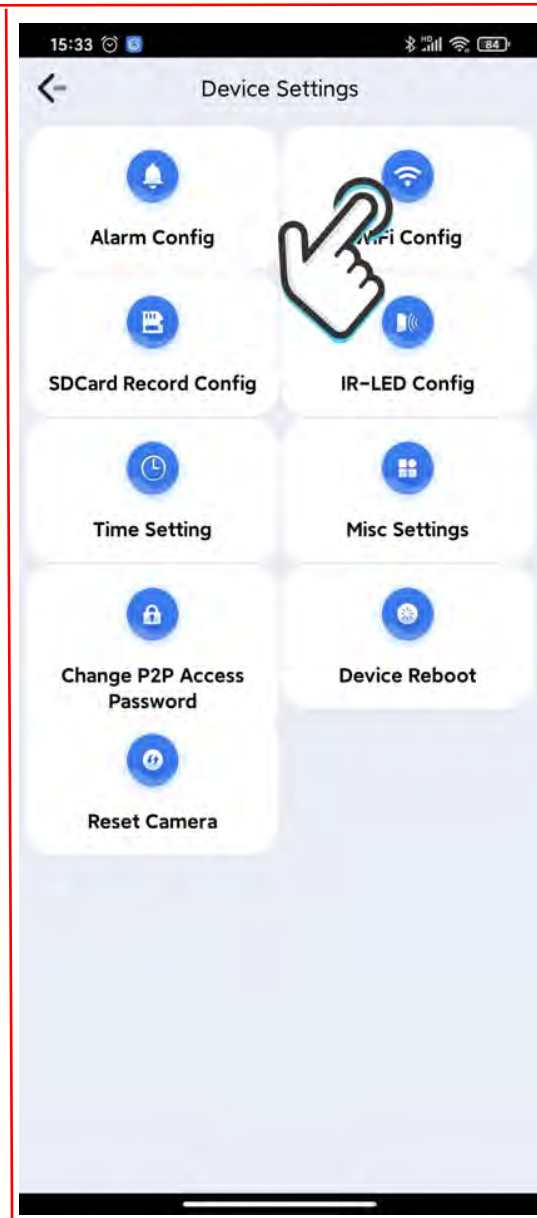
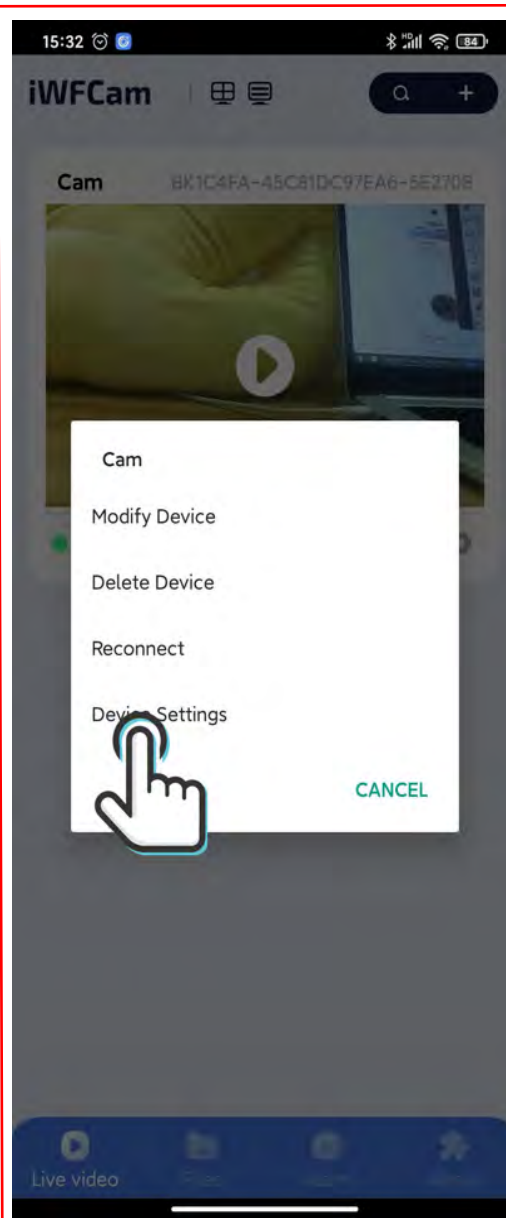
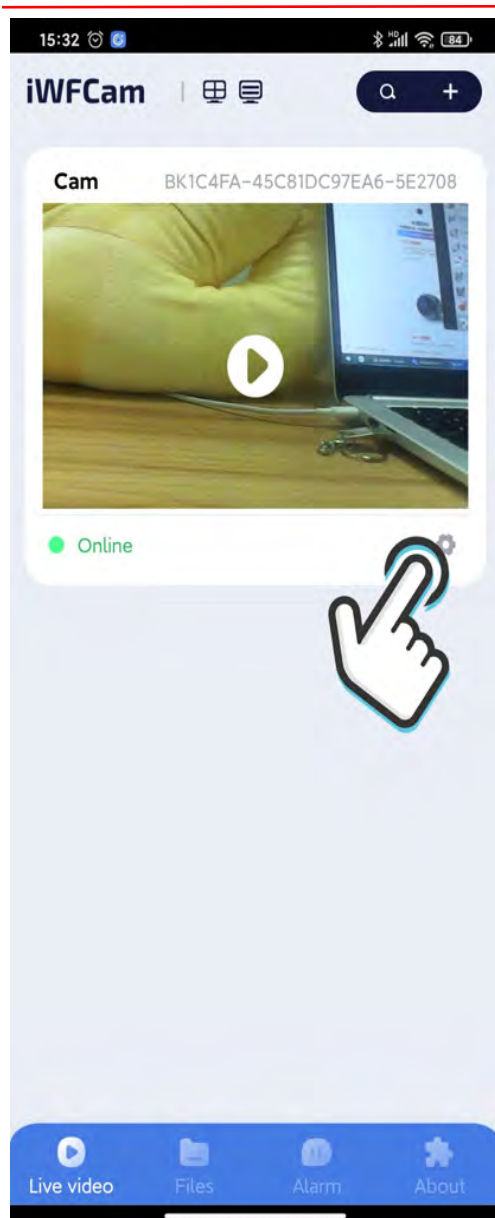

V. Enjoy Your APP Journey

1. Check Live Feed Video:

1.1 Click the camera in the APP, it will pop-up message to change the password; skip or change it ;

1.2 Enter into Live Feed Page; you can adjust Brightness, Night Vision, Video Resolution, Audio, Video, Photo, etc.

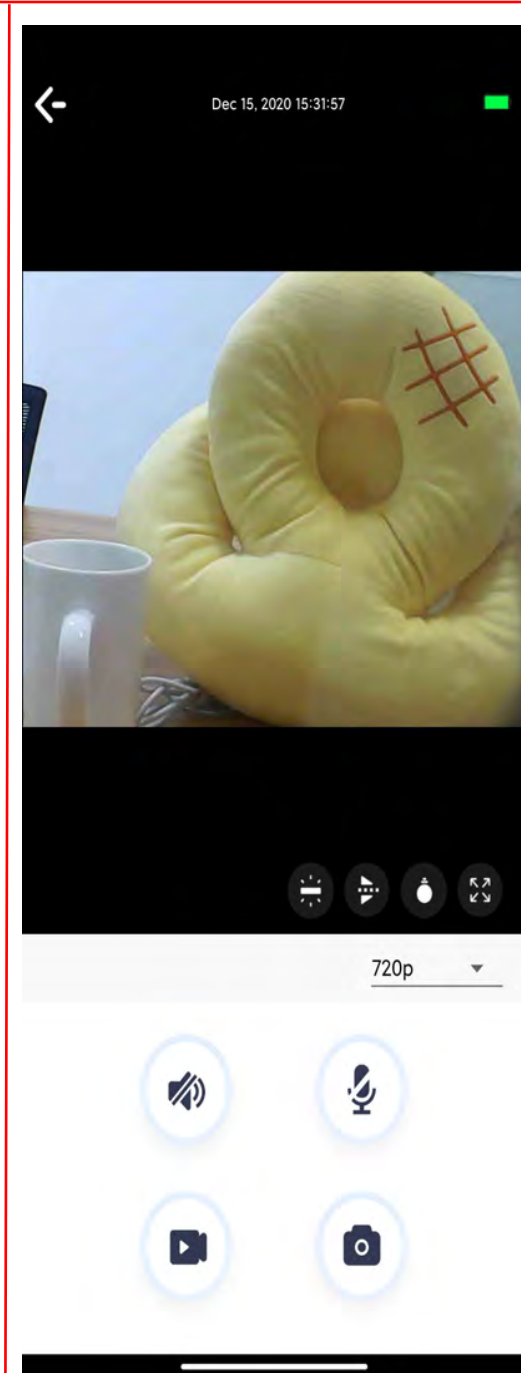
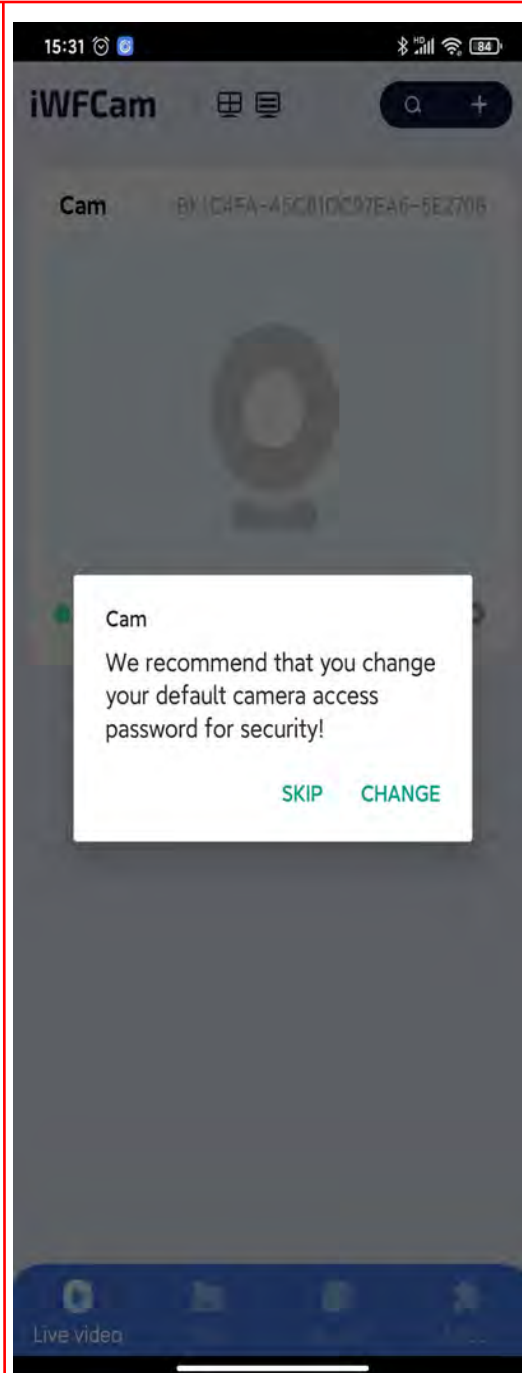
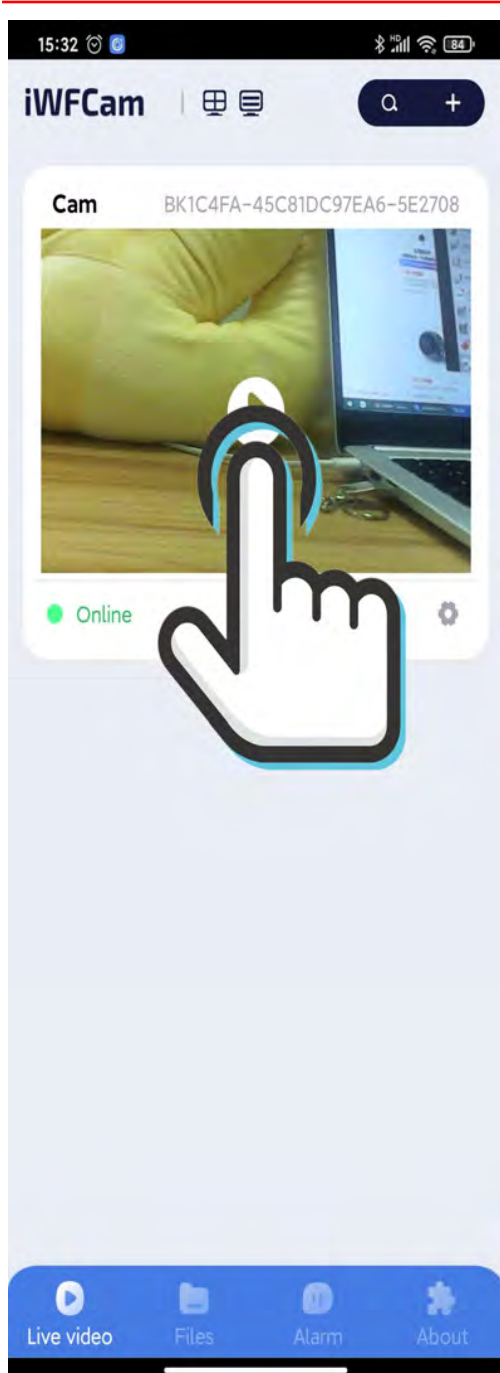

2. Config Your Camera:

You can Modify Camera Name, Delete Device, Reconnect, Share or set more functions in the APP settings.

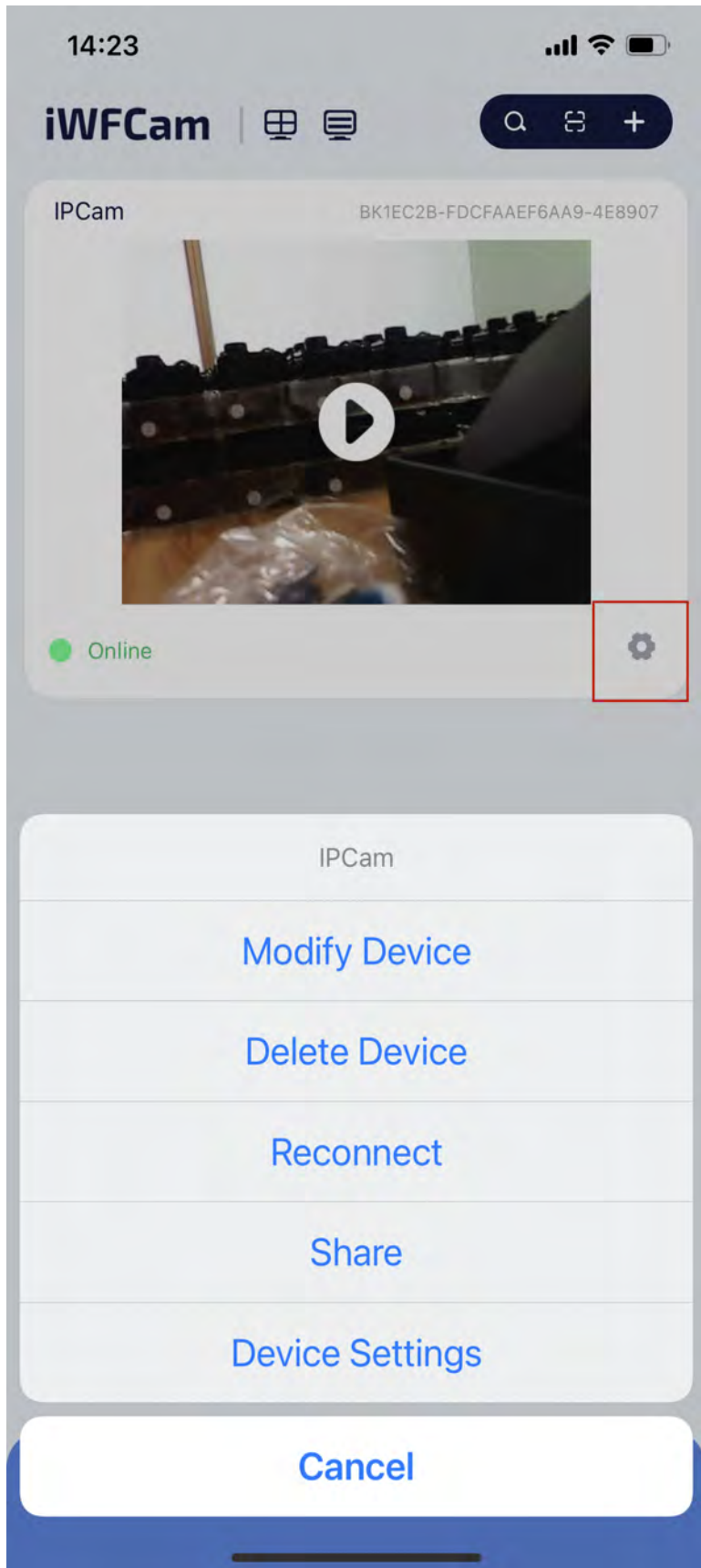

2.1 Modify Device and Share

You can modify the name and share the camera with your family or friends. The first phone to set WIFI CONFIG for the camera will be recognized as the main device. Others who want to access the camera should be approved and authorized by the main device Share QR code.

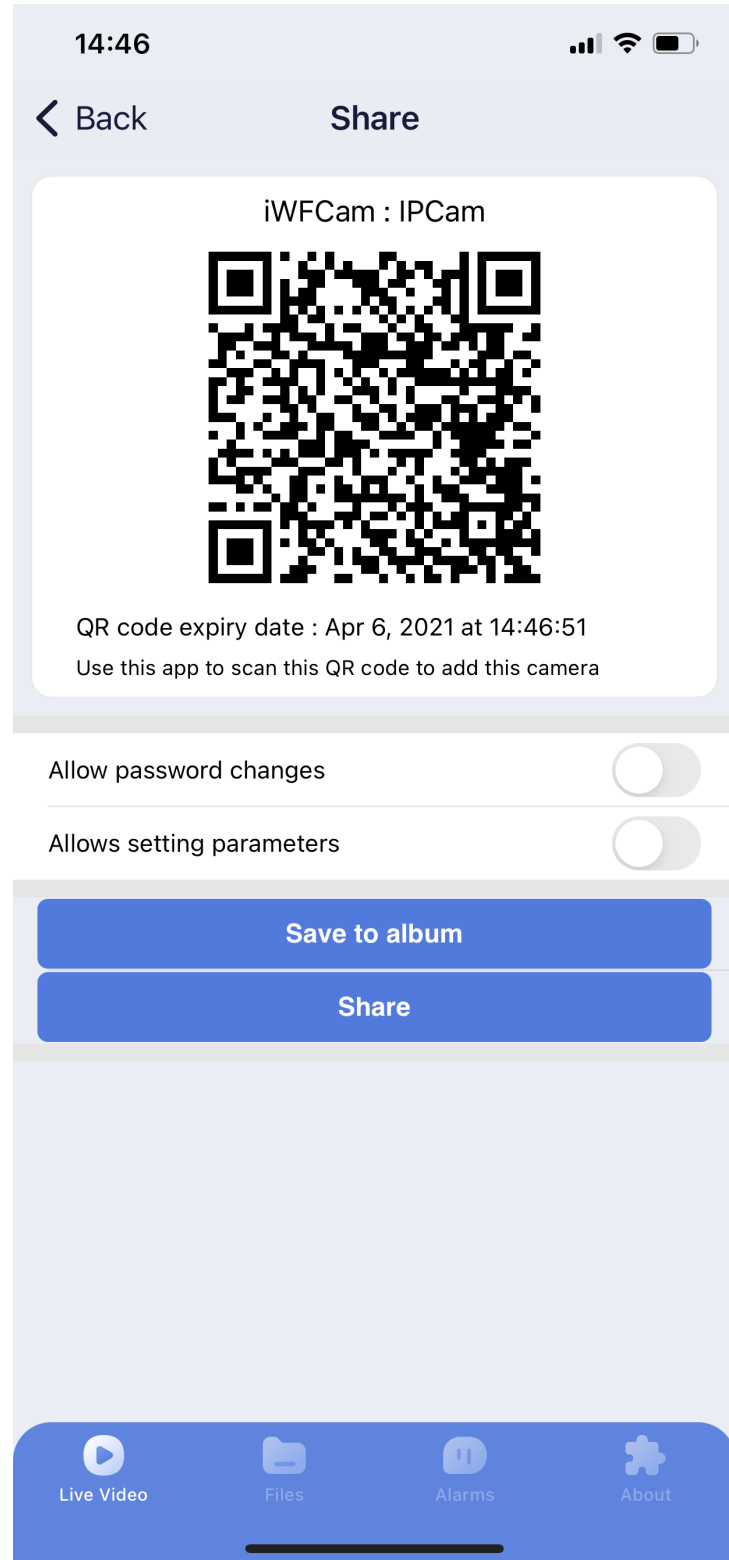
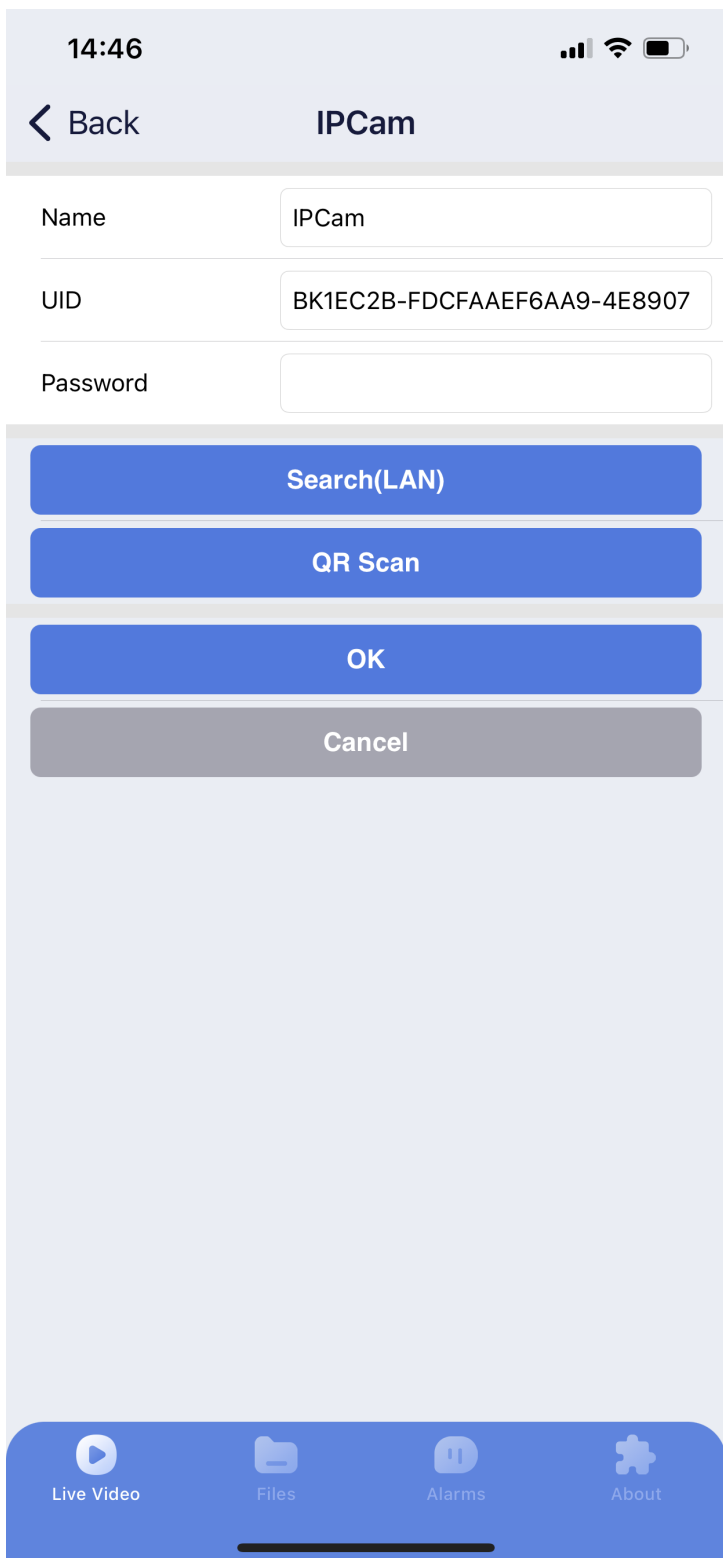

2.2 Device Settings

You can set Alarm Config, WiFi Config, SD Card Record Config, IR-LED Config, Time Setting, Misc Settings, Change Password and Reboot Device.

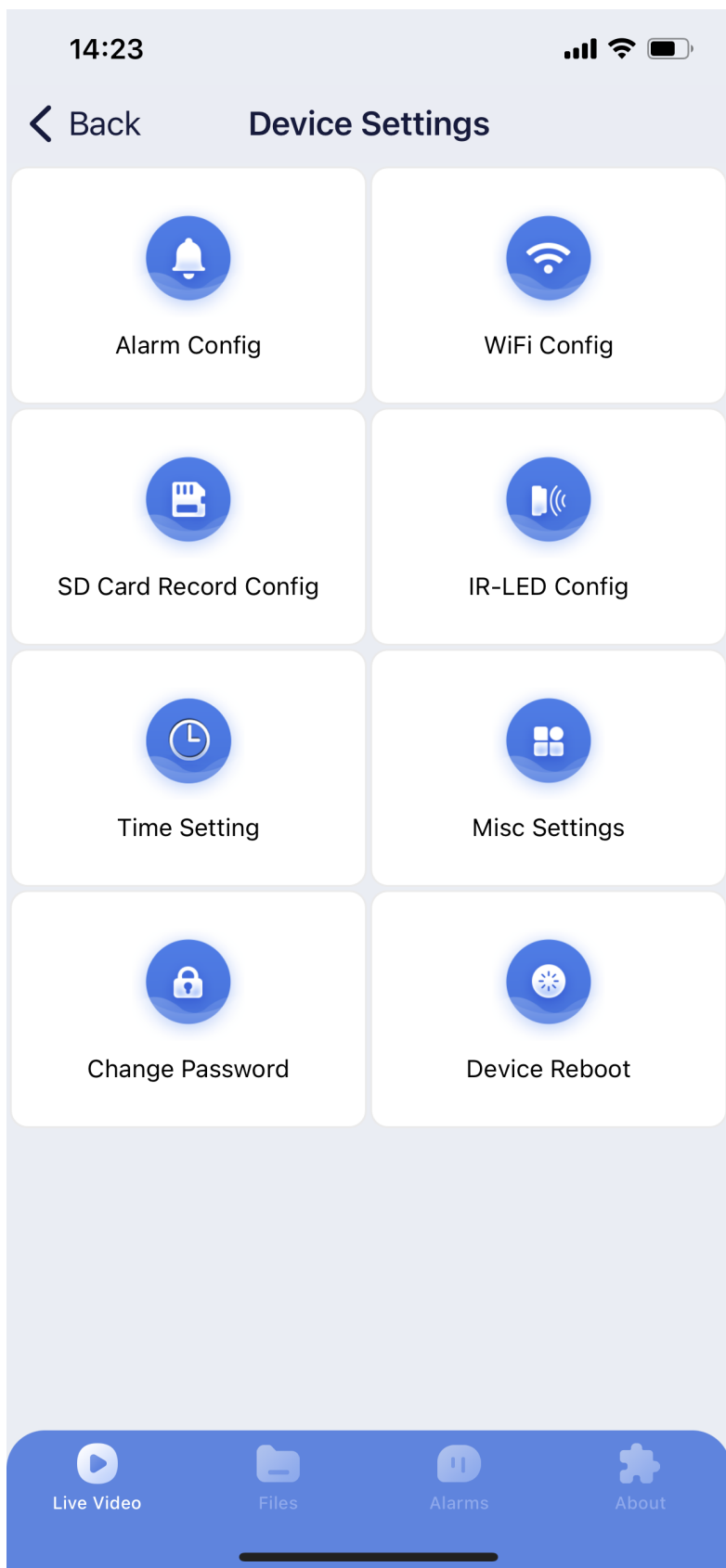

2.2.1 Alarm Config

With motion and sound detection, the camera can promptly alarm you with real-time situation. You can set Detection Sensitivity, alarm schedule time and alarm interval time, Push Notifications and On-Screen Display. The higher sensitivity you set, the more battery power and storage space it needs.

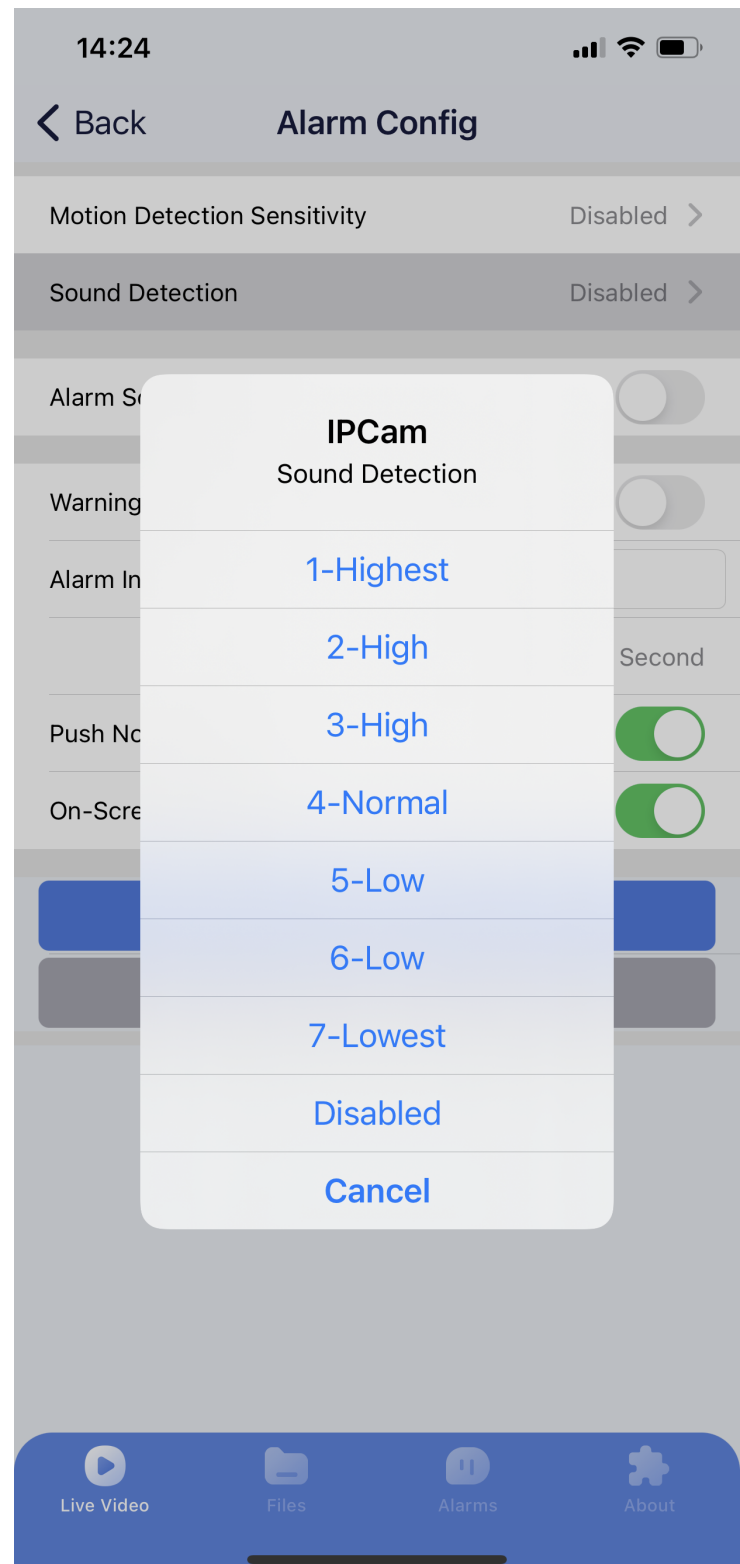
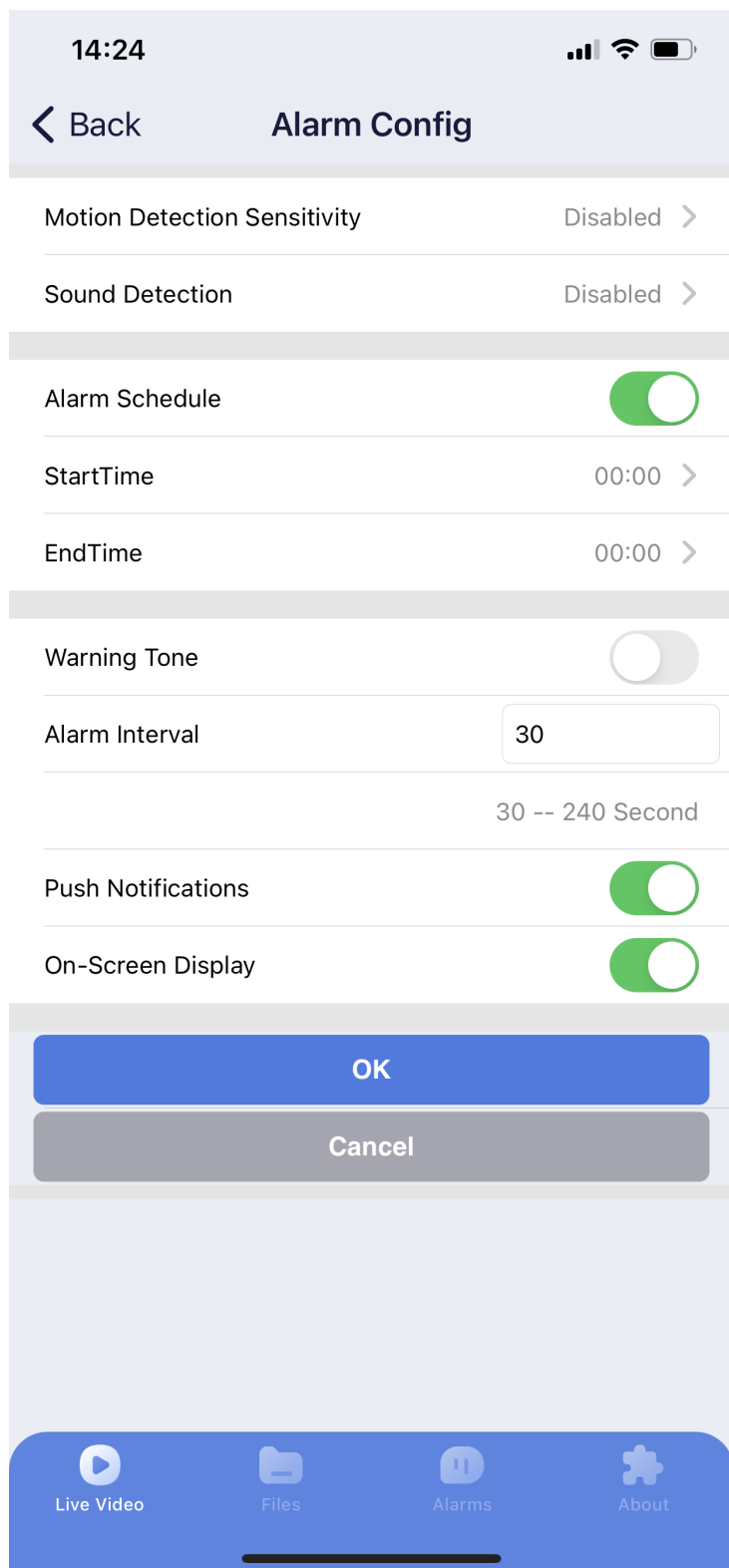

2.2.2 WiFi Config

In this step, you can set WiFi for the camera to connect with using router so that you can remotely access and watch real-time videos. Please refer to Connect Camera with WIFI Router (IP Mode) in point 3, Part III.

2.2.3 SD Card Record Config

The camera will auto detect whether you insert a card or not. Support MAX 32G, FAT32, not included.

Please format the card before use.

Please turn off the camera before inserting and removing the card, or the recording videos would be damaged.

Once inserted a card, it auto saves all recordings on the card; without a card, the recording files are saved on your phone app cloud. Without the card, you should manually click Video or Photo icon in the live feed page to start recording and saving files.

With Micro SD Card in

Recording files will be saved on the card with Micro SD card in. Please properly insert the card and format it before use.

Note: If you want to format the card in the APP, you should set Record OFF and confirm OK firstly to stop recording, and then click Format to format the card.

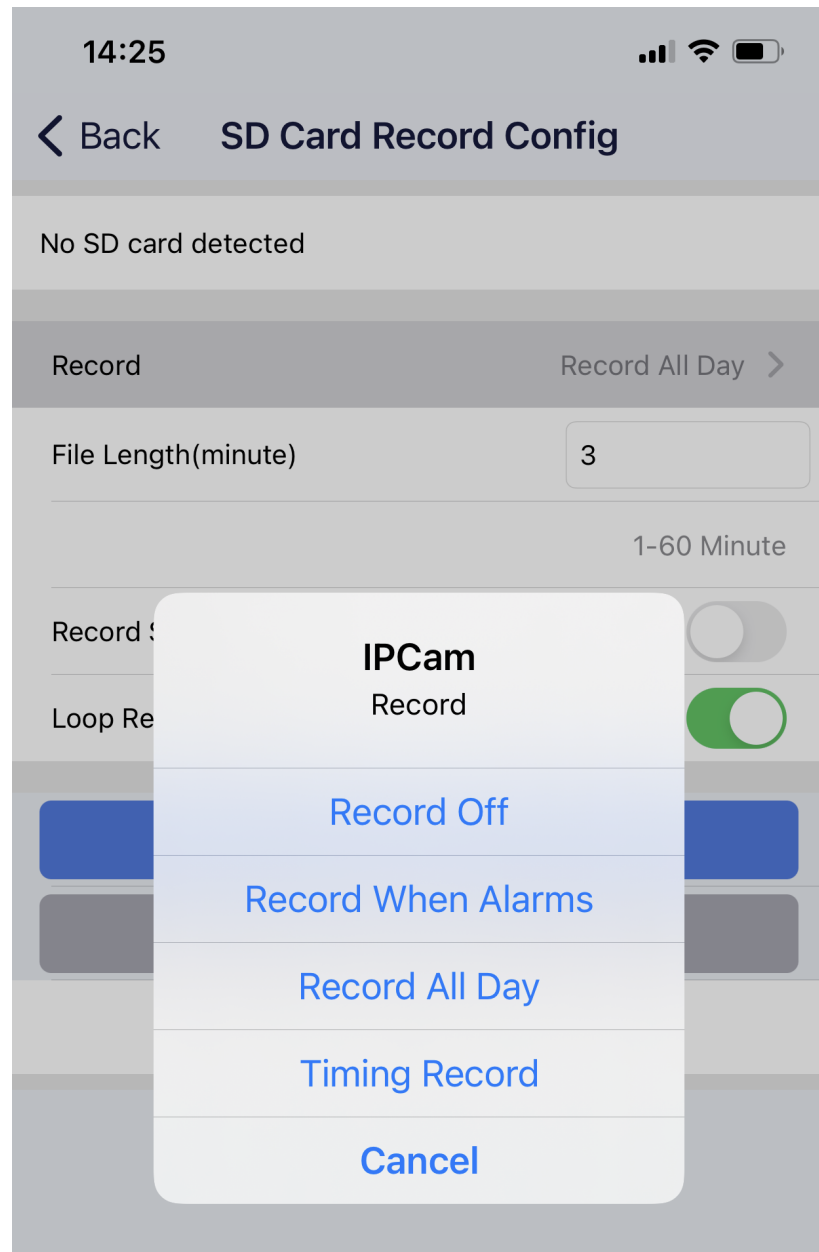
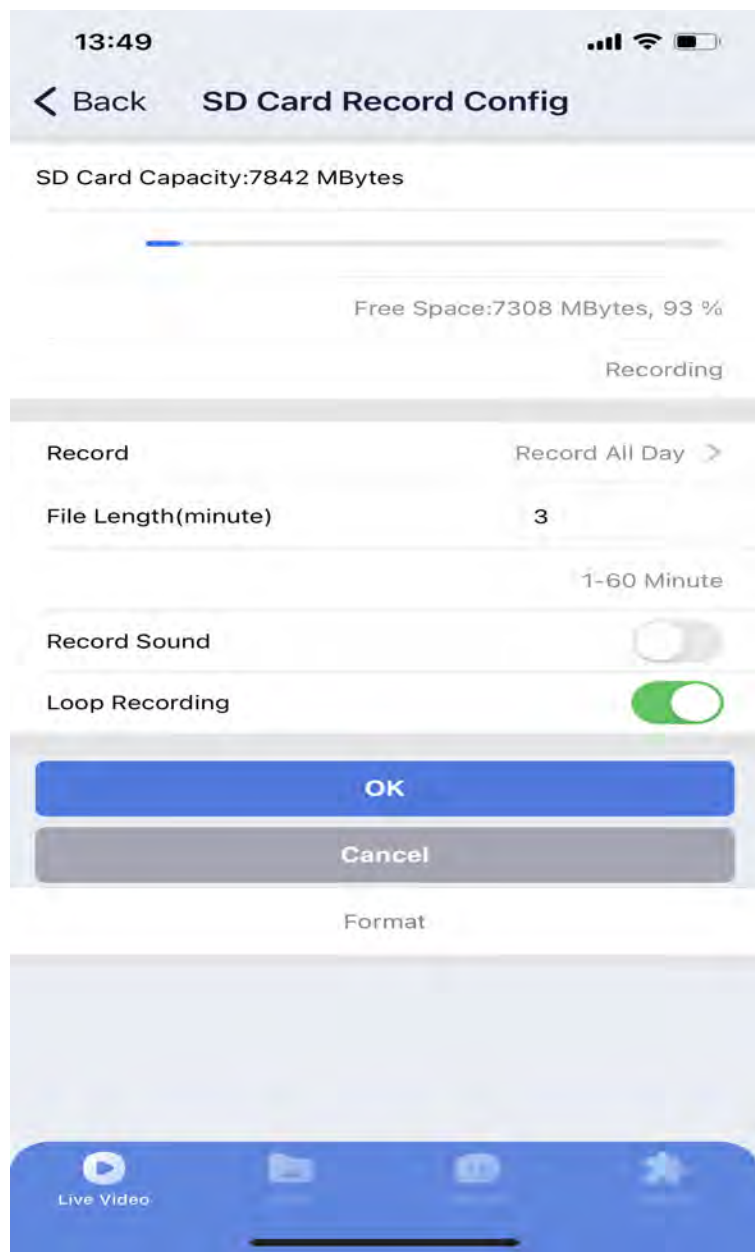

Without Micro SD Card

Without Micro SD card, the files will auto be saved in the APP cloud. You can directly playback the recording files on your phone.

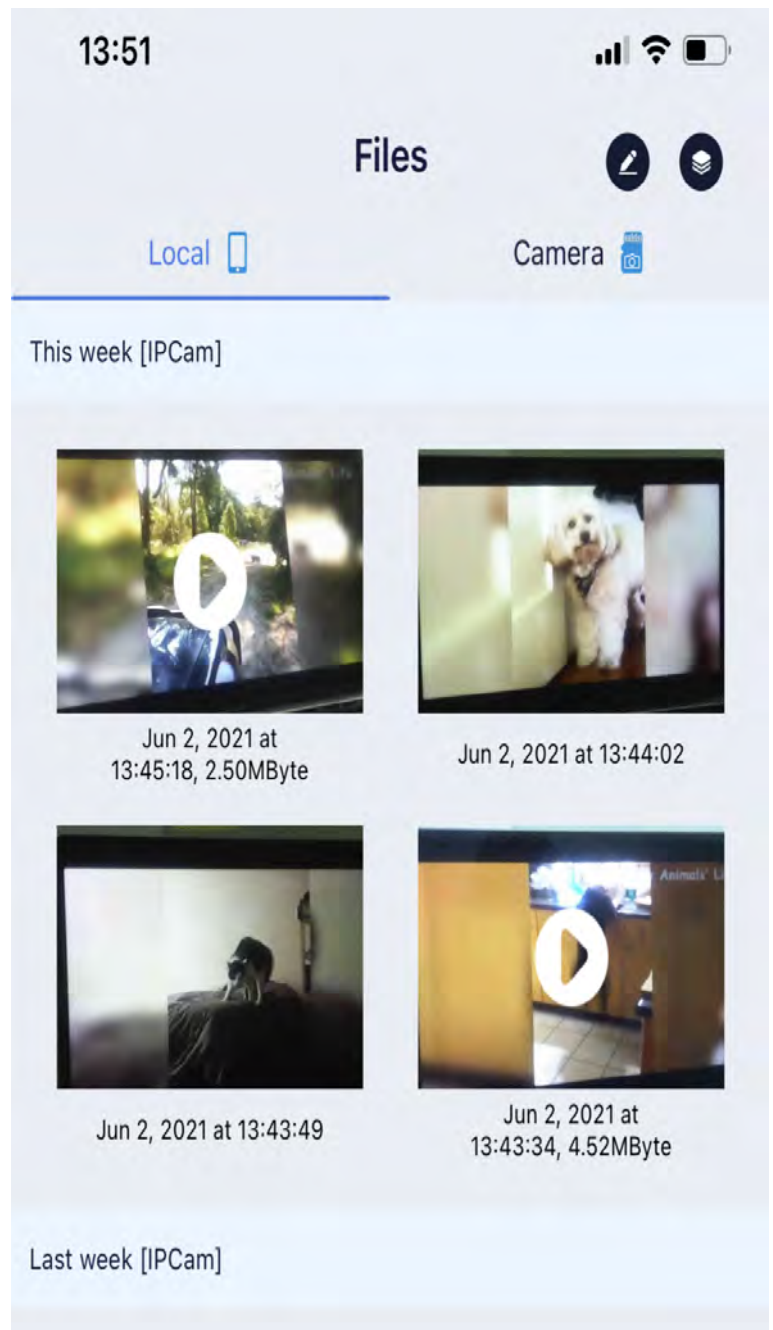
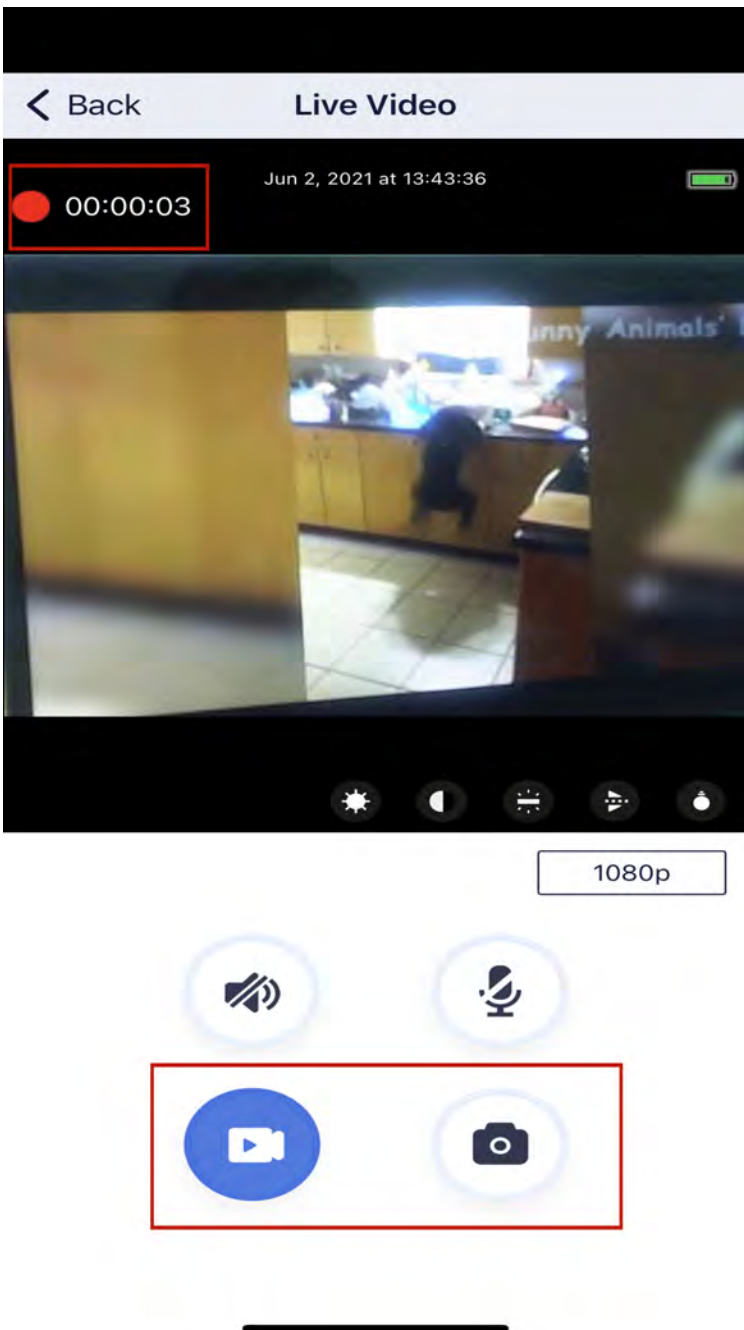

2.2.4 IR-LED Config

You can manually or schedule to turn on/off IR LED.

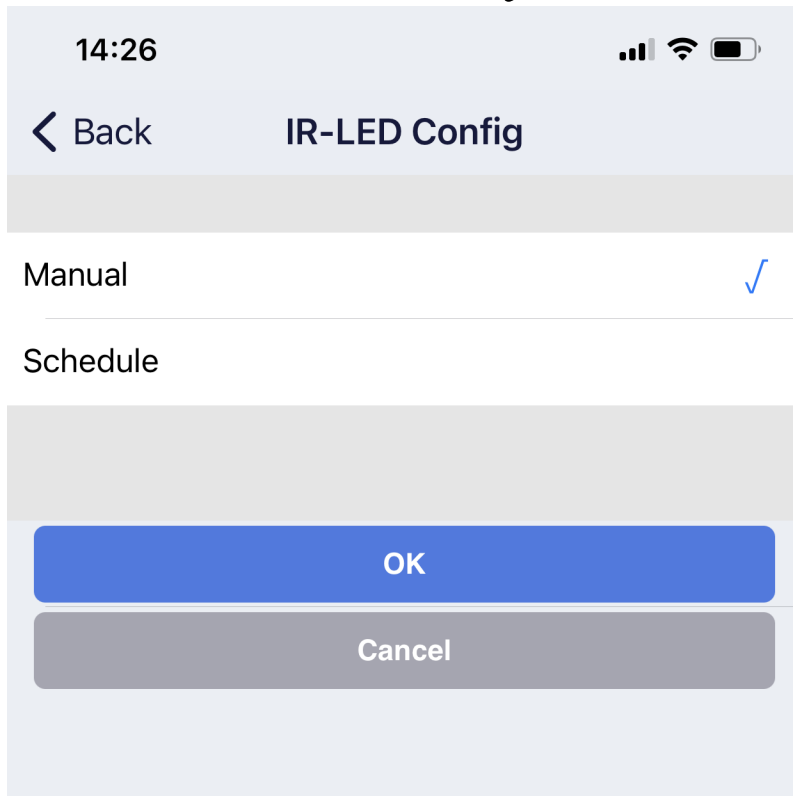

2.2.5 Time Setting

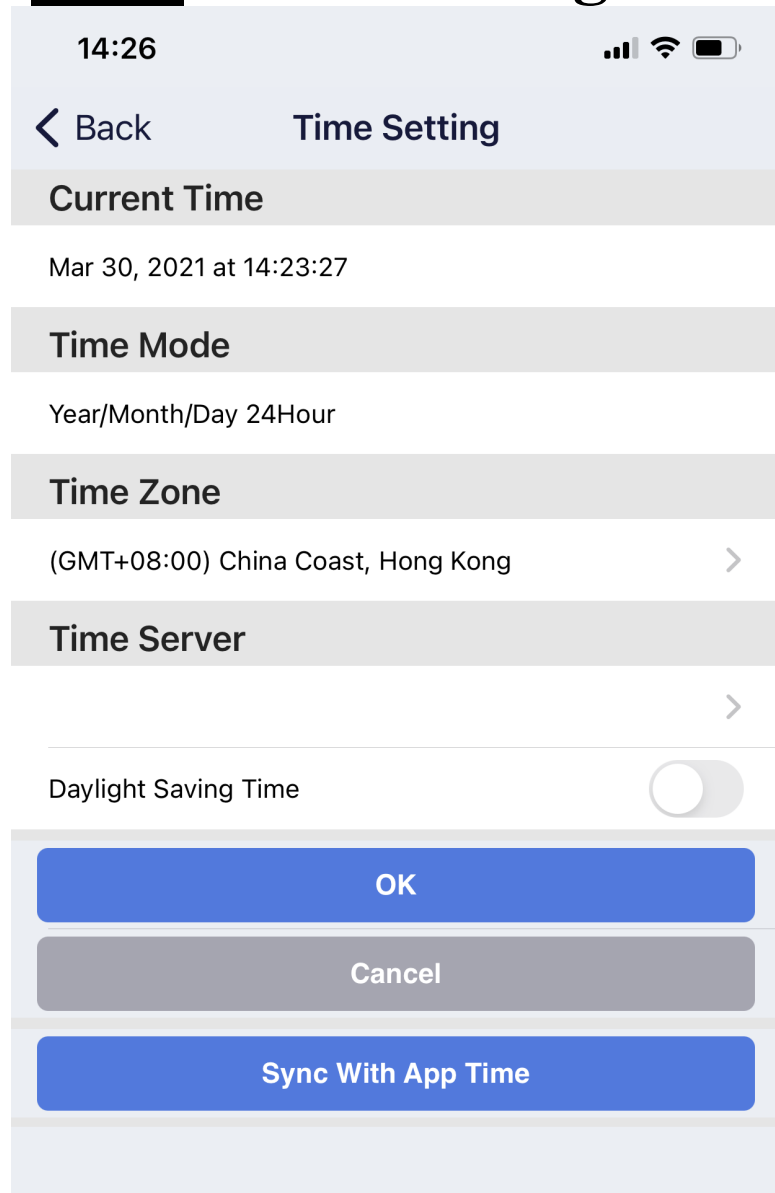

2.2.6 Misc Settings

You can turn ON/OFF the indicator lights and set the power frequency(50 Hz and 60 Hz).

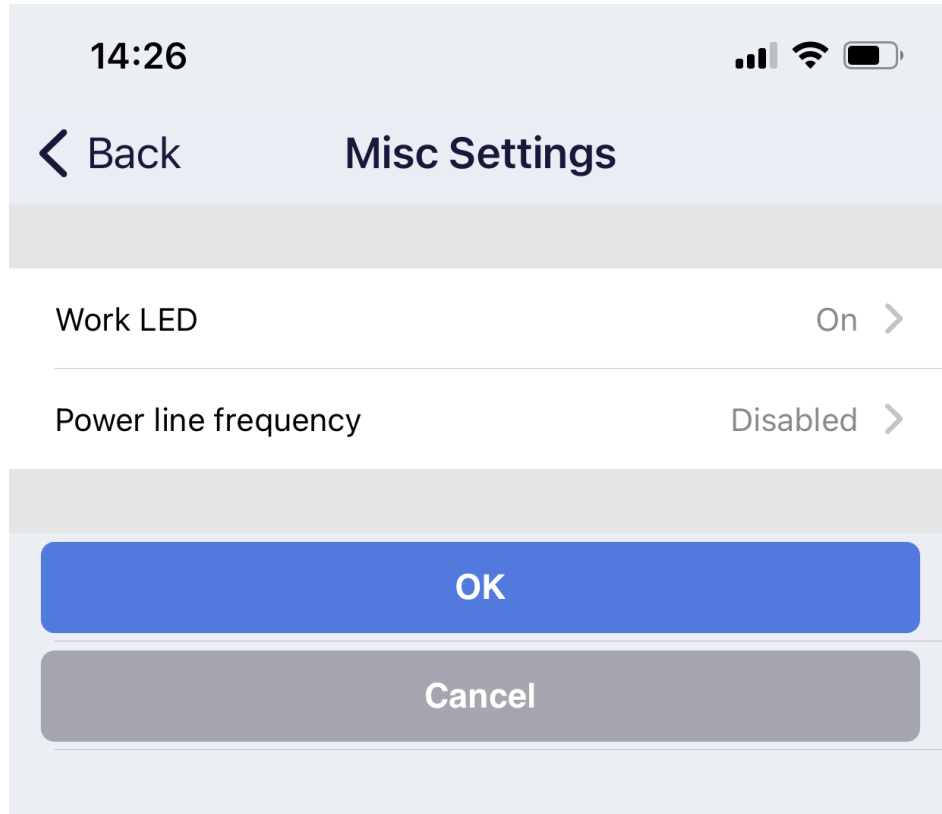

The screenshot shows the 'Misc Settings' screen. At the top, the time is 14:26, and there are icons for signal strength, Wi-Fi, and battery. Below the title bar, there are two settings: 'Work LED' set to 'On' and 'Power line frequency' set to 'Disabled'. At the bottom, there are two buttons: a blue 'OK' button and a grey 'Cancel' button.

2.2.7 Change Password

Default password is 8888.

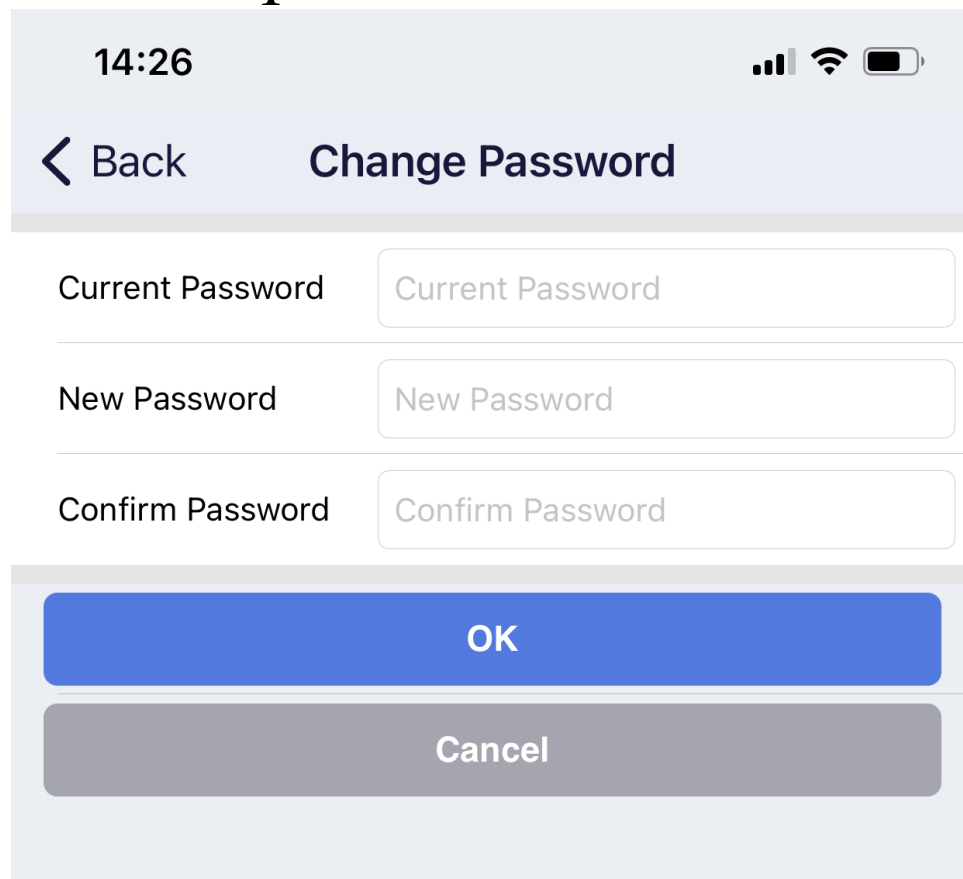

The screenshot shows the 'Change Password' screen. At the top, the time is 14:26, and there are icons for signal strength, Wi-Fi, and battery. Below the title bar, there are three input fields: 'Current Password', 'New Password', and 'Confirm Password'. At the bottom, there are two buttons: a blue 'OK' button and a grey 'Cancel' button.

VI. File Storage

Recording files will be saved on Micro SD card(Max 32G, not included) when you have one card in the device, or files will be saved on your phone APP local documents without card. You can check and playback the files in phone APP.

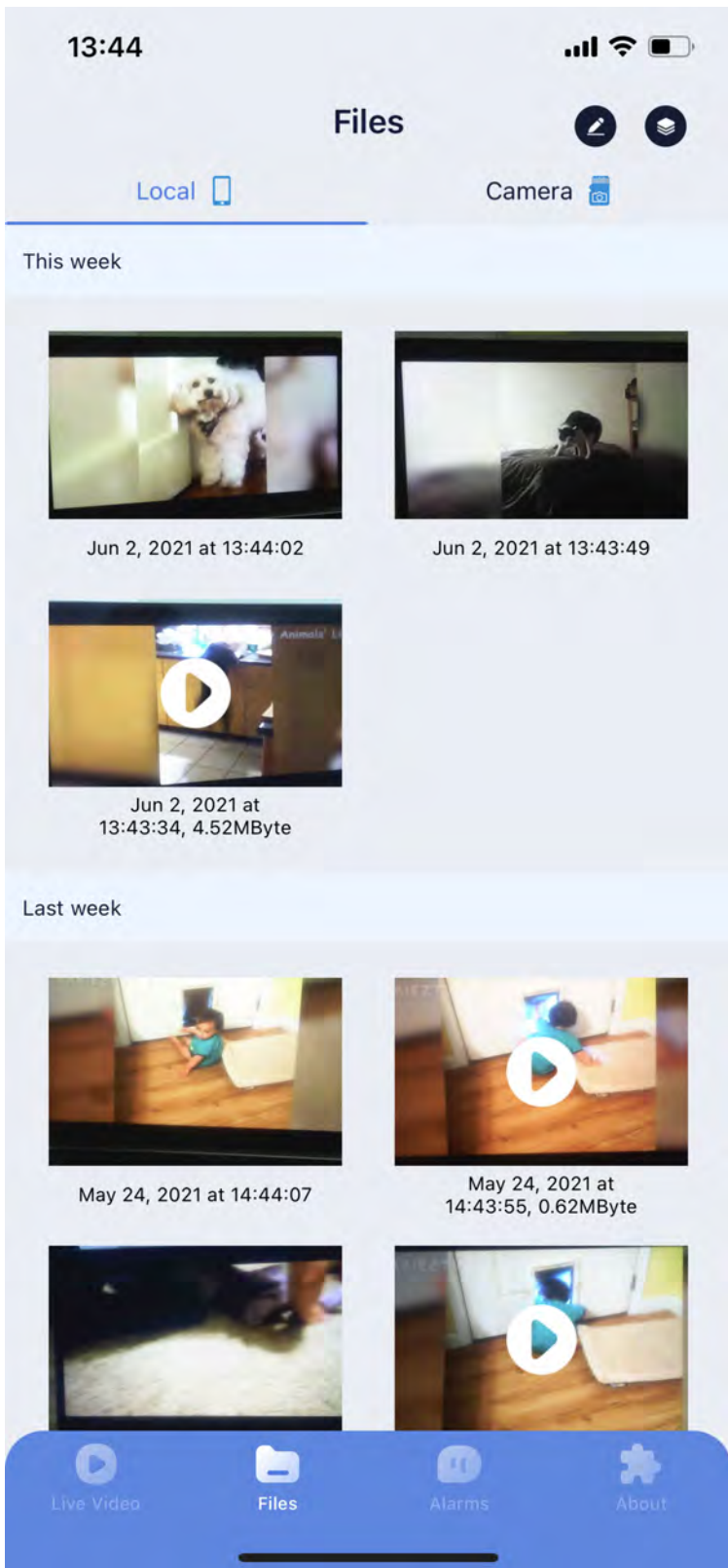

VII. Q&A

Q: Why my camera is offline and disconnect when I walk away?

A: Because you don't set WiFi Config in the APP for remote viewing. Please set the camera connect with the router so that you can remotely view the camera without distance limitation. Please refer to "**3.Set WiFi Config for remote viewing(IP Mode)**" on this manual page 8.

Besides, low power will also influence the signal of the camera and cause it offline. Please keep it charged while it is recording so that it can record for 7/24 without interruption.

Q: Can't connect the camera to app. The app is telling me my cell phone is not connected to wifi even though it is.

A: Turn on location services in the phone settings. Setting path: Phone Settings > Privacy > Location Services > ON and allow iWFCAM app to access the location (While using the app).

Q: Does it work without SD card?

A: Yes, it does. Micro SD card is not necessary. The camera can work without WiFi, too(card reequired).

Q: Why can't I receive notifications for motion detection?

A: Allow notifications of iWFCAM app with the path Phone settings >Notifications > iWFCAM > Allow Notifications.

Q: Micro SD card cannot save the videos?

A: 1) It supports SD card with speed above Class 4 (Max 32g).

2) Format SD card in FAT32 on computer or laptop.

3) Format the SD card again in the app, meanwhile please set Not Recording in the app Micro SD Card settings, or the card can't be formatted.

4) Please use genuine ones, and compatibility is not guaranteed for fake, inferior and refurbished cards.

Q: How do I watch the video of the sd card on my laptop?

A: The videos saved on the card are H.264 format. You can use the card reader in the package to playback the videos on your laptop in compatible players.

Q: Other issues

A: Highly recommend you to firstly reset the camera if you have any issues with the camera.

1) Press and hold the "R" button for 6 seconds to reset the cam until Red indicator light flashes slowly, which means it starts reset process; Red and Blue light together, which means the reset process has done;

2) Phone, camera, and WiFi router should be as close as possible for the first time connection. After setting WiFi Config for the camera, please keep it as close as possible to the router.

FCC Statement

This device complies with Part 15 of the FCC rules. Operation is subject to the following two conditions: 1) this device may not cause harmful interference, and 2) this device must accept any interference received, including interference that may cause undesired operation.

Note: This equipment has been tested and found to comply with the limits for a Class B digital device, pursuant to part 15 of the FCC Rules. These limits are designed to provide reasonable protection against harmful interference in a residential installation. This equipment generates uses and can radiate radio frequency energy and, if not installed and used in accordance with the instructions, may cause harmful interference to radio communications. However, there is no guarantee that interference will not occur in particular installation. If this equipment does cause harmful interference to radio or television reception, which can be determined by turning the equipment off and on, the user is encouraged to try to correct the interference by one or more of the following measures:

- Reorient or relocate the receiving antenna.
- Increase the separation between the equipment and receiver.
- Connect the equipment into an outlet on a circuit different from that to which the receiver is connected.
- Consult the dealer or an experienced radio/TV technician for help.

Changes or modifications not expressly approved by the party responsible for compliance could void the user's authority to operate the equipment.

Radiation Exposure Statement

This device complies with RF radiation exposure limits set forth for an uncontrolled environment. This transmitter must not be co-located or operating in conjunction with any other antenna or transmitter.

This device must operate with a minimum distance of 20 cm between the radiator and user body.