

**HISMITH<sup>®</sup>**



**AK-01**

Please read this instruction manual carefully before using this product  
Keep this manual for future reference  
Hismith sex machines are designed for ultimate pleasure

# CONTENTS

01 English  
1.....13

02 Deutsch  
14.....27

03 Français  
28.....41

04 Nederlands  
42.....55

### About HISMITH®

When we started the Hismith adventure in 2012, sex toys had become more compact and better looking, but you still needed to do the job yourself. We were only a bunch of horny engineering students back then, but we just knew there had to be a better way. Machines have already taken over most of the jobs that us humans used to do. So, we asked ourselves: why not blowjobs?

And so, our mission became to make ultimate pleasure available to anybody, anywhere, with the touch of a button. We take great pride in creating our premium sex machines. Experience harder, better, faster and longer sex than any human can ever offer you.

Our brand new Hismith APP offers you full control of your Hismith device(s) through your smart phone. The app adds another layer of features and functionalities such as: Giving control of your sex machine to someone else, easily designing and saving your own sex machine programs, a social section to find others to play with and much more.

HISMITH, ultimate pleasure.

### How to Assemble The Device

Preparation: Take all parts out of the foam container. Remove the protective film on the bars and pluck one of the anti-skid caps off each bar to prepare for the next step.

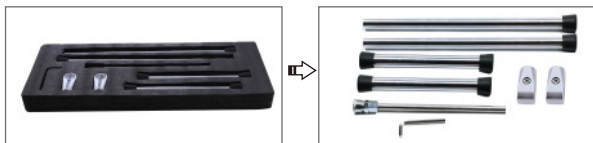

### Part 1: Installing The Support

1: Take one short bar, a long bar and a metal Clip and connect them into a T-shaped leg, as you can see on the image below. Once you have correctly placed it, tighten the screw. Repeat this process to setup the second leg as well.

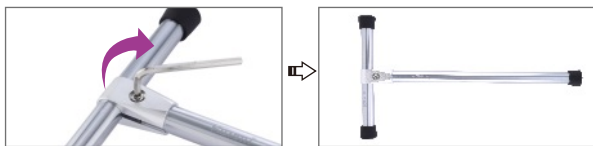

2: Loosen the clip on the main sex machine body. Push the long end of the T-Shaped leg, without the anti-skid cap, through the hole and proceed to tighten the clip again in the desired position. Repeat the process for the second leg. Refer to the illustration below:



**Tip: if you're having difficulties tightening the clip, you can adjust its position a bit by turning it to the side.**

### Part 2: Install The thrust Bar and Attachments

1: Loosen the knob (butterfly screw) on the side of the machine a little, as shown on the illustration below. Avoid unscrewing it fully.



2: Insert the thrust bar in the front of the machine until you can't go any further. You will be able to screw the thrust bar, clockwise, onto the thrusting mechanism inside the hole. Once it is screwed onto the internal thrusting mechanism, you can tighten the knob (butterfly screw) again. Feel if the thrusting bar is attached tightly. If it's not attached tightly, take it off and repeat this step until you are sure that the thrust bar is safely attached.

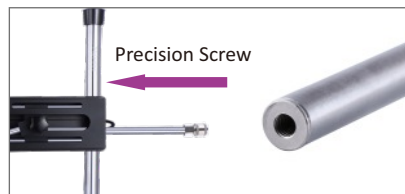

3: Connecting the Hismith dildo: Simply hold the dildo and push the octagonal shape pin, into the KlicLok® system in the front of the thrusting bar. Once you hear the click, you will know that it's locked. You can remove the dildo again by pulling back the ring on the KlicLok system, which will then eject the dildo.



### Part 3: Connect the Power Adapter And speed Controller

- 1: Connect the power adapter with the cable box, make sure everything is connected firmly.



- 2: Connect the speed controller: While inserting the cable, please carefully align the pins with the holes in the power cable. Once it is connected, tighten the ring on the cable.



### Part 4: A Safety Way to Plug it into a Wall Socket

- 1: Make sure the red switch on the Speed Controller is switched OFF, before plugging it in.
- 2: If necessary, adjust the dial to zero, to avoid the machine to move directly to high speeds when it is switched on.

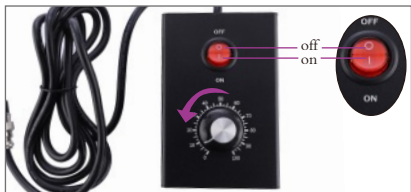

### Hismith Premium Sex Machine Parameters

Input Voltage	110V~250V / 50~60HZ
Output Voltage	24V/4.17 A (safety voltage)
Motor max power	100W
The Stroke Length	approx 1.18-5.9 inches (3cm~15cm)
Noise	30-50db
Connector	KlicLok® System

### APP Control Version

Remote control distance	>10m
Battery	AAA(not included )

### Warranty

We grant a 1-year warranty on this product, commencing on the date of purchase. Within the warranty period, we will restore any defects in the product resulting from faults in materials or workmanship, either by repair or replacing the complete appliance based on the defect. This warranty extends to any country where this appliance is supplied by Hismith or its appointed distributors.

This warranty does not cover: Damage due to improper use, use with inauthentic connectors and adapters or cosmetic defects that do not hinder the operation of the appliance. The warranty becomes void if repairs are undertaken by unauthorized personnel.

Sex machine positioning tips



APP CONTROL VERSION

If you get an APP Control machine, Please check Hismith APP User Manual to find more details



KlicLok® System

Our patented octagonal KlicLok-connector keeps toys safely in the intended position with one easy click.



2. The male part of the connector on our KlicLok accessories is removable in order to use it with or without your sex machine.

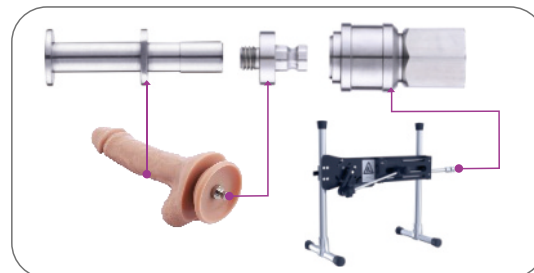

When the part is in, you can use it with your Hismith sex machine, or screw it off to use it as a regular suction cup dildo.

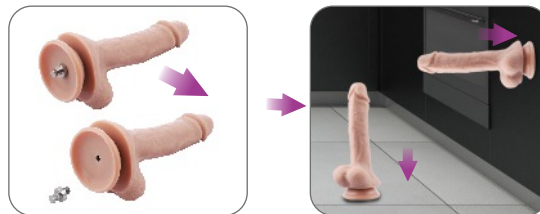

## Warnings and precautions

- 1: The machine and accessories are not waterproof, please do not use the machine in damp, moist or wet places. Do not touch the power plug with wet hands, this can cause an electric shock.
- 2: Don't idle the machine in high speeds to avoid accidental injury.
- 3: Please check if the thrust bar is connected tightly, before using heavy attachments, such as a male masturbation cup or large dildos.
- 4: Please adjust the speed dial to zero before turning the machine on.
- 5: We advise against the use of this product by cardiac patients such as people with high blood pressure.
- 6: This product is not intended for use by minors. Keep away from children.
- 7: The motor will gradually warm up with continuous use. We advise to use it no more than 30 minutes at a time, before letting the motor cool down.
- 8: Use this product only for its intended use as described in this manual. Use only the original Hismith connectors to attach your toys to this product.
- 9: This sex machine is a personal device, intended for solo or couple use only. In case of sharing the device with others, pay close attention to personal hygiene to avoid risk of diseases or infections.
- 10: Remove piercings or jewelry in the genital area before use.
- 11: Do not use the toy on irritated or damaged skin. Stop using the device if you experience pain or feel unwell during use.
- 12: Do not use the device if it is: unusually hot, damaged or deformed, discolored.

## Our attachments and adapters

Below you will find a number of the connectors and attachments that are available to use in combination with your new sex machine. Please contact Hismith support for more information about these products.

## Connectors



HSC36

HSC02

HSC03

HSC04



HSC07

HSC09

HSC11

HSC17



HSC18

HSC19

HSC23

HSC28



HSC20

HSC21

HSC22

Beginner 6"-8"



Intermediate 8"-9"

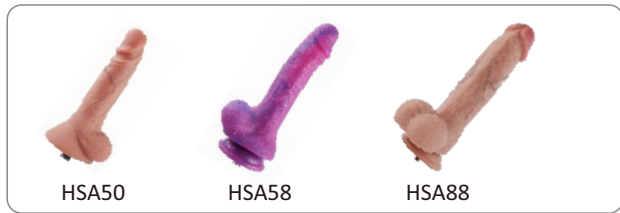

Master 10"



Monster Series

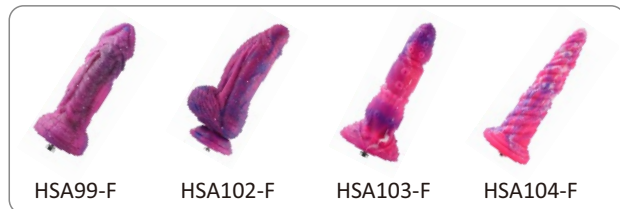

Masturbation Cup





Vibration Series  
(with remote controller)

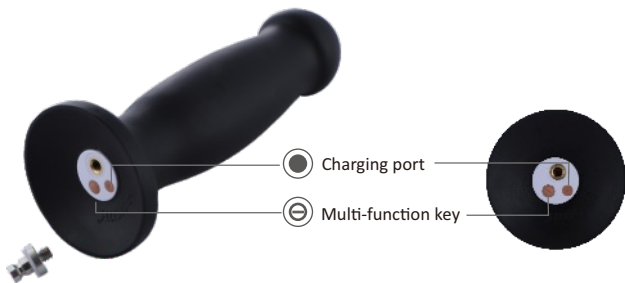

### Care and Maintenance

Please lubricate the sliding rail with heat resistant gear oil periodically. We suggest lubing it every three months. When cleaning the machine, please use dry paper or cotton towels, if you do clean it with wet cloth, please air dry it as soon as possible.

### Contact Us

If you encounter any problems or have any questions you would like us to answer, please do not hesitate and contact us at [support@hismith.com](mailto:support@hismith.com), we will do our best to find a solution within 12 hours. For bulk business please Email to Brian and Misha.

**Customer support:** [support@hismith.com](mailto:support@hismith.com)

**For Business:** [brian@hismith.com](mailto:brian@hismith.com)

[misha@hismith.com](mailto:misha@hismith.com)

### Disclaimer

Use at your own risk. Neither Hismith, nor its retailers take any responsibility or liability for the use of this product. Proper use also includes compliance with our Quick Start Guide as well as the warnings listed herein. Furthermore, Hismith reserves the right to revise this publication and make changes to the contents without obligation to notify any person of such revision. Translations of any materials into languages other than English are intended solely as a convenience to the non-English-reading public and are not legally binding. We have attempted to provide an accurate translation of the original material in English, but due to the nuances in translating to a foreign language, slight differences may exist.

Applicable for all products. Model may be changed for improvements without notice.  
©2022Hismith. All rights reserved  
Shenzhen Hismith Technology Co.,Ltd  
Designed and manufactured by Hismith in China  
Official Website:[www.hismith.com](http://www.hismith.com)

#### Federal Communications Commission Notice

This device complies with part 15 of the FCC Rules. Operation is subject to the following two conditions: (1) This device may not cause harmful interference, and (2) this device must accept any interference received, including interference that may cause undesired operation.

Any Changes or modifications not expressly approved by the party responsible for compliance could void the user's authority to operate the equipment.

**Note:** This equipment has been tested and found to comply with the limits for a Class B digital device, pursuant to part 15 of the FCC Rules. These limits are designed to provide reasonable protection against harmful interference in a residential installation. This equipment generates uses and can radiate radio frequency energy and, if not installed and used in accordance with the instructions, may cause harmful interference to radio communications. However, there is no guarantee that interference will not occur in a particular installation. If this equipment does cause harmful interference to radio or television reception, which can be determined by turning the equipment off and on, the user is encouraged to try to correct the interference by one or more of the following measures:

- Reorient or relocate the receiving antenna.
- Increase the separation between the equipment and receiver.
- Connect the equipment into an outlet on a circuit different from that to which the receiver is connected.
- Consult the dealer or an experienced radio/TV technician for help.

The device has been evaluated to meet general RF exposure requirement. The device can be used in portable exposure condition without restriction.