

Wireless Microphon

Type-C/Lightning

User Manual



Instruction

Thanks for choosing our product

This product is a smart wireless microphone, which can provide professional recording output. Plug and play, No App or Bluetooth Required. Widely used: it can be used in online live broadcast, video Vlog shooting, program interview, recording, video teaching and other occasions. (Note: Video conferencing is not supported)

The wireless microphone consists of three parts: Microhone Transmitter, Receiver and and Charging Case.

The product has two configurations: 1T1R and 2T1R. The manual is general, please take the real object as the standard (as shown in the figure below)



ID diagram

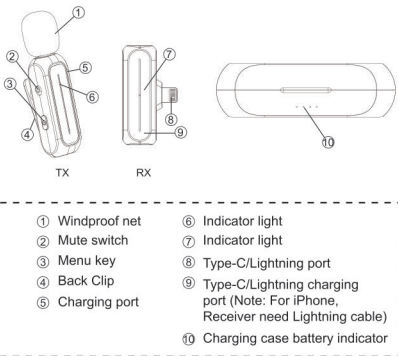

The product has two configurations: 1T1R and 2T1R. The manual is general, please take the real object as the standard

HOW to Use

Step 1 : Take out the RX from the charging box and insert the RX into the mobile device port, the blue light flashes indicating that the RX is powered on and successfully linked with the mobile phone.

Step 2 : Take out the microphone(TX) from the charging box, and the transmitter will turn on automatically. At this time, the white indicator light flashes and blue alternately. The TX and The RX will be paired automatically. After successful pairing, the blue lights of TX and Rx will always be on. It can be used.

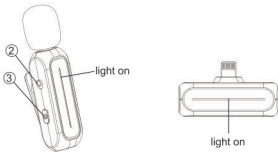

Notices : ③ is a Menu key which can shutdown of the TX, and also it is a power on/off switch.
② can control the microphone recording and Pause/Mute recording. Pause refer to UI menu for details (Note: Mute recording just stop microphone recording, Phone recording will still continue)

Notes:
Since the RX occupies the charging port of the mobile phone, if the mobile phone is low power at this time, the mobile phone can be charged through the type-C or lightning port of the RX.

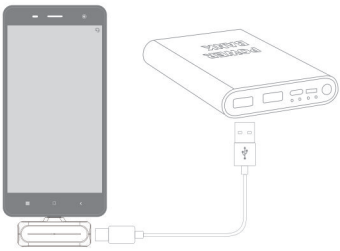

About UI

Function	How to use	Light	Notices
Power on	take it out of the charging box	The white and blue light flashes	Press the key for 1s
Power off	Put it into the charging box	The white light flashes three times	Press and hold the key for 3s
Paired with RX	/	The blue light on	Automatically paired
Mute/Pause recording	Toggle switch up	Blue light flashes twice quickly in two seconds	Reverse operation can restore recording
Denosing mode	Press the key once	Blue light breathing	Click again to exit
KTY mode	press the key twice	White light breathing	Click again to exit
Low battery	Put the device into the charging box	The white light flashes quickly twice every 5s	
Charging		White light on/light off after fully charged	Or charge with usb-c port

Receiver RX

Function	How to use	Light	Notices
Power on	Plug in the device	The blue light flashes	
Power off	Pull off the device	The light off	
Paired with TX	Blue light on	Automatically paired	
Disconnect pairing		The blue light flashes	

Charging case

Battery level led	The four LEDs from left to right indicate 25%- 50%- 75% and 100% battery level. Four LEDs are on, indicating 100% battery level. For every 25% decrease in battery level, turn off one LED. Must be use the 5V adapter to charge the charging case. During the charging process, the current battery level LED flashes, and the four indicators are always on after full charge.
Charging case output	When the microphones put into the Charging case, it will automatically charge the MIC. During the charging process, the power light of the case is always on. After the MIC is full, the case will enter the sleep state of turning off the light
Charging case input	Please use the 5V adapter to charge the charging case. During the charging process, the current battery level LED flashes, and the four indicators are always on after full charge

Packing List

- (1) Microphone Transmitter (TX)
- (2) Receiver (RX)
- (3) Charging case
- (4) Typc-C charging cable
- (5) User manual
- 【 】 1T1R Wireless Microphone
- 【 】 2T2R Wireless Microphone

Notices: The 1T1R Wireless Microphone is the same as that of 2T2R Wireless Microphone function operation. This user manual is shared.

This device complies with part 15 of the FCC Rules. Operation is subject to the following two conditions: (1) this device may not cause harmful interference, and (2) this device must accept any interference received, including interference that may cause undesired operation.

Any changes or modifications not expressly approved by the party responsible for compliance could void the user's authority to operate the equipment.

NOTE: This equipment has been tested and found to comply with the limits for a Class B digital device, pursuant to Part 15 of the FCC Rules. These limits are designed to provide reasonable protection against harmful interference in a residential installation. This equipment generates, uses and can radiate radio frequency energy and, if not installed and used in accordance with the instructions, may cause harmful interference to radio communications. However, there is no guarantee that interference will not occur in a particular installation.

If this equipment does cause harmful interference to radio or television reception, which can be determined by turning the equipment off and on, the user is encouraged to try to correct the interference by one or more of the following measures:

- Reorient or relocate the receiving antenna.
- Increase the separation between the equipment and receiver.
- Connect the equipment into an outlet on a circuit different from that to which the receiver is connected.
- Consult the dealer or an experienced radio/TV technician for help.

The device has been evaluated to meet general RF exposure requirement. The device can be used in portable exposure condition without restriction