

## 3合1无线充电器(折叠式) 使用说明书



### 一、产品简介

本产品是一款三合一快速无线充电器，可同时为支持Qi标准的手机/iWatch/TWS蓝牙耳机无线充电。本产品另外还增加夜晚环境灯设计，是一款方便实用的智能电子设备。

本产品采用折叠设计。产品的折叠方式，更便于存放和携带；打开充电面板状态可以同时为多台设备充电。将设备置于充电区，即可为设备无线充电。您可以将手机竖放或横放，不影响手机充电，充电的同时可以视频聊天或看喜欢的影视。



### 二、规格参数

品名	3合1无线充电器
使用方式	可折叠
材质	塑胶+亚克力
颜色	黑色
接口	Type-C
输入电流	≥9V-2A, 5V-3A, 12V-1.5A
手机输出	15W/10W/7.5W/5W
手表输出	2.5W
耳机输出	3W
适配器	≥QC3.0 18W
尺寸	165X141.3X13mm
兼容性	支持符合Qi标准的手机、蓝牙耳机、苹果手表
产品清单	无线充电器x1、充电线x1、说明书x1

### 三、操作步骤

- 在对其他设备进行无线充电时，请通过配备的充电线先为本产品供电。
- 轻按环境灯开关按键，打开环境灯；再次轻按环境灯开关按键，关闭环境灯。

- 为手机、iWatch或蓝牙耳机等设备充电时，将手机、iWatch或蓝牙耳机平放在充电区，0.1秒后，开始为设备充电；当充满电后，可以直接取下设备；充电过程中，如果设备需要终止充电，可以直接取下。

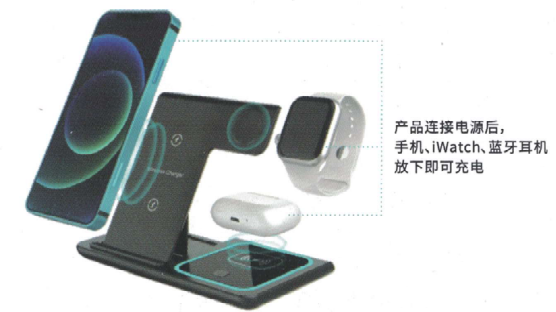

- 产品翻开状态，手机充电时，可以横/竖摆放充电。

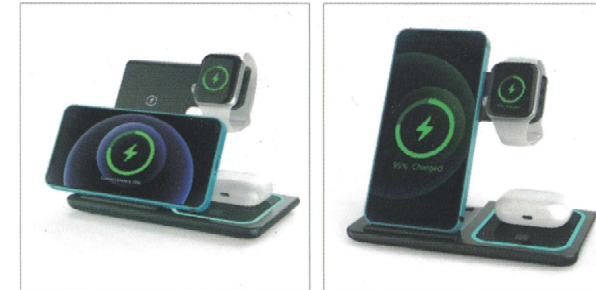

- 产品可以折叠，方便存放和携带。



### 四、注意事项

- 禁止将产品浸入水中，避免造成内部电路短路。
- 禁止自行拆卸或摔打产品，以免造成产品损坏。
- 请将产品放置在远离易燃易爆的液体、气体或爆炸品的地方。
- 请勿将磁卡、磁条介质和精密机械放置在离本产品太近的位置。

## 3-IN-1 Wireless Charger (Foldable) User Manual



### I . Product Description

This device is a 3-in-1 fast wireless charger which can support power charging for Qi compatible mobile phone/iWatch/TWS bluetooth headset. Also nightlight design is special and more practical. This product adopts folding design. The folding method of the product is more convenient for storage and carrying. It can charge multiple devices at the same time. Place the device in the charging area to wirelessly charge the device. You can place the phone vertically or horizontally without affecting the charging of the phone, and you can video chat or watch your favorite movies while charging.

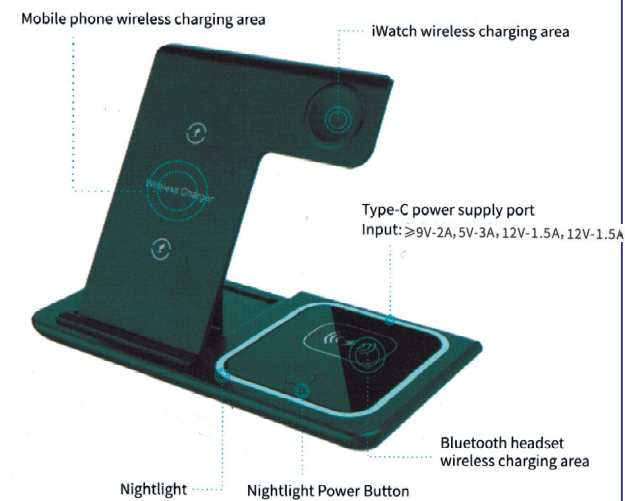

### II . Specifications

Name	3 in 1 Wireless Charger
Using Type	Foldable
Material	Plastic + Acrylic
Colour	Black
Charging Port	Type-C
Input Current	≥9V-2A, 5V-3A, 12V-1.5A, 12V-1.5A
Phone Output	15W/10W/7.5W/5W
Watch Output	2.5W
Headphone Output	3W
Adapter	≥QC3.0 18W
Inch	165*141.3*13mm
Compatibility	Support Qi Compatible Mobile Phones, Bluetooth Headsets, Apple Watch
Product List	Wireless Charger x1, Charging Cable x1, Manual x1

### III.Operation Steps

1. Please firstly power on the device by our provided power cable.
2. Turn on / off nightlight by the nightlight power button.
3. When charging devices such as mobile phone, iWatch or bluetooth headsets, just place these devices on the charging area and they will be charged only after 0.1 second. When the devices are full charged or you want to terminate charging, just take them away from charging area.

Wireless charging for mobile phone, iWatch and TWS bluetooth headsets



4. When the device is open, the mobile phone could be charged in horizontal or vertical direction.



5. The product can be folded for easy storage and carrying



### IV.Precautions

1. It is forbidden to immerse the device in water to avoid short circuit of the internal circuit.
2. It is forbidden to disassemble or beat the device by yourself to avoid to damage the device.
3. Please place the device away from flammable and explosive liquids, gases or explosives.
4. Do not place magnetic cards, magnetic stripe media and precision machinery too close to the device.

## FCC Warning

This device complies with part 15 of the FCC Rules. Operation is subject to the following two conditions:

(1) This device may not cause harmful interference, and (2) this device must accept any interference received, including interference that may cause undesired operation.

Any Changes or modifications not expressly approved by the party responsible for compliance could void the user's authority to operate the equipment.

Note: This equipment has been tested and found to comply with the limits for a Class B digital device, pursuant to part 15 of the FCC Rules. These limits are designed to provide reasonable protection against harmful interference in a residential installation. This equipment generates uses and can radiate radiofrequency energy and, if not installed and used in accordance with the instructions, may cause harmful interference to radio communications. However, there is no guarantee that interference will not occur in a particular installation. If this equipment does cause harmful interference to radio or television reception, which can be determined by turning the equipment off and on, the user is encouraged to try to correct the interference by one or more of the following measures:

- Reorient or relocate the receiving antenna.
- Increase the separation between the equipment and receiver.
- Connect the equipment into an outlet on a circuit different from that to which the receiver is connected.
- Consult the dealer or an experienced radio/TV technician for help.

The FCC certification of this device refers to RF exposure testing performed in typical operating conditions, where a person is no closer than 20 centimeters from the device surface at all times, except for non-repetitive patterns with transient time intervals in the order of a second. Only in the stated conditions, the device is shown to fully comply with the FCC RF Exposure requirements of KDB 447498.