

Introduction

Thank you for choosing the ASAHOM LED Bulb String Lights. This product has an IP65 water-resistant rating, making them ideal for outdoor use. You can adjust the brightness and set up a timer through the Tuya Smart app.

Control String Lights in Series

Connect the string lights as indicated in the picture.

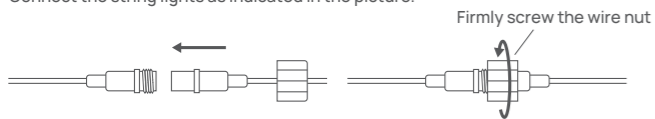

Notice: Only 2 string lights can be connected in a series.

Installing Your Device

Installing Steps

Hang the light bulbs onto the rope using the hook.

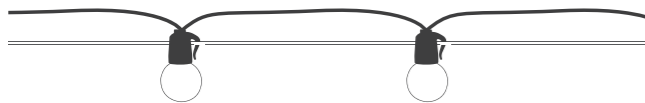

• The adapter is not waterproof. Exercise caution when using the adapter outdoors.

Pairing Your Device with the Tuya Smart App

What You Need:

- A smartphone or tablet running iOS 8.0 (or above) or Android 4.3 (or above).
- A WiFi route supporting the 2.4GHz and 802.11 b/g/n bands. 5GHz is not supported.
- The device is powered on.

1. Download the Tuya Smart app from the App Store (iOS devices) or Google Play (Android devices).



2. Turn on the Bluetooth on your smartphone.

3. Open the app, tap the "+" icon in the top right corner ---choose Auto Scan, and the device will automatically appear in the scan list.

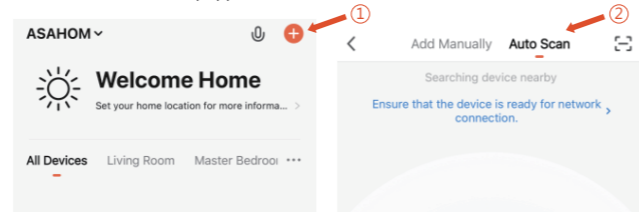

4. Tap the device icon and follow the on-screen instructions to complete pairing.

Troubleshooting

1. APP can't scan the device

- Ensure the string lights are powered on.
- Confirm Bluetooth on your smartphone is enabled.
- Position your smartphone close to the control box, then try again.
- If it still fails to scan, plug and unplug the power supply 5 times, the light starts to flash and try again.

2. Can't connect to WiFi

- Confirm your home WiFi is 2.4GHz and you entered the correct password during the connection.
- Position your smartphone close to the control box
- Plug and unplug the power supply 5 times, re-add the device after the light starts to flash

3. Some of the bulbs do not work.

- Unplug the adapter, then plug it in again.
- If the problem persists, please contact Customer Service.

Specifications

Input (Adapter) AC 100-240V 50 / 60Hz 0.8A MAX

Output (Adapter) DC 12V,1A

Length 50ft / 15.2m

Color RGB

Number of Bulbs 25

Water Resistance IP65 (String Lights) / IPX0 (Adapter)

Working Temperature -20 + 50°C / -4 + 122°F

FCC and ISED Canada Statement

This device complies with Part 15 of the FCC Rules and Industry Canada licence-exempt RSS standard(s). Operation is subject to the following two conditions:

- (1) This device may not cause harmful interference, and
- (2) This device must accept any interference received, including interference that may cause undesired operation.

Warning: Changes or modifications not expressly approved by the party responsible for compliance could void the user's authority to operate the equipment.

Le présent appareil est conforme aux CNR d'industrie Canada applicables aux appareils radio exempts de licence. L'exploitation est autorisée aux deux conditions suivantes :

- (1) l'appareil n' doit pas produire de brouillage, et
- (2) l'utilisateur de l'appareil doit accepter tout brouillage radioélectrique subi, même si le brouillage est susceptible d'en compromettre le fonctionnement."

NOTE: This equipment has been tested and found to comply with the limits for a Class B digital device, pursuant to Part 15 of the FCC Rules.

These limits are designed to provide reasonable protection against harmful interference in a residential installation. This equipment generates uses and can radiate radio frequency energy and, if not installed and used in accordance with the instructions, may cause harmful interference to radio communications. However, there is no guarantee that interference will not occur in a particular installation. If this equipment does cause harmful interference to radio or television reception, which can be determined by turning the equipment off and on, the user is encouraged to try to correct the interference by one or more of the following measures:

- 1.Reorient or relocate the receiving antenna.
- 2.Increase the separation between the equipment and receiver.
- 3.Connect the equipment into an outlet on a circuit different from that to which the receiver is connected.
- 4.Consult the dealer or an experienced radio/TV technician for help.

FCC and IC Radiation Exposure Statement

This equipment complies with FCC and IC radiation exposure limits set forth for an uncontrolled environment This equipment should be installed and operated with minimum distance 20cm between the radiator & your body.

The light source of this luminaire is not replaceable; when the light source reaches its end of life the whole luminaire shall be replaced.

Not intended for illumination. Only used for creating ambiance.