



## SMART FLOOD LIGHT INSTALLATION INSTRUCTIONS

SAVE THESE INSTRUCTIONS

INCLUDES: 2 Smart Flood Lights & Installation Instructions

### SMART FLOOD LIGHT INSTALLATION

#### WARNING

1. Make sure to cut off power before installation.
2. Please do not place this light in corrosive conditions.
3. If there is any damage to the cord, please cut off the power and stop using the fixture immediately.
4. To ensure the light works properly, please use the voltage indicated on the packaging.

### PRODUCT SPECIFICATIONS

MODEL	GKOFD20W120VB-RGBW-WB
WATTAGE	20W
INPUT VOLTAGE	120VAC
FREQUENCY	60Hz
ILLUMINATION	Max. 2000 Lumens, Dimmable
COLOR	RGB, Cool White, Warm White
COLOR INDEX	Ra>80
BEAM ANGLE	120°
WATERPROOF	IP65
WORKING TEMPERATURE	-4°F to 104°F (-20°C to 40°C)
SMART CONTROL	WIFI & Bluetooth

### SURFACE MOUNTING

1. Before installation, ensure that the wire and plug of the smart flood light are in good condition and without damage.
2. Use two stainless steel M6 expansion bolts (not included) to mount the flood light bracket to the selected surface, as shown in Figure 1 & Figure 2.
3. Adjust the direction of the flood light up or down as needed, then plug into an outlet to power on the fixture.

### IMPORTANT INSTALLATION NOTICE

1. When installing, make sure the distance between the flood light and any other objects is a minimum of 3 ft. to ensure effective heat dissipation.
2. Though the smart flood light is waterproof for outdoor use and will function in the rain, it is not suitable to be used underwater.

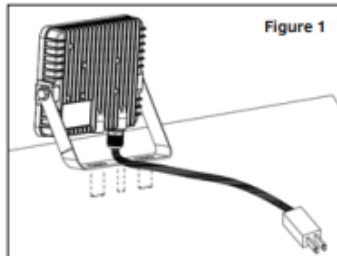

Figure 1

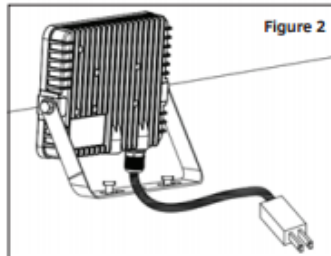

Figure 2

#### SMART FLOOD LIGHT SETUP

1. Make sure to turn on Bluetooth on your mobile phone, and connect your mobile phone to WiFi Internet (2.4GHz).
2. Download the Smart Life app to your mobile phone and install the app. To download the Smart Life app, you may search the keyword "Smart Life" in the Apple Store or on Google Play, or scan the QR code below:



3. Create an account on Smart Life and login. Make sure to remember your account and password for Alexa or Google Assistant app pairing later.
4. Add the smart flood light to the Smart Life app.
  - a. Login and stay at the home page.



- b. Power on the smart flood light using your power switch. The light will start blinking after 5 seconds automatically, and the device will show up on the app page. Tap the "Go to add" button and enter the WiFi password to complete the pairing.  
If the light doesn't blink, please repeatedly press **on-off-on-off-on-off-on** on the smart flood light to activate the blinking mode on the light, making sure to maintain an interval of 1-2 seconds between each **on** and **off**.

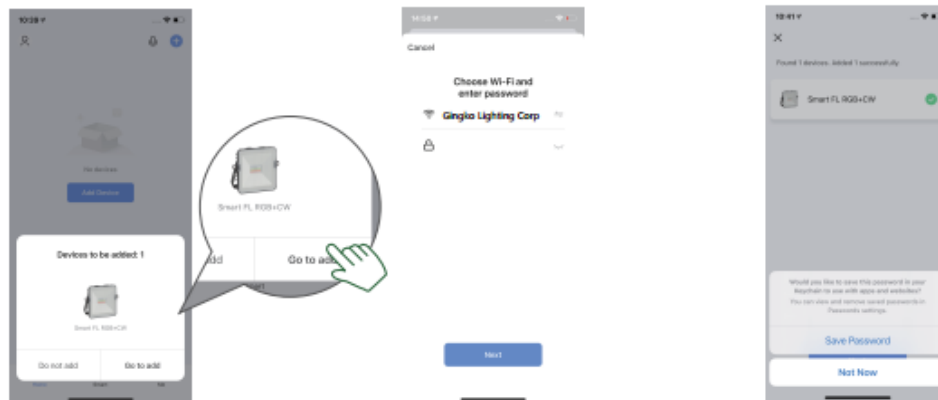

c. Tap "Next" to give a name to the smart flood light, and tap "Save". A simple, easy-to-remember name is recommended.

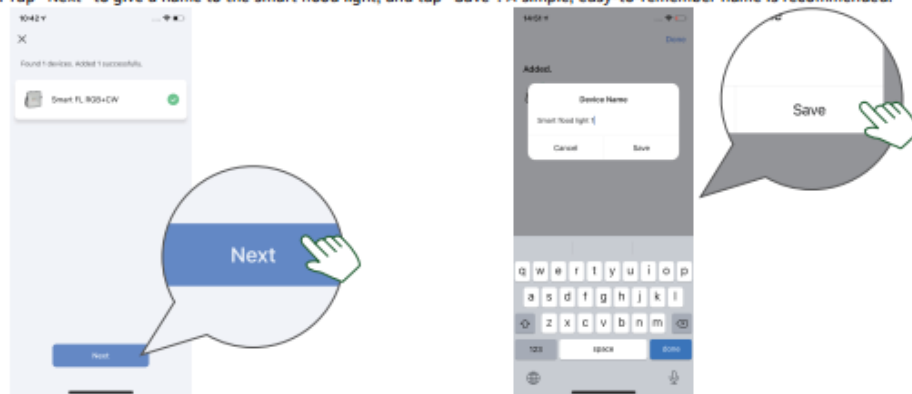

d. The named light will be shown on the homepage of the Smart Life app. Now you can control the smart flood light with the Smart Life app, using multiple light settings such as: "On/Off", "Adjust Brightness", "Change Colors", etc.

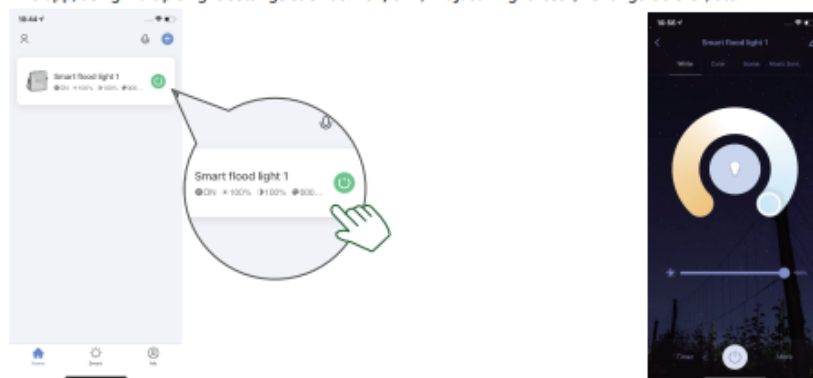

#### GROUP THE SMART FLOOD LIGHT

After all the smart flood lights have been paired to the Smart Life app, you may group the lights for easy control by following these steps:

1. Choose any light on the Smart Life app, tap the "Edit" button in the top right corner, then tap "Create Group".

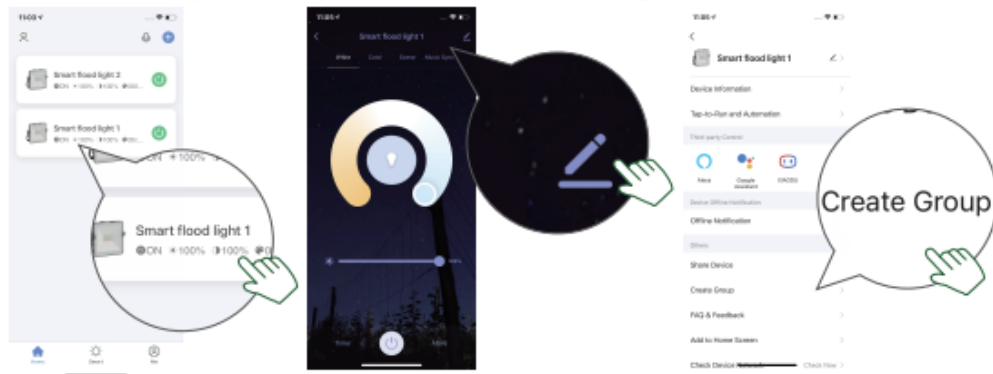

2. Choose the lights you want to group from the device list, tap “Save” and name the group, tap “Save” again to complete setup.

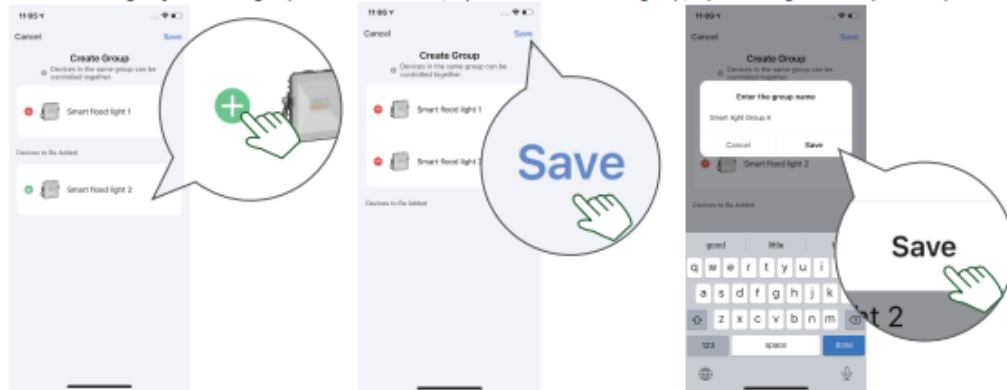

3. The named group will be shown on the homepage of the Smart Life app. Now you can control the group with the Smart Life app, using multiple light settings such as: “On/Off”, “Adjust Brightness”, “Change Colors”, etc.

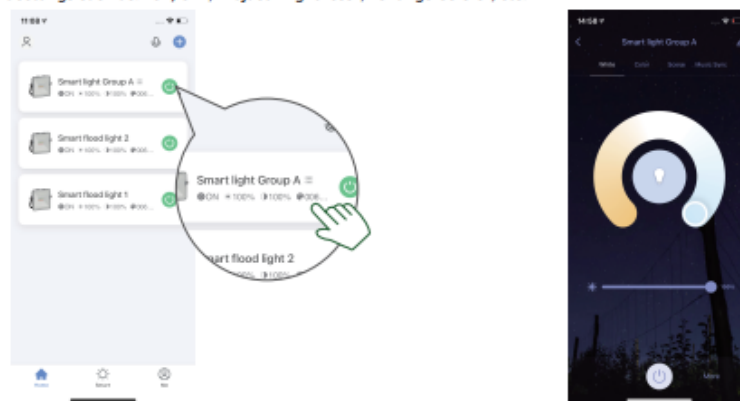

#### TROUBLESHOOTING

If the smart flood light has disconnected from the Smart Life app, do the following:

1. Check that the 2.4GHz WiFi signal is available.
2. Make sure to turn on Bluetooth on your mobile phone and connect your mobile phone to WiFi.
3. Check that the WiFi password is correct on the Smart Life app.
4. Follow **SMART FLOOD LIGHT SETUP** procedures above to pair the Smart Flood Light.
5. Feel free to contact our customer service [info@kkoled.com](mailto:info@kkoled.com) or 630-793-9449 (7:30-16:00 CST, M-F) if you have any further problems.

## FCC statement

This device complies with Part 15 of the FCC rules. Operation is subject to the following two conditions:

- 1) This device may not cause interference.
- 2) This device must accept any interference, including interference that may cause undesired operation of the device.

Note: This equipment has been tested and found to comply with the limits for a Class B digital device, pursuant to part 15 of the FCC Rules. These limits are designed to provide reasonable protection against harmful interference in a residential installation. This equipment generates uses and can radiate radio frequency energy and, if not installed and used in accordance with the instructions, may cause harmful interference to radio communications. However, there is no guarantee that interference will not occur in particular installation. If this equipment does cause harmful interference to radio or television reception, which can be determined by turning the equipment off and on, the user is encouraged to try to correct the interference by one or more of the following measures:

- Reorient or relocate the receiving antenna.
- Increase the separation between the equipment and receiver.
- Connect the equipment into an outlet on a circuit different from that to which the receiver is connected.
- Consult the dealer or an experienced radio/TV technician for help.

Changes or modifications not expressly approved by the party responsible for compliance could void the user's authority to operate the equipment.

### FCC Radiation Exposure Statement

This device complies with FCC RF radiation exposure limits set forth for an uncontrolled environment. This transmitter must not be co-located or operating in conjunction with any other antenna or transmitter.