

Wireless Bluetooth headset manual

Product model : SK18



SK18

Functional operation diagram

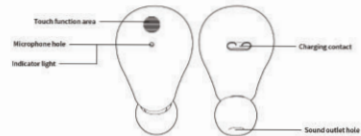

Type-C充电接口

Headset function operation instructions

1. Power on: Long press the function key for 3 seconds
2. Shutdown: Long press the function key for 6 seconds
3. Answer/end: Click the function key
4. Reject incoming calls: Hold down the multifunction key for 1.5 seconds
5. Pause/Play: Double click the function key
6. Previous song: Three click function key (random)
7. Next song: Three click function key (random)
8. Volume+: Long press the function key for 1.5 seconds (random) to increase the volume by one grid
9. Volume -: Press and hold the function key for 1.5 seconds (random) to decrease the volume by one grid
10. Game mode: Four click function key (random) to switch game mode/music mode
11. Voice Assistant: Activate Siri with four click function keys (random)
12. Restore factory settings: Five click function key (clear pairing record) to operate without connecting the phone

Headset connection pairing operation

When the headset charging compartment is taken out, it will start automatically, and the red and blue lights will flash alternately to start the device search. As shown in the following figure

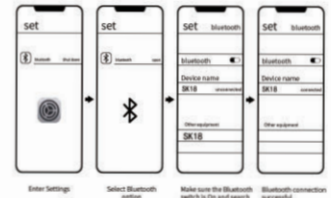

Charging state indication

1. 100% of the charging chamber's power display 0.00 indicates low power display and charging is required
2. When charging the charging box, the display screen displays 100% specific power, and when fully charged, it displays 100%
3. When the charging chamber charges the headset, Headphone light red, bin blue light shining
4. When the headset is low, the prompt (Beep) indicates low power prompt.

Functional use	Communication Bluetooth headset, music Bluetooth headset, binaural call
Frequency Response	20HZ-20KHZ
impedance	320=15%
sensitivity	103 + 3dB AtW000Hz AtQ 126V
Bluetooth receiving distance	≥ 15m (under standard environment)
Bluetooth version	BLUETOOTH 5. three
Transmission range	2400. 0- 2483.5NHz
Support agreement	HSP/HFP/ADP/SBC/ ACC/ AVRCP
Transmission frequency	2.4GHZ-2.483 5GHZ 5Mband
Headset charging time	30 minutes (headphones), about 1 hour (charging cabin)
Playback time	5-6hours (60% volume)
Talk time	4-5H (60% volume)
Endurance time	Talk duration when Bluetooth headset and mobile phone are connected; About 5-6 hours (binaural call); length of call in connected state; It can run the earphones three times
Charging voltage / current	
Product working temperature	-10-50, C Rated input of earphone: dc5v=20ma
product storage temperature	-20-55° C Rated input of charging chamber: dc5v= 300mA

Product safety information

- Please read all instructions and warnings before using this product. Improper use will damage the product or personal safety.
1. The product contains batteries. Do not expose the product to strong sunlight or overheated environments such as heaters. Do not store this product at high temperature.
 - Under strong light and strong magnetic field.
 2. The product cannot be placed near the fire source and other harsh environments. It is forbidden to knock, throw, trample, squeeze or throw into the fire. If there is swelling, do not use it.
 3. Ambient temperature of the product: 0-45 ° C.
 4. Do not use the product inappropriately in violation of the product instructions, causing damage to the product or endangering the safety of personal and property, and bear the consequences.
 5. Non professional personnel are strictly forbidden to disassemble this product, otherwise it may cause fire, or even completely damage this product.
 6. Do not use loads (electrical appliances) that exceed the output current of this product. If the load is exceeded, it will automatically stop working.
 7. Please use clean cotton cloth to clean the headphone charging contact regularly. To avoid the situation that the headset cannot be charged or turned on due to long-term uncleanness.
 8. Do not put this product in water (or washing machine). If the product has water ingress, please wait for it to dry naturally before using it.

▪ **FCC Statement**

This equipment has been tested and found to comply with the limits for a Class B digital device, pursuant to part 15 of the FCC rules. These limits are designed to provide reasonable protection against harmful interference in a residential installation.

This equipment generates, uses and can radiate radio frequency energy and, if not installed and used in accordance with the instructions, may cause harmful interference to radio communications. However, there is no guarantee that interference will not occur in a particular installation. If this equipment does cause harmful interference to radio or television reception, which can be determined by turning the equipment off and on, the user is encouraged to try to correct the interference by one or more of the following measures:

- Reorient or relocate the receiving antenna.
- Increase the separation between the equipment and receiver.
- Connect the equipment into an outlet on a circuit different from that to which the receiver is connected.
- Consult the dealer or an experienced radio/TV technician for help.

To assure continued compliance, any changes or modifications not expressly approved by the party

Responsible for compliance could void the user's authority to operate this equipment. (Example- use only shielded interface cables when connecting to computer or peripheral devices).

This equipment complies with Part 15 of the FCC Rules. Operation is subject to the following two conditions:

- (1) This device may not cause harmful interference, and
- (2) This device must accept any interference received, including interference that may cause undesired operation.

†

RF warning statement:

The device has been evaluated to meet general RF exposure requirement.

The device can be used in portable exposure condition without restriction.