

Bluetooth Alarm Clock Wireless Camera

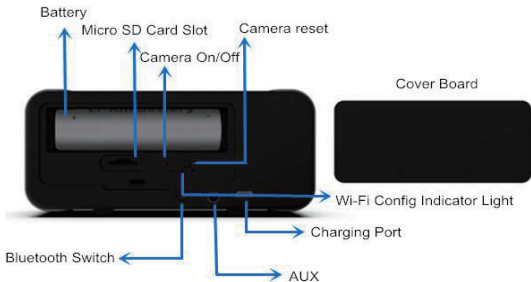

This product is placed on the desktop

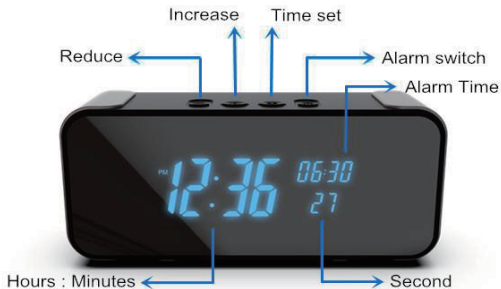

Quick Guide For APP Installation

For iOS Devices:

- Scan below QR Code for iOS operating system to download and install “Camama” APP with iPhone or iPad devices.
- Search “Camama” in App Store with your iOS devices, download and install App.

For Android Devices:

- Scan below QR Code for Android operating system to download and install “Camama” App with Mobile or tablet devices.
- Search “Camama” in Google Play with your iOS devices, download and install App.



iOS Device QR Code



Android Device QR Code

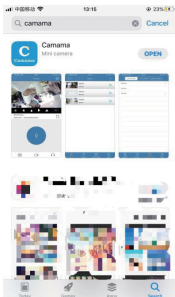

1. Adding New Camera Device

- A. Connected the power supply and turn on the device by ON/OFF switch. The green light will flashing and the camera are waiting to be connected.
- B. Enter your phone “settings”-> choose “WLAN”-> find the camera’s hot-spot signal (the name of the signal is “Camama_XXXXX”),connects the camera’s hot spots.

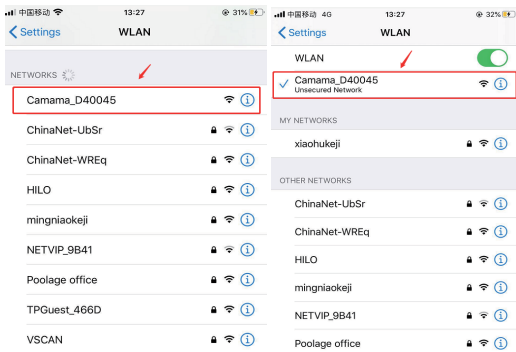

Important Note!

If you can not find the camera’s hot-spot signal, please reboot the device by press the reset button about 5s until listening a sound of “Ding”, after that, the hot spot signal will come up again and you can connect it for next steps.

C. Load the APP (Camama) and click the button  to add new device->choose "Search in LAN"->Click the device ID and Saved. After this step Finished, the camera has been added to the App and you can watch the video via hot spots at distance of 10-15m range(Point-Point Mode).

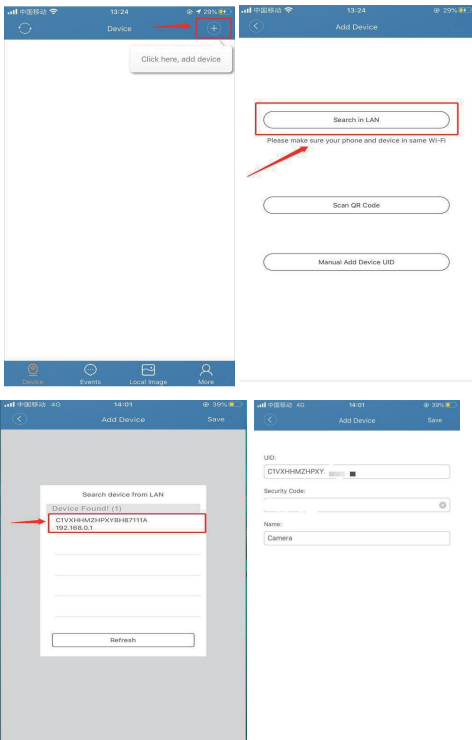

Please noted: On the above step, some of iPhone user can't find the device, how to resolve it?

If you're using IOS14.0 or above, when you connect the device at the first time, please shut-off the cellular data of your phone, then go back to app and refresh it, then you'll find the device come up, after connection was done, you can turn on the cellular data of your phone.

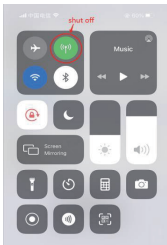

2. WIFI Setting For Remote Control (Remote Mode)

Click the setting button->Choose the "WIFI Setting"->Click the" Manage Wi-Fi networks" and choose your home wifi and input your passwords, then click the OK button. Waiting for about 5~10 second. when it shows "online" again, it means the wifi setting is successful.

After this step was done, the second green light will not flashing, it means the camera has been connected to router successfully, then you can watch your home and access the live feed at any anytime from anywhere by your mobile phone (Remote Control)

Note:

1.After input your wifi passwords and config the connection, the device will restart automatically and wait for the camera to restart, which will be completed in about 20-40 seconds. During the connection process, please do not shut-off the device manually.

2.When connecting to WiFi, please make sure input the correct WiFi password. If the passwords is wrong, the camera will be offline, then you need to reboot the device and re-pair it.

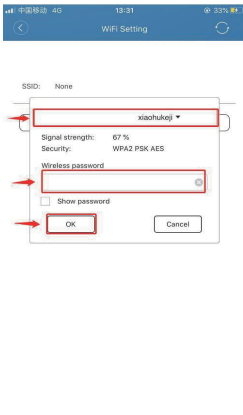
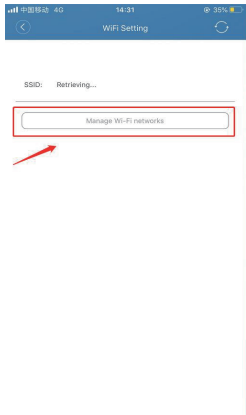
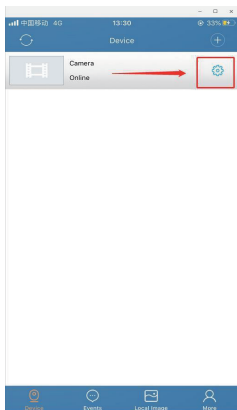

3. Live Feed and Remote Viewing

(Live Stream and Remote 7/24 Monitoring from anywhere)

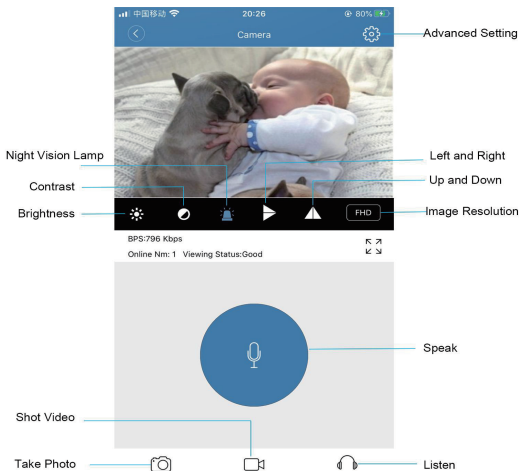

4. Motion Detection Settings

Click the setting button->Choose the “Alarm Setting” to set motion detection.

You can active the motion mode here and choose the levels of motion detection. It has 4 levels of motion(Low, Medium, High, Max)

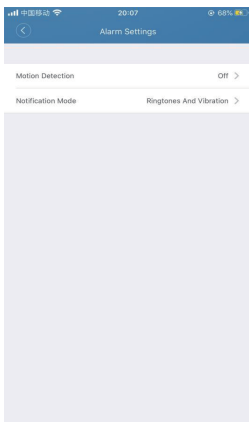
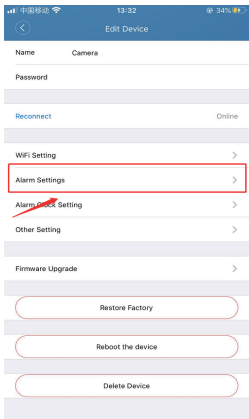

5. SD Card Recording Settings

Click the setting button->Choose the “Other Setting” to setting SD Card. You can active the SD card recording while insert a Micro SD card, you’re able to choose the 3 recording modes (Full time recording, Alarm recording and Timing Record)

Notes:

This camera support both recording with/without SD card.

- A. If without SD card, it shoot videos and saved to your mobile phone.
- B. If with SD card, the device recording automatically and save the videos to SD card, and it also saved the recordings to your mobile phone as well.

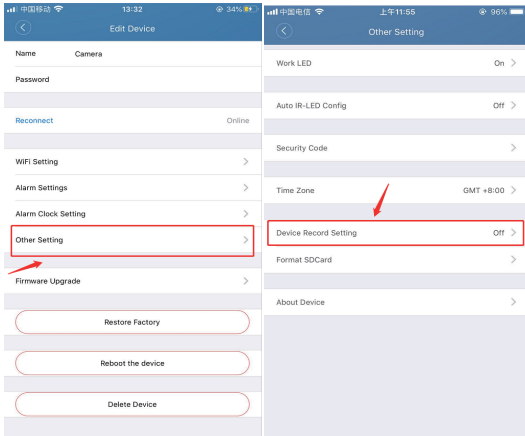

6. Camera Related Parameters

Resolution Ratio	4K/2K/1080P
Video Format	AVI
Frame Number	30
Visual Angle	120 degree
Motion Detection Camera Shooting	Straight line 6 meters
Compressed Format	H.264
Night Version	5~8M
Recording Range	20 m ²
Consumption	2A/5V
Storage Temperature	-20-80 degree centigrade
Operating Temperature	-10-60 degree centigrade
Operation Humidity	15-85%RH
Memory Card Type	TF card
Player Software	Mainstream player
Mobile Phone Operating System	Android/iOS

7. Bluetooth Speaker Using

Long press the Bluetooth switch to turn on/off the clock Bluetooth. Enter the Bluetooth setting on your phone, search and find the device's bluetooth name "**Amzcev**" and connected it, then you can enjoy great music by this bluetooth speaker, the bluetooth distance is about 10-15m. (PS:You could control the voice by your phone or media player)

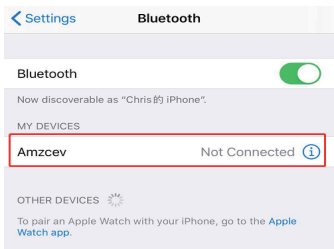

8. Clock Setting

1. Setting alarm: Long press the alarm switch button to turn on/off. When the alarm turn on, press the alarm switch button one time to set the hour, press two times to set the minute. Press the "+" or "-" button to set the time.
When the alarm goes off, the clock will make a drip sound for 60 seconds. Press any button to turn off the sound.
2. Setting time: Press the "M" button one time to setting the hour, Press the "M" button two times to setting the minute. Press the "+" or "-" button to set the time.
3. Long press the "M" button to turn off the time display, and long press it again to turn on the time display.
4. Setting the hour system: Press the "+" button one time to choose 24-hour system or 12-hour system. When you choose 12-hour system, the clock would show the AM/PM sign.

9. Frequently Question & Answers

What can i do if the camera offline, shut-down or it cannot working?

Please reboot the device to factory settings, then connect the hot-spot signal and do the Wi-Fi configuration again.

What kind of micro SD card is required for recording?

The camera supports 8G-128GB micro SD card. Please use high speed class 10 FAT formatted memory card.

Why can't use my micro SD Card for recording?

You should format the micro SD through the App before using. If SD card is not recognized, just remove the card and re-insert it.

Why can't the camera go online?

- 1.No power connect
- 2.Check if your router is working properly or not .
- 3.Weak WiFi signal
- 4.Wrong password while WiFi setting.

Why is remote monitoring not smooth ?

You should choose a suitable resolution to watch according to your internet speed.

Why I can't save to my SD card ?

Please make sure you have turn-on the SD card recording function in App, and the SD card must be formatted at the first time to use it.

If i forgot my password ?

Press the reboot button for 5s to restore the device to factory setting, then you have to re-connect the wifi and can set the new passwords.

Reminder:

The initial password for the camera is 123456. Please change your own passwords to ensure the security of your camera

If you have any question for using this product, please E-mail to us:

FCC WARNING

This device complies with part 15 of the FCC Rules. Operation is subject to the following two conditions:

- (1) this device may not cause harmful interference, and
- (2) this device must accept any interference received, including interference that may cause

undesired operation. Any changes or modifications not expressly approved by the party responsible for compliance could void the user's authority to operate the equipment.

NOTE: This equipment has been tested and found to comply with the limits for a Class B digital device, pursuant to Part 15 of the FCC Rules. These limits are designed to provide reasonable protection against harmful interference in a residential installation. This equipment generates, uses and can radiate radio frequency energy and, if not installed and used in accordance with the instructions, may cause harmful interference to radio communications.

However, there is no guarantee that interference will not occur in a particular installation. If this equipment does cause harmful interference to radio or television reception, which can be determined by turning the equipment off and on, the user is encouraged to try to correct the interference by one or more of the following measures:

- Reorient or relocate the receiving antenna.
- Increase the separation between the equipment and receiver.
- Connect the equipment into an outlet on a circuit different from that to which the receiver is connected.
- Consult the dealer or an experienced radio/TV technician for help.

To maintain compliance with FCC's RF Exposure guidelines, This equipment should be installed and operated with minimum distance between 20cm the radiator your body: Use only the supplied antenna.