

PN-W36

尺寸: 70 * 105mm

105克铜版纸 折页

彩色双面印刷

风琴折

BLAVOR

1000 mAh

Portable Apple Watch Charger

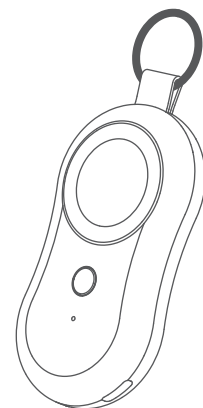

PN-W36
User Manual

Thank you for choosing BLAVOR product. In order to provide a better user experience, we have provided detailed information about the product and instructions for use. Please read the instructions carefully before using this product to use it correctly.

1. Product Details

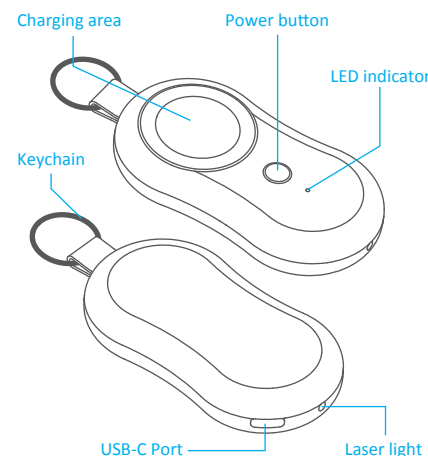

2. Product Parameters

USB-C Input	DC5V/1A
Wireless Charging Output	2.5W
Battery Capacity	1000mAh/3.7V

3. Product Features

- Exclusive design, fashionable and beautiful.
- High-quality polymer batteries, safe and stable, charging anytime and anywhere.
- Using the original magnetic module, compatible with all models of Apple Watch.
- Strong magnetic charging and portable design, perfectly absorbing the watch to charge.
- Built-in infrared laser light, which can play with pets, point objects at a long distance, and point directions outdoors.

4. Package Includes

- Portable Watch Charger X2
- USB-C Cable X1
- User Manual X1

5. Instructions:

1) Turn on/off

Press the power button to turn on the charger, the indicator light is on, and if there is no charging device connected, it will automatically shut down after 10 minutes, or you can press the button twice to shut it down.

2) Recharge the battery

Plug into the USB-C charging cable, the LED indicator flashes red when charging, and keeps bright when fully charged.

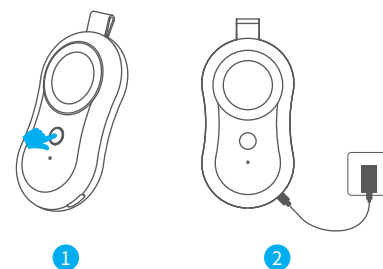

3) Watch wireless charging

Press the power button, the blue indicator light is on. Put the watch in the wireless charging area and the watch will be absorbed and charged automatically.

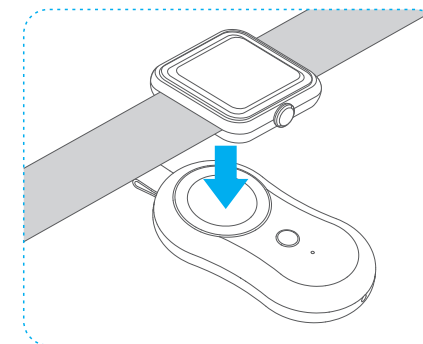

4) Funny cat laser light

Press and hold the button for about 3 seconds to turn on/off the laser light.

6. Warning

- Keep away from moisture and corrosive substances.
- Do not use chemicals to clean this product.
- When the product is not used for a long time, please charge it every three months.
- This product is suitable for charging equipment within the specification of DC5V/3A. If the charging equipment exceeds this specification, it may cause damage to the product.
- Please do not disassemble or modify this product.
- Please pay attention to fire prevention, moisture-proof, to prevent malfunction.
- Do not use this product in a high temperature environment ($\geq 45^{\circ}\text{C}$).
- Please connect devices that meet the output specifications of this product.
- If the battery swells, leaks or emits a strange smell, please stop using it immediately.
- The built-in laser light of this product cannot directly shine on the eyes of people or animals, otherwise it may cause damage to the eyes.

7. Warranty & After-Sales Service

- Each BLAVOR product provides a 12-month warranty from the date of purchase.
- Products that are well packaged and undamaged can be returned for a full refund within 30 days from the date of purchase. Please note that if the product has no quality problems, the customer will bear the freight.
- Free replacement of products with quality problems within 12 months
- If you are not 100% satisfied with our products, please feel free to contact our customer service at support@blavor.com. We take customer feedback very seriously and will reply you within 24 hours



Please contact our after-sales
Service department at
support@blavor.com

FCC Statement

Changes or modifications not expressly approved by the party responsible for compliance could void the user authority to operate the product. NOTE: This equipment has been tested and found to comply with the limits for a wireless power charger, pursuant to Part 18 of the FCC Rules. These limits are designed to provide reasonable protection against harmful interference in a residential installation. This equipment generates, uses and can radiate radio frequency energy and, if not installed and used in accordance with the instructions, may cause harmful interference to radio communications. However, there is no guarantee that interference will not occur in a particular installation. If this equipment does cause harmful interference to radio or television reception, which can be determined by turning the equipment on and off, the user is encouraged to try to correct the interference by one or more of the following measures:
-Reorient or relocate the receiving antenna.
-Increase the separation between the equipment and receiver. -Connect the equipment into an outlet on a circuit different from that to which the receiver is connected.
-Consult the dealer or an experienced radio/TV technician for help.