

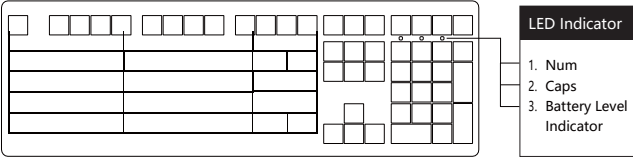

MX108 Wireless Keyboard & Mouse Combo User Manual

Quick Guide ▶

Packing List



System Requirement

Windows®XP / Vista / 7 / 8 / 10 or higher version

Connectivity Method

Turn the keyboard power switch to the ON position and insert the USB receiver into an available USB port to complete the 2.4G connection and start using it.

Independent Indicator

Status	Indicator Position	LED Indicator
Num	LED Indicator 1	Steady white
Caps	LED Indicator 2	Steady white
Low Battery	LED Indicator 3	Slow flashing white LED
Charging		Steady red
Fully Charged		Steady red → Light off

MX108 HotKeys

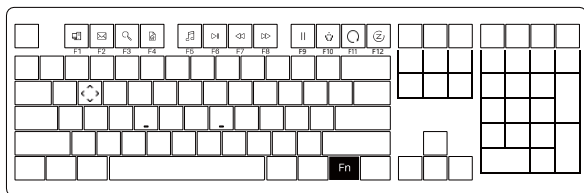

Fn+	F1	My computer
	F2	E-mail
	F3	= Windows search
	F4	Browser homepage
	F5	Multimedia player

Fn+	F6	Play/Pause
	F7	Previous song
	F8	= Next song
	F9	Stop
	F10	Bookmark

Fn+	F11	Refresh
	F12	One-Key Hibernate
	W	= Swap W A S D with ↑ ↓ ← →

MX108 System Commands (Mac)

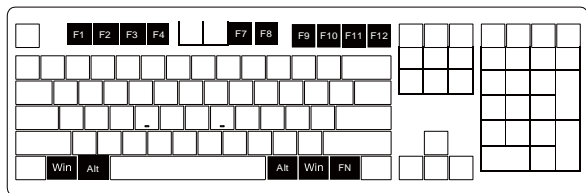

F1	Decrease display brightness
F2	Increase display brightness
F3	Open mission control
F4	Activate Siri

F7	Skip back (Audio)
F8	Pause/Play (Audio)
F9	Skip forward (Audio)
F10	Mute

F11	Volume down
F12	Volume up
Left Win	Option
Left Alt	Command

Right Alt	Command
Right Win	Option

Fn + (F1 ~ F12)
F1 ~ F12

MX108 Bluetooth + 2.4G Wireless Mouse Overview

Specifcations

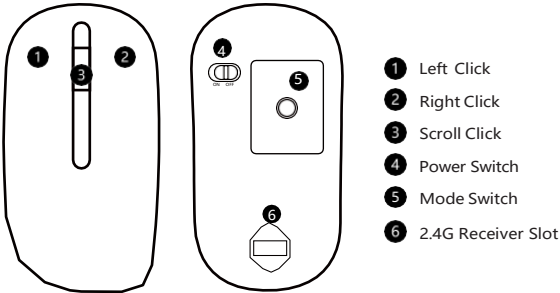

Model	MX108	Mode	BT + 2.4G Wireless
Length	114mm	Voltage	Built-in lithium battery: 3.7V/300mAH
Width	33mm	Charge	USB 5.0V
Height	60mm	Polling Rate	Bluetooth: 133Hz 2.4G: 125Hz
Weight	≈84g	Wireless Distance	10m 360°
LED Indicator	Red	DPI	Default 1200
Mode Switch	Short press to switch to 2.4G mode. (The indicator light will be green) Short press again to switch to Bluetooth mode. (The indicator light will be blue)	2.4G Pairing	Press left and right clicks to power on. (The green indicator flashes quickly)
		Bluetooth Pairing	Press and hold the pairing button for 3 seconds to enter pairing mode. (Pairing duration is 2 minutes)
Operating Systems	WIN2000/Win7/Win8/Win10/ Android/IOS/Mac	Key Functions	* Left/Right click * Power switch/Mode switch * Scroll click

Akko Warranty and Service Statement

1. Akko offers a One-Year warranty for customers in mainland China. For other regions, please contact your seller (Akko distributor) for specific warranty details.
2. If the warranty period expires, customers are responsible for repair costs. Akko provides instructions for self-repair if preferred, but users assume full responsibility for any losses incurred during the process.
3. Disassembling the keyboard and mouse without manufacturer/seller's instruction will void the warranty immediately.
4. Return and warranty policies may vary across platforms and are subject to the specific distributor's terms at the time of purchase.

Company: Shenzhen Yinchon Technology Co., Ltd

Address: 33 Langbi Rd, Bitou Community 1st Industrial Zone, Bao'an District, Shenzhen, China

Tel: 0755-23216420

Website: en.akkogear.com

Origin: Shenzhen, China



WARNING:

Water and Beverages can't be poured into the Keyboard.



中国制造/Made in China



[instagram.com/akkogear](https://www.instagram.com/akkogear)



[facebook.com/akkogear](https://www.facebook.com/akkogear)



[tiktok.com/@akkogear](https://www.tiktok.com/@akkogear)

Precautions

Man-made damage is not limited to immersion, falling off, and pulling off the wires with excessive forces, etc.

FCC STATEMENT :

This device complies with Part 15 of the FCC Rules. Operation is subject to the following two conditions:

This device may not cause harmful interference, and

This device must accept any interference received, including interference that may cause undesired operation.

Warning: Changes or modifications not expressly approved by the party responsible for compliance could void the user's authority to operate the equipment.

NOTE: This equipment has been tested and found to comply with the limits for a Class B digital device, pursuant to Part 15 of the FCC Rules. These limits are designed to provide reasonable protection against harmful interference in a residential installation. This equipment generates uses and can radiate radio frequency energy and, if not installed and used in accordance with the instructions, may cause harmful interference to radio communications. However, there is no guarantee that interference will not occur in a particular installation. If this equipment does cause harmful interference to radio or television reception, which can be determined by turning the equipment off and on, the user is encouraged to try to correct the interference by one or more of the following measures:

Reorient or relocate the receiving antenna.

Increase the separation between the equipment and receiver.

Connect the equipment into an outlet on a circuit different from that to which the receiver is connected.

Consult the dealer or an experienced radio/TV technician for help.

RF warning statement:

The device has been evaluated to meet general RF exposure requirement. The device can be used in portable exposure condition without restriction.



www.akkogear.com

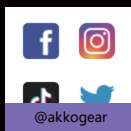

扫描关注官方微信



扫描关注官方微博