

Contact: support@thechefrobot.com

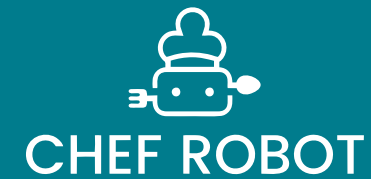

Chef Robot

CR-7 User Manual

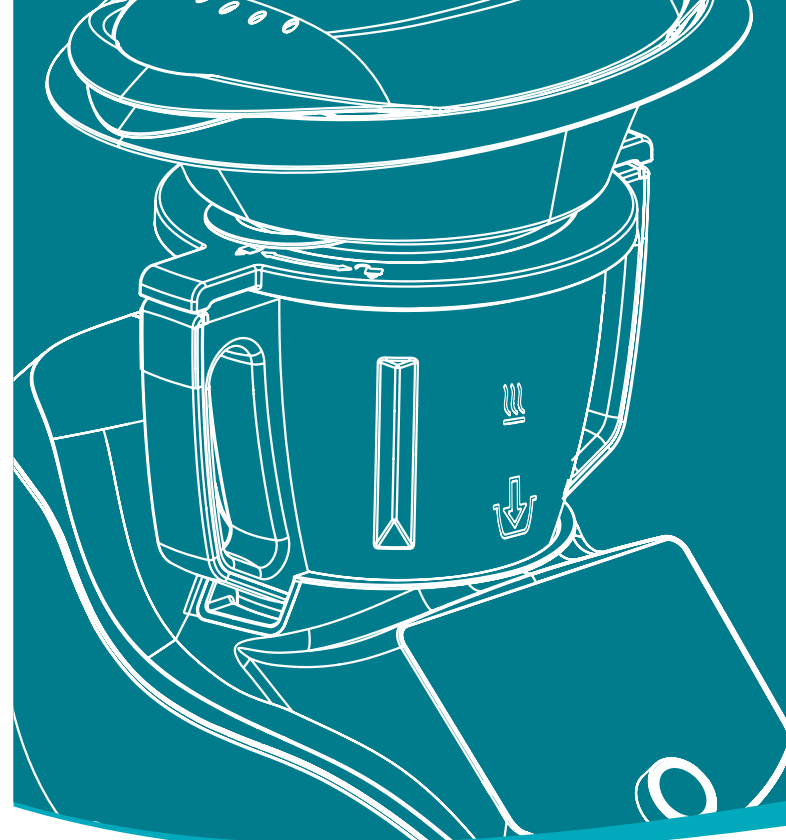
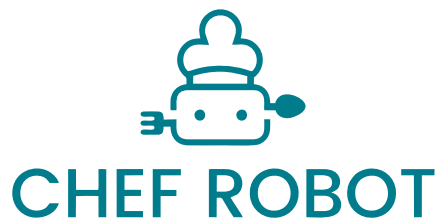

Table of Contents

1.0 Safety Precautions	01-05
2.0 About Your Chef Robot	
2.1 Chef Robot Overview	06
2.2 Knob Instructions	07
2.3 LED & Button Guidelines.....	07
2.4 Switch On/Off	08
2.5 Main functions	09
3.0 Use of Chef Robot	
3.1 Mixing Bowl & Blade	10-13
3.2 Steamer	14
3.3 Basket	15
3.4 Measuring Cup	16
3.5 Spatula	16
3.6 Butterfly	17
4.0 Icons and User Interface	
4.1 Main Icons	18
4.2 Main User Interface	19
4.2.1 Opening Screen	19
4.2.2 Safety Guide	20
4.2.3 Home	21
4.2.3.1 Setting the Cooking Time	22
4.2.3.2 Setting the Temperature	23
Special Functions Description	
(1) Slowcook.....	23
(2) Aicook	23
(3) Steam	23
4.2.3.3 Setting the Rotational Speed	24
Special Functions Description	
(1) Speed	24
(2) Reversal	24
4.2.3.4 Scale.....	25-26
4.2.4 Quick Functions Screen	27
4.2.5 Recipes Screen	28-30
4.2.6 Search Screen	31
4.2.7 Main Settings Screen	32
4.2.7.1 Settings	33
Special Functions	
(1) Sleep Mode	34
(2) Version Upgrade.....	35
(3) Restore Factory Set	36
4.2.7.2 APP/Pair account	37-40
4.2.7.3 Operation Guide	41
4.2.7.4 Basic Information	42
5.0 Troubleshooting	43
6.0 Cleaning & Maintenance	
6.1 Cleaning the Main Unit.....	44
6.2 Cleaning Mode	44
6.3 Cleaning the Mixing Bowl	45
6.4 Cleaning the Mixing Blade	45
6.5 Cleaning other accessories	46
6.6 Storage & Maintenances.....	46
7.0 Grounding Instructions	47
8.0 Specifications	47
9.0 Certifications	47
10.0 Disposal	47

1.0 Safety Precautions

Safety Warnings

Please pay close attention wherever you see the terms **Danger**, **Caution**, **Care** or **Attention** in this manual.

! Danger Danger: Wrong or incorrect use of Chef Robot here could be dangerous and lead to personal injury or even death.

! Caution Danger: Wrong or incorrect use of Chef Robot here could be dangerous and lead to personal injury or even death.

! Care Danger: Wrong or incorrect use of Chef Robot here could lead to personal injury.

! Attention These are useful tips for using Chef Robot. Using or not using will not affect your personal safety.



Read these instructions carefully before operating this product

! Caution

Prevent electric shock

- This product is equipped with grounding protection. Please use it only in homes or buildings that are properly grounded.
- Be sure Chef Robot is switched off when cleaning or removing the parts and when not using the machine.
- Never immerse, soak, or rinse the machine itself. Clean the main body of Chef Robot only by wiping it with a damp cloth. Keep water and dirt outside the Chef Robot housing.
- Stop operating the machine if the power cord, plug, or other parts of the product are damaged, or if Chef Robot malfunctions and experiences product failure. Contact your nearest authorized service organization and send the machine for maintenance.

! Caution

Open the mixing bowl lid carefully

- Do not force open the mixing bowl lid.
- Only open the lid once the speed is set to 0 and the mixing bowl is set to the unlocked position.

! Caution

Prevent heat and pressure-related injuries

- Avoid touching or blocking the steam vents of the mixing bowl lid when Chef Robot is operating. When it is heating food, the mixing bowl can be under extreme pressure and contact with the boiling or near-boiling food can cause scalding burns.
- If the vents of the mixing bowl lid are blocked or if food is ejected from the bowl or the measuring cup during use, unplug the machine immediately and don't touch it until it has cooled down.
- Don't put an excessive amount of food into the steamer or mixing bowl. Food should not exceed the maximum line marked on the appliance.
- Don't cook food in the steamer that can easily block its vents.
- Don't cover the mixing bowl lid or the steamer during cooking.

! Caution

Prevent spills and steam-related injuries

- Avoid high temperature food spills. Such spills can cause burns either through escaping steam or through the ejection of boiling or near-boiling food during cooking.
- Be careful when moving the mixing bowl to avoid food spills.
- Chef Robot should be placed on a clean, flat, solid surface to prevent it from falling.
- When in use, keep the power cord safe and avoid entangling it in other objects.
- While heating food, don't suddenly start the Turbo function or begin high-speed rotations. This may cause hot food to spill out of the machine. Process hot food slowly at first and increase the speed gradually.
- When heating food, the mixing bowl, the mixing bowl lid, the steamer, and the measuring cup can get very hot. Don't touch these parts during cooking to avoid possible injury.
- During cooking, some operations can produce a lot of steam. Stay away from steam to avoid possible injury.
- Please be careful to avoid steam ejection from the mixing bowl, steamer, steamer rack, and the steamer lid when touching or moving those parts.

! Caution

Prevent cuts.

- The mixing blade is very sharp. Please be very careful when operating. Hold the mixing blade from the top only when installing it in or removing it from the mixing bowl.
- When holding, installing, or removing the mixing blade, please be careful to avoid accidentally falling or dropping the blade.
- Don't place your hands or any non-food items in the mixing bowl to prevent hurting yourself or damaging the mixing blade.
- Switch off the machine when either installing or removing the mixing blade.
- Make sure to keep any loose hair and clothing away from the machine while it's operating.

! Care

Avoid personal injury and machine damage.

- If any parts of the machine are damaged, stop using the machine immediately and contact your service representative or the manufacturer for replacement parts.
- Don't leave the machine unattended while it is operating.
- While kneading dough, cutting certain foods, and performing other operations, Chef Robot may rock back-and-forth slightly. Be sure **not** to place the machine on or near the edge of the countertop or table to prevent it from falling.

IMPORTANT SAFEGUARDS

When using electrical appliances, basic safety precautions should always be followed including the following:

- 1) Read all instructions.
- 2) To protect against risk of electrical shock do not put the plug, power supply cord, or the main body in water or other liquid.
- 3) This appliance is not intended for use by persons (including children) with reduced physical, sensory, or mental capabilities, or lack of experience and knowledge, unless they are closely supervised and instructed concerning use of the appliance by a person responsible for their safety. Close supervision is necessary when any appliance is used by or near children. Children should be supervised to ensure that they do not play with the appliance.
- 4) Turn the appliance OFF, then unplug from the outlet when not in use, before assembling or disassembling parts and before cleaning. To unplug, grasp the plug and pull from the outlet. Never pull from the power cord.
- 5) Do not touch moving parts. Do not attempt to defeat the cover interlock mechanism.
- 6) Do not operate any appliance with a damaged cord or plug or after the appliance malfunctions, or is dropped or damaged in any manner. Contact the manufacturer at info@thechefrobot.com for information on examination, repair, or adjustment.
- 7) The use of attachments, not recommended by the manufacturer may cause a risk of injury to persons.
- 8) Do not use outdoors.
- 9) Do not let cord hang over edge of table or counter, or touch hot surfaces.
- 10) Do not place on or near a hot gas or electric burner, or in a heated oven.
- 11) Do not touch hot surfaces. Use handles or knobs.
- 12) Keep hands and utensils out of the machine during use to reduce the risk of severe injury to persons or damage to Chef Robot. The spatula may be used but must be used only when the machine is not running.
- 13) The blade assembly is sharp. When handling the blade assembly, always handle carefully by the top. To avoid risk of injury, when pouring out the contents, be careful to grasp with two hands when pouring out food or liquid.
- 14) Always operate the machine with cover in place.
- 15) Allow to cool before assembling or disassembling parts and before cleaning the appliance.
- 16) To reduce the risk of injury, never place the mixing blade assembly on base without the bowl properly attached. Never place the mixing blade in the mixing bowl without locking it in place by rotating the latch on the underside of the mixing bowl clockwise.
- 17) Unplug from outlet when not in use and before cleaning. Allow to cool before putting on or taking off parts.
- 18) Extreme caution must be used when moving an appliance containing hot liquids.
- 19) Always attach plug to appliance first, then plug cord into the wall outlet. To disconnect, turn any control to "off", then remove plug from wall outlet.

- 20) Do not use appliance for other than intended use.
- 21) Intended for countertop use only.
WARNING: Spilled food can cause serious burns. Keep appliance and cord away from children. Never drape cord over edge of counter, never use outlet below counter, and never use with an extension cord.
- 22) Preheating of the appliance is not necessary.
- 23) If the supply cord is damaged, it must be replaced by the manufacturer, its service agent or similarly qualified persons in order to avoid a hazard.
- 24) **CAUTION:** In order to avoid a hazard due to inadvertent resetting of the thermal cut-out, this appliance must not be supplied through an external switching device, such as a timer, or connected to a circuit that is regularly switched on and off by the utility.
- 25) For household use only.
- 26) The appliance is only to be used with the stand provided.
- 27) **CAUTION:** Insure that the appliance is switched off before removing it from its stand.
- 28) **WARNING:** Be careful there no spillage on the electrical connections when operating, cleaning or other service.
- 29) There is residual heat on the heating element surface after use. Be careful not to touch the hot surface of the bowl when in use.
- 30) **CAUTION:** Do not operate without the cover in place. Extremely hot surface on the mixing bowl. Unplug before assembling or removing the mixing bowl.
- 31) **CAUTION:** Risk of electric shock, cook only in the removable mixing bowl.
- 32) **CAUTION:** Household use only. Do not immerse in water.

SAVE THESE INSTRUCTIONS

To assure continued FCC compliance:
FEDERAL COMMUNICATIONS COMMISSION INTERFERENCE STATEMENT

This equipment has been tested and found to comply with the limits for a Class B digital device, pursuant to Part 15 of the FCC Rules. These limits are designed to provide reasonable protection against harmful interference in a residential installation. This equipment generates, uses and can radiate radio frequency energy and, if not installed and used in accordance with the instructions, may cause harmful interference to radio communications. However, there is no guarantee that interference will not occur in a particular installation. If this equipment does cause harmful interference to radio or television reception, which can be determined by turning the equipment off and on, the user is encouraged to try to correct the interference by one or more of the following measures:

- Reorient or relocate the receiving antenna.
- Increase the separation between the equipment and receiver.
- Connect the equipment into an outlet on a circuit different from that to which the receiver is connected.
- Consult the dealer or an experienced radio/TV technician for help.

Warning:

To assure continued FCC compliance:

Any changes or modifications not expressly approved by the grantee of this device could void the user's authority to operate the equipment.

FCC ID:2A3Z9-CR-7 **FCC**

This device complies with Part 15 of the FCC Rules.

Operation is subject to the following two conditions:

(1) This device may not cause harmful interference, and (2) this device must accept any interference received, including interference that may cause undesired operation.

2.0 About Your Chef Robot

2.1

Chef Robot Overview

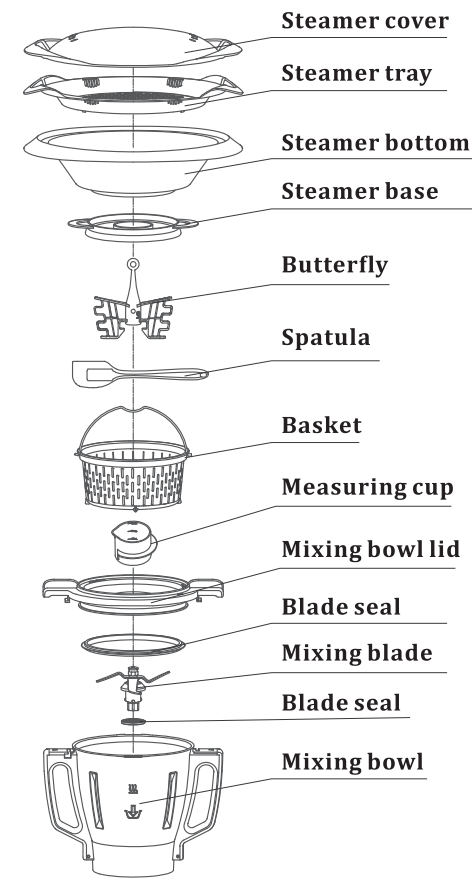
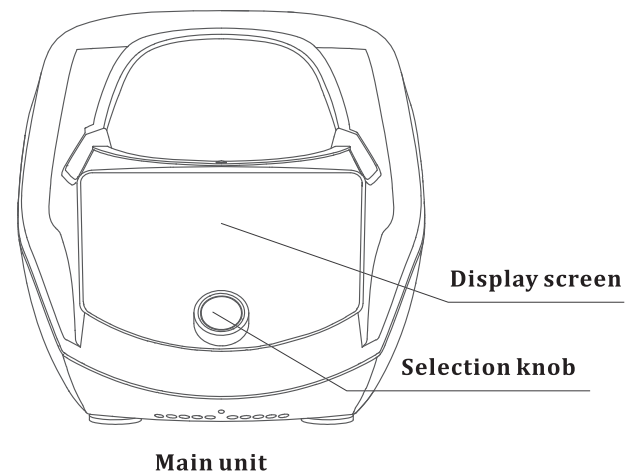

2.2 Knob Instructions

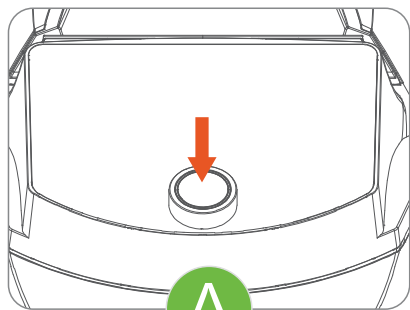

A

Long press for 3 seconds: Puts the machine in sleep mode.

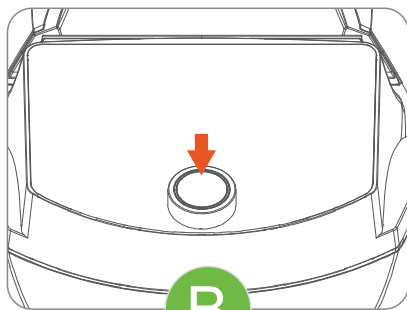

B

Short press: Start and pause.

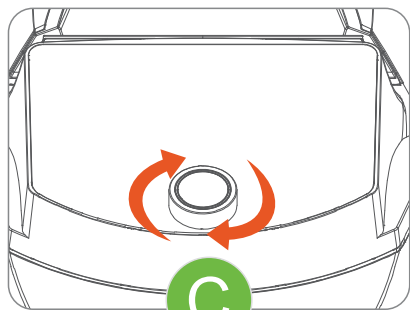

C

Left and right rotations: Set time, temperature and speed.

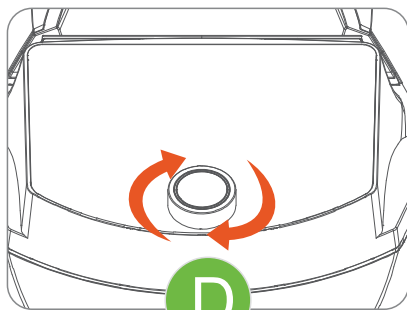

D

When viewing recipes, left and right rotations: Switch the recipes.

LED & Button Guidelines

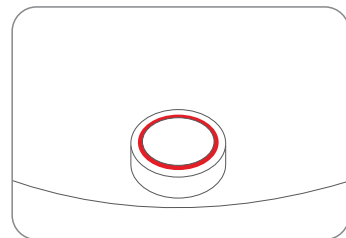

Red: Fault is reported.

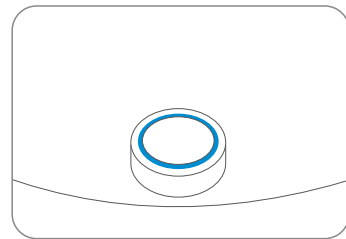

Blue: Normal operations
Flashing blue: Cooking

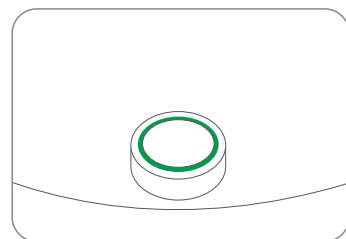

Green: End of cooking

2.3

2.4

Switch On/Off

Connect the power cable to a suitable electrical wall outlet, ensuring each is dry and clean.

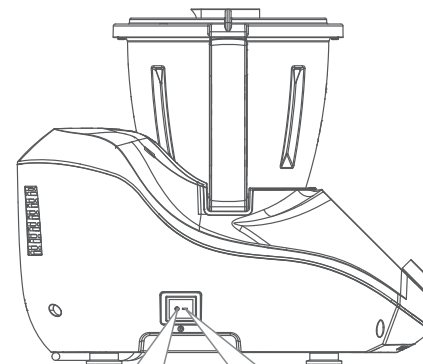

To switch the main unit off, set the power switch to the "0" position.

To switch the main unit on, set the power switch to the "1" Position.

⚠ Attention

After use, switch off, then unplug Chef Robot from the electrical wall outlet.

Use the power cable collector on the bottom of device

1. Before use, remove the power cable from the power cable collector
2. After use, store the power cable as shown in the figure.

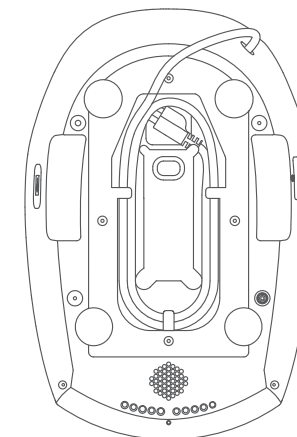

2.5 Main functions

Chef Robot is a multifunctional smart kitchen cooking machine that allows you to create and share own recipes. It lets you cook more easily and makes food preparation fun and enjoyable!



Chef Robot is intended for household use only and not for commercial use.
Chef Robot is intended to be used in dry indoor areas only.

3.0 Use of Chef Robot

3.1 Mixing Bowl & Blade

A Installing the mixing blade

The blade is sharp. Handle carefully to avoid being cut.

Do not turn over the mixing bowl when removing the blade. The blade might fall out suddenly.

Never hold the mixing blade by the blades themselves to avoid injury.

1. Attach the blade seal to bottom of the mixing blade as pictured here.
2. Grab the upper part of the mixing blade and place it in the mixing bowl, as shown here.
3. Lock the blade in place by rotating the latch on the underside of the mixing bowl clockwise.

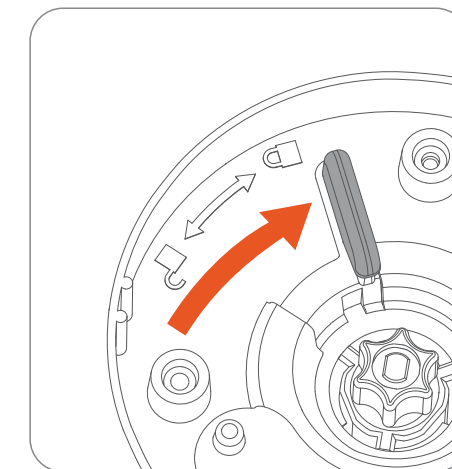
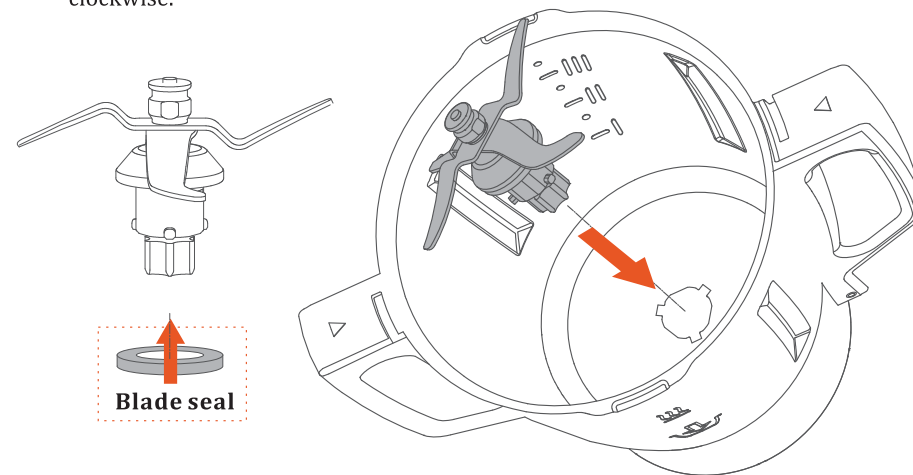

Rotate the latch clockwise to lock blade after putting the blade into bowl