

Power-on and Wake-on-LAN,setting guide file storage path (Select the corresponding file according to the machine model): C:\Power On and WOL

System drive file storage path: C:\Driver

After service

Email:  
Mini PC:Support-pc@bee-link.com  
TV BOX:Support-box@bee-link.com  
Sales : Wholesale@bee-link.com

Call us! +86-755-36633117/36633118



Video Tutorial



Forum



MADE IN CHINA



# SER

## User Manual

FCC Compliance Statement:

This device complies with Part 15 of the FCC Rules. Operation is subject to the following two conditions:  
(1) this device may not cause harmful interference, and  
(2) this device must accept any interference received, including interference that may cause undesired operation.  
Changes or modifications not expressly approved by the party responsible for compliance could void the user's authority to operate the equipment.  
NOTE: This equipment has been tested and found to comply with the limits for a Class B digital device, pursuant to Part 15 of the FCC Rules. These limits are designed to provide reasonable protection against harmful interference in a residential installation. This equipment generates, uses instructions, may cause harmful interference to radio communications. However, there is no guarantee that interference will not occur in a particular installation. If this equipment does cause harmful interference to radio or television reception, which can be determined by turning the equipment off and on, the user is encouraged to try to correct the interference by one or more of the following measures:  
-- Reorient or relocate the receiving antenna.  
-- Increase the separation between the equipment and receiver.  
-- Connect the equipment into an outlet on a circuit different from that to which the receiver is connected.  
-- Consult the dealer or an experienced radio/TV technician for help.

FCC Radiation Exposure Statement

This equipment must be installed and operated in accordance with provided instructions and the antenna(s) used for this transmitter must be installed to provide a separation distance of at least 20 cm from all persons and must not be co-located or operating in conjunction with any other antenna or transmitter. End-users and installers must be provide with antenna installation instructions and transmitter operating conditions for satisfying RF exposure

[Buttons and Ports]

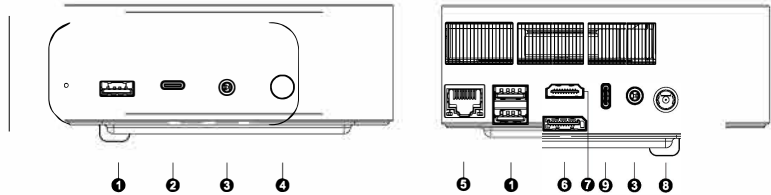

- |   |                          |               |
|---|--------------------------|---------------|
| 1. USB port                             | 4. Power button          | 7. HDMI port  |
| 2. Type-C port                          | 5. 2.5Gbps Ethernet jack | 8. DC port    |
| 3. Audio jack (with microphone support) | 6. Display Port          | 9. USB 4 port |

**⚠ To ensure safety and avoid hazards, we strongly recommend that you use the original power adapter for power supply.**  
\*The specifications are subject to the actual product.

[Precautions for Use]

- In order to continuously improve the user experience, we may occasionally update applications and firmware.
- Do not use strong chemical solvents to clean the product, and we recommend you wipe it with a soft cloth.
  - Please keep this product away from fire.
  - Please do not try to open the case or perform repairs yourself. If a failure occurs, please contact customer service.
  - When cleaning the electronic product, please keep it dry and be cautious of electric shocks.
  - Please check whether any cables or plugs are worn or damaged.
  - Do not dispose of the product carelessly, be mindful to protect the environment.
  - Ideal working environment temperature: 10°C-45°C; humidity: 30%-85%.
  - Ideal storage environment temperature: -20°C-60°C; humidity: 10%-90%.



The terms "HDMI" and "HDMI High-Definition Multimedia Interface", the HDMI trade dress, and the HDMI logo are all trademarks or registered trademarks of HDMI Licensing Administrator, Inc.

[RAM and SSD Installation (This operation should be performed when the power is disconnected)]

DDR SDRAM Installation (As shown in the figure)

- 1.Align the DDR SDRAM module with the RAM slot, then gently push the module into the slot at a 30° angle.
2. Press the module down until the DDR SDRAM is secured by the safety arms at both ends of the RAM slot.

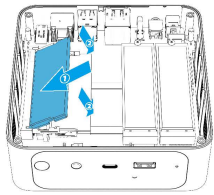

SSD Installation (as illustrated in the picture)

1. Align the plug of the SSD and that of the M.2 slot on the motherboard, then gently push the SSD in.
2. Press the other end down and use screws to fix it in place.

SSD Slot 1: Used for system drive installation  
SSD Slot 2: Used for storage drive installation

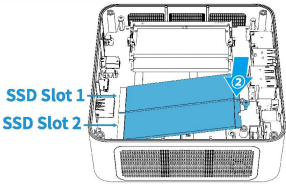
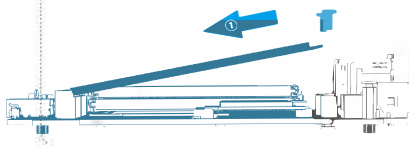

[Steps for Connection]

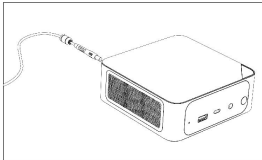

1. Connect the mini PC to the power supply supply



2. Connect the mini PC to the monitor with an HDMI/DP cable

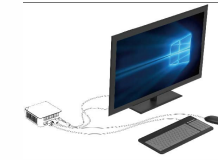

3. Connect the mini PC with a keyboard and a mouse

[Switching the Audio Playback Device in Windows]

If your PC is connected to multiple audio playback devices (eg. speakers, headphones, Bluetooth headset, monitors with built-in speakers, etc) simultaneously, you will need to choose one of them for audio playback

1. Simply click the sound icon in your notification area (also known as the "system tray").

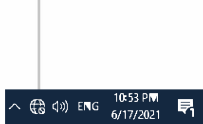

2. Click "Select playback device".



3. Choose a device from the list for audio playback.

