

ALL IN ONE SMART LED DISPLAY

Operating Instruction



Contents

1. Introduction	3
2. Getting Started	4
3. Remote	6
3.1 Buttons on the Remote	6
3.2 Bluetooth Pairing Method	6
4. Screen Mirroring	7
4.1 Wireless Mirroring	7
4.1.1 Mirroring from Mobile Phone	7
4.1.2 Mirroring from PC	9
4.1.3 Mirroring Multiple Devices Simultaneously	10
4.1.4 Reverse Control	13
4.1.5 Wireless Snapshot	14
4.1.6 Wireless Speech	15
4.2 Wired Mirroring	16
5. Signal Switching	17
6. Display Effect Adjustment	19
6.1 Select An Application Mode	19
6.2 Customize a Display Effect	21
6.3 Enable Blue Light Filter	22
7. Settings	23
7.1 File Management	23
7.2 Network Settings	25
7.2.1 Wired Network	25
7.2.2 Wireless Network (Wi-Fi)	25
7.2.3 Hotspot	26
7.2.4 Bluetooth	27
7.3 Display Effect Adjustment	28
7.4 Sound Settings	28
7.5 General Settings	29
7.5.1 Signal Settings	29
7.5.2 App Management	31
7.5.3 Date and Time	31
7.5.4 Language and Keyboard	33
7.5.5 Wallpaper	33
7.5.6 Assistive Touch	34
7.6 System Settings	35
7.6.1 Scheduled Startup and Shutdown	35
7.6.2 Factory Reset	36
7.6.3 Android System Update	37
7.6.4 About	38
7.6.5 Switch Ethernet Port	38

1.Introduction

This document introduces the instructions of the Smart LED Display (SLD) operating system to help users get started quickly.

The SLD Series brings the brand-new large-screen visual experience to the conference room. It can wirelessly mirror the screen of the speaker's smart terminal, whether Windows, macOS, iOS or Android, to the display in real time without complex wired connections. For different applications, the operating system provides four modes to make optimal display effect happen for presentation, video playback and remote conference.

Working with the specified models of receiving cards, the system enables the fine-pitch indoor LED display to have outstanding grayscale and color performance. Thanks to the function of quick mirroring up to 4 devices to the LED display and switching between the mirrored screens, the system meets all the conference applications and can be mainly used in various business applications in the design, medical and education industries, etc.

2. Getting Started

Initialize the operating system

For the first-time use of the system, do the following steps to complete the initialization.

- Step 1 Choose the system language. You can choose from Chinese, English or Japanese.

Figure 2-1 Choosing a language

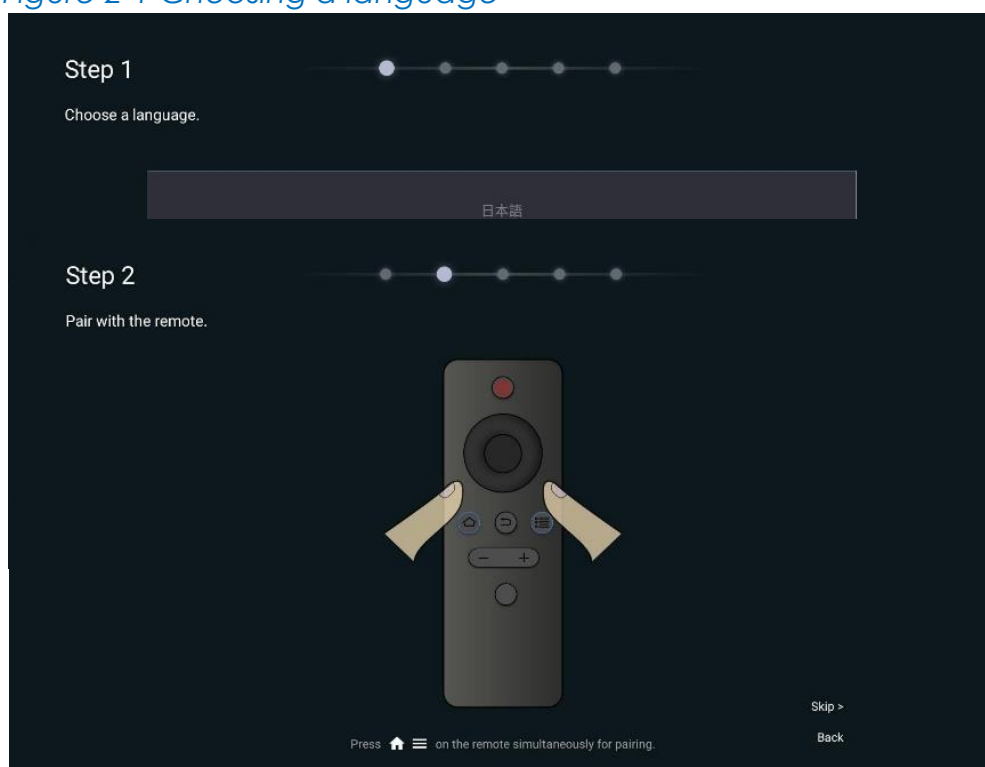

- Step 2 Hold the menu and home button on the remote simultaneously until the **Connecting to the remote** window appears on the screen. Then, press any button on the remote to complete pairing the system with the remote via Bluetooth.

Figure 2-2 Pairing with the remote

- Step 3 Select the Wi-Fi network you want to connect the system to and enter the password.

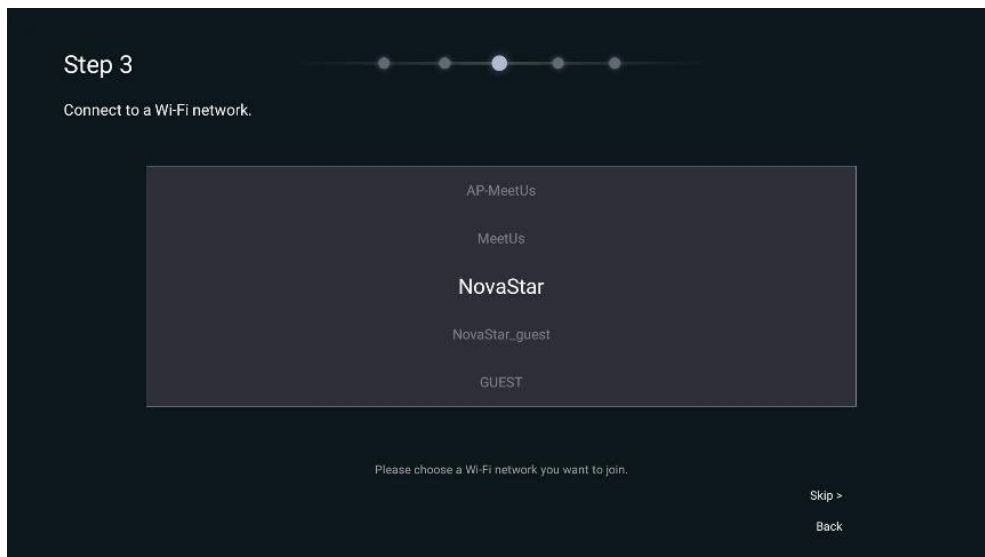

Figure 2-3 Connecting to a Wi-Fi network

- Step 4 Customize the device name. A custom name is convenient for you to use other devices to search for.

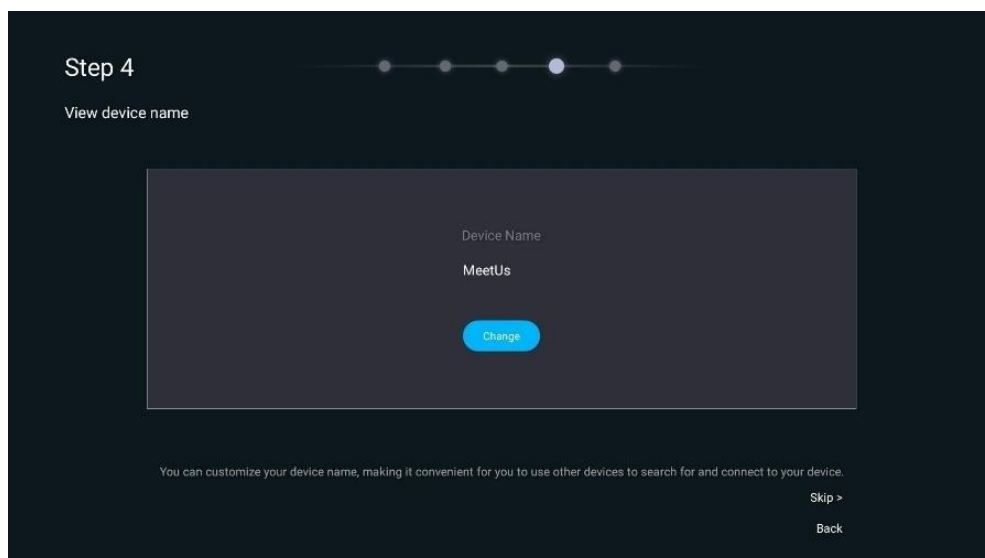

Figure 2-4 Customizing device name

- Note: the mirroring dongle in the next step is not available outside mainland China.

3.Remote

3.1 Buttons on the Remote



Figure 3-1 Description of buttons on the remote

3.2 Bluetooth Pairing Method

Method 1

- Step 1 Hold the menu and home button on the remote simultaneously until the **Connecting to the remote** window appears at the bottom of the screen.
- Step 2 Press any button on the remote to complete pairing.

**Note: If the Bluetooth pairing is not successful after a long time, please check whether the Bluetooth antenna connection is normal.*

Method 2

- Step 1 On the home page, select **More Apps** to enter the App interface.
- Step 2 Click **Settings** > **Network** > **Bluetooth** to enter the Bluetooth settings screen.
- Step 3 Select the remote name from the **Other Devices** list and press on the name.
- Step 4 Press any button on the remote to complete pairing.

4.Screen Mirroring

4.1 Wireless Mirroring

4.1.1 Mirroring from Mobile Phone

Mirroring from Android

- Step 1 Use the phone to scan the QR code on the **Quick Sharing** screen to download the Transcreen app and install it on the phone.
- Step 2 Connect the phone to the hotspot (default name: MeetUs; default password: 12345678).
- Step 3 Run the Transcreen app on the phone. On the displayed **Select for Devices** window, select the device you want to connect to, and tap **Confirm**.
- Step 4 Tap **Mirror** and then tap **Start now** on the displayed window to start mirroring.



Figure 4-1 Running the Transcreen app

Mirroring from iOS

- Step 1 Connect the phone to the hotspot (default name: MeetUs; default password: 12345678).
- Step 2 Open up the control center.
- Step 3 Tap **Screen Mirroring** and start mirroring.



Figure 4-2 Screen mirroring

4.1.2 Mirroring from PC

Mirroring from Windows

- Step 1 On the PC, open a browser, enter the website address "meexus.cn" and download the **LinkED for Windows** client.
- Step 2 Connect the PC to the hotspot (default name: MeetUs; default password: 12345678).
- Step 3 Run the client on the PC. The connected device will be detected by the client automatically. Then, click **Start projection**.

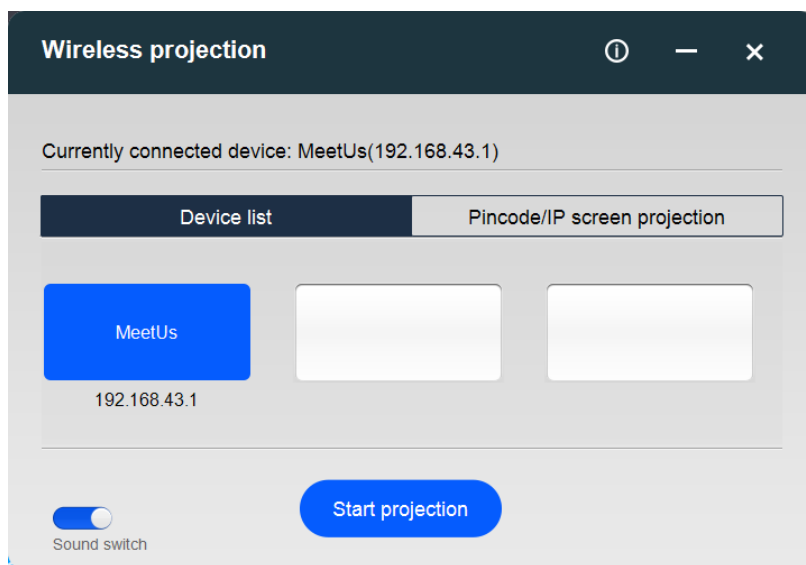

Figure 4-3 Screen mirroring - Windows

Mirroring from macOS

- Step 1 Connect the PC to the hotspot (default name: MeetUs; default password: 12345678).
- Step 2 Click the AirPlay icon in the menu bar at the top of your screen and select the device you want to mirror the screen to.

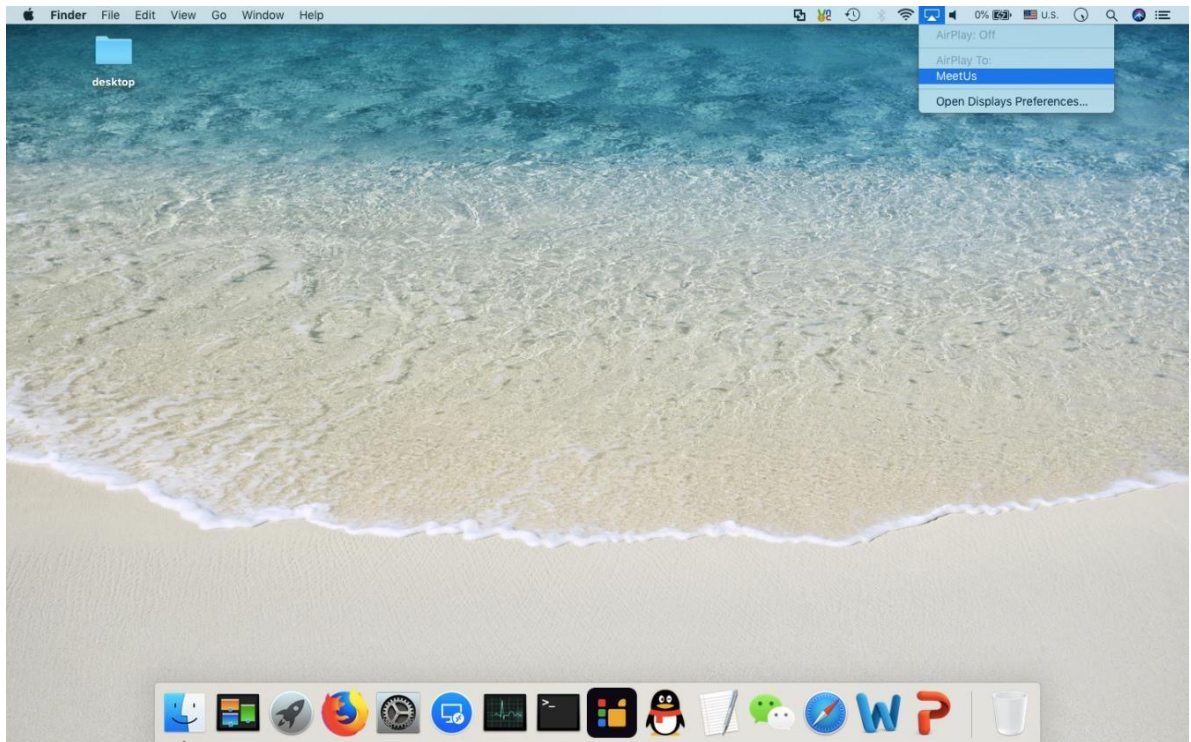

Figure 4-4 Screen mirroring - Mac

4.1.3 Mirroring Multiple Devices Simultaneously

The system supports mirroring multiple devices simultaneously. The display is split into multiple sections to show the mirrored screens of the devices. Users can mirror up to 4 devices to the system at the same time. To mirror multiple devices to the system, do the following steps.

- Step 1 On the home page, select **Quick Sharing** to enter the screen shown below.

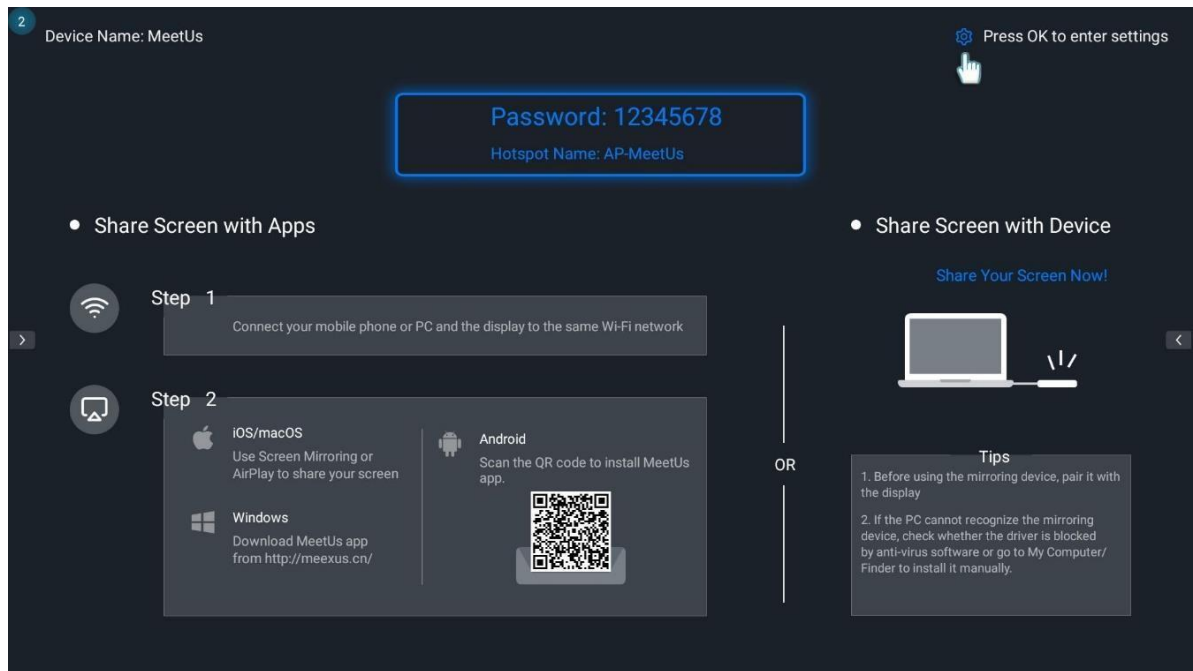

Figure 4-5 Quick sharing

- Step 2 Press the **OK** button on the remote to select the icon at the top right corner to open the **Mirror Setting** menu and select **Set the quantity of split-screen**.

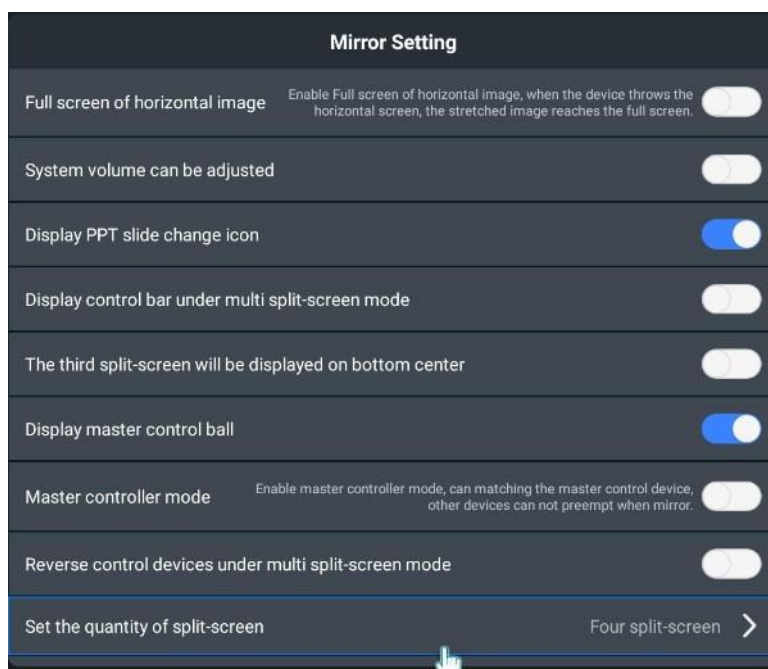
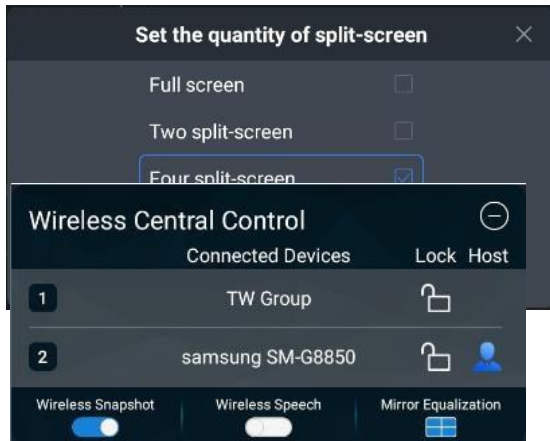

Figure 4-6 Setting the quantity of split-screen

- Step 3 In the window that appears, select a mirroring mode from **Full screen**, **Two split-screen**, and **Four split- screen**.

Figure 4-7 Setting the quantity of split-screen



- Step 4 Enable **Display master control ball** in the menu to open the **Wireless Central Control** window. On the window, click the connected devices with the mouse one by one to complete split-screen mirroring.

Figure 4-8 Wireless central control

*Note:

- You can only use the connected mouse to select and operate on the master control ball. The remote cannot work on the control ball.
- For iOS devices, you can only use their screen mirroring function to mirror screens. You cannot mirror screens via the master control ball.
- In split-screen mode, the sound of only one screen can be played, but the sound for each screen can be turned on or off independently.
- You can swap positions of the screens, and double click a screen to let it display in full screen.

4.1.4 Reverse Control

The system supports reverse control during mirroring. The speaker can walk around the room freely and use the Android mobile device (phone or tablet) to reverse-control the computer that is being mirrored.

- Step 1 Use the mobile device to scan the QR code on the **Quick Sharing** screen to download and install the Transcreen app.
- Step 2 Connect the mobile device to the hotspot of system (default name: MeetUs; default password: 12345678).
- Step 3 Run the Transcreen app on the phone. On the displayed **Select for Devices** window, select the device you want to connect to, and tap **Confirm**.
- Step 4 For the first-time use, tap **Mirror** and then tap **Start now** on the displayed window to start mirroring.
- Step 5 Tap **Secondary mirror** to start reverse control.

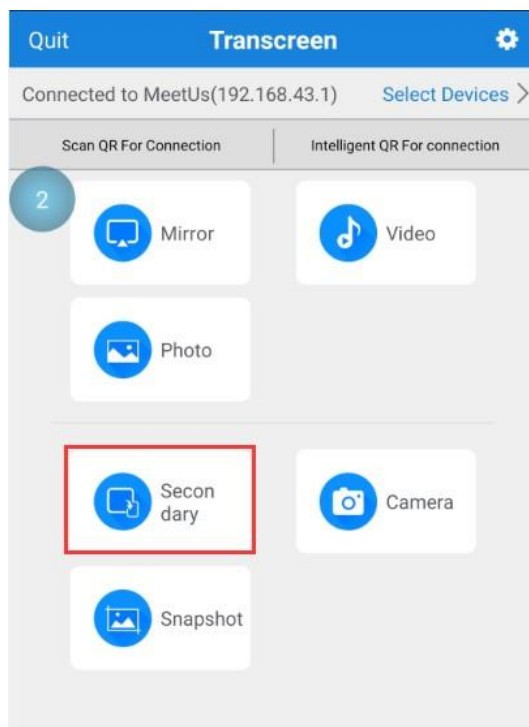

Figure 4-9 Secondary mirroring

4.1.5 Wireless Snapshot

The system supports wireless snapshot function. The audience can use the mobile device (phone or tablet) to take a snapshot of the content mirrored on the conference display by the speaker. The snapshot will be transmitted and saved to a specified location of the audience's mobile device instantly.

- Step 1 On the system, enable **Display master control ball** in the menu to open the **Wireless Central Control** window. On the window, enable the **Wireless Snapshot** function with the mouse.



Figure 4-10 Wireless central control

- Step 2 Use the mobile device to scan the QR code on the **Quick Sharing** screen to download and install the Transcreen app.
- Step 3 Connect the mobile device to the hotspot (default name: MeetUs; default password: 12345678).
- Step 4 Run the Transcreen app on the phone. On the displayed **Select for Devices** window, select the device you want to connect to, and tap **Confirm**.

- Step 5 Tap **Snapshot**. A snapshot of the mirrored content will be taken instantly and saved to the specified location.

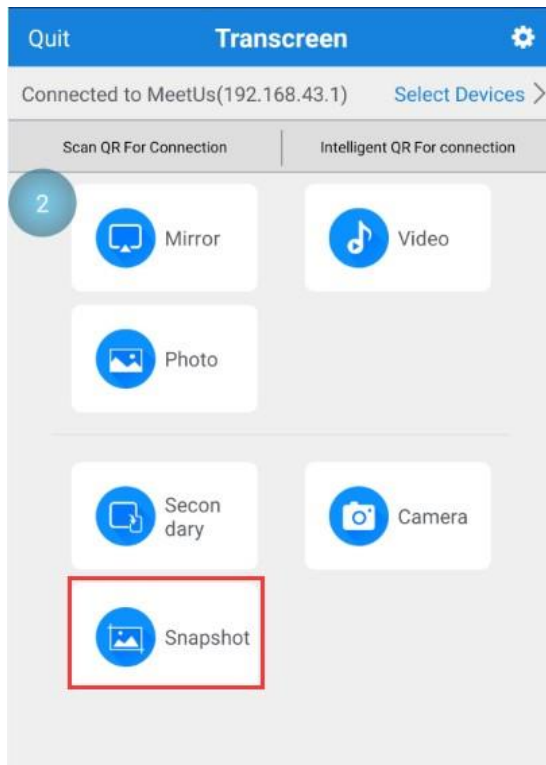

Figure 4-11 Wireless snapshot

4.1.6 Wireless Speech

The system supports wireless speech function. The mobile device (phone or tablet) can be used as a microphone, and the audience can make a speech directly via the mobile device. The sound will be transmitted to the sound system in the room.

- Step 1 On the system, enable **Display master control ball** in the menu to open the **Wireless Central Control** window. On the window, enable the **Wireless Speech** function with the mouse.



Figure 4-12 Wireless central control

- Step 2 Use the mobile device to scan the QR code on the **Quick Sharing** screen to download and install the Transcreen app.
- Step 3 Connect the mobile device to the hotspot (default name: MeetUs; default password: 12345678).
- Step 4 Run the Transcreen app on the phone. On the displayed **Select for Devices** window, select the device you want to connect to, and tap **Confirm**.

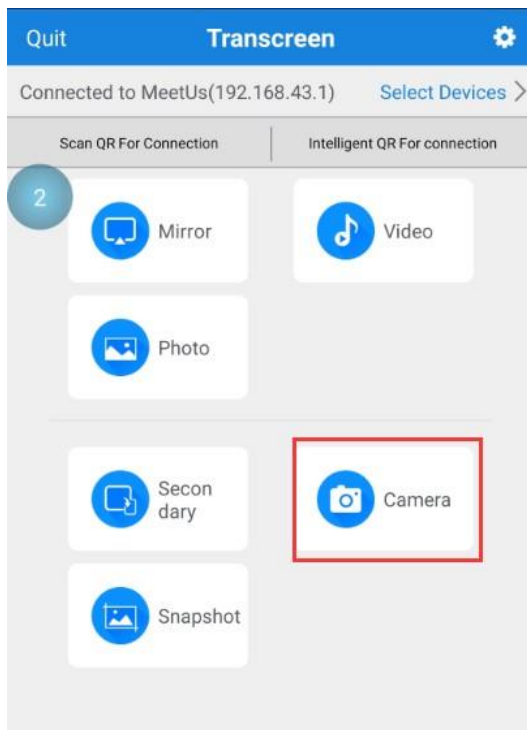

Figure 4-13 Camera (wireless speech)

- Step 5 Tap **Camera**. On the displayed screen, tap and hold **Press to talk** to talk directly.

4.2 Wired Mirroring

Connect the system to the device you want to mirror the screen from via HDMI cable. There are three HDMI 2.0 inputs.

5.Signal Switching

You can switch the signal via the following 3 methods.

Via Presentation

- Step 1 On the home page, select **Presentation** to enter its screen.



Figure 5-1 Presentation interface

- Step 2 Select the signal that you want to present and press the **OK** button on the remote to complete switching.

Via Menu

- Step 1 On the remote, press the menu button to enter the menu.



Figure 5-2 Menu interface

- Step 2 Select **Signal** to open the signal switching screen displayed at the bottom of the display.
- Step 3 Select the signal that you want to present and press the **OK** button on the remote to complete switching.

Via Signal Switching Button on the Remote

- Step 1 On the remote, press the signal switching button to open the signal switching screen displayed at the bottom of the display. (See the button description of the remote in 3.1 Buttons on the Remote.)
- Step 2 Select the signal that you want to present and press the **OK** button on the remote to complete switching.

6. Display Effect Adjustment

To have a more comfortable viewing experience, you can adjust the display effect via the following 3 methods.

6.1 Select an Application Mode

- Step 1 On the remote, press the menu button to enter the menu.

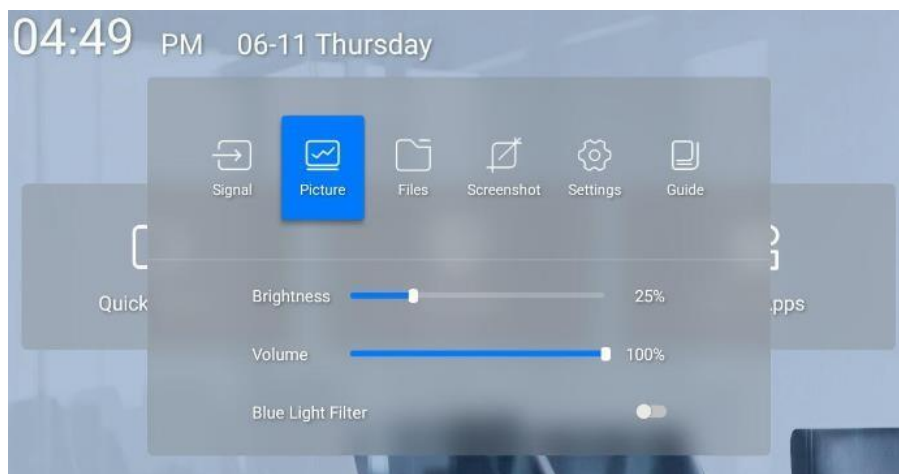

Figure 6-1 Menu interface

- Step 2 Select **Picture** and press the **OK** button to enter the effect adjustment screen.



Figure 6-2 Effect adjustment interface

- Step 3 Select a mode based on your need
 - a) Standard Mode: This is the default mode and covers most applications.
 - b) Soft Mode: This mode is suitable to applications where there is a lot of text, such as document presentation, PPT slide show, etc.
 - c) Movie Mode: This mode is suitable to video and movie playback applications
 - d) Conference Mode: This mode is suitable to the applications where there are many figures, such as a remote conference.

6.2 Customize a Display Effect

You can fine-tune the effect parameters after selecting an application mode to satisfy personalized requirements.

- Step 1 On the remote, press the menu button to enter the menu.
- Step 2 Select **Picture** and press the **OK** button to enter the effect adjustment interface.



Figure 6-3 Effect adjustment screen

- Step 3 Adjust the brightness, saturation, contrast, color temperature and hue parameter values to customize the display effect.
- Step 4 (Optional) If you are not satisfied with the effect after adjustment, press the **Reset** button to reset the parameter values to the defaults.

6.3 Enable Blue Light Filter

You can enable the blue light filter for eye care via one-click only.

- Step 1 On the remote, press the menu button to enter the menu.

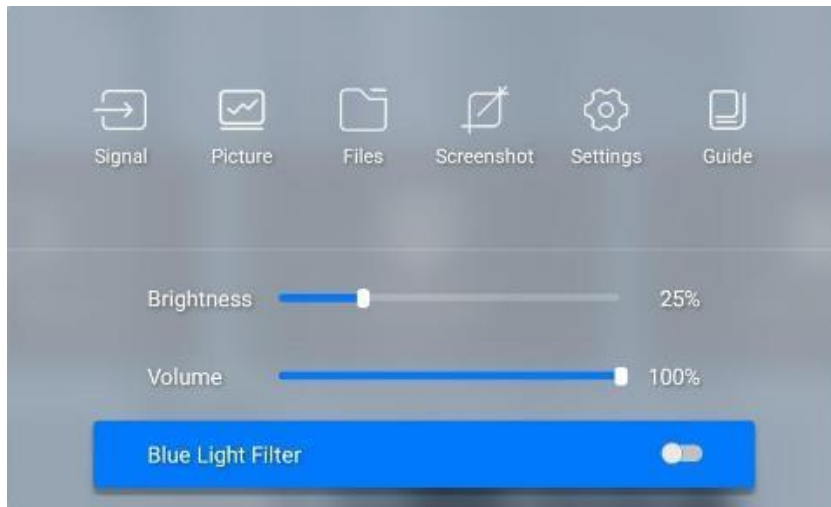

Figure 6-4 Blue light filter mode

- Step 2 Toggle the **Blue Light Filter** switch to enable or disable the mode.

**Note:*

After you enable the blue light filter mode, the display will become a little yellowish.

7.Settings

7.1 File Management

You can do the following steps to manage the files.

- Step 1 On the home page, select **More Apps** to enter the App interface.

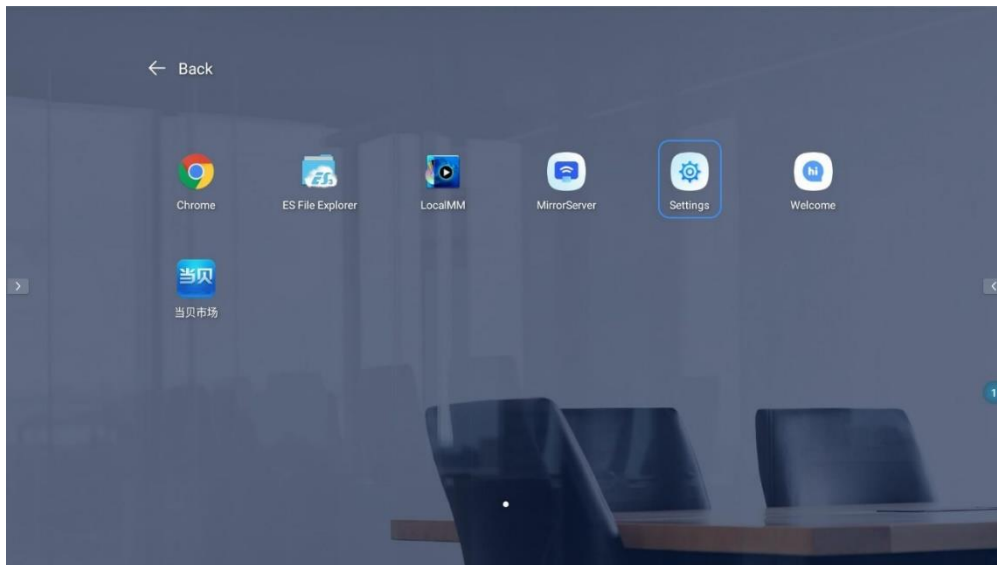

Figure 7-1 App Interface

- Step 2 Select ES File Explorer.

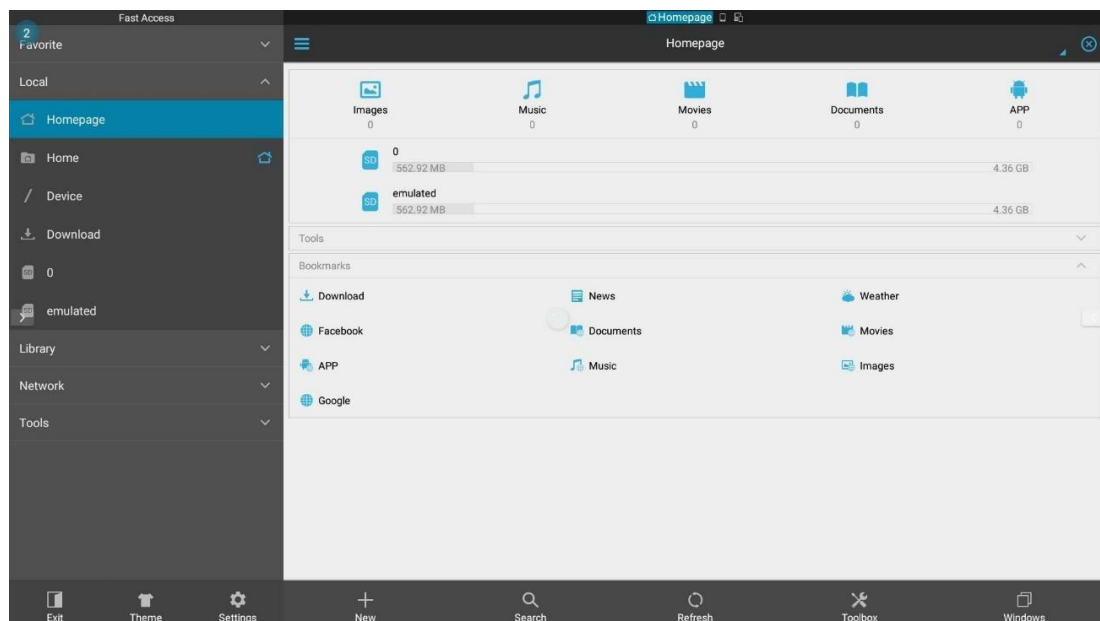

Figure 7-2 ES File Explorer

- Step 3 Select the folder where the target file is located.
- Step 4 Select the target file and press the **OK** button on the remote to open the file.
- Step 5 (Optional) Hold the **OK** button of the remote or the left mouse button on the target file to enable and use the file operation options at the bottom of the display, including copy, cut, delete and rename.

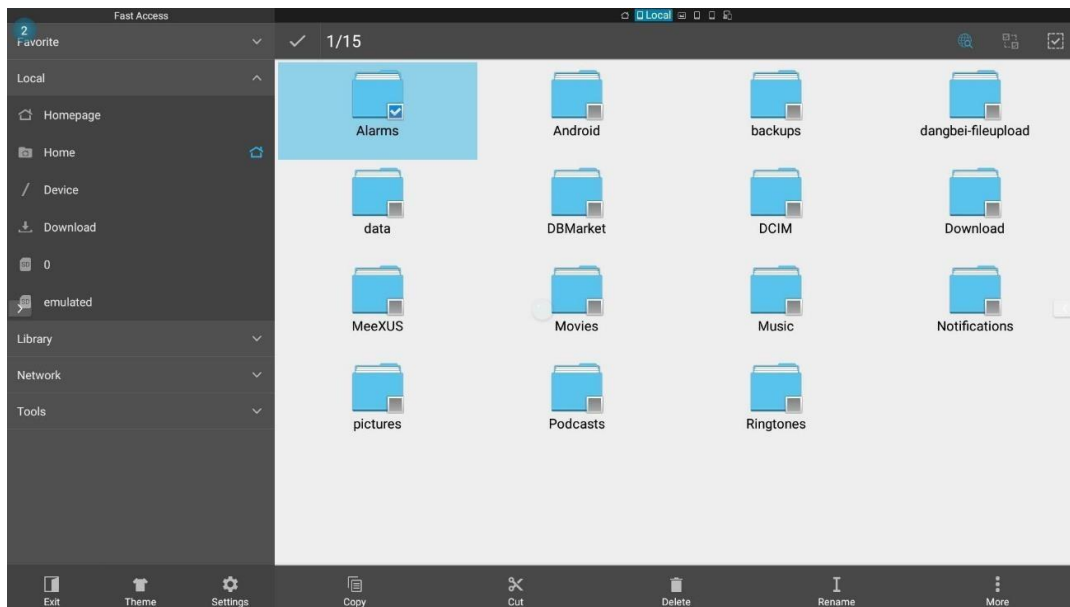

Figure 7-3 ES File Explorer - Copy / Cut / Delete / Rename

7.2 Network Settings

7.2.1 Wired Network

- Step 1 On the home page, select **More Apps** to enter the App interface.
- Step 2 Select **Settings** > **System** > **Switch Ethernet Port** > **Wired Network**.
- Step 3 Go back to the settings interface and select **Network** > **Wired Network**.

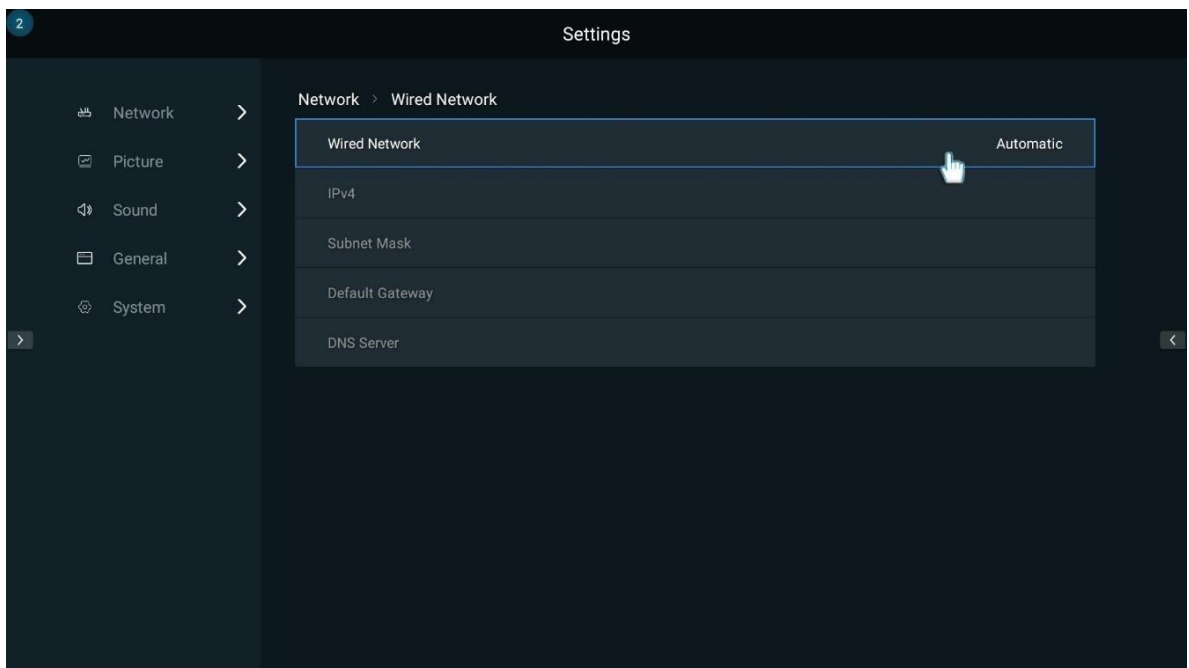



Figure 7-4 Wired network

- Step 4 Set the **Wired Network** parameter to **Automatic** to automatically obtain the IP address.
- Step 5 Go back to the home page, If the  icon appears at the top right corner, then the network connection is successful.

7.2.2 Wireless Network (Wi-Fi)

- Step 1 On the home page, select **More Apps** to enter the App interface.
- Step 2 Select **Settings** > **Network** > **Wireless Network**.
- Step 3 Select an available Wi-Fi network and enter the password.

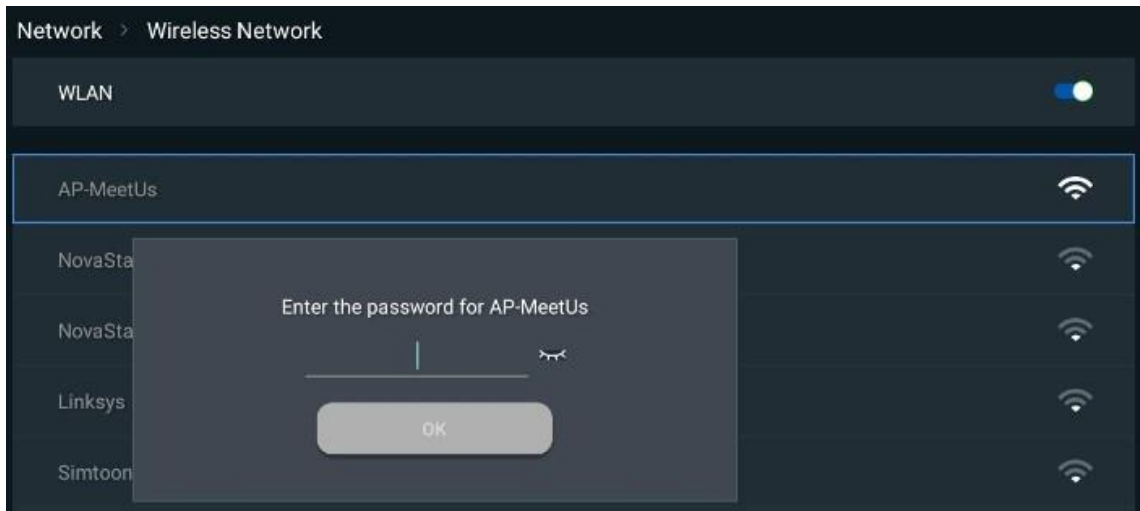

Figure 7-5 Entering the Wi-Fi password

- Step 4 Press **OK** to connect to the Wi-Fi network.

7.2.3 Hotspot

- Step 1 On the home page, select **More Apps** to enter the App Interface.
- Step 2 Select **Settings > Network > Hotspot**.
- Step 3 Set a password for the hotspot.

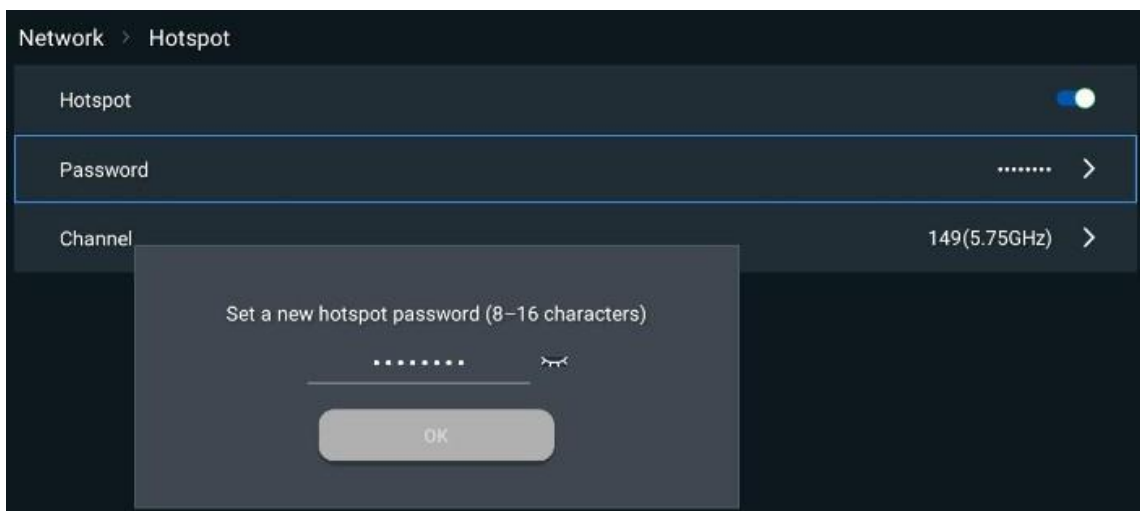

Figure 7-6 Setting a new hotspot password

- Step 4 Press **OK** to enable the hotspot.

7.2.4 Bluetooth

- Step 1 On the home page, select **More Apps** to enter the App interface.
- Step 2 Select **Settings > Network > Bluetooth**.
- Step 3 Turn on the Bluetooth switch.
- Step 4 Select the target device to pair it with the system.

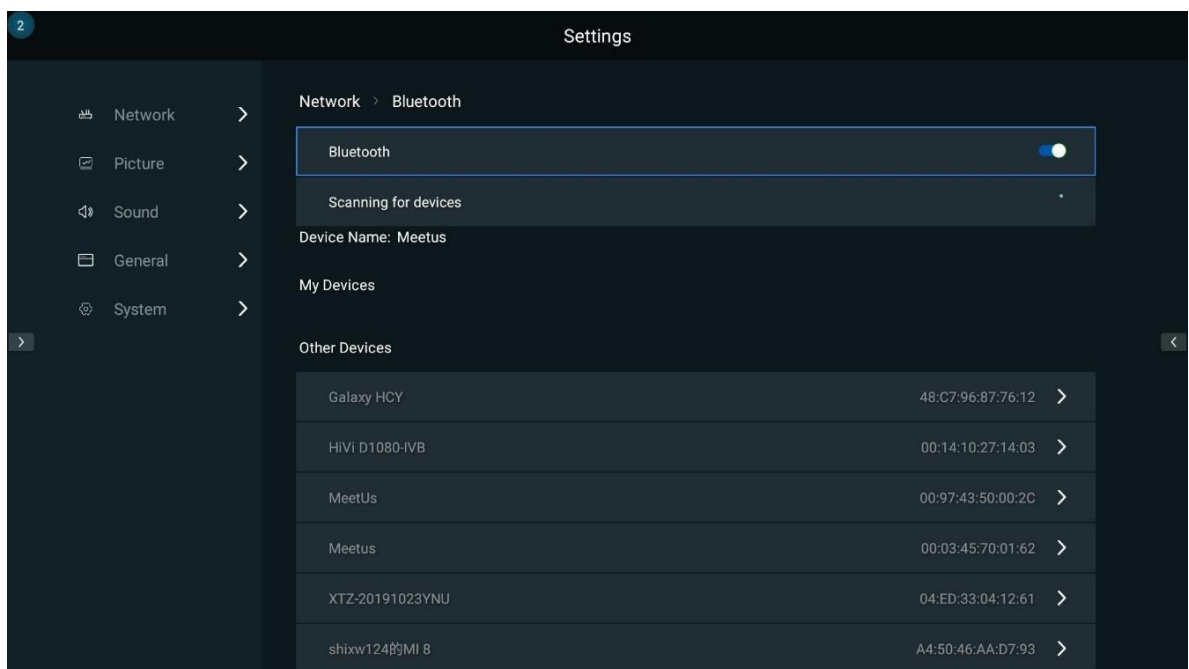

Figure 7-7 Bluetooth

7.3 Display Effect Adjustment

- Step 1 On the home page, select **More Apps** to enter the App interface.
- Step 2 Select **Settings > Picture**.

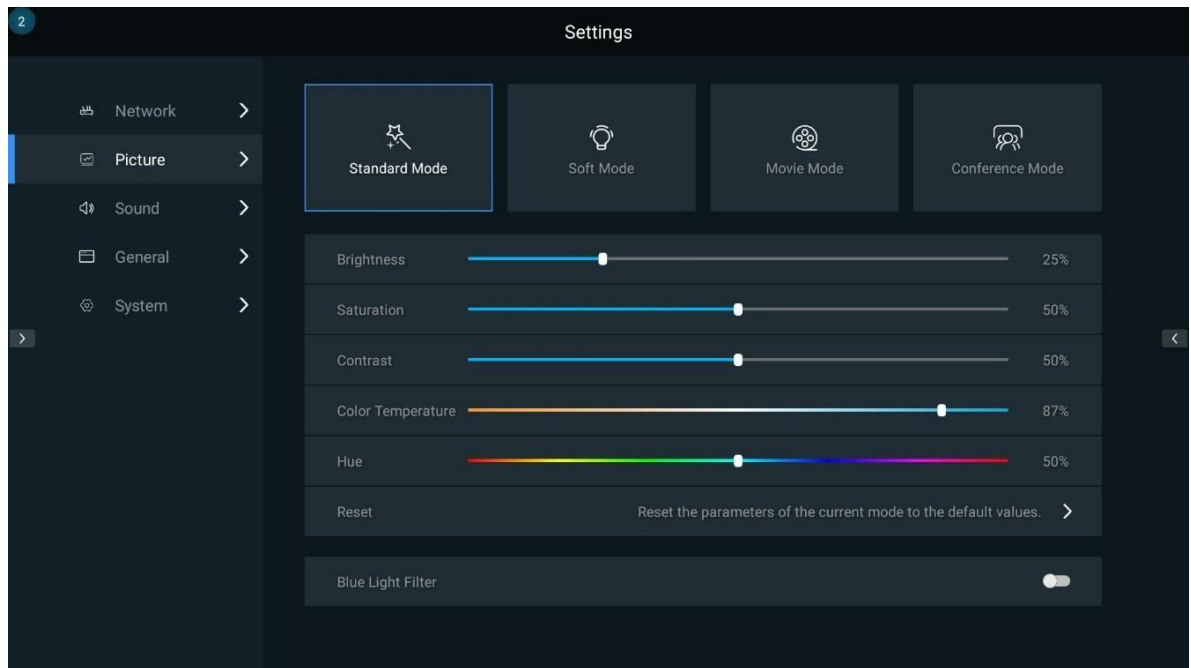

Figure 7-8 Effects

- Step 3 For the detailed adjustment method, see 6.Display Effect Adjustment.

7.4 Sound Settings

- Step 1 On the home page, select **More Apps** to enter the App interface.
- Step 2 Select **Settings > Sound**.

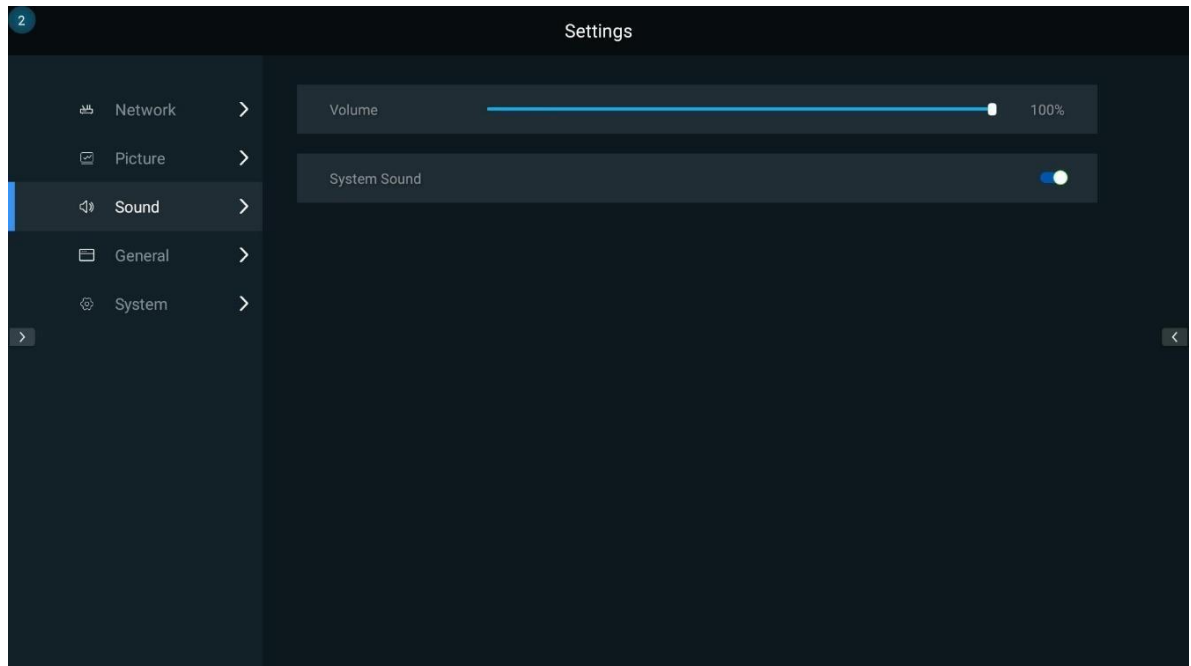

Figure 7-9 Sound settings

- Step 3 Adjust the volume and turn on or off the sound for the system.

7.5 General Settings

7.5.1 Signal Settings

- Step 1 Select **Settings > General > Signal** to enter the signal settings interface.
- Step 2 Do the following settings for the signal.
 - Remember Signal: Set the startup signal to **Last Used, Home** (default), **HDMI1, HDMI2, HDMI3** or **Windows**.
 - Set Aspect Ratio: Set the aspect ratio of the selected HMID source to **Auto Fit** (default), **4:3, 16:9**, or **Pixel to Pixel**.

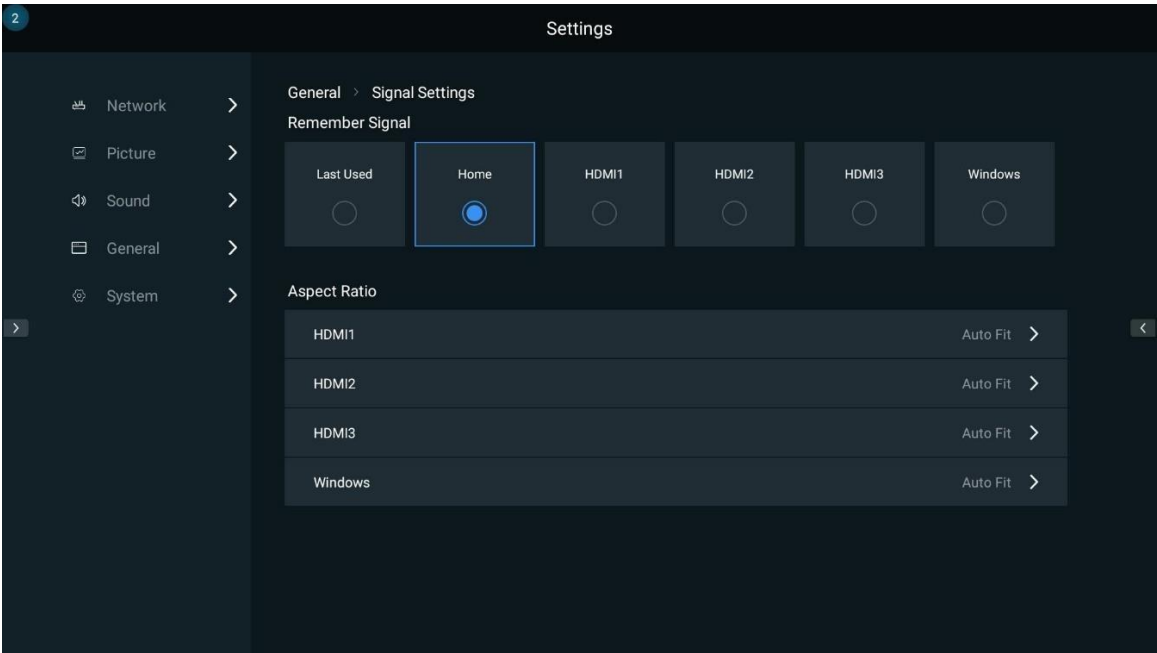

Figure 7-10 Signal settings

7.5.2 App Management

- Step 1 Select **Settings** > **General** > **Apps** to enter the app management interface.
- Step 2 Do the following settings for the installed apps.
 - Force Stop: Force the app to stop.
 - Open App: Run the selected app.
 - Uninstall: Uninstall the selected app.
 - Clear Data: Clear the data and cache of the selected app.

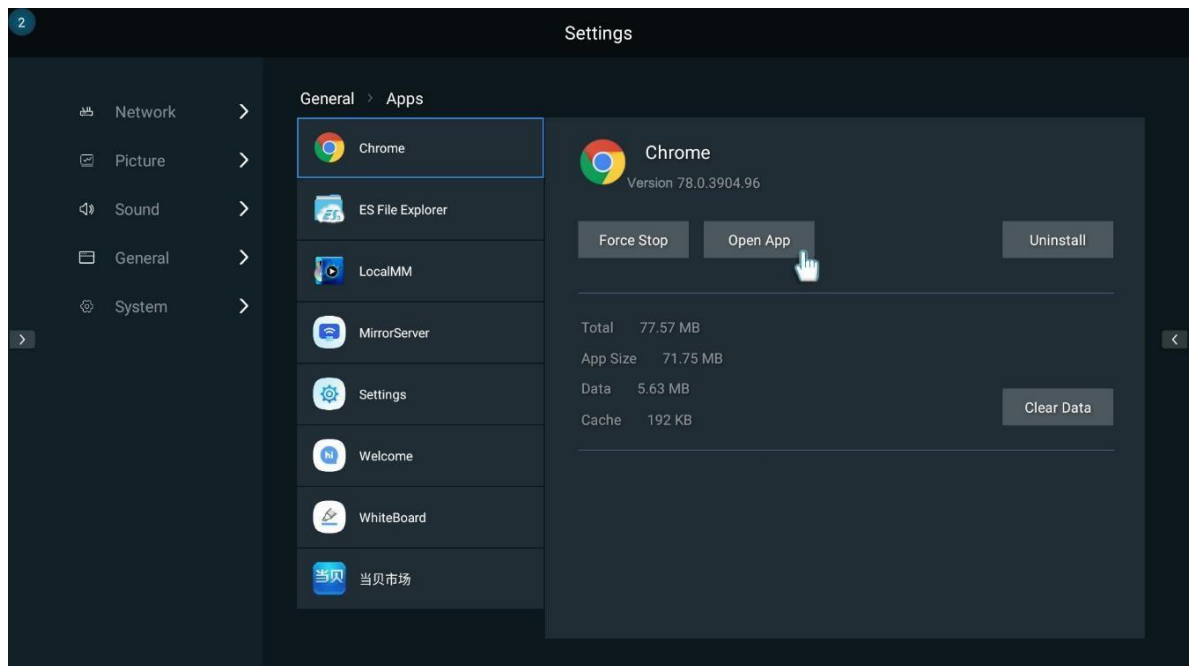

Figure 7-11 App management

7.5.3 Date and Time

- Step 1 Select **Settings** > **General** > **Date & Time** to enter the date and time settings interface.
- Step 2 Do the following data and time settings for the system.
 - Set Automatically: Enable this function to synchronize the date and time of the system with the network time. You can also disable this function and then manually set the date and time.

- 24-Hour Time: Turn on the switch enable the 24-hour time format. If you do not turn on the switch, the 12-hour time format is used by default.
- Date Format: Set the date format to **Year-Month-Day** (default) or **Day-Month-Year**.

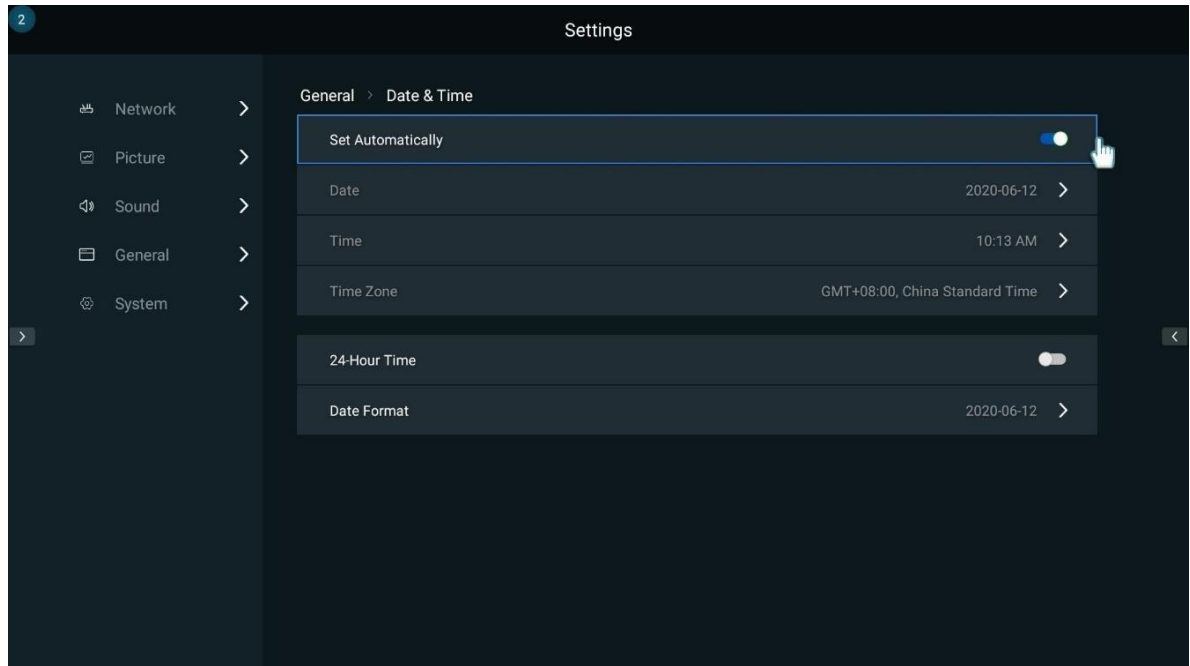

Figure 7-12 Date and time

7.5.4 Language and Keyboard

- Step 1 Select **Settings > General > Language & Keyboard** to enter the language and keyboard settings interface.
- Step 2 Do the following language and keyboard input method settings for the system.
 - Language: Set the system language to 中文 (简体) (default), **English**, 中文 (繁体) , or 日本語.
 - Keyboard: Set the keyboard input method to 谷歌拼音输入法 (default), **Android keyboard (AOSP)**, or **Google Japanese Input**.

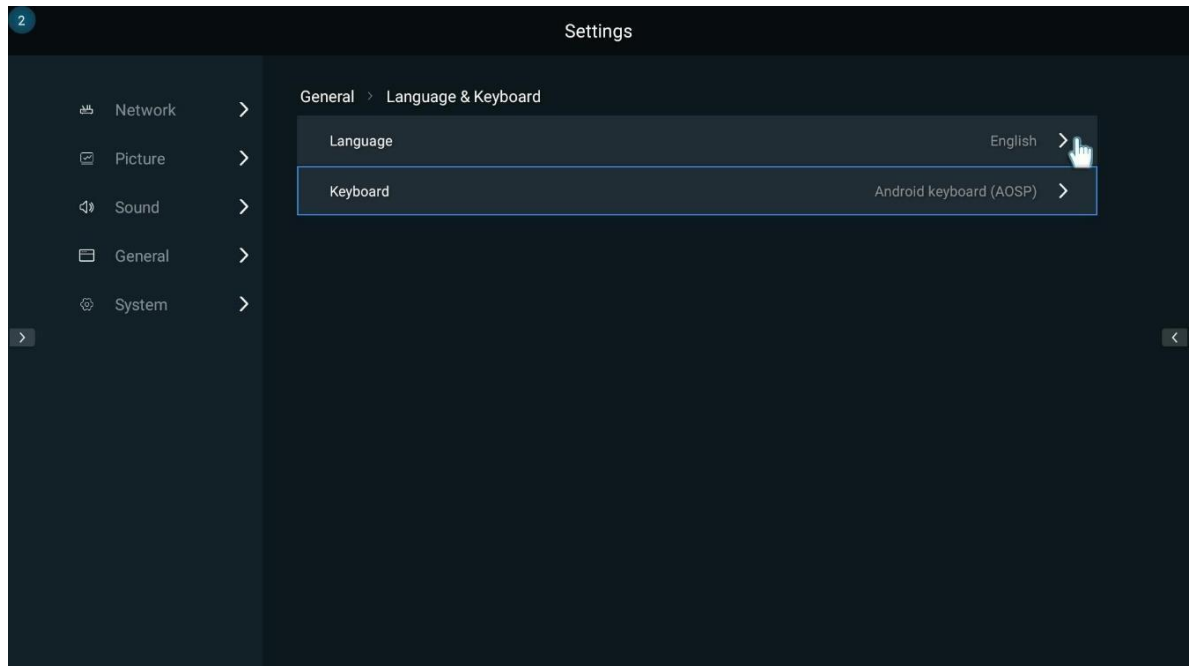

Figure 7-13 Language and keyboard

7.5.5 Wallpaper

- Step 1 Select **Settings > General > Wallpaper** to enter the wallpaper settings interface.

- Step 2 Set the wallpaper to a system wallpaper or a custom wallpaper.
 - System wallpaper: Select a target wallpaper and press the **Set as Wallpaper** button on the selected wallpaper.
 - Custom wallpaper: Press the **Custom Wallpaper** button to open the ES File Explorer, select a local picture, and press the **OK** button on the remote.

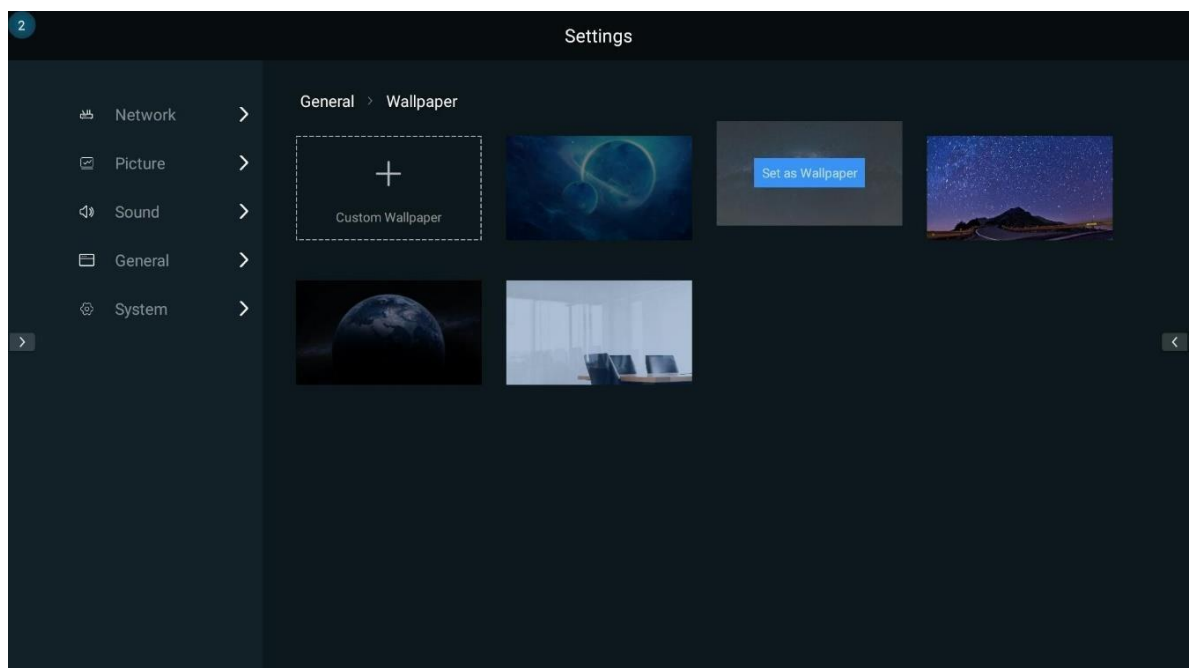

Figure 7-14 Wallpaper

7.5.6 Assistive Touch

- Step 1 Select **Settings > General > Assistive Touch** to enter the assistive touch settings interface.
- Step 2 Turn on the **Assistive Touch** switch and press the small triangle icons at the left and right display edges to open the sidebar.

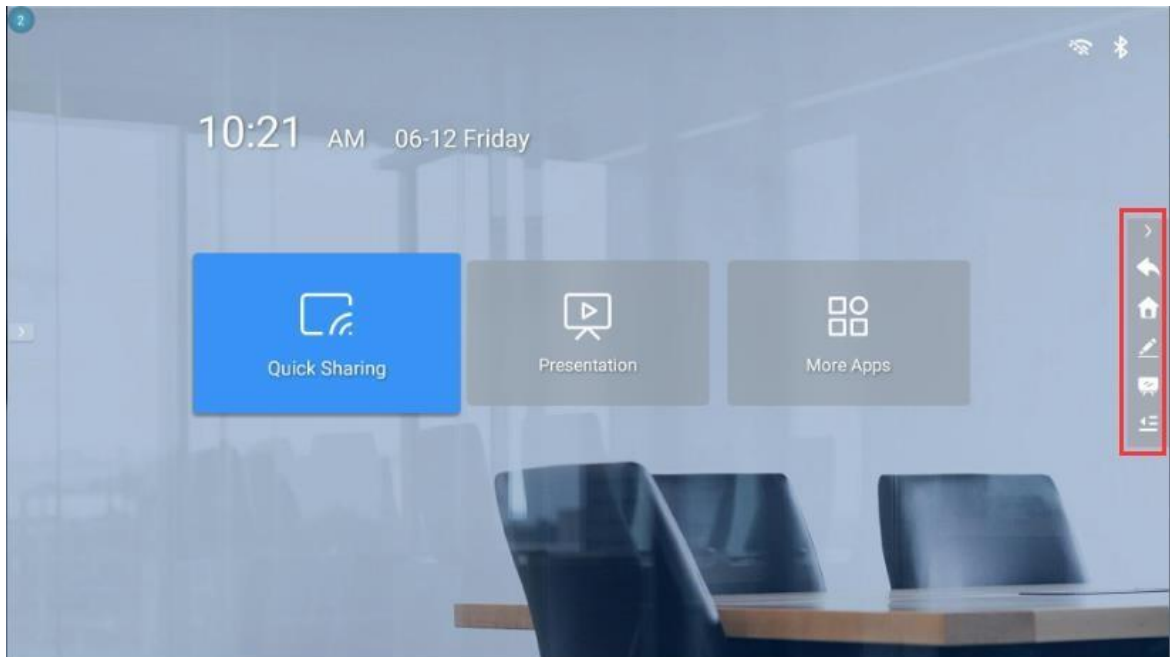







Figure 7-15 Assistive touch

- : Back button. Click or tap to go back to the previous operation
- : Home button. Click or tap to go back to the home page.
- : Pencil button. Click or tap to open the drawing tool.
- : Whiteboard button. Click or tap to open the whiteboard tool.
- : Menu button. Click or tap to open the menu bar.

*Note: You can only use the connected mouse or touch screen to operate on the assistive touch menu. The remote cannot work on this menu.

7.6 System Settings

7.6.1 Scheduled Startup and Shutdown

- Step 1 Select **Settings > System > Scheduled Startup & Shutdown** to enter the scheduled startup and shutdown settings interface.
- Step 2 Turn on the scheduled startup and/or shutdown function and set up the time.

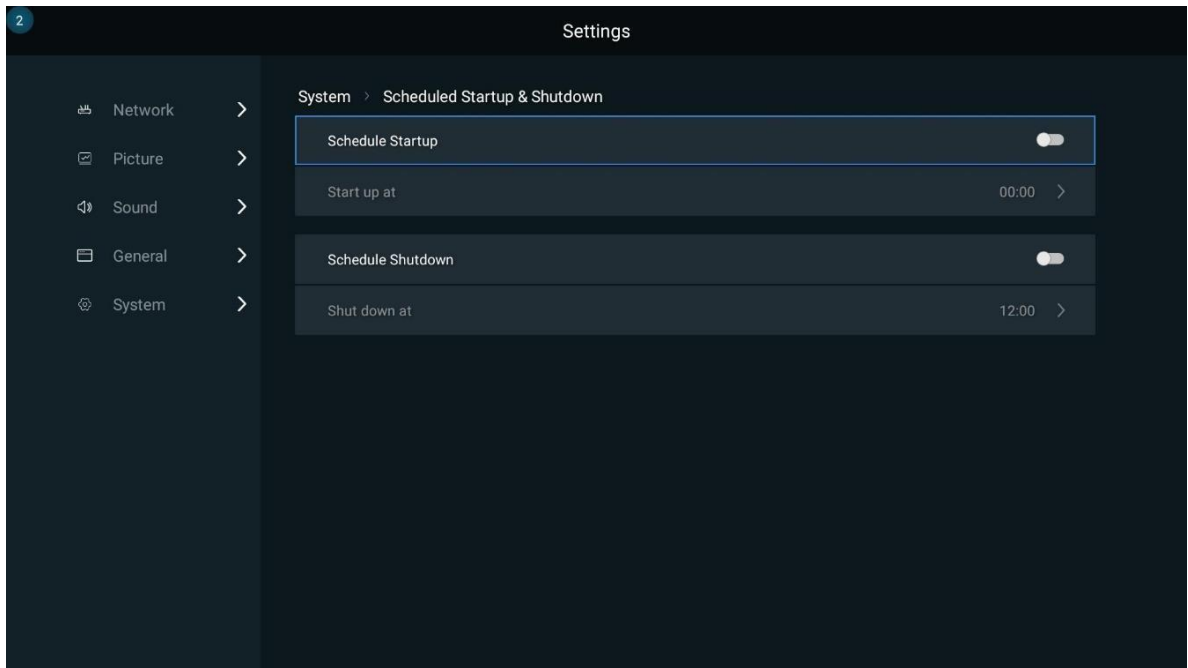

Figure 7-16 Scheduled startup and shutdown

7.6.2 Factory Reset

- Step 1 Select **Settings > System > Factory Reset** to enter the factory reset settings interface.
- Step 2 Press the **Factory Reset** button to reset the system to its factory status.

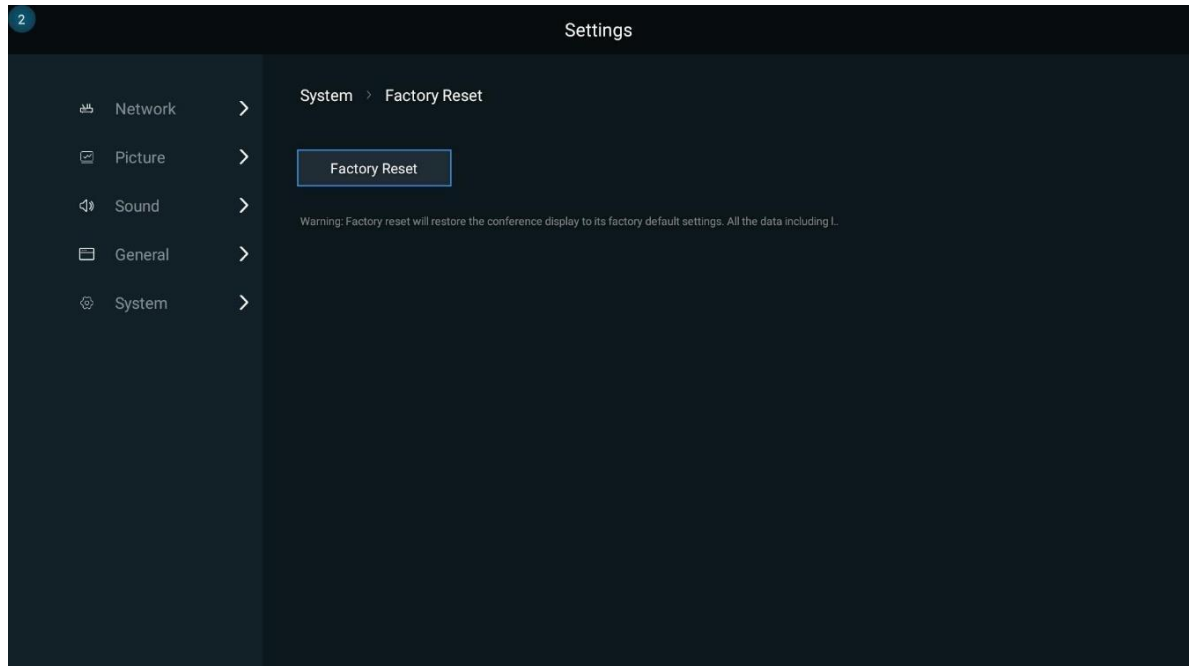

Figure 7-17 Factory reset

*Note:

Factory reset will erase all the data including local documents, images, videos, applications, etc., and the data cannot be recovered.

7.6.3 Android System Update

- Step 1 Select **Settings > System > System Update** to enter the system update interface.
- Step 2 Insert the USB drive that contains the update package into the USB port. (The update package file name is "update_signed.zip" and the package must be placed in the root directory of the USB drive.)
- Step 3 When the screen displays "There are update files in the root directory of the USB flash drive and update is available", press the **Local Update** button.

The update process takes about 3–5 minutes. During the update process, do not power off system, and do not disconnect the USB drive. (These operations are risky and may damage the control card.)

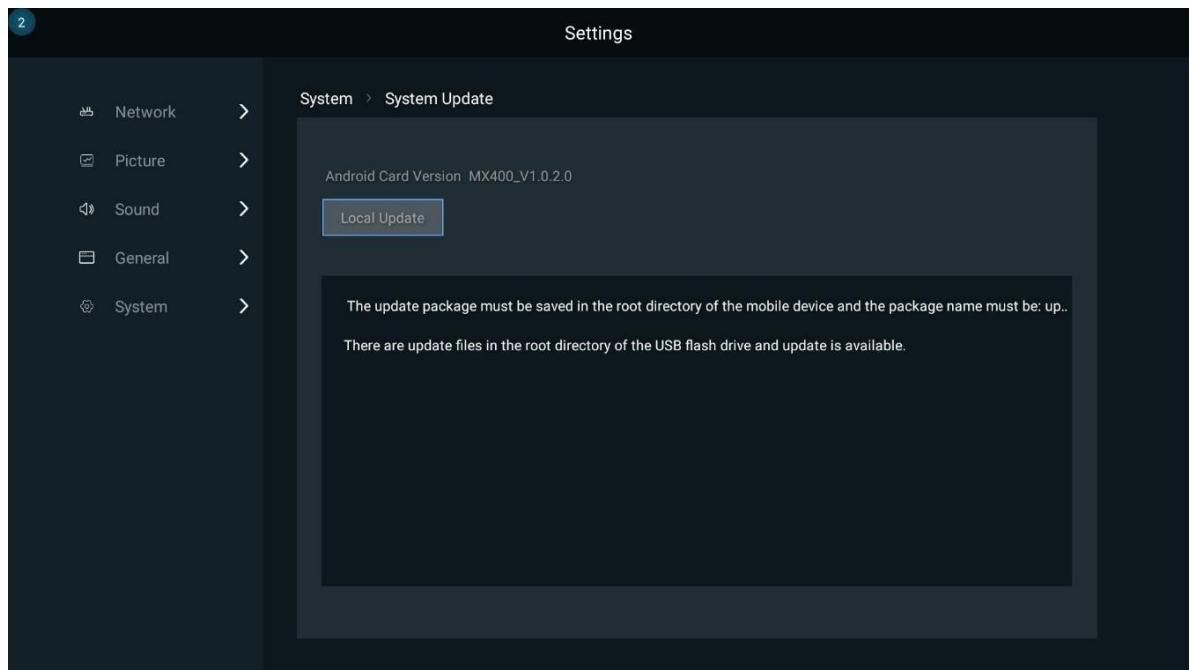

Figure 7-18 System update

7.6.4 About

Select **Settings** > **System** > **About** to enter the **About** interface. Basic system information can be viewed, and the device name can be changed.

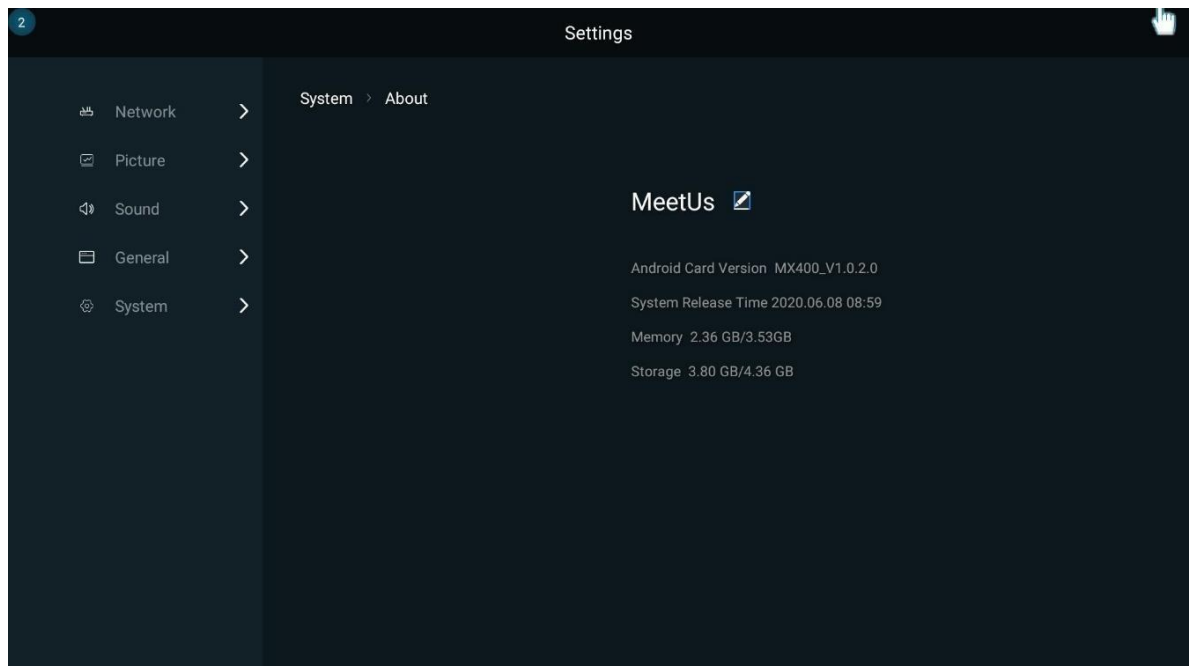

Figure 7-19 About

7.6.5 Switch Ethernet Port

- Step 1 Select Settings > System > Switch Ethernet Port.

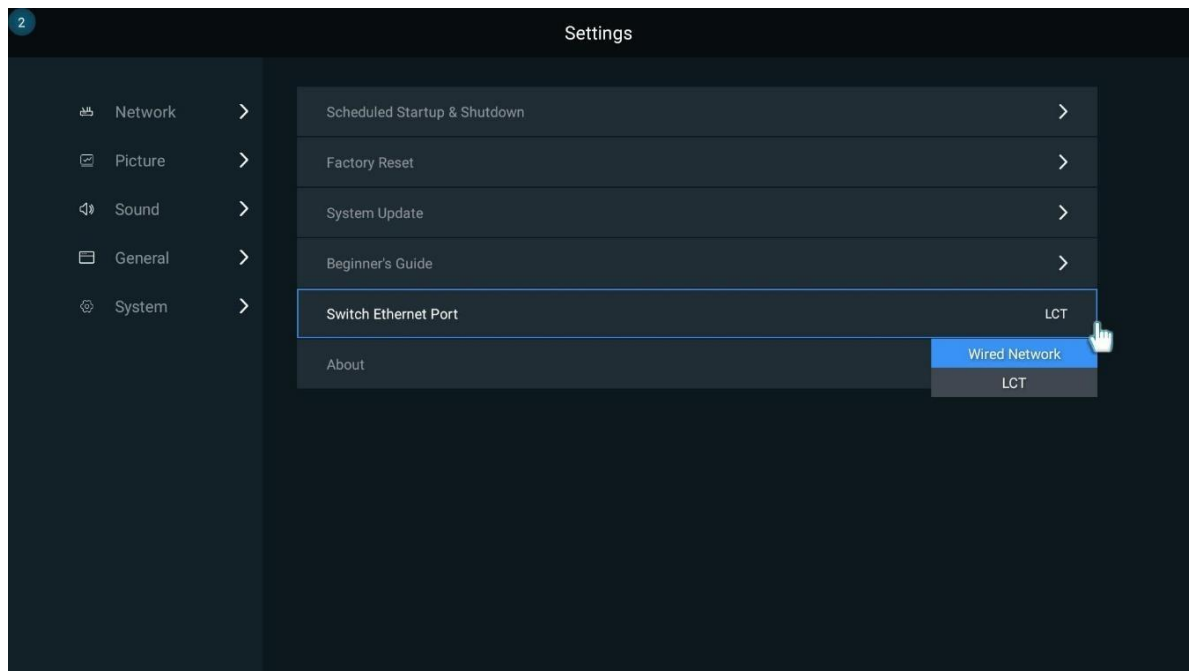

Figure 7-20 Switching Ethernet port

- Step 2 Switch the Ethernet port to **LCT** (default) or **Wired Network**.

If you want to connect the system to the control computer via Ethernet port, switch the Ethernet port to **LCT**.

If you want to use the wired network connection via Ethernet port, switch the Ethernet port to **Wired Network**.

FCC regulatory compliance statement

This device complies with part 15 of the FCC Rules. Operation is subject to the following two conditions: (1) This device may not cause harmful interference, and (2) this device must accept any interference received, including interference that may cause undesired operation.

Caution: Changes or modifications to this unit not expressly approved by the party responsible for compliance could void the user's authority to operate the equipment.

NOTE: This equipment has been tested and found to comply with the limits for a Class A digital device, pursuant to part 15 of the FCC Rules. These limits are designed to provide reasonable protection against harmful interference when the equipment is operated in a commercial environment. This equipment generates, uses, and can radiate radio frequency energy and, if not installed and used in accordance with the instruction manual, may cause harmful interference to radio communications. Operation of this equipment in a residential area is likely to cause harmful interference in which case the user will be required to correct the interference at his own expense..

To satisfy RF exposure requirements, a separation distance of **20** cm or more should be maintained between the antenna of this device and persons during device operation. To ensure compliance, operations at closer than this distance is not recommended.

ISED Regulatory Compliance

This device contains licence-exempt transmitter(s)/receiver(s) that comply with Innovation, Science and Economic Development Canada's licence-exempt RSS(s). Operation is subject to the following two conditions:

- (1) This device may not cause interference.
- (2) This device must accept any interference, including interference that may cause undesired operation of the device.

L'émetteur/récepteur exempt de licence contenu dans le présent appareil est conforme aux CNR d'Innovation, Sciences et Développement économique Canada applicables aux appareils radio exempts de licence. L'exploitation est autorisée aux deux conditions suivantes :

- 1) L'appareil ne doit pas produire de brouillage;*
- 2) L'appareil doit accepter tout brouillage radioélectrique subi, même si le brouillage est susceptible d'en compromettre le fonctionnement.*

This equipment complies with IC RSS-102 radiation exposure limits set forth for an uncontrolled environment. This equipment should be installed and operated with minimum distance 20cm between the radiator and your body.

Cet équipement est conforme aux limites d'exposition aux radiations IC CNR-102 établies pour un environnement non contrôlé. Cet équipement doit être installé et utilisé avec une distance minimale de 20cm entre le radiateur et votre corps.