

Jewenwils

Remote Control Transmitter

Model: MLC18
[Instruction Manual]

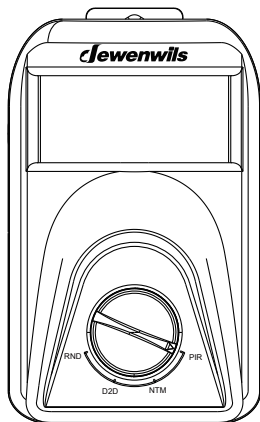

Please pay attention to the warning signs
Read the instructions with caution before operating
and keep it properly

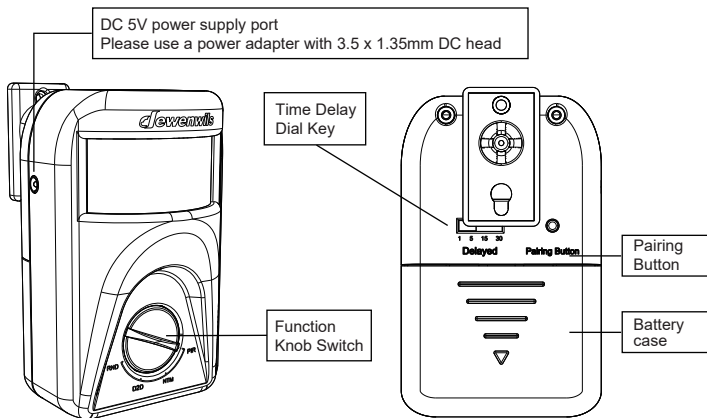

Function Introduction

The motion/light sensor transmitter has the following 4 modes.

PIR	Motion Detection Mode: The receiver will be on whenever the sensor detects motion, whether in day or night.
NTM	Night Time Motion Activation Mode: When the transmitter is in a location with poor light conditions, the receiver will turn on once the sensor detects motion.
D2D	Dusk to Dawn Mode: The receiver will turn on at dusk and off at dawn. Please note the amount of light at the location of the transmitter.
RND	Random Mode: The receiver will randomly turn on and off when the transmitter is in a location with poor light conditions. (Note: the interval between turning on/off is no less than 10 minutes and no more than 2 hours).

Note: To activate the desired function, please rotate the knob switch to the corresponding letter inscribed for that mode.

Method of using time delay function

When using the "PIR" or "NTM" mode, toggle the "Delayed" switch (on the back of the transmitter) to select the amount of time that the receiver can remain on after the last detected motion, 1 minute, 5 minutes, 15 minutes or 30 minutes are available. This switch is inoperative in the "RND" and "D2D" modes.

Operating Instructions

Notes: The receiver must be located within 100 feet of the remote transmitter. Actual functional range may be affected by the following factors: weather, radio frequency interference, low remote battery, and obstructions between the transmitter and receiver.

1. Remove the battery cover on the rear side of the transmitter. Insert 3 "AAA" batteries according to the (+) and (-) instructions on the inside of the battery compartment, and re-install the battery cover. Recommended to use "NiMH batteries"
2. Plug the receiver into a powered outlet.
3. Plug your device into the socket of the receiver.

Mounting the Transmitter Bracket

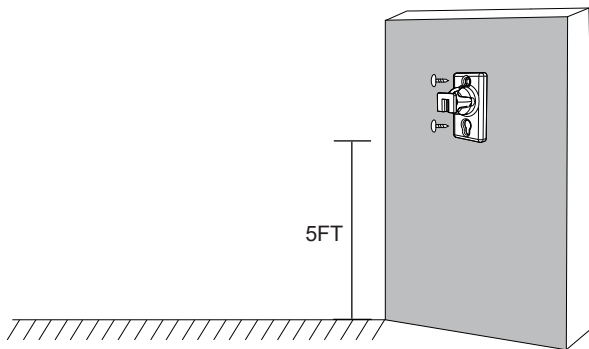

1. Install the transmitter mounting bracket in the desired location with the included screws.

Note: The installation height of the transmitter from the ground should not be less than 3ft and not more than 7ft.

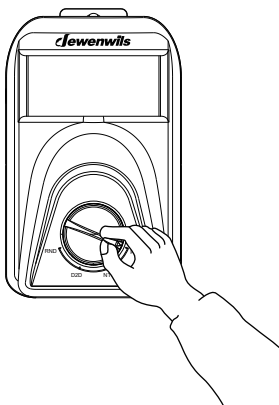

2. Select the desired mode.

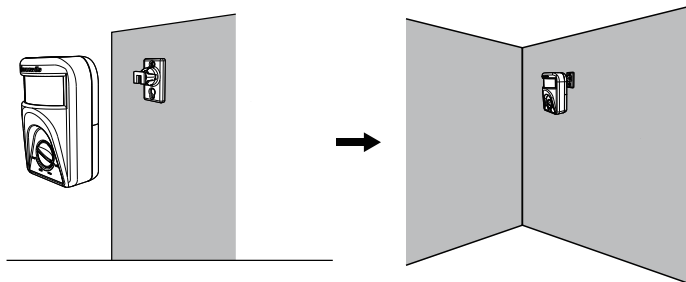

3. Hang the transmitter on the fixed bracket.

Replacing Battery

If you find that the receiver does not work properly or the transmitter does not work, please replace the batteries. Recommended to use "NiMH batteries".

Note:

1. Do not mix old and new batteries.
2. Do not mix Alkaline Batteries, Super Heavy Duty Batteries (Zinc-Carbon) or Rechargeable Batteries (NiCd, NiMH, etc.) together.

Specifications:

- Transmission Frequency: 433.92MHz
- Remote Control Distance: 100 ft (Free Area)
- Detecting Angle: 120°
- Detection distance: 20ft

FCC STATEMENT

This device complies with Part 15 of the FCC rules. Operation is subject to the following two conditions:

1) this device may not cause harmful interference, and 2) this device must accept any interference received, including interference that may cause undesired operation.

Changes or modifications not expressly approved by the party responsible for compliance could void your authority to operate the equipment.

NOTE: This equipment has been tested and found to comply with the limits for a Class B digital device, pursuant to Part 15 of the FCC Rules. These limits are designed to provide reasonable protection against harmful interference in a residential installation.

This equipment generates uses and can radiate radio frequency energy and, if not installed and used in accordance with the instructions, may cause harmful interference to radio communications. However, there is no guarantee that interference will not occur in a particular installation. If this equipment does cause harmful interference to radio or television reception, which can be determined by turning the equipment off and on, the user is encouraged to try to correct the interference by one or more of the following measures:

- Reorient or relocate the receiving antenna.
- Increase the separation between the equipment and receiver.
- Connect the equipment into an outlet on a circuit different from that to which the receiver is connected.
- Consult the dealer or an experienced radio/TV technician for help.

FCC Radiation Exposure Statement:

This equipment complies with FCC radiation exposure limits set forth for an uncontrolled environment.

ISED Warning:

This device complies with Innovation, Science, and Economic Development Canada licence-exempt RSS standard(s). Operation is subject to the following two conditions:

- (1) this device may not cause interference, and
- (2) this device must accept any interference, including interference that may cause undesired operation of the device.

Le présent appareil est conforme aux CNR d'Innovation, Sciences et Développement économique Canada applicables aux appareils radio exempts de licence. L'exploitation est autorisée aux deux conditions suivantes :

- (1) l'appareil ne doit pas produire de brouillage, et
- (2) l'utilisateur de l'appareil doit accepter tout brouillage radioélectrique subi, même si le brouillage est susceptible d'en compromettre le fonctionnement.

The device is compliance with RF exposure guidelines, users can obtain Canadian information on RF exposure and compliance.

Le présent appareil est conforme

Après examen de ce matériel aux conformité ou aux limites d'intensité de champ RF, les utilisateurs peuvent sur l'exposition aux radiofréquences et la conformité and compliance d'acquérir les informations correspondantes.

One Year Limited Warranty

Supported by our professional R&D team and QC team, we provide One Year Warranty for materials and workmanship from the purchase date. Please note that the warranty does not cover damage caused by personal misuse or improper installation.

Please attach your Order ID and Name so that our dedicated customer service team can help you better.