



Model No: TSB7600

User Guide

Specifications:
 Capacity:12000mAh
 Cell: Li-Polymer, Grade A
 Transmission Distance: ≤6mm
 Charging Efficiency: ≥70%
 Size: 150*77*19mm
 Weight:288g
 Input Voltage: Micro: 5V/2A ,9V/2A ; Type C : 5V/2.5A,9V/2A
 Output Voltage: 5V/3.1A, 9V/2A,12V/1.5A
 Wireless Output Voltage: 5V/1A; 9V/1.12A
 Wireless Power: 10W/7.5W/5W

- ①Transmitter Coil Area
- ②Wireless Charging Status Indicator
- ③Switch
- ④Power Level Indicator
- ⑤Micro Input
- ⑥Type-C Input/Output
- ⑦USB Output

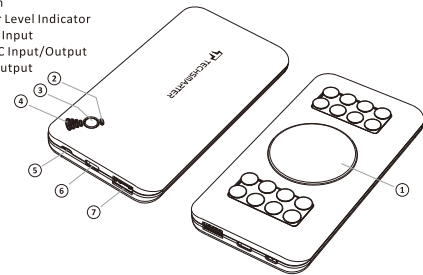

How to Use

Charging your Wireless Power Bank

- 1.Insert USB cable USB A end into power adapter.
- 2.Plug power device into DC power socket.
- 3.Plug the end of the Micro USB data cable into the Input port of the product. The blue light flashes to indicate the current power level.

Remark: please use the adapter & data cable could support AFC or PD at least if max output required

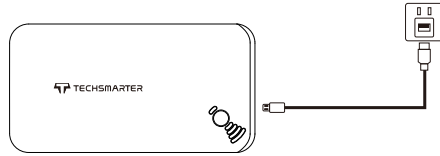

Battery Indicator

● 1	● 2	● 3	● 4
0%-25%	25%-50%	50%-75%	75%-100%

Charging Your Device

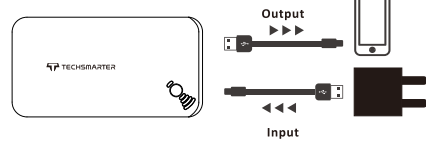

USB port Schematic for regular charging and discharging

- 1.Insert the USB data cable USB A end into Output.
- 2.Plug the other end of the cable into a device such as a mobile phone.
- 3.Click the switch button and the power is discharged to charge the device such as a mobile phone and the blue light flashes. The red light is on, indicating wireless charging standby.

Wireless discharging

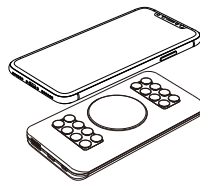

- 1.Make sure there isn't any foreign object attached to the back of the phone, such as a ring holder or metal plate. A case is not a foreign object.
- 2.Click the switch and the red light is on, indicating wireless charging standby to charge the device such as a mobile phone.
- 3.Place a mobile phone or other compatible device that complies with the Qi protocol on the mobile power supply to achieve wireless charging. Note that the center of the mobile phone's receiving coil must coincide with the transmitting coil of the product, and the green light indicates wireless charging.

Accessories:

- Wireless Power Bank*1
- Micro USB Charging Cable*1
- USB C Cable*1
- User Manual*1

Indicators:

Blue light flashes: charging
 Blue light on: discharging

Red light on: wireless charging stand-by
 Green light on: wireless charging
 Red and Green light fast blink: abnormal operation

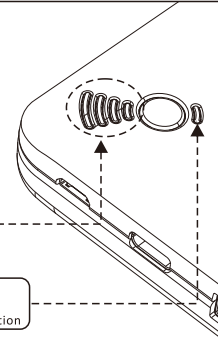

Warning



One Year warranty

Customer Support:
Support@techsmarterusa.com

www.techsmarterusa.com

FCC Statement

Changes or modifications not expressly approved by the party responsible for compliance could void the user's authority to operate the equipment.
 This equipment has been tested and found to comply with the limits for a Class B digital device, pursuant to Part 15 of the FCC Rules. These limits are designed to provide reasonable protection against harmful interference in a residential installation. This equipment generates uses and can radiate radio frequency energy and, if not installed and used in accordance with the instructions, may cause harmful interference to radio communications. However, there is no guarantee that interference will not occur in a particular installation. If this equipment does cause harmful interference to radio or television reception, which can be determined by turning the equipment off and on, the user is encouraged to try to correct the interference by one or more of the following measures:
 -- Reorient or relocate the receiving antenna.
 -- Increase the separation between the equipment and receiver.
 -- Connect the equipment into an outlet on a circuit different from that to which the receiver is connected.
 -- Consult the dealer or an experienced radio/TV technician for help
 This device complies with part 15 of the FCC rules. Operation is subject to the following two conditions (1) this device may not cause harmful interference, and (2) this device must accept any interference received, including interference that may cause undesired operation.