

# REMOTE DOG TRAINING COLLAR

## USER MANUAL

GE-G21/GE-G22

 Please Read Page Right









GE-G21/GE-G22

### Specifications

Product name : Dog training collar  
Product model : GE-G21/GE-G22  
Material: ABS  
Battery capacity: remote control 500 mAh; receiver 300mAh  
Charging voltage: 5V/1A  
Charging time : 1.2 hours  
Charging port: Type-c USB  
Operate range: 2600FT  
Remote control frequency: 433M FSK  
Operating temperature: 32-104 , <95%RH  
Standby time: 20 days for remote control; 10 days for receiver.  
Receiver sensitivity: -126DBm  
Endurance: 6H continuously working  
Working temperature: -30 C - 70 C  
Storage temperature: -30 C - 85 C  
Scope of application: all kinds of dogs

Design by Vsezund and Manufactured in China

## Contents

 Important Safety Information	1
 What's in The Box	2
 Learn about Your Remote	3
 Learn about Your Collar	4
 How to Operate	5
 Main Features	6
 FAQ	7
 How to Train	8 9
 Certification Statements	10 11

## Important Safety Information

### WARNING

#### Warning and Caution

1. Please use the device when the pet is under control in a safe area.
2. Do not use it on aggressive dogs.
3. The device is used for healthy dogs only.
4. It should be wore for less than 12 hours every day. Please take the collar off every 2 hours if conditions permit.
5. Please do not tie the leash to the receiving collar.
6. If your dogs are allergic to the contact point of collar or feel uncomfortable wearing collar, please stop using it and consult a veterinarian.
7. This product is only suitable for training, and remember that animal cruelty is prohibited.
8. When the collar is turned on, the human body should not directly touch the E-Shock contact of the product.

## What's in The Box

### Components

#### Components Name

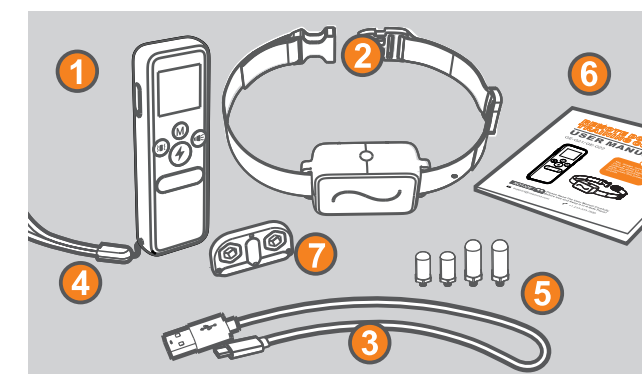

1. Training Remote
2. Training Receiver (Collar)
3. Type C USB Charging Cable
4. Wrist Strap
5. Long and Short E-Shock Probes
6. User Manual
7. Test Unit & Probe Driver

\* The shorter E-Shock probe has been assembled on the collar.

## Learn about Your Remote

### Introduction of Components

#### Training Remote

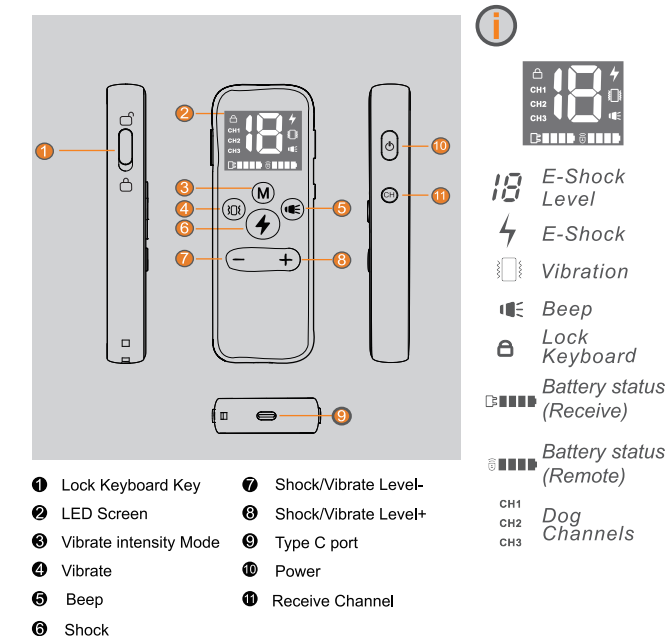

- 1 Lock Keyboard Key
- 2 LED Screen
- 3 Vibrate intensity Mode
- 4 Vibrate
- 5 Beep
- 6 Shock
- 7 Shock/Vibrate Level-
- 8 Shock/Vibrate Level+
- 9 Type C port
- 10 Power
- 11 Receive Channel

## Learn about Your Collar

### Introduction of Components

#### Training Receiver

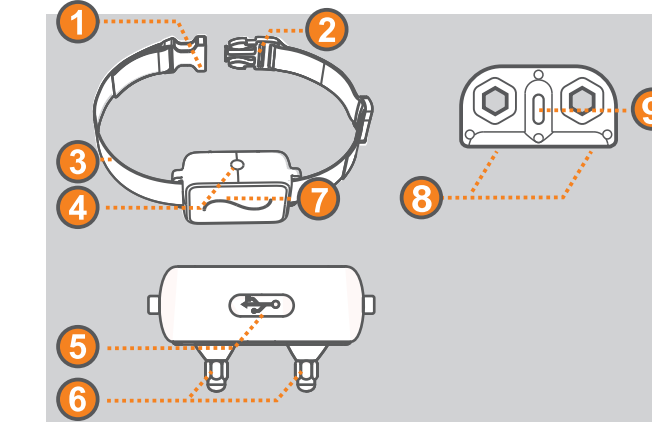

1. Buckle
2. Slider Buckle
3. Adjustable Strap
4. Power ON&OFF / Pairing Key
5. USB Charging
6. E-Shock Probe
7. LED Indicator
8. Test Contact
9. Test Light

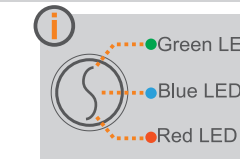

## How to Operate

### Pairing operation

#### Pairing Operation

Tips: In the 1-pair package, the receiver and controller are already paired on dog channel 1 by default.

1. Operate the remote: press CH button to select the channel you need.
2. Operate the receiver: Briefly press the power button twice, till the light turned blue and start flashing.
3. Operate the remote: Press vibrate, beep or shock button to finish the pairing.
4. When the blue light turned off means the pairing has done.
5. Change the channel: If you want to change the receiver's channel, please repeat the above procedure.

#### CUSTOMER SUPPORT

+1 213-373-7686  
support@vsezund.com  
www.vsezund.com

#### SUPPORT HOURS

Monday - Friday  
9:00 am - 6:00 pm



Operation Video

## Main Features

### Main Features Introduction

#### 3 Basic Training Methods

**BEEP Training:**  
one-key execution, no level setting. The intensity of the BEEP is fixed and cannot be changed.

**Vibration Training:**  
one-key execution, 8-level setting.

**E-Shock Training:**  
one-key execution, 18-level setting.

#### Main Features

1. The remote control distance range is 2600FT (the maximum effective range of barrier-free area).
2. A remote controller can control up to 3 receiving collars
3. The adjustable gears of electric shock strength are 0-18, and the adjustable gears of vibration strength are 1-8.
4. Dual battery power display. The remote controller can remotely receive and display battery power of the collar.
5. The key lock function of the remote controller is to prevent the key from triggering by mistake when it is put into the pocket.
6. The waterproof level of receiving collar is IPX7 (the remote control is not waterproof), but it is not recommended for dogs to swim with collars.
7. Please do not test electric stimulation with human body.

## FAQ

### Frequently Asked Questions

#### FAQ

- Q:** Is the static stimulation safe for my pet?  
**A:** While the stimulation is unpleasant, it is harmless to your pet.
- Q:** Why doesn't the pet respond when operating the remote control?  
**A:** There may be two reasons. First, beep and vibration are not enough to stimulate the pet; second, the collar is loose, and the webbing needs to be tightened to make the contacts touch the skin.
- Q:** Once my pet is trained and has been obeying my commands, will he have to continue to wear the training collar?  
**A:** Probably not. They may need to wear the training collar from time to time for reinforcement.
- Q:** Why do many similar products cause a more serious sores on the dog's neck?  
**A:** This phenomenon is not caused by E-Shock current, but a kind of "pressure necrosis". The reason is that wearing the collar for a long time or even using the receiver collar as a matching collar, causes the receiver probes to compress or wear the skin for a long time, eventually leading to a severe sores. **Please follow the wearing time requirements of the instructions and other related warnings.**

## How to Training

### Find the Best Stimulation Level for Your Pet

#### Training Tips

**Important: Always start at the lowest level and work your way up.**

- The Remote Trainer has 1 tone, 1 vibration and 16 E-Shock levels. This allows you to choose the E-Shock level that is best for your pet. We recommend training with tone and vibration, or the lower levels of E-Shock when needed. In most cases E-Shock levels 1-7 will be adequate for your training needs. Once you have placed the training collar on your pet, it is time to find the "recognition level". The "recognition level" is the stimulation level that your dog begins to notice. It should not make your pet uncomfortable.
- Follow the steps below to find your pet's recognition level:
  1. Choose level 1, and press E-Shock button continuously for 1 to 2 seconds. A slight change in your pet's behavior, such as looking around in curiosity, scratching at his collar, or flicking his ears, indicates the Recognition Level that is best for him.
  2. If your pet shows no reaction, repeat this several times before moving to high E-Shock level.
  3. Choose level 2 and press E-Shock button continuously for 1 to 2 seconds.
  4. If your pet shows no reaction, repeat this level several times before moving up to the next level.
  5. Move up through the E-Shock levels until your pet reliably responds to the shock.
  6. If your pet continues to show no response at Level 16, check the fit of the training collar. See "page 19". You might also want to test it on your hand at a lower level to ensure the collar is working.

## How to Training

### Find the Best Stimulation Level for Your Pet

#### Training skill

1. Please use the device in a safe area and quiet environment.
2. Please cooperate with oral language and gesture prompts during training.
3. Please comfort your pet when it is uncomfortable during training, and praise him when it behaves well.
4. Please use vibration mode for training first, and electric stimulation is used only when the vibration effect is not enough.
5. The training time should not be too long. Please carefully control the times of electric stimulation. If the pet feels uncomfortable, please stop using it.

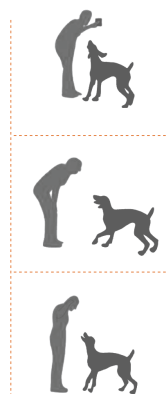

## Certification Statements



This device complies with Part 15 of the FCC Rules. Operation is subject to the following two conditions:  
(1) This device may not cause harmful interference, and  
(2) This device must accept any interference received, including interference that may cause undesired operation.  
**Warning: Changes or modifications not expressly approved by the party responsible for compliance could void the user's authority to operate the equipment.**  
**Note:** This equipment has been tested and found to comply with the limits for a Class B digital device, pursuant to Part 15 of the FCC Rules. These limits are designed to provide reasonable protection against harmful interference in a residential installation. This equipment generates uses and can radiate radio frequency energy and, if not installed and used in accordance with the instructions, may cause harmful interference to radio communications. However, there is no guarantee that interference will not occur in a particular installation. If this equipment does cause harmful interference to radio or television reception, which can be determined by turning the equipment off and on, the user is encouraged to try to correct the interference by one or more of the following measures:

- Reorient or relocate the receiving antenna.
- Increase the separation between the equipment and receiver.
- Connect the equipment into an outlet on a circuit different

## Certification Statements



from that to which the receiver is connected.  
• Consult the dealer or an experienced radio/TV technician for help.



The company declares under its own responsibility that this product complies with the basic requirements of CE (2014/30/EU) and RoHS (2011/65/EU). Without the approval of our company or the distributor, unauthorized changes or modifications to the equipment may violate the CE regulations, may cause the user to lose the right to operate the equipment, and invalidate the warranty.



#### Recycling Information & Battery Disposal

Please observe the regulations for electronic and electrical devices to be disposed of in the respective country. In some countries or regions this device must be recycled. If this device is no longer required, it must not be disposed of with normal municipal waste. Separate collection of spent batteries is required in many regions; check the regulations in your area before discarding spent batteries. For more recycling information, please refer to local regulations.