

Baseus AirGo AG20 Open-Ear Earbuds

User Manual

Please read this user manual carefully before using the product and keep it in a safe place.

Quick Start

1. Power On:

For the first power-on: Open the charging case, remove the insulation sticker from the charging contacts on the earphones, and place the earphones back into the charging case. The earphones will automatically enter pairing mode. **Subsequent power-on:** Open the charging case. The earphones will automatically enter pairing mode.

2. Bluetooth Pairing: Open the Bluetooth settings on your phone and select the device Name: Baseus AirGo AG20. Once the connection is successful, you can use it normally.

Quick controls

Play/Pause: Double-tap the left ear or right ear (L or R)

Previous track: Long press for 1.5 seconds on the left ear (L)

Next track: Long press for 1.5 seconds on the right ear (R)

Activate smartphone voice assistant: Triple-tap the left ear or right ear (L or R)

触摸功能区域
耳机指示灯
充电仓指示灯
麦克风孔
出音孔
充电触点
Type-C 充电接口

Touch function area
Headphone indicator light
Charging case indicator light
Microphone
Audio output
Charging contacts
Type-C charging port

APP Download

You can use the "Baseus" app to customize button settings, switch modes, and access more features.

Scan the QR code below to quickly download the app, or search and download it from your phone's app store.



Power Off and Factory Reset

Power Off: Place the earbuds back into the charging case, close the lid, and the power off process is complete.

Factory Reset: Open the charging case lid, take out the earbuds from the case, tap the touch area of the left or right earbud 5 times. The red and white indicator lights will flash simultaneously 3 times to indicate that the factory reset is successful.

Wearing the Product

Before wearing, please confirm the "L" and "R" markings on the earbuds. "L" denotes the left ear and "R" denotes the right ear.

When wearing, use your fingers to slightly extend the earhook and hang it on your ear by following the rear end of the earhook. You can adjust the angle of the earhook based on your actual wearing situation to ensure a secure and comfortable fit.

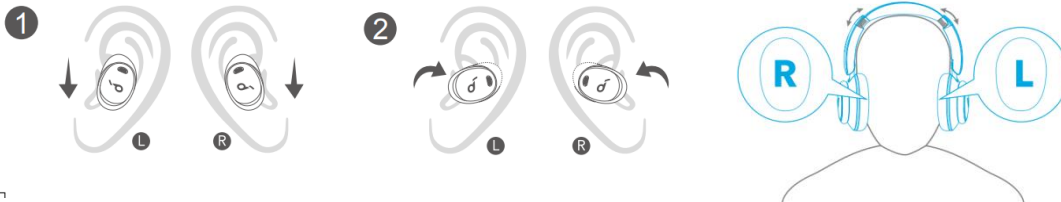

Operating Functions

Phone Mode

Answer/End call: Double-tap left ear or right ear (L or R)

Reject call: Long press left ear or right ear (L or R) for 1.5 seconds

Battery Indicator

Charging the earbuds in the charging case: The charging case's white light will flash and then turn off after 10 seconds.

Charging the charging case by connecting to a power source:

During charging, the charging case's white light will run from left to right once in a marquee motion, followed by the current battery level light flickering. (For example, if the battery level is at 40%, the first light will be on steadily, and the second light will be blinking.)

When fully charged, the indicator light will display a steady white light.

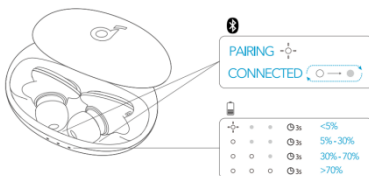

Low Latency

For the first use, you need to manually enable or disable it in the "Baseus" app.

Instructions for using the app and its security:

1. You can customize the keys within the app.
2. Please use the search function within 35 hours to locate the headphones.
3. When the app's headphone search function is activated, the headphones will emit a buzzing alarm. Do not use them while wearing them to avoid any impact on your hearing.

Note: To enter the settings, open the app, go to "App Start Management," and manually enable the following options for the "Baseus" app: allow auto-start, allow associated start, allow background activity.

部件名称	有害物质或元素					
	铅 (pb)	汞 (Hg)	镉 (Cd)	六价铬 (Cr VI)	多溴联苯 (PBB)	多溴二苯醚 (PBDE)
PCB	X	O	O	O	O	O
塑料	O	O	O	O	O	O
电池	O	O	O	O	O	O
附件	O	O	O	O	O	O
充电线	X	O	O	O	O	O

本表格依据 SJ/T 11364 的规定编制。

O: 表示该有害物质在该部件所有均质材料中的含量均在 GB/T 26572 标准规定的限量要求以下。

X: 表示有害物质至少在该部件某一均质材料中的含量超出 GB/T 26572 标准规定的限量要求。

该产品符合欧盟 RoHS 2.0 指令 (2011/65/EU)

温馨提示: 5 年图标是指“环保有效使用期限”, 不是产品质量保证期限。电子产品均含有铅、汞、镉等有害物质, 一旦超期使用, 有害物质将可能因为发生外泄或突变, 对环境造成污染, 或对人体及人身财产造成严重损害。“环保使用期限”, 意为所有的电子产品都将被要求在此有效限期内使用, 超过安全使用年限之后出现的安全风险问题, 我们将不再对产品质量负责。

Product safety information:

Please read all instructions and warnings before using this product. Improper use may cause damage to the product or personal safety.

- This product contains a battery. Do not expose it to strong sunlight or high-temperature environments such as near a heater. Do not store it in high temperatures, intense light, or strong magnetic fields.
- Do not place the product in harsh environments near fire sources. Do not knock, throw, step on, crush, or put it into the fire. If there is swelling, do not use it.
- The recommended operating temperature for the product is 0~40°C.
- Do not use the product improperly in violation of the product manual, as it may cause damage to the product or endanger personal and property safety. You will be held responsible for any consequences.
- Non-professionals are strictly prohibited from disassembling the product, as it may cause fire or permanent damage to the product.
- Do not exceed the output current load (electrical appliances) of this product. Exceeding the load will automatically stop the operation.
- Regularly clean the charging contacts on the headphones with a clean cotton cloth to prevent charging or start-up issues caused by long-term lack of cleaning.
- Do not submerge this product in water (or washing machine). If the headphones are damaged due to personal reasons, you will be responsible for the consequences, and the company will not provide after-sales return or exchange services.

Product Specifications:

Product Name: Baseus Open-ear True Wireless Earbuds

Model: Baseus PM66-A

Material: ABS+PC+Silicon

Bluetooth Version: V5.3

Communication Distance: 10 meters

Music Playtime: Approximately 6 hours (at 50% volume)

Music Playtime with Charging Case: Approximately 26 hours

Battery Capacity: 90mAh/0.33Wh (earbuds), 1000mAh/3.7Wh (charging case)

Earbuds Rated Input: 5V DC 120mA

Charging Case Rated Input: 5V DC 1000mA

Earbuds Rated Power Consumption: 15mA

Charging Case Rated Power Consumption: 360mA

Charging Time: Approximately 2 hours

Frequency Range: 20Hz-20kHz

Charging Interface: Type-C

Compatibility: Devices with Bluetooth functionality

FCC ID: 2A482-PM66-A

Contents:

Earphone Charging Case ×1

Earbuds (Left and Right) ×2

Charging Cable ×1

User Manual ×1

Warranty Card ×1

This device complies with Part 15 of the FCC Rules. Operation is subject to the following two conditions: (1) this device may not cause harmful interference, and

(2) this device must accept any interference received, including interference that may cause undesired operation.

Any Changes or modifications not expressly approved by the party responsible for compliance could void the user's authority to operate the equipment.

This equipment has been tested and found to comply with the limits for a Class B digital device, pursuant to part 15 of the FCC Rules. These limits are designed to provide reasonable protection against harmful interference in a residential installation. This equipment generates, uses and can radiate radio frequency energy and, if not installed and used in accordance with the instructions, may cause harmful interference to radio communications. However, there is no guarantee that interference will not occur in a particular installation. If this equipment does cause harmful interference to radio or television reception, which can be determined by turning the equipment off and on, the user is encouraged to try to correct the interference by one or more of the following measures:

- Reorient or relocate the receiving antenna.**
- Increase the separation between the equipment and receiver.**
- Connect the equipment into an outlet on a circuit different from that to which the receiver is connected.**
- Consult the dealer or an experienced radio/TV technician for help.**

The device has been evaluated to meet general RF exposure requirement. The device can be used in portable exposure condition without restriction.