

Manual Book

Product number: JX-01

Product name: Modern led ceiling light

WARNING: General Safety Instructions

- Install the segments on a hard and level surface to avoid damage.
- To avoid electric shock, the power must be turned off during the whole installation or future cleaning.
- Do not disassemble, refit or hit the components.
- For better installing experience, please read the instructions below.

Components

1 Segments



actual quantity and shape of segments depends on specific orders.

2 Drive & Connector

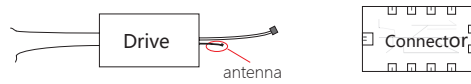

actual ports on drive and connector depends on the specific orders.

3 Cross base & Holder

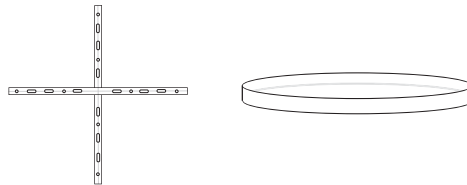

4 Screws for connecting

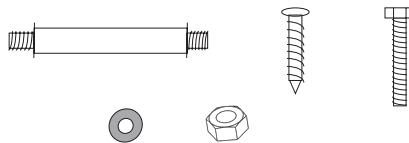

Warranty Policy

Dear User,

Thank you very much for buying our product.

During installation or using, you will be so welcome to contact us if there is any problem or uncertainty.

Warranty Coverage:

- 1, any damages caused by shipping.
- 2, functional failures on different components.
- 3, missing components caused by packaging.
- 4, wrong items being sent, delivery time out.

Installation Steps

1

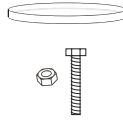
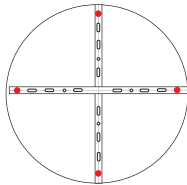

take the holder as reference to install the screws as the four red spots.
DO NOT fasten the screws.

2

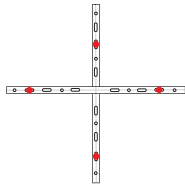

install the cross base to the top, keep the four screws input at step 1.

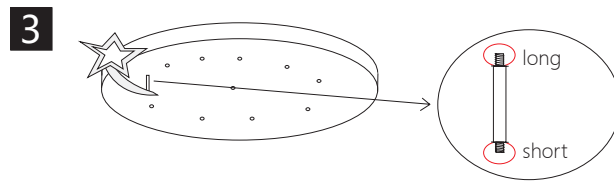
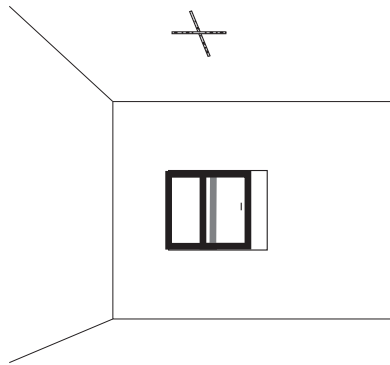

long side connects to the holder, and short side connects to the segments, wire gets through h this vibe.

install the segments to the holder one by one.
make sure that each segment' s wire get
through the holder as below:

connect the adapter to the drive
(the only bigger port on the adapter)

connect the wire of segments to the rest
ports of adapter

note: there may be extra ports on both the
adapter and drive.

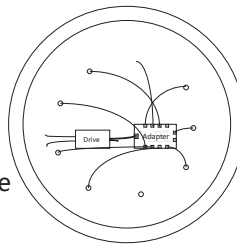

4

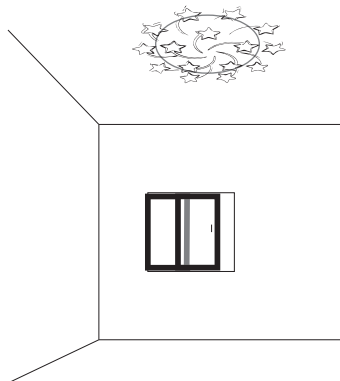

after installation, lift up the segments with with the
holder, fasten the four screws on the cross
base, connect the wire on the drive.

APP download

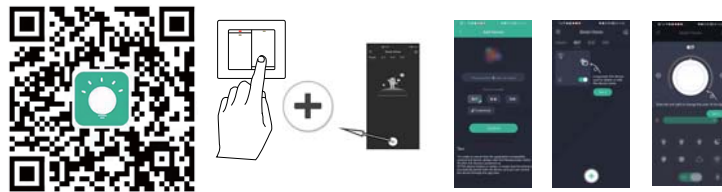

1 scan the QR Code, download the app and install in phone

2 turn on the light and search the light in the app, pair them

3 set a scene for the light where it's installed, such as living room, bedroom, then follow the popping up tips to finish the pairing

Remote Control

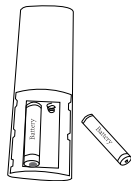

Step 1,

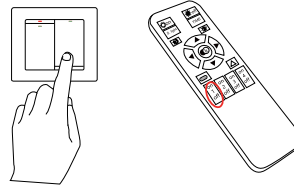

Step 2,
turn on the light and press the “ON 1

FCC Warning Statement

Changes or modifications not expressly approved by the party responsible for compliance could void the user's authority to operate the equipment. This equipment has been tested and found to comply with the limits for a Class B digital device, pursuant to Part 15 of the FCC Rules. These limits are designed to provide reasonable protection against harmful interference in a residential installation. This equipment generates uses and can radiate radio frequency energy and, if not installed and used in accordance with the instructions, may cause harmful interference to radio communications. However, there is no guarantee that interference will not occur in a particular installation. If this equipment does cause harmful interference to radio or television reception, which can be determined by turning the equipment off and on, the user is encouraged to try to correct the interference by one or more of the following measures:

- - Reorient or relocate the receiving antenna.
- - Increase the separation between the equipment and receiver.
- - Connect the equipment into an outlet on a circuit different from that to which the receiver is connected.
- - Consult the dealer or an experienced radio/TV technician for help.

This device complies with part 15 of the FCC Rules. Operation is subject to the following two conditions: (1) This device may not cause harmful interference, and (2) this device must accept any interference received, including interference that may cause undesired operation.

RF Exposure Statement

To maintain compliance with FCC's RF Exposure guidelines, This equipment should be installed and operated with minimum distance of 20cm the radiator your body. This device and its antenna(s) must not be co-located or operation in conjunction with any other antenna or transmitter