

IMPORTANT SAFETY PRECAUTIONS

- Do not operate mobile equipment while driving a motorized vehicle – safe driving and safety consideration of others should always be your highest priority.
- In the event you should notice smoke, strange noises or odor from this product, or any other abnormal signs, immediately turn off the power and consult your dealer. Using this product in this condition may result in permanent damage to the system.
- Set your volume control at a low setting, then slowly increase the sound until you can hear it comfortably without distortion, or ear discomfort.

Be sure to observe the following guidelines:

Do not turn up the volume so high, otherwise you can't hear what's around you.

Use caution or temporarily discontinue use in potentially hazardous situations.

INSTALLATION PRECAUTIONS

- Do not attempt to service this product by yourself. Installation or servicing of this product by persons without professional training and experience in electronic equipment and motorized vehicle accessories may be dangerous and could expose you to the risk of electric shock, injury or other hazards.
- When wiring directly to the vehicles battery, be sure to disconnect the batteries negative terminal wire before starting any wiring procedures.
- The speaker has a weather resistant design, it should not be under any circumstances submerged in, or under water.
- Use only the supplied installation parts provided with the speaker.
- Wipe a mild detergent and lukewarm water using a clean sponge or a soft cloth.

PRODUCT INFORMATION:

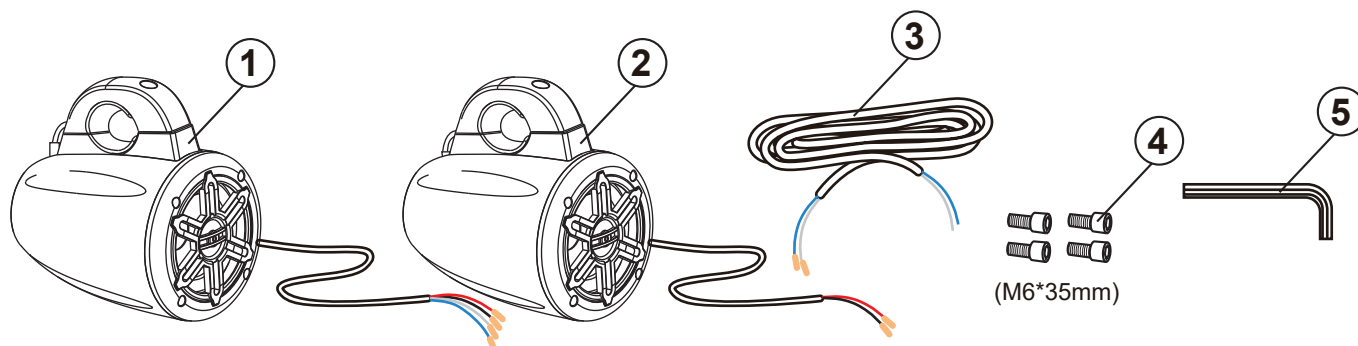

INSTALLATION TIPS:

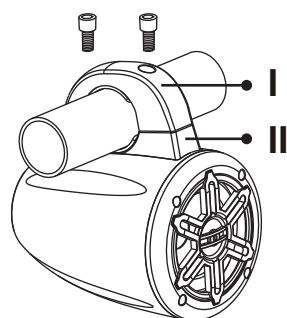

- I. The base of the bracket.
- II. The cover of the bracket, is fixed by 2 mounting screws.

Mounting hole dimension

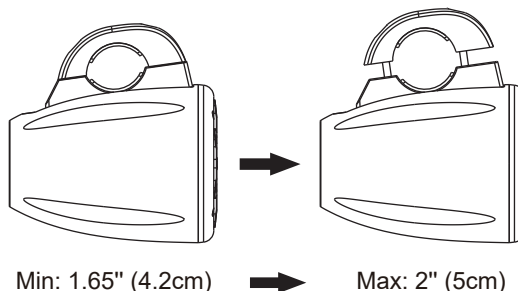

WIRE DIAGRAM

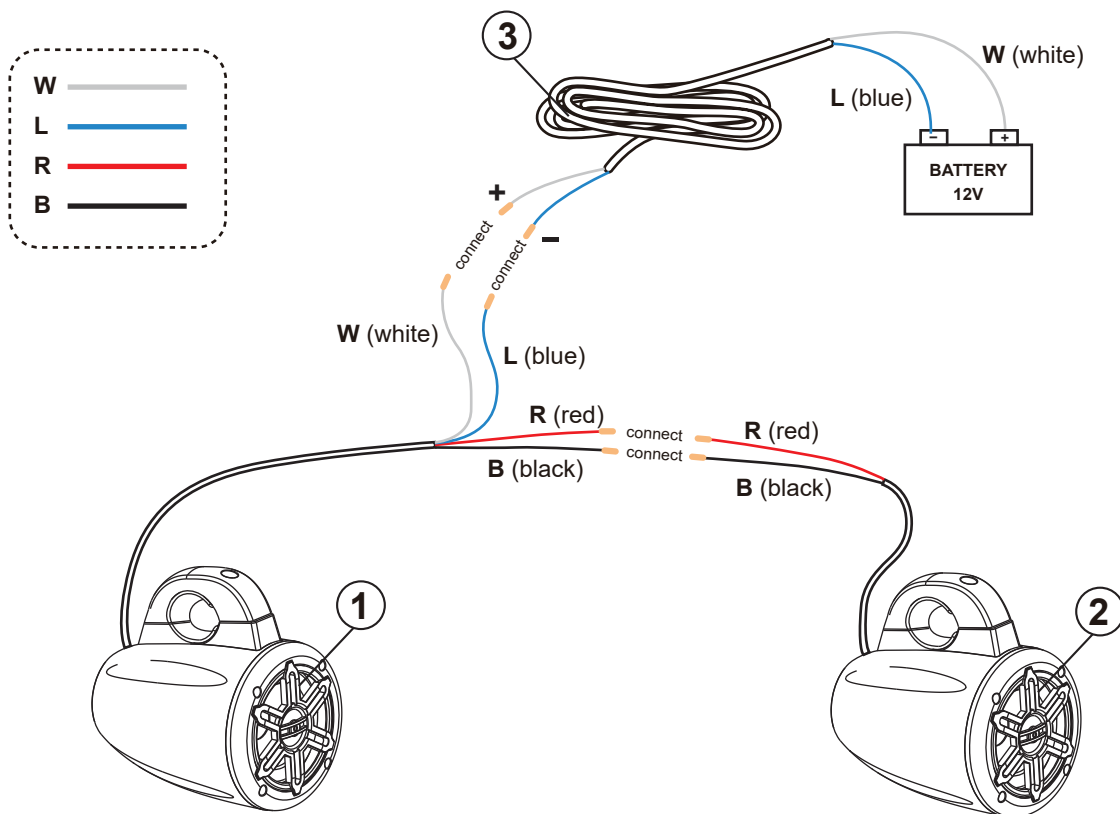

- As shown in pictures, W / L is DC 12V power.
- As shown in pictures, connect the Positive Pole and the Negative Pole respectively of two speakers (R to R), (B to B).

BLUETOOTH OPERATION

Pairing & discovering a new bluetooth connection

- 1) Power on the speaker, a tone will be heard, signalling that the speaker is now ready for Bluetooth pairing. The speaker is now ready for Bluetooth pairing.
- 2) The speaker is now in pairing mode:

ANDROID users:

- a. Go into the Settings Menu of your device.
- b. Enter the Bluetooth Menu.
- c. TURN ON Bluetooth and press SCAN.
- d. "KEMIMOTO" will now be displayed under available devices.
- e. If prompted, enter passcode: "0000".

iOS users:

- a. Go into the Settings Menu of your iOS device.
- b. Enter the Bluetooth Menu.
- c. TURN ON Bluetooth.
- d. "KEMIMOTO" will now be displayed.
- e. If prompted, enter passcode: "0000".

- 3) If KEMIMOTO is not seen, repeat the above steps to refresh the "Device List".
- 4) When the connection is successful a tone will be heard.

Note:

- Using this product without running the engine can drain the battery.
- To avoid battery exhaustion, be sure to occasionally run the vehicles engine while using this product.

Reconnection

- 1) Power on the speaker and your last paired device Bluetooth.
- 2) Ensure you are within range of the speaker, the unit will now automatically reconnect.
- 3) If the device is out of range from the speaker, it will disconnect automatically.
- 4) If your device was previously paired with the speaker, but it wasn't the last paired device:
 - a. Ensure no other devices are currently paired.
 - b. Enter the Bluetooth Menu on your device being paired.
 - c. "KEMIMOTO" will display under available devices.
 - d. Choose the "KEMIMOTO" to reconnect.

NOTE: Some devices may require a manual Bluetooth reconnection once the devices Bluetooth is powered OFF / ON and/or back in range.

CAUTION

Don't connect the speaker to a 24v power supply, the product is only suitable for 12v power.

Don't clean in hot sun or on very hot days.

Don't use abrasive or highly alkaline cleaners on the main body.

Don't scrape the main body with razor blades, or other sharp instruments.

Don't ever use gasoline, acetone or carbon tetra chloride.

Don't ever use a pressure washer aimed at the speakers.

SPECIFICATIONS

Technical Specifications:

Bluetooth: Version: 4.1

Waterproof : IP-65

Roll Cage Support Size: Up to 1.65"-2 "(5cm)

Tweeter Type: 1" Titanium Dome

Frequency Response: 100hz-20kHz

Impedance: 4 Ohms

Magnet: 10 Oz

Sensitivity: 90 dB

Construction Material: Engineered ABS

Speaker Housing Dimensions (L x W x H): 5.4" x 5.4" x 7.0" inches

Maximum Output Power: 300 Watts

COMMON SOLUTIONS

Problem	What to do
No power	<ul style="list-style-type: none">• Reconnect the wires according to the instructions and make sure the color of the wire harness is correct• Connect to other 12v power supply.
Speaker won't pair with mobile device	<ul style="list-style-type: none">• On your mobile device, turn the Bluetooth feature off and then on.• Remove "KEMIMOTO" from the Bluetooth list on your mobile device. Pair your mobile device again.
No sound	<ul style="list-style-type: none">• On your mobile device, turn the Bluetooth feature off and then on.• Remove "KEMIMOTO" from the Bluetooth list on your mobile device. Pair your mobile device again.• Increase the volume on your mobile device and music source.• Use a different music source.• Pair a different mobile device.• If two mobile devices are connected, pause your other mobile device first.
Poor sound quality	<ul style="list-style-type: none">• Use a different music source.• Pair a different mobile device.• Increase the volume on your mobile device and music source.

FCC Caution:

This device complies with part 15 of the FCC Rules. Operation is subject to the following two conditions: (1) This device may not cause harmful interference, and (2) this device must accept any interference received, including interference that may cause undesired operation.

Any Changes or modifications not expressly approved by the party responsible for compliance could void the user's authority to operate the equipment.

Note: This equipment has been tested and found to comply with the limits for a Class B digital device, pursuant to part 15 of the FCC Rules. These limits are designed to provide reasonable protection against harmful interference in a residential installation. This equipment generates uses and can radiate radio frequency energy and, if not installed and used in accordance with the instructions, may cause harmful interference to radio communications. However, there is no guarantee that interference will not occur in a particular installation. If this equipment does cause harmful interference to radio or television reception, which can be determined by turning the equipment off and on, the user is encouraged to try to correct the interference by one or more of the following measures:

- Reorient or relocate the receiving antenna.
- Increase the separation between the equipment and receiver.
- Connect the equipment into an outlet on a circuit different from that to which the receiver is connected.
- Consult the dealer or an experienced radio/TV technician for help.

The device has been evaluated to meet general RF exposure requirement. The device can be used in portable exposure condition without restriction.