

15W Classic Magnetic Wireless Charger

User Manual

Other mobiles need a wireless charging receiver(include android phone and iPhone)
(Note: All devices must be Qi standard)

Product Specification

Input : 9V 2A
Output : 15W(max)
Efficiency : \geq 73%
Transmission distance : 3-8mm
Standards : Qi

Attention

1. Please use a 9V/2A or 5V/2A adapter and high quality cable to ensure charging effect.
2. If you want clear the charger, please make sure it is not connected power supply.

Attention:

1. Please keep the charger away from water or other liquid.
2. If you need to clean the charger, please make sure it is not connected power supply.
3. Using Environment temperature remains 0-45℃.

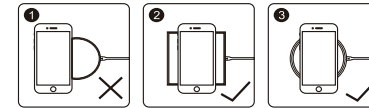

The handset requires a center-emitter for wireless charging, as shown.

Standard Accessories
Wireless Charger
USB Cable
User Manual

"This device complies with Part 15 of the FCC Rules. Operation is subject to the following two conditions: (1) This device may not cause harmful interference, and (2) this device must accept any interference received, including interference that may cause undesired operation."

(2)
Note: This equipment has been tested and found to comply with the limits for a Class B digital device, pursuant to part 15 of the FCC Rules. These limits are designed to provide reasonable protection against harmful interference in a residential installation. This equipment generates, uses and can radiate radio frequency energy and, if not installed and used in accordance with the instructions, may cause harmful interference to radio communications. However, there is no guarantee that interference will not occur in a particular installation. If this equipment does cause harmful interference

to radio or television reception, which can be determined by turning the equipment off and on, the user is encouraged to try to correct the interference by one or more of the following measures:

- Reorient or relocate the receiving antenna.
 - Increase the separation between the equipment and receiver.
 - Connect the equipment into an outlet on a circuit different from that to which the receiver is connected.
 - Consult the dealer or an experienced radio/TV technician for help.
- The equipment complies with FCC radiation exposure limits set forth for an uncontrolled environment. This equipment should be installed and operated with minimum distance between 20cm the radiator your body.

"CAUTION: Changes or modifications not expressly approved by the party responsible for compliance could void the user's authority to operate the equipment."

Product Introduction

Wireless charger is an intelligent product, with simple design and compatible with any mobile phones with Qi standard. Mobile phone is without plug when charging, which is more convenient and efficient. It can bring you with limitless life experience as well as safe and free experience with wireless charging function.

This product is compatible with Qi standard



This device complies with part 15 of the FCC Rules

Made in China