

WiFi Smart Devices

Only 2.4GHz Wi-Fi

Works with Amazon Echo & Google Home
& Bluetooth
User Manual

Specifications:

Power Supply: AC 100-240V, 50/60 Hz
Load Current: 10A Max. Resistive load
Wi-Fi Standard: Only Supports 2.4GHz Network
IEEE 802.11 b/g/n
Operation temperature: -20°C to +55°C

Control with App

1. Download App.
You can scan the QR code to download App.
You can also search "Smartlife" App in either App Store or Google Play to install.

2. Register & Login App.

- ① Open the App.
- ② Register a new account. Please follow the register steps one by one.
- ③ Login with your account & password.



For IOS and Android

- 1 -

Requirements: 2.4GHz Wi-Fi at home

1. If you only have 5GHz Wi-Fi router, you will not be able to complete connection.
2. If you are using a dual Wi-Fi router, and it broadcast 2 Wi-Fi signals, make sure that your phone was connected with the 2.4GHz Wi-Fi signal.
3. If you are using a dual Wi-Fi router but it broadcast only 1 Wi-Fi signals, you will have to manage your Wi-Fi router and change the setting to 2.4GHz Wi-Fi. Then, plug the smart plug into a powered socket.

3. Add new devices-Auto discover

Only 2.4GHz Wi-Fi

- a) Please press and hold the Button for 5 seconds until the indicator is blinking at a uniform speed.

INDICATOR — ○

BUTTON — ⏻

- 2 -

- b) Login with your account & password.
- c) Just a minute, Pop up window: Devices to be added. Please follow the steps one by one.

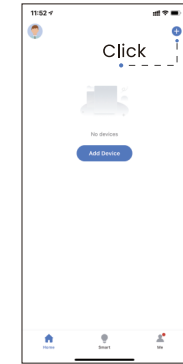

(Figure 1)

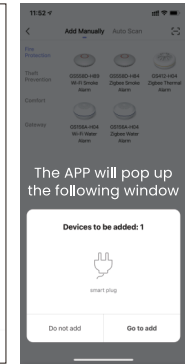

(Figure 2)

- 3 -

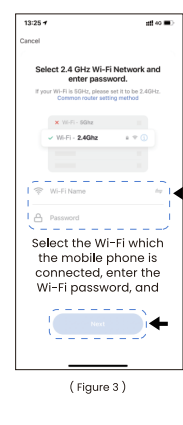

(Figure 3)

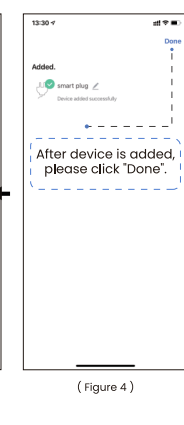

(Figure 4)

- 4 -

Now, You can Control devices on "Smartlife" App.

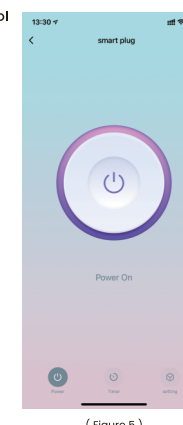

(Figure 5)

- 5 -

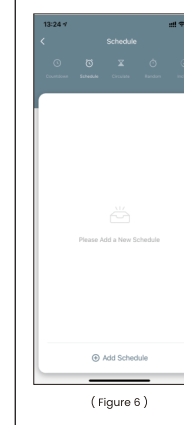

(Figure 6)

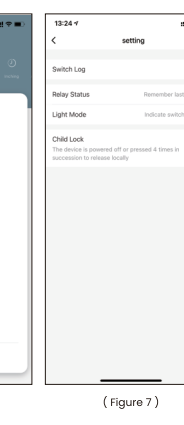

(Figure 7)

- 6 -

If there is no popup window: Devices to be added. Please use Add Manually Add new devices- Add Manually



(Figure 8)

- 7 -

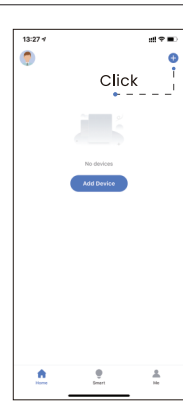

(Figure 9)

- 8 -



(Figure 10)



(Figure 11)

- 9 -

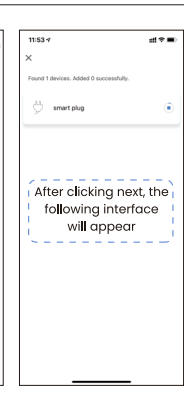

(Figure 12)

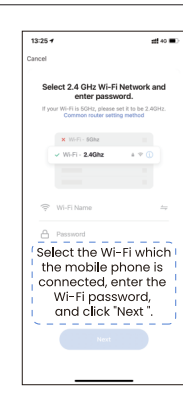

(Figure 13)

- 10 -

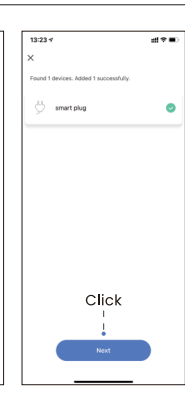

(Figure 14)



(Figure 15)

- 11 -



(Figure 16)

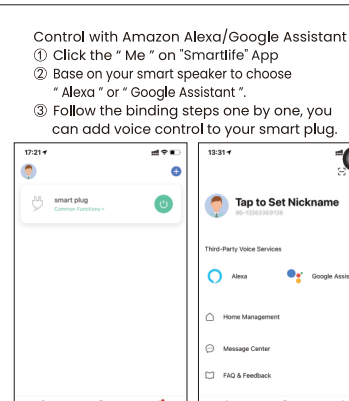

(Figure 17)

- 12 -

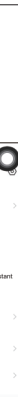

(Figure 18)

After bound, you can use your voice to control your smart devices:
(Amazon Alexa)
Alexa, turn on/off bedroom light.
(Google Assistant)
OK Google, turn on/off bedroom light.

WARNING

- Plug in fully to the wall outlet while using.
- Do not insert a conductor or other tools to the socket hole.
- If there is radio frequency interference, it might affect the operation.
- Indoor use only.
- Do not use in bathroom and other damp locations.
- Please ensure the security of the electricity, resistive load current 10A Max.
- Please keep the device out of the reach of children to avoid danger.



- 13 -

FCC STATEMENT

1. This device complies with Part 15 of the FCC Rules. Operation is subject to the following two conditions:
(1) This device may not cause harmful interference, and
(2) This device must accept any interference received, including interference that may cause undesired operation.

2. Changes or modifications not expressly approved by the party responsible for compliance could void the user's authority to operate the equipment.

NOTE: This equipment has been tested and found to comply with the limits for a Class B digital device, pursuant to Part 15 of the FCC Rules. These limits are designed to provide reasonable protection against harmful interference in a residential installation.
This equipment generates uses and can radiate radio frequency energy and, if not installed and used in accordance with the instructions, may cause harmful interference to radio communications.

- 14 -

However, there is no guarantee that interference will not occur in a particular installation. If this equipment does cause harmful interference to radio or television reception, which can be determined by turning the equipment off and on, the user is encouraged to try to correct the interference by one or more of the following measures:

- Reorient or relocate the receiving antenna.
- Increase the separation between the equipment and receiver.
- Connect the equipment into an outlet on a circuit different from that to which the receiver is connected.
- Consult the dealer or an experienced radio/TV technician for help.

Radiation Exposure Statement

This equipment complies with FCC radiation exposure limits set forth for an uncontrolled environment. This equipment should be installed and operated with minimum distance 20cm between the radiator & your body.

- 15 -