

# Khadas Tea User Manual

## SECTION 0: Quickstart Guide

### QUICKSTART GUIDE



## SECTION 1: Product Diagram

### 1 PRODUCT DIAGRAM

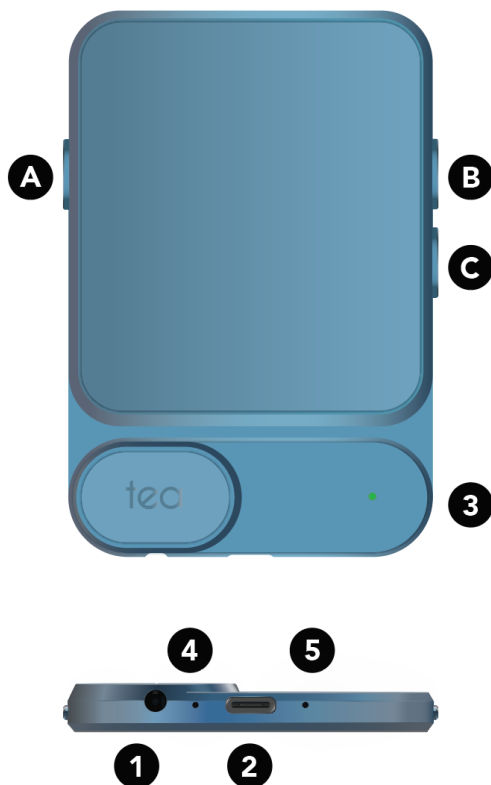

## SECTION 2: Interface Usage



On / Off / Play / Pause / Accept, Reject Call / Hey Siri



Volume Up / Previous Track



Volume Down / Next Track



Track Mode / Volume Mode



Enable Recharging / Disable Recharging



3.5 Single-End Headphone Jack



USB-C Recharging / USB Data Input

3

RGB LED Indicator Light

4  
5

Microphones

### SECTION 3: Indicator Light

3



Off / Fully Charged

3



Bluetooth Pairing

3



Bluetooth Paired

3



Bluetooth Music Playback

3



DSD Playback

3



MQA Rendering

3



PCM Playback

3



Low Battery

3



Battery Charging



Mode Switch Confirmation

## SECTION 4: Turn Device On / Off



Long-press for 3-seconds to turn 'Tea' ON. Repeat action again to turn 'Tea' OFF.

## SECTION 5: Bluetooth Pairing



Pair with 'Tea' from within your Bluetooth menu. When 'Tea' is turned off, long-press for 6-seconds to pair with another device.

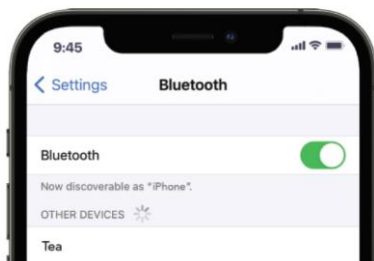

## SECTION 6: Switch Button Mode



Press simultaneously to cause buttons B and C to switch from volume mode, to track change mode.

## SECTION 7: Smartphone Recharge



Press simultaneously to enable/disable recharging 'Tea' from your smartphone. The USB-C to C cable supports recharging, the USB-C to Lightning cable does not.



## SECTION 8: Incoming Call Accept / Reject



Single press to accept incoming call (short press again to hang up)



Double-press to reject incoming call

## SECTION 9: Hey Siri Digital Assistant



**2s**

Long press for 2 seconds to activate Siri

## SECTION 10: App Download

Download the App from the iOS or Android App Store. This app provides additional control and functionality. Scan the QR code to download for iOS or Android.



Android



iOS



## SECTION 11: Warranty and Support

Contact customer service if you require assistance, and before arranging return-shipment of this product. See the included warranty card for more details.

**Email:** [support@khadas.com](mailto:support@khadas.com)

**Website:** <https://khadas.com/tea>

## FCC Statement

This equipment has been tested and found to comply with the limits for a Class B digital device, pursuant to part 15 of the FCC Rules. These limits are designed to provide reasonable protection against harmful interference in a residential installation. This equipment generates, uses and can radiate radio frequency energy and, if not installed and used in accordance with the instructions, may cause harmful interference to radio communications. However, there is no guarantee that interference will not occur in a particular installation. If this equipment does cause harmful interference to radio or television reception, which can be determined by turning the equipment off and on, the user is encouraged to try to correct the interference by one or more of the following measures:

- Reorient or relocate the receiving antenna.
- Increase the separation between the equipment and receiver.
- Connect the equipment into an outlet on a circuit different from that to which the receiver is connected.
- Consult the dealer or an experienced radio/TV technician for help.

Caution: Any changes or modifications to this device not explicitly approved by manufacturer could void your authority to operate this equipment.

This device complies with part 15 of the FCC Rules. Operation is subject to the following two conditions: (1) This device may not cause harmful interference, and (2) this device must accept any interference received, including interference that may cause undesired operation.

### RF Exposure Information

The device has been evaluated to meet general RF exposure requirement. The device can be used in portable exposure condition without restriction.