

REV	DESCRIPTION	DESIGN	CHECK	APPROVAL
A1	发行A1版图档			

封底

封面

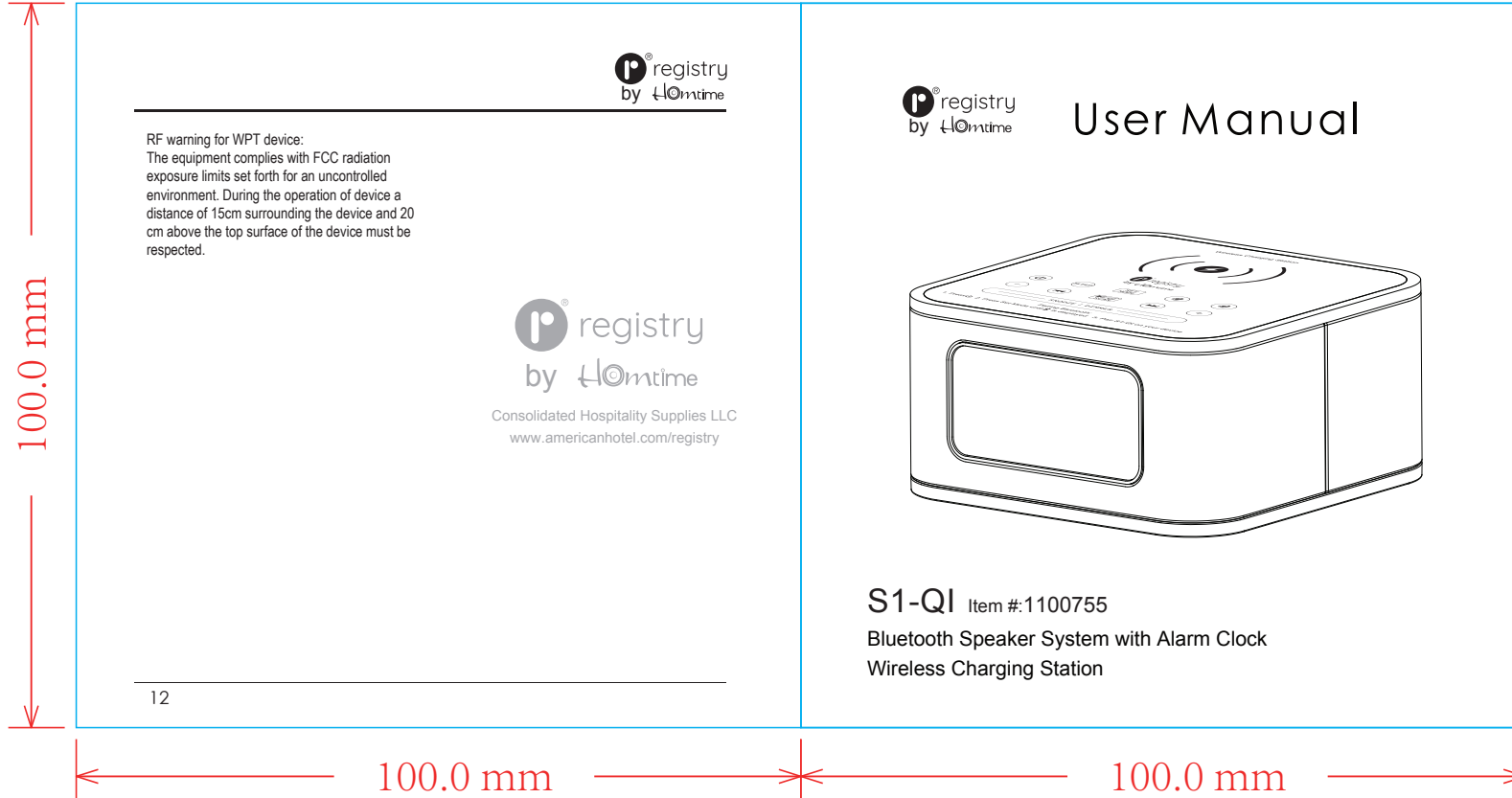

DEG	A	B	C	D		
0~10	±0.02	±0.05	±0.1		0~30'	±0.5'
11~20	±0.05	±0.1	±0.15		31~60'	±0.5'
21~30	±0.1	±0.15	±0.2		61~90'	±1'
31~50	±0.15	±0.2	±0.3			
51~	±0.2	±0.25				

Modle Name: S1-QI (CHS)		3rd Angle Projection			
Part Name: 英文说明书					
Doc No.:				Draw	Date: 2022-01-10
Material: 120G双胶纸		Unit mm	Scale 1/1	Check	Date:
Finish: 单黑印刷+钉装 共14P		Sheet	1 of 1	Approval	Date:



User Manual

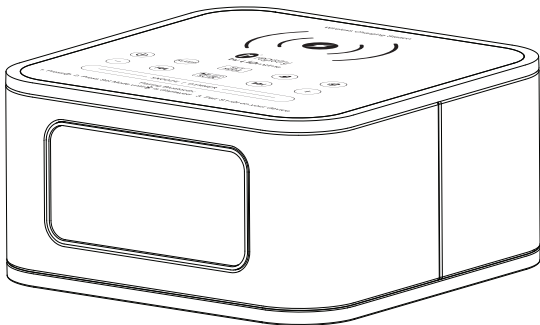

S1-QI Item #:1100755

Bluetooth Speaker System with Alarm Clock
Wireless Charging Station

INDEX

CAUTION	1	CARE & MAINTENANCE / FAQ	9
STEP TO BLUETOOTH FUNCTION	2	NOTICE	10
INFORMATION	3	FCC Caution	11
What's in the box	3		
Product features	3		
Specifications	3		
UNIT FEATURES & FUNCTIONS	4		
BASIC	6		
Power ON	6		
Set Time	6		
Set Alarm Time	6		
Alarm Function	6		
Sleep Function Under on Mode	6		
Play Music from Mobile VIA Bluetooth	6		
FM Radio Operation	7		
Play Music from AUX jack	7		
USB PLAYBACK & CHARGING	7		
Back-up Button Battery	7		
WIRELESS CHARGING	8		

CAUTION

KNOW THESE SAFETY SYMBOLS



This 'bolt of lightning' indicates uninsulated material within your unit may cause an electric shock. For the safety of everyone in your household, please do not remove product covering.

The 'exclamation mark' calls attention to features for which you should read the enclosed literature closely to prevent operating and maintenance problems.

WARNING: To reduce the risk of fire or electric shock, this apparatus should not be exposed to rain or moisture and objects filled with liquids, such as vases, should not be placed on this apparatus.

CAUTION: To prevent electric shock, fully insert the plug. (For regions with polarized plugs: To prevent electric shock, match wide blade to wide slot.)

IMPORTANT SAFETY INSTRUCTIONS

- a Read these instructions.
- b Keep these instructions.

c Heed all warnings.

d Follow all instructions.

e Do not use this apparatus near water.

f Clean only with dry cloth.

g Do not block any ventilation openings.

Install in accordance with the manufacturer's instructions.

h Do not install near any heat sources such as radiators, heat registers, stoves, or other apparatus (including amplifiers) that produce heat.

i Protect the power cord from being walked on or pinched, particularly at plugs, convenience receptacles, and the point where they exit from the apparatus.

j Only use attachments/accessories specified by the manufacturer.

k Unplug this apparatus during lightning storms or when unused for long periods of time.

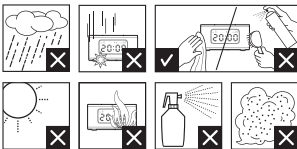

STEP TO BLUETOOTH FUNCTION

LISTEN

Pairing

First, register ("pair") a Bluetooth device (mobile phone, etc) and this unit with each other. Once pairing is established, there is no need for pairing again.

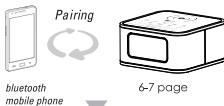

Bluetooth connection

Operate the Bluetooth device to make the Bluetooth connection.

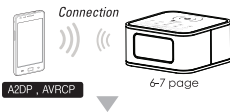

Listening to music

You can listen to music played on the Bluetooth device. Playback or pause is possible from this unit.

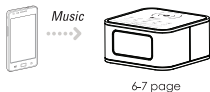

CALLING

Pairing

First, register ("pair") a Bluetooth device (mobile phone, etc) and this unit with each other. Once pairing is established, there is no need for pairing again.

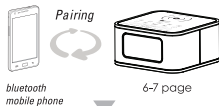

Bluetooth connection

When the unit is turned on, the unit starts making the Bluetooth connection to the recognized mobile phone automatically.

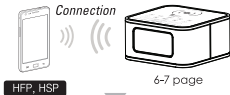

Talking on the phone

You can make and receive a call by operating this unit.

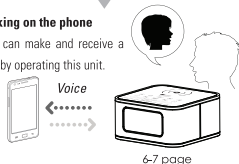

INFORMATION

WHAT'S IN THE BOX

<i>S1-QI Body Unit</i>	<i>1 PCS</i>
<i>Power Adaptor</i>	<i>1 PCS</i>
<i>User Manual</i>	<i>1 PCS</i>
<i>Audio Cable</i>	<i>1 PCS</i>
<i>Button Battery</i>	<i>1 PCS</i>

PRODUCT FEATURES

- 1) Stereo speaker, providing superior quality sound
- 2) Bluetooth Hands-Free call
- 3) 3.2 inch backlit LCD with 3 levels dimming
- 4) FM digital radio
- 5) 3.5mm audio jack for connecting other audio sources
- 6) Single USB charging port
- 7) Dual alarms
- 8) USB playing, supports MP3/WAV format
- 9) Wireless charging for Qi-enabled cellphones
- 10) 12H/24H switch
- 11) Snooze/Sleep function

SPECIFICATIONS

- Bluetooth specification : 3.0
- Bluetooth profiles : HSP, HFP, A2DP and AVRCP
- Bluetooth frequency range : 2.402GHz - 2.480GHz
- Operating distance : 32.8 feet / 10 m
- Operation Voltage : DC 5V 3A
- Output Power : 3w + 3w
- Driver Unit : 40hm 3w 2in
- Frequency range : 40Hz - 20KHz
- S/N Ratio : >65dB
- Distortion Rate : <1%
- FM Frequency Range : 87.5 - 108MHz
- Wireless Charging current : 300 - 600mA
- Dimensions : 5.43x5.43x2.72 inches
13.8x13.8x6.9 CM
- Net Weight : 1.741 lbs / 0.79 KGs

** Product information is subject to change without prior notice.*

UNIT FEATURES & FUNCTIONS

FRONT

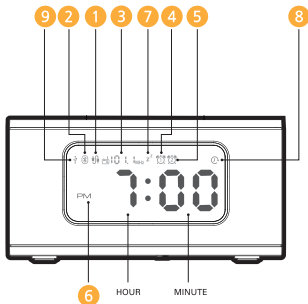

REAR

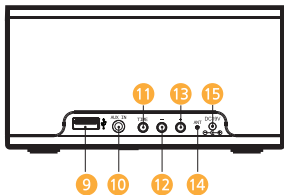

FUNCTION
1 AUX MODE
2 BLUETOOTH MODE
3 FM RADIO MODE
4 ALARM 1
5 ALARM 2
6 AM/PM
7 SNOOZE
8 SLEEP TIMER
9 USB PLAY / CHARGE
10 AUX INPUT
11 TIME SETTING
12 -
13 +
14 RADIO ANT
15 POWER

UNIT FEATURES & FUNCTIONS

TOP

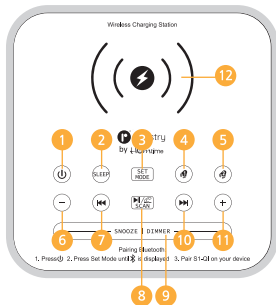

BUTTON	FUNCTION
1 BUTTON	Power ON/OFF
2 SLEEP	SNOOZE 90-80-70-60-50-40-30-20-10-OFF minute
3 MODE, SETTING	Switch Modes, Alarm Time setting
4 ALARM 1	Time Setting of Alarm 1
5 ALARM 2	Time Setting of Alarm 2
6 VOL -, TIME-	Volume down / Adjusting Alarm Time
7 BACKWARD SONG	Skip Backwards last song
8 PLAY/PAUSE, TALK, SCAN	Bluetooth & USB, Play/Pause, Answer the phone and Hang up/Auto scan FM station
9 SNOOZE, LED	SNOOZE, Display Brightness Level (4 Level : 1-2-3-4)
10 NEXT SONG	Skip Forwards next song
11 VOL +, TIME+	Volume up / Adjusting Alarm Time
12 WIRELESS CHARGING SURFACE	mobile device is placed on the charging surface. mobile device may charge properly.

BASIC

POWER ON

Connect the power cable into the jack on the back of S1-Q1 labeled "DC 5V", and then plug the power cable into the USB charger. The LCD display turns on. Press "⏻" to turn on the unit.

SET TIME

Under any mode, press "TIME" to set time. Press "+" or "-" to switch the Hour mode between 12-Hour and 24-Hour. Press "TIME" to confirm it. Then Hour figure and MINUTE figure begin to flash. Press "+" or "-" to adjust the HOUR and press "TIME" to confirm it, then press "+" or "-" to adjust the MINUTE and press "TIME" to confirm the setting. It exits the setting in 10seconds if no operation on any key.

SET ALARM TIME

Under any mode, press "🔔" to enter alarm time



setting, "🔔" icon displays in the LCD. Press "🔔" some times to display OFF/BU. (OFF- none alarm is selected). When BU icon appears, press "SET MODE" to enter alarm time setting. The HOUR figure begins to flash, then press "+" or "-" on the top side of the unit to adjust the figure; Press "SET MODE", the MINUTE figure begins to flash. Press "+"

or "-" to adjust the figure. It will exit the setting in 5 seconds if no operation on any key.

ALARM FUNCTION

1) When alarm1 is on, icon is flashing in the LCD and the alarm ring tone is becoming larger and larger. Press " Snooze / DIMMER " to activate the Snooze function. " z z " icon appears in the LCD. Alarm will be on again in 9-minute snooze. The alarm can last for 30minutes at most if no button is pressed (including snooze time).

2) To stop alarm, press "⏻" or "🔔". Alarm 1 is one-off alarm.

3) Setting Alarm "🔔" is the same as setting Alarm "🔔". Alarm "🔔" works everyday. To turn it off completely, switch "🔔" to OFF mode.

SLEEP FUNCTION UNDER ON MODE

Press "⏻" to set timing shutdown time from 90-80-70.....OFF.

Choose the time, it will store it automatically in 3 seconds and exit the setting. To see the remaining sleep time, press "⏻".

PLAY MUSIC FROM MOBILE VIA BLUETOOTH

OPERATION

Press "SET MODE" to choose Bluetooth mode. Go to mobile settings, turn on Bluetooth and search Bluetooth devices. Connect

BASIC

"S1-Q1". When it is successfully paired, you will hear a sound of "DU". Play music from your mobile now. (When Bluetooth is connected, press "  " to switch it to other mode, Bluetooth will be OFF automatically and get disconnected with mobile. When switching it to Bluetooth mode again, connect "S1-Q1" manually or automatically.)



ANSWER THE PHONE

When a phone call is coming, press "  " to answer the phone.



HANG UP

Press "  " to hang up when having a phone call.

PLAY MUSIC

When playing music, press "  " to pause the music. Press "  " to skip backwards last song; Press "  " to skip forwards next song.

FM RADIO OPERATION

Switch the unit to FM mode, Press and Hold "  " to auto scan radio station and store the scanned stations accordingly. The frequency starts from 87.5MHz to 108MHz and skips at every 0.1 MHz in scanning process. Once catching a station, it stops a second and store it, then continues the auto-scanning. When it scans from 87.5MHz to 108MHz or stores 20 stations, it will stop scan automatically. Press "  " or "  " to select the station.

PLAY MUSIC FROM AUX JACK

Press "  " to switch the mode to AUX IN, plug in the 3.5mm audio cable into the AUX IN jack. Play music now.

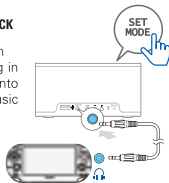

USB PLAYBACK & CHARGING

Supports USB memory music playback and enables fast charging of smartphones and other digital devices.

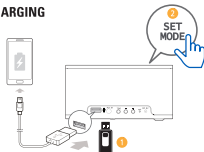

BACK-UP BUTTON BATTERY

The 3V button battery is to retain the alarm/clock setting in case of a power failure. It can not display the alarm/clock time.

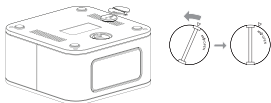

CAUTION

a Wireless charging covers are sold separately.

b Use only JBlab - approved adapter.

Unauthorized chargers may cause damage or the wireless charger may malfunction..

c Do not place the wireless charging cover solely on the wireless charger. Doing so may overheat the wireless charger and cause a fire. It may also result in serious burn or device malfunction.

d To charge a mobile device that does not have a built-in wireless charging coil, attach a wireless charging cover to the mobile device. Then, place the mobile device on the wireless charger.

e Do not place foreign materials, such as metal objects, magnets, and magnetic stripe cards, between the mobile device and the wireless charger. The mobile device may not charge properly or may be damaged due to overheating.

f When the mobile device is fully charged, remove it from the wireless charger.

g When the mobile device is not placed on the charging surface properly, or depending on the location of the mobile device's wireless charging coil, your mobile device may not charge properly.

h Depending on the location of the mobile device's wireless charging coil, your mobile device may not charge properly.

i Wireless charging may not work properly if you have attached a thick case to your mobile device. If your case is thick, remove it before placing your mobile device on the wireless charger.

j If you use the wireless charger in areas with weak network signals, you may lose network reception.

k If you connect a charger to the mobile device during wireless charging, the wireless charging feature will be unavailable.

l The wireless charger is compatible with Wireless Power Consortium (WPC) certified devices.

FAQs

CARE AND MAINTENANCE

Read the following recommendations before using S1-Q1 . Following these you will be able to enjoy our product for many years.

1. *Keep the product dry and don't put it in the damp place to avoid the product's internal circuit being affected.*
2. *Keep the product away from direct sunlight or hot places. High temperature will shorten the life of electronic devices, destroy the battery or distort certain plastic parts.*
3. *Don't expose the product to cold areas as it may damage the internal circuit board.*
4. *Don't try to disassemble the product as it may get damaged if you are not professional.*
5. *Don't let the product fall down onto the floor or other hard surfaces. The internal circuit might get damaged.*
6. *Don't use intensive chemical products or detergent to clean the product.*
7. *Don't scratch the surface with sharp things.*

FAQs

What to do when there is no sound when making a call with S1-Q1 ?

1. *Ensure S1-Q1 connects well with Bluetooth mobile phone*
2. *Ensure the volume has already been properly adjusted*

3. *Make sure the audio input of car audio system is adjusted to AUX.*

What to do when my mobile phone can not search and find S1-Q1 ?

If S1-Q1 is not in pairing mode, your mobile phone can't find it. Please make sure S1-Q1 is in pairing mode and in the effective working range.

What to do when the voice is not clear?

1. *Ensure your mobile phone is in strong-signal areas.*
2. *Ensure S1-Q1 is in the effective working range.*

How far is the effective range between S1-Q1 and Bluetooth mobile phone?

According to the Bluetooth standard, the max. controllable range of Class II handsfree kit is 32.8feet . But it varies with different environment and paired mobile phone.

Poor radio reception?

1. *Keep the clock radio away from other electronic devices to avoid radio interference.*
2. *Fully extend and adjust the position of the FM antenna.*

No response from the clock radio

Disconnect and reconnect the power cable , then turn on the clock radio again.

NOTICE

Clock/alarm setting erased

- 1. Power has been interrupted or the power plug has been disconnected.*
- 2. Reset the clock/alarm.*
- 3. Back up battery was dead, so please change it.*

When you use the USB power supply cable, it can occur that a charging delay and being not charged phenomenon. To charge battery effectively, please use the AC adapter.

of your old products with your normal household waste. Correct disposal of your old product helps to prevent potential negative consequences for the environment and human health.



Your product contains batteries covered by the European Directive 2006/66/EC, which cannot be disposed with normal household waste. Please inform yourself about the local rules on separate collection of batteries because correct disposal helps to prevent negative consequences for the environmental and human health.

NOTICE



Your product is designed and manufactured with high quality materials and components, which can be recycled and reused.



When this crossed-out wheeled bin symbol is attached to a product it means that the product is covered by the European Directive 2002/96/EC.

Please inform yourself about the local separate collection system for electrical and electronic products.

Please act according to your local rules and do not dispose

FCC Caution

FCC Radiation Exposure Statement:

This equipment complies with FCC radiation exposure limits set forth for an uncontrolled environment. In order to avoid the possibility of exceeding the FCC radio frequency exposure limits, Human proximity to the antenna shall not be less than 20cm (8 inches) during normal operation.

FCC Caution.

This device complies with part 15 of the FCC Rules. Operation is subject to the following two conditions: (1) This device may not cause harmful interference, and (2) this device must accept any interference received, including interference that may cause undesired operation.

Any Changes or modifications not expressly approved by the party responsible for compliance could void the user's authority to operate the equipment.

Note: This equipment has been tested and found to comply with the limits for a Class B digital device, pursuant to part 15 of the FCC Rules. These limits are designed to provide reasonable protection against harmful interference in a residential installation. This equipment generates uses and can radiate radio frequency energy and, if not installed and used in accordance with the instructions, may cause harmful interference to radio communications. However, there is no guarantee that interference will not occur in a particular installation. If this equipment does cause harmful interference to radio or television reception, which can be determined by turning the equipment off and on, the user is encouraged to try to correct the interference by one or more of the following measures:

- Reorient or relocate the receiving antenna.
- Increase the separation between the equipment and receiver.
- Connect the equipment into an outlet on a circuit different from that to which the receiver is connected.
- Consult the dealer or an experienced radio/TV technician for help.

RF warning for WPT device:

The equipment complies with FCC radiation exposure limits set forth for an uncontrolled environment. During the operation of device a distance of 15cm surrounding the device and 20 cm above the top surface of the device must be respected.



Consolidated Hospitality Supplies LLC
www.americanhotel.com/registry